

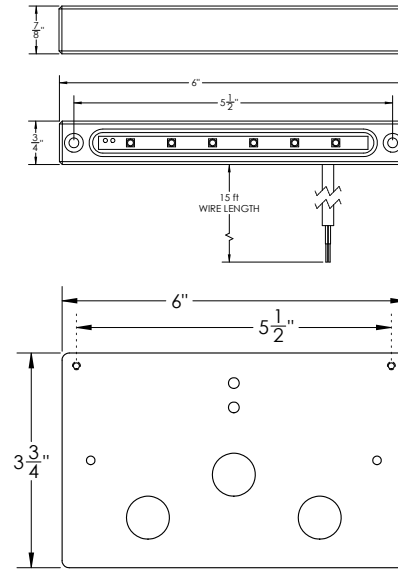

Slim and versatile, this accent light allows for maximum adaptability in any landscape project. The powder coated cast aluminum housing features discreet connector wire. The connector ensures installation ease and simple replacement. Accent lights are completely waterproof and come with a mounting plate in the event the installation calls for grout, gravel, etc. The light may also be mounted directly to a surface. These lights have;

- Haven LED Technology.
- Anti-moisture connections.
- Concealed integrated connector.

DIMENSIONS



TECHNICAL SPECIFICATIONS

POWER INFORMATION

Voltage: 12V AC or 12V DC

Wattage: 1W

Max Voltage: 15V AC or 15V DC

Color Temperature: 2700K

Transformer: Stratus or Mosaic (sold separately)

CONSTRUCTION

Cast Aluminum Color Options: Gray, Brown

Wire Length: 15 ft.

FEATURES



MODEL NUMBER	MODEL NAME	LED/MAX POWER	FINISH	COLOR OPTION
627A2	Brown Accent Light	1W / 1.5W	Aluminum	2700K
627A4	Gray Accent Light	1W / 1.5W	Aluminum	2700K

= Best Seller