

Gingerbread Church - 2 different linens

Below you can find Suggested Fabric Layouts for the black and gingerbread coloured linens Thea used for her Gingerbread Church. You do not need to follow these suggestions, but they may be of some help to you. We gave you 1" of extra linen all the way around each piece for finishing. Please double check your own measurements from those in the leaflet to be sure.

1. Cut Antique Almond linen 14" wide x 29 1/2" high for the Church and Steeple Fronts, Backs, Sides and optional Bases.
2. Cut Black linen 7" wide x 26" high for all the roof pieces.

We suggest you baste the lines on your piece of fabric, and then baste horizontal and vertical lines on each section, so you can centre and stitch each design on one big piece of fabric, stretched on your roller bars. - Lisa

Model: 28ct "Antique Almond" Cashel: 14"w x 29.5"h

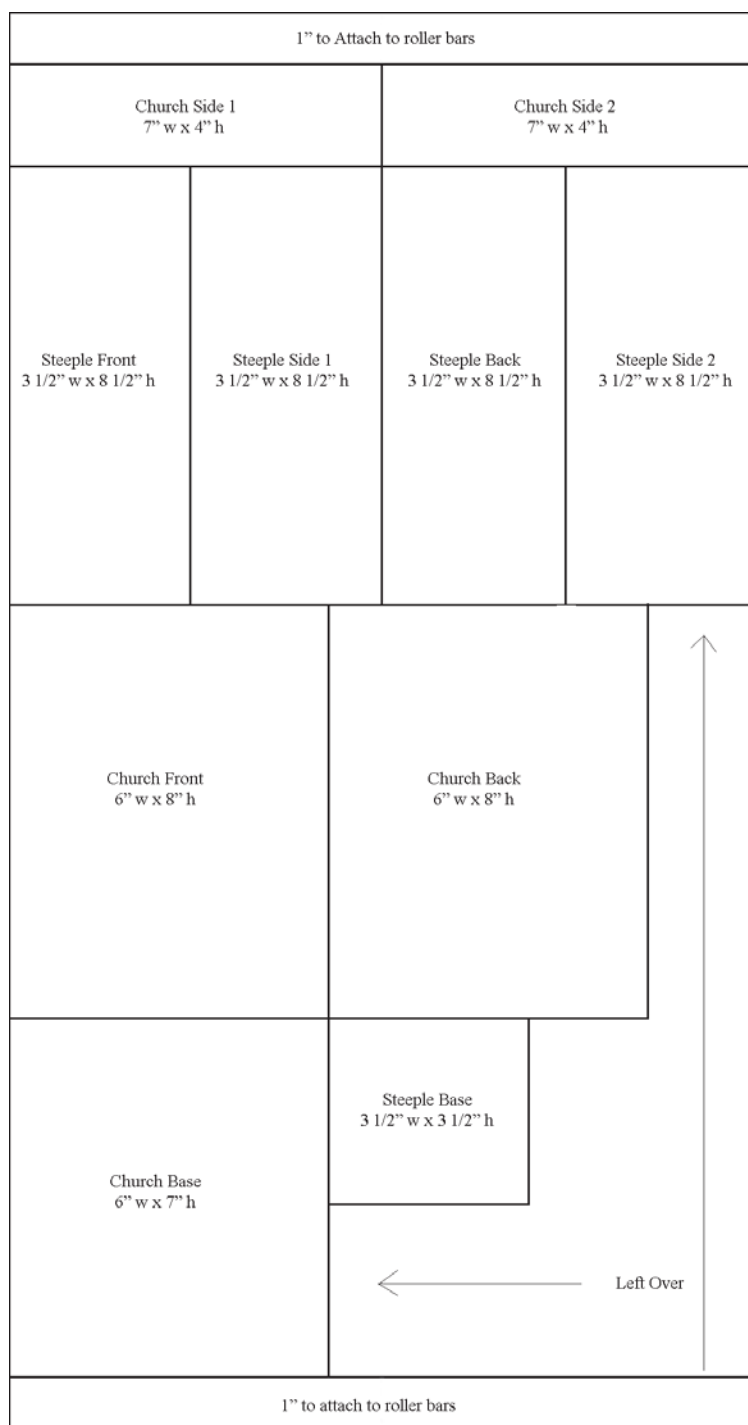

Model: 28ct "Black" Cashel Linen: 7"w x 26"h

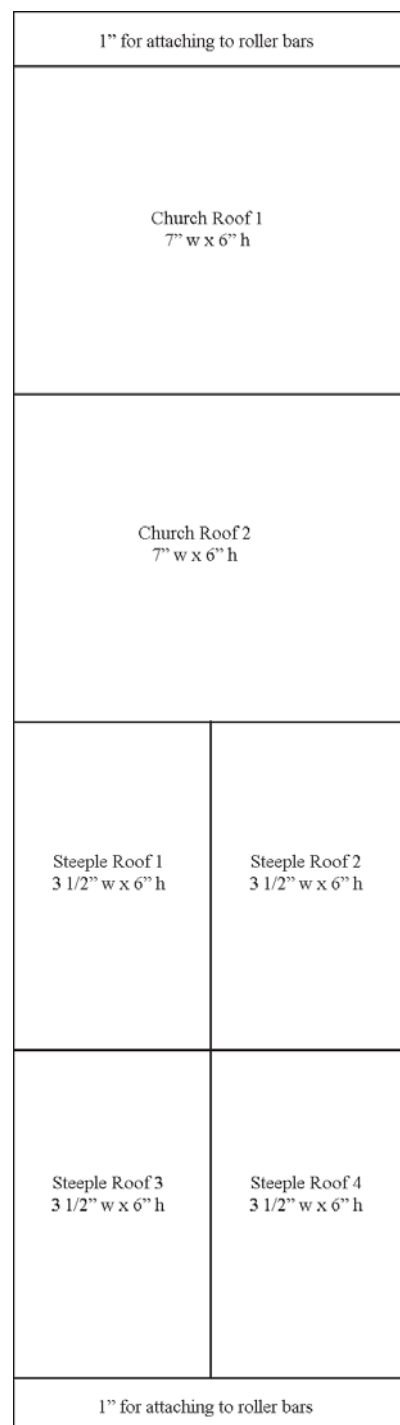

The
Victoria
SAMPLER

©Copyright 2011 Thea Dueck

