

Light up your kitchen,

Spread your world with a new vision.-----Peppermint

Limited Warranty of Peppermint ®

Peppermint ® is a reliable brand and we always put your needs and rights at the first place. Beauty, elegance and innovation this is always what we are chasing for. We endow our products with more spirits, for making you own a different kind of feeling for your cooking life. All faucets are backed by our Peppermint warranty®, covering finish and function. Following the warranty information below, you will find important details on how to maintain the quality of your new faucets.

How Long About Our Warranty?

All parts (other than electronic parts and batteries) and finishes of this Peppermint ® faucets are guaranteed to the original consumer purchaser to be free from defects in material and workmanship for 10 years, for commercial users, for three (3) years from the date of purchase.

Electronic Parts and Batteries (if applicable)

Electronic parts (other than batteries), if any, of this Peppermint® faucet are guaranteed to the original consumer purchaser to be free from defects in material and workmanship for three (3) years from the date of purchase or, for commercial users, for one (1) year from the date of purchase. No warranty is provided on batteries.

What We Will Do

Peppermint® will repair or replace, free of charge, during the applicable warranty period, any part that proves defective in material and/or workmanship under normal installation, use and service. If repair or replacement is not practical, Peppermint® may elect to refund the purchase price in exchange for the return of the product. These are your exclusive remedies.

For The Following Situation, That Is Not Covered

This Limited Warranty covers only those workmanship and material non-conformities specified above, and does not cover for any damage to the faucet resulting from reasonable wear and tear, misuse, abuse, neglect or improper or incorrectly performed installation, maintenance or repair, or product misuse or due to the use of cleaners containing abrasives, alcohol or other organic solvents. We recommend using a professional plumber for all installation and repair.

Peppermint ® reserves all the right for the final explanation.

Safety information

*Before you read this instruction, please firstly check for the product that you received.

Make sure all the components are in good condition and no parts missing.

*Please read this instruction thoroughly.

*If you are not confident for finishing the whole installation. Please employ an experienced and qualified plumber for avoiding any unexpected loss.

*Before you start any installation, please consider the followings.

*Check there is no hidden electrical wires, cables or water supply pipes.

*All the tools that you need are prepared.

*This product must not be modified in any way as this will invalidate the warranty.

*Make sure the water supply or your main stopcock is off

Easy & quick installing guide

For the pull out system installation, the whole pull out system is designed for a convenient installing and quick replacement. There will be three important part for you to install :

Faucet Pull out system

Part 1 : faucet body connecting: Using the o-ring for connecting the faucet body and the pull out hose.

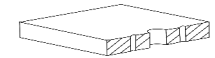
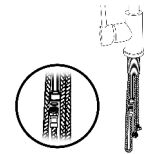
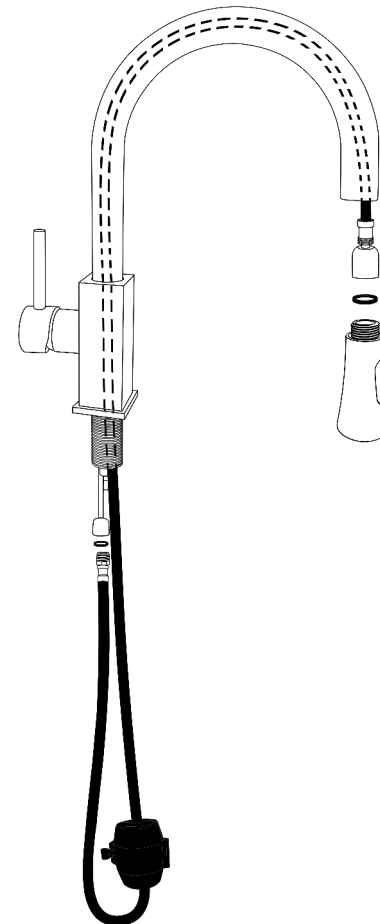

Part 2 : gravity ball : Please see the mark that we make on the pull out hose. That is correct position for installing the ball.

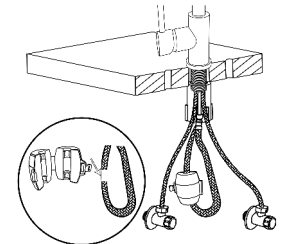

Part 3 : pull out spray : Using the o-ring for connecting the pull out hose and the spray head



Attention : The following guide will mention the corresponding part about the pull out system.

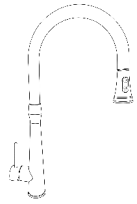

one hole Kitchen Pull Out Faucet

1. Make sure all the components are prepared to start installation.
2. Screw in the flexible connecting pipes to the mixer and the water supply. And installing the pull out system part 1 【(8) , (9)】 . We suggest that you better use your hand and do not over tighten.
3. Installing the hole cover (for 3 hole) ,make the faucet through the hole cover and your worktop.
4. Installing the rubber gasket (11) and metal bracket (12) from the bottom of the faucet, then using locking nut (13) , secure the faucet to the worktop by tightening the locking nut (13).
5. Installing the pull out system part 2 【(8),(14)】 and part 3 【(6),(7)】 .
6. Turning on the water supply or your main stopcock, and open the faucet letting the water flow for a few minutes to check all the parts and connections for any leaks.

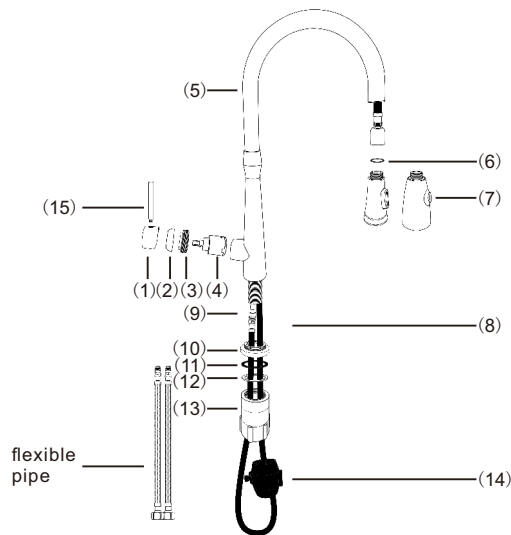

- (1) handle
- (2) handle décor
- (3) handle fixed kit
- (4) valve
- (5) faucet body
- (6) pull out spray
- (7) o-ring (for pull out spray)
- (8) pull out hose
- (9) o-ring (connecting faucet body to the pull out hose)
- (10) faucet fixed decor
- (11) rubber gasket
- (12) metal bracket
- (13) locking nut
- (14) gravity ball
- (15) handle stick

-3-

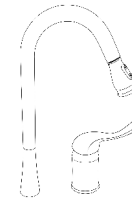

three hole Kitchen Pull Out Faucet

1. Make sure all the components are prepared to start installation.
2. Installing the middle faucet body (10) . Make it through the worktop. Then Installing the rubber gasket (14) and metal bracket (15) from the bottom of the faucet, then using locking nut (16) , secure the faucet to the worktop by tightening the locking nut (16).
3. Screw in the flexible connecting pipes to the mixer (faucet handle body) (5) . We suggest that you better use your hand and do not over tighten.
4. Make the mixer (faucet handle body) (5) through the worktop. .Installing the rubber gasket (7) and metal bracket (8) from the bottom of the mixer (faucet handle body) (5), then using locking nut (9), secure the faucet to the worktop by tightening the locking nut (9).
5. And installing the pull out system part 1 【(6) , (13)】 . Screw the flexible connecting pipes to the water supply. We suggest that you better use your hand and do not over tighten.
6. Installing the pull out system part 2 【(13),(17)】 and part 3 【(11),(12)】 .
7. Turning on the water supply or your main stopcock, and open the faucet letting the water flow for a few minutes to check all the parts and connections for any leaks.
8. Screw the rubber gasket (19) to the main dispenser body and then make it through the worktop. For fixing the dispenser, Installing the rubber gasket (20) and metal bracket (21) from the bottom of the dispenser Screw the bottle (22) to the dispenser.

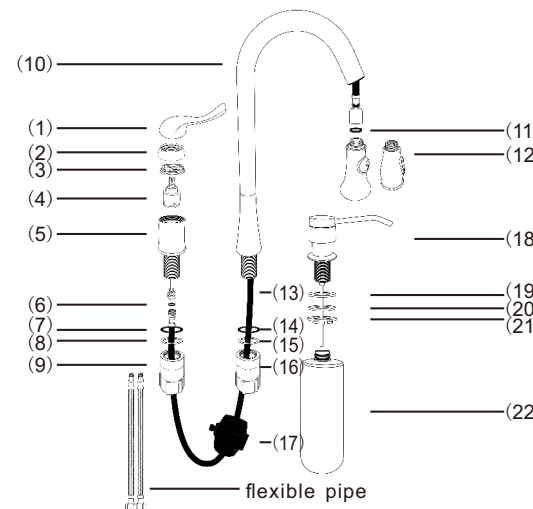

- (1) handle
- (2) handle décor
- (3) handle fixed kit
- (4) valve
- (5) faucet handle body
- (6) o-ring (for pull out spray)
- (7) rubber gasket
- (8) metal bracket
- (9) locking nut
- (10) middle faucet body
- (11) o-ring (connecting faucet body to the pull out hose)
- (12) pull out spray
- (13) pull out hose
- (14) rubber gasket
- (15) metal bracket
- (16) locking nut
- (17) gravity ball
- (18) dispenser head
- (19) rubber gasket
- (20) rubber gasket
- (21) metal bracket
- (22) bottle

-4-

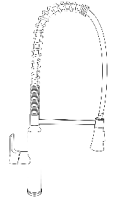

High spring Kitchen Pull Out Faucet

1. Make sure all the components are prepared to start installation.
2. Screw in the flexible connecting pipes to the mixer and the water supply. We suggest that you better use your hand and do not over tighten.
3. Installing the hole cover (for 3 hole) ,make the faucet through the hole cover and your worktop.
4. Installing the rubber gasket (10) and metal bracket (11) from the bottom of the faucet, then using locking nut (12) , secure the faucet to the worktop by tightening the locking nut (12).
5. Turning on the water supply or your main stopcock, and open the faucet letting the water flow for a few minutes to check all the parts and connections for any leaks.

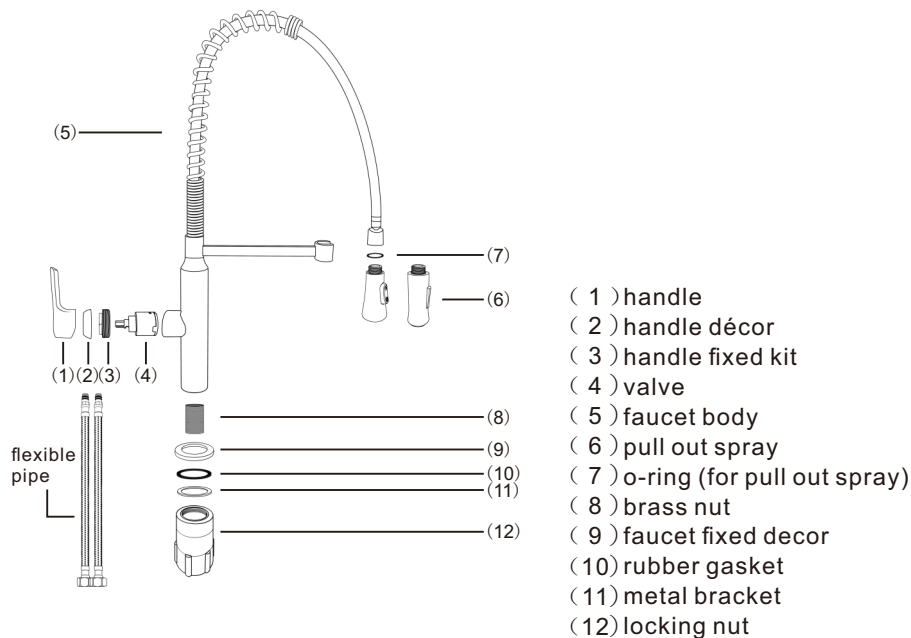

GENERAL CLEANING

The only safe way to clean your product is to wipe with a soft damp cloth. Removing the spots from your chrome faucets doesn't require harsh chemicals or strenuous scrubbing, and the sooner you tackle the spots, the easier they are to clean. Although you can't completely keep your faucets from spotting unless you install a water softener, by cleaning the faucet regularly you can prevent deposits from building up, so the chrome looks its best at all times.

Please pay attention if you still want to use some liquid for an easy clean. We suggest using the washing up liquid. All bathroom cleaning products (powders and liquids) will damage the surface of your fitting, even the non-scratch cleaner.