



THE OUTDOOR
GREATROOM
COMPANY

The Cove Fire Pit

Installation Instructions for CV-1242, CV-54 and CV-72



IMPORTANT

Please consult your Crystal Fire® Plus instruction manual for detailed instructions and important information related to the burner installation including: lighting and operating instructions, safety information, and proper tightening of connections with two wrenches.

DO NOT ATTEMPT TO INSTALL CRYSTAL FIRE® PLUS BURNERS WITHOUT FIRST CONSULTING THE CRYSTAL FIRE® PLUS OWNER'S MANUAL.

Contents

Required Tools.....	2
Included with your Fire Pit.....	3
Assembly Instructions.....	4
Sparker Box Installation.....	4
Gas Connections.....	5
Burner installation.....	6
Glass Installation.....	7

Required Tools

FOUR people are required for this installation.



- 2 Open Ended Wrenches
To secure gas connections.



- Leather Gloves
To protect hands from rough edges found on fire pit during installation.



- One AAA Battery (not included)
Required for electric spark igniter installation.



- Utility Knife
To cut and remove packaging.



- Power Drill
To remove support board from crate.

Included With Your Fire Pit

CV-1242



CV-1242-BASE with Control Panel

CV-54 / CV-72

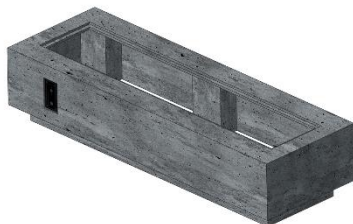

CV-54/CV-72 Base and Pedestal
with Control Panel

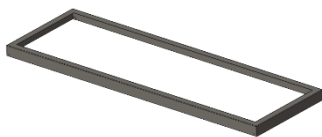

Burner Riser (P/N: 10298)



Burner Plate
(P/N: BP1242-CV, BP1264-CV)



CFP1242 Crystal Fire® Plus Burner Kit

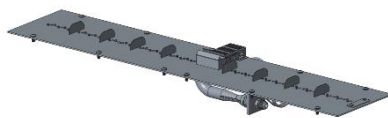

Burner Insert
(BI737, BI757)

Fire Glass Beads
(2 bags CFG-D, 3 bags CFG-D)

Assembly Instructions

1. Remove Cove Fire Pit Base from Packaging crate

- Four People are required to lift base out of packaging and place into final location.



2. Sparker Box Installation

- Remove sparker cap and hex nut. Insert AAA battery (not included) with + end out.
- Install sparker into control panel as shown below, secure using hex nut and replace sparker cap.
- Depress sparker button to ensure your sparker is working properly. You should hear the spark behind the sparker box.

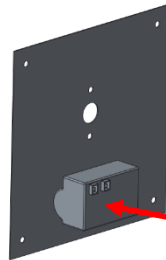
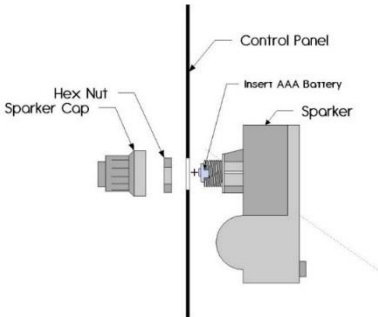

Locate and orient sparker box on control panel as shown. Sparker box must be installed **before** burner valve.

3. Gas Connections

Read and understand your Crystal Fire Burner Owner's manual before beginning burner hookups or using the device. Do not use Teflon tape or pipe dope on flare fittings.

- See Crystal Fire® Plus instructions for burner installation.
 - All gas connections were completed at the factory.
- Check all connections for leaks. If needed, tighten connection with 2 wrenches and re-check for leaks.
- Attach burner valve to control panel with provided screws as shown below. Ensure sparkler box is installed before this step.

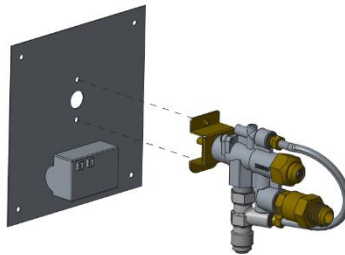

4. Thermocouple Installation

- Refer to Crystal Fire® Plus instruction manual for detailed attachment of thermocouple.
- Attach thermocouple to burner valve as shown below.

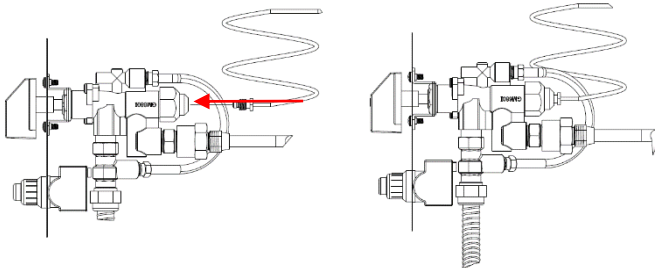

5. Connect Ground wire and Electrode wire from burner to sparker box.

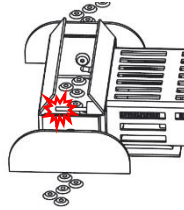
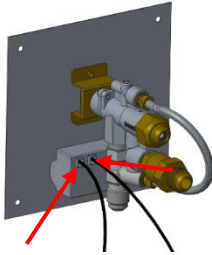

- Connect ignitor and ground wire to sparker box. Both wires can connect to either connection point. The unit will operate in either configuration.
- Test system by pushing the button on the igniter. Consult the troubleshooting section of the Crystal Fire® Plus Burner Owner's Manual, if the spark is weak, intermittent, or not present.

6. Drop burner into base.



CV-1242

- Place burner riser (P/N: 10298) into recessed opening in base.
- Place burner on top of riser.

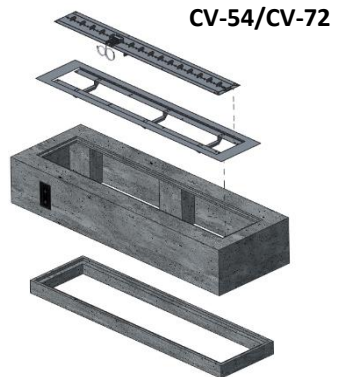

CV-54/CV-72

- Place Pedestal down first, followed by the base
- Place burner plate into recessed opening in base.
- Place burner on top of burner plate

7. Install Fire Media

- Scatter all included glass beads, lava rock, or other approved fire media evenly across entire burner surface.

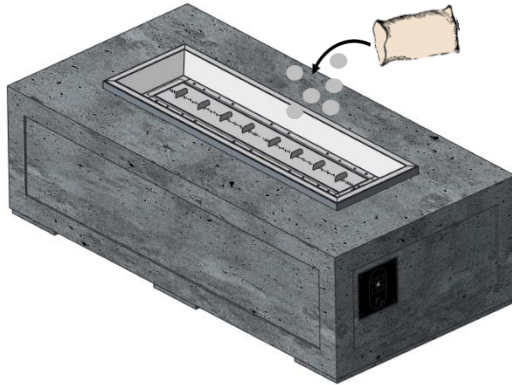

**DO NOT OPERATE CRYSTAL FIRE® PLUS BURNER
WITHOUT INCLUDED GLASS BEADS OR OTHER
APPROVED FIRE MEDIA**

IMPORTANT

Please consult your Crystal Fire® Plus instruction manual for detailed instructions and important information related to the burner installation including: lighting and operating instructions, safety information, and proper tightening of connections with two wrenches.

**DO NOT ATTEMPT TO INSTALL CRYSTAL FIRE® PLUS BURNERS
WITHOUT FIRST CONSULTING THE CRYSTAL FIRE® PLUS OWNER'S
MANUAL.**

WARNING

**After consulting the manual and following instructions, remember; before
operating, all gas connections must be fully checked for leaks**

Warranty: Fire pit tables are covered under a 1-year manufacturer's warranty. Please visit <https://www.outdoorrooms.com/product-registration> to register your product.

	<p>WARNING: This product can expose you to chemicals including Carbon Monoxide and Benzene which are known to the State of California to cause cancer or birth defects or reproductive harm. For more information, visit www.P65Warnings.ca.gov</p>
---	---

Thank you for purchasing an Outdoor GreatRoom Company product! This fire pit was made with pride in the USA.

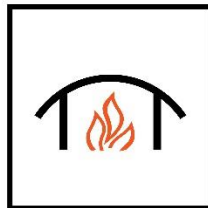

9583 217th St. W. • Lakeville, MN 55044
Toll Free: 1-866-303-4028 • Sales@OutdoorRooms.com