

fruitstar[®]

Fruit & Vegetable Juicer

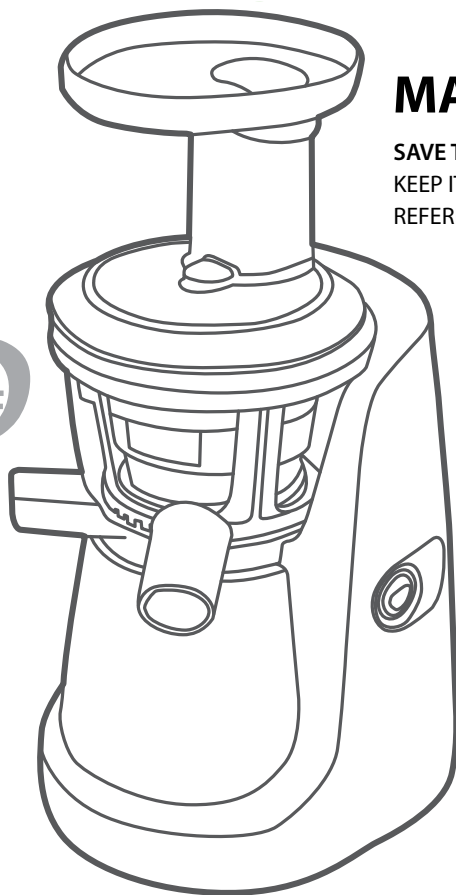

MANUAL

SAVE THIS MANUAL.
KEEP IT HANDY FOR QUICK
REFERENCE AND PROPER CARE.

CONTENTS

03	Read all instructions
04	Safety warning/precaution
06	Features
07	Parts
08	How to assemble
10	How to use
12	How to disassemble
13	How to clean and store
14	Tips for extracting
15	Tips for silicone parts
16	Recipes for Juice
18	Troubleshooting
19	Specifications
20	Registration Form
21	Warranty

IMPORTANT SAFEGUARDS



When using electrical appliances, basic safety precautions should always be followed including the following:

1. Read all instructions.
2. To protect against risk of electrical shock do not put Main Body of Fruitstar in water or other liquid.
3. Close supervision is necessary when any appliance is used by or near children.
4. Unplug the unit from outlet when not in use, before assembly or disassembly of parts, and before cleaning.
5. Avoid contact with moving parts.
6. Do not operate any appliance with a damaged power cord or plug. Do not operate if appliance malfunctions, or if unit is dropped or damaged in any manner. Contact the nearest authorized service facility for examination, repair, and/or electrical/mechanical adjustments.
7. Do not use parts not recommended or sold by the manufacturer with the Fruitstar, as it may cause fire, electric shock or injury.
8. Do not use outdoors.
9. Do not let power cord hang over the edge of a table or counter.
10. Do not let cord come in contact with hot surfaces, including the stove.
11. Always make sure that the Feeding Chute Assembly is locked in securely in place before turning on the machine. Do not unfasten the Feeding Chute Assembly while juicer is in operation.
12. Be sure to turn the switch OFF after each use. Make sure the motor stops completely before disassembling.
13. Do not put your fingers or other objects into the juicer openings while it is in operation. If food is lodged in the openings, use the plunger or another piece of fruit or vegetable to push it down. When this method is not possible, turn the juicer off and unplug, then disassemble juicer to remove the remaining food.
14. Do not use the appliance if the pulp wiping assembly is damaged.

SAVE THESE INSTRUCTIONS

SAFETY PRECAUTIONS

The following information is intended so as to prevent damage to the unit or injury to the user. Please read the following pages and use the appliance properly.

 **Warning:** This sign warns risk of death or severe injuries.

 **Caution:** This sign warns risk of injuries or product damage.

 Prohibited

 Must unplug electric cord

 Must take action

 Must follow instructions

 Do not disassemble



SAFETY WARNING

Do not plug multiple cords into a single outlet or a fire may result.

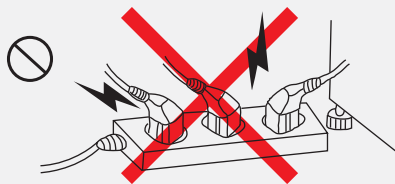

Do not plug in the cord with wet hands or you may incur an electrical shock.



Please unplug the cord when not in use.

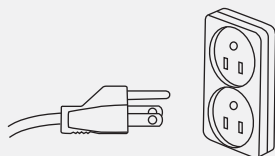

Use dry towel to clean.

*Otherwise, it may cause an electrical shock.

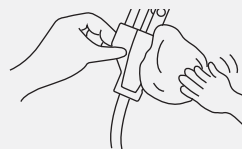

Do not drop the appliance or subject the appliance to any impact.

*Otherwise, the appliance may malfunction.



Please do not pull the cord to unplug the outlet.

*The cord may break, which may result in electrical shock or fire.

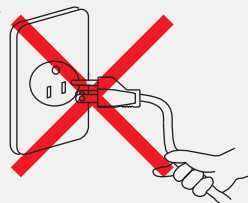

Please do not insert any silverware, other metals or fingers into the appliance while the cord is plugged in.

*Otherwise, an electrical shock may occur.





SAFETY PRECAUTION

Do not put the parts in a dishwasher or very hot water.

*Otherwise, parts will wear faster.



Do not use the appliance near any heat source.

*Otherwise, the appliance may change color.

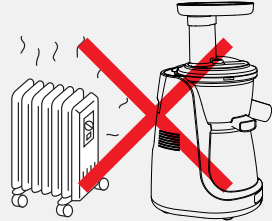

Do not repair, disassemble the Main Body, or customize the appliance.

*Otherwise, you may cause a fire or harm to yourself.



Do not use any cleaning chemicals to clean the appliance.

*Otherwise, it may change the color of the appliance or result in fire.



Do not use the appliance on an uneven surface.

*Otherwise, the appliance can fall or cause a malfunction.



Do not curve/twist the power cord or put pressure on the power cord.

*Otherwise, you may cause a fire or harm to yourself.

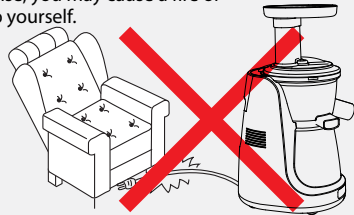

Do not keep or operate the appliance near infants or small children.

*Otherwise, it may injure them.



Do not spray water or flammable

*Otherwise, it may cause an explosion or electrical shock.

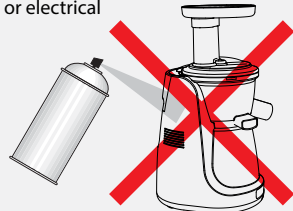

FEATURES

Slow juicing of approximately 80 RPM

Fruitstar extracts juice by a slow juicing mechanism to retain the maximum amount of nutrients and enzymes for a healthier, natural juice every time.

Excellently Juices Fruits and Also Vegetables Well

Excellently extracts all kinds of fruit juice and also juices vegetables well if the vegetables are properly prepared.

Easy to Assemble & Disassemble

The Auger Housing and the Main Body come apart easily for efficient cleaning and assembly.

Additional Safety Switch

All parts must be assembled properly and the Feeding Chute Assembly must be locked securely in place in order for the juicer to turn on. This assures a safe operation.

Convenient Hand Grip

Handgrip feature makes it easier to use and move around.

Powerful Motor with 240 Watts

The high-powered, low-speed motor is able to effectively process highly fibrous fruits and vegetables.

Quiet Operation- Approximately 55 dB

The motor is whisper quiet and extracts juice swiftly and effortlessly.

Easy to Clean

Simply pour water into the appliance after each use for self-cleaning. This will shorten cleaning time.

HD Ultem Vertical Auger & Juicing Screen

Stainless Steel Juicing Screen w/ HD Ultem Frame

Full 10-year Warranty

On/Off/ Reverse Switch

PARTS NAME

Feeding Chute Assembly

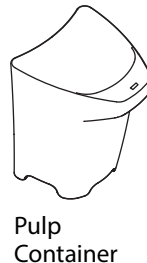
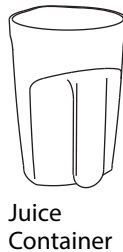
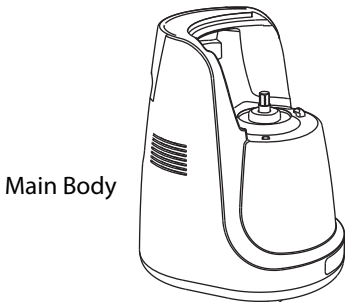
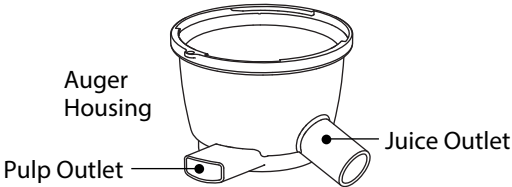
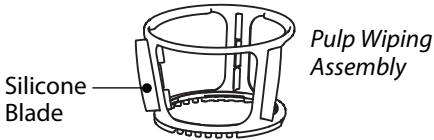
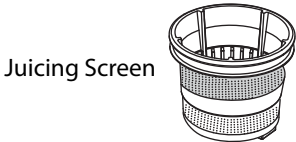
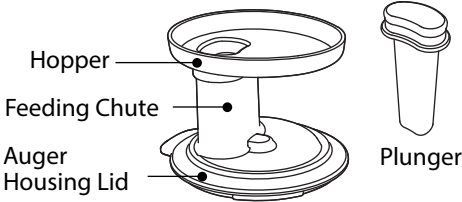

<Additional Safety Switch>

The Main Body and Auger Housing Lid must be assembled properly before the switch is turned on (otherwise the Fruitstar will not turn on).

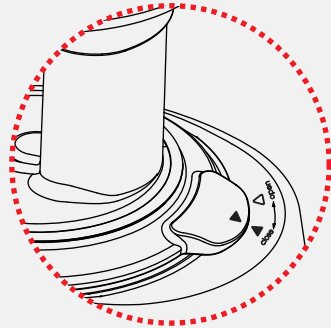

Power switch

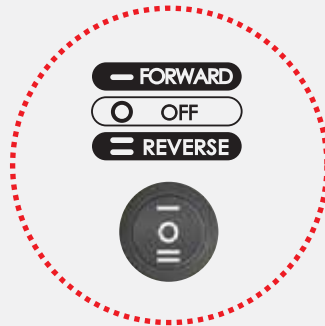

HOW TO ASSEMBLE

- 1** Place the Vertical Auger into the center of the Juicing Screen. Then place the Juicing Screen into the Pulp Wiping Assembly. Turn and push down the Juicing Screen while inserting it into the Pulp Wiping Assembly.

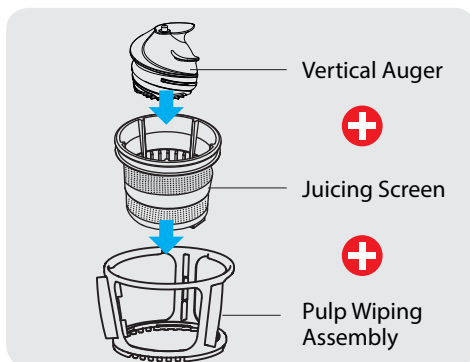
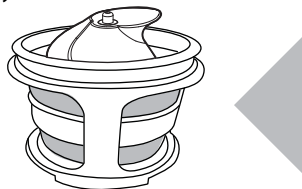

- 2** Insert (Vertical Auger + Juicing Screen + Pulp Wiping Assembly) into the Auger Housing.

Make sure the red dot on the Juicing Screen and the red dot on the Auger Housing are aligned.

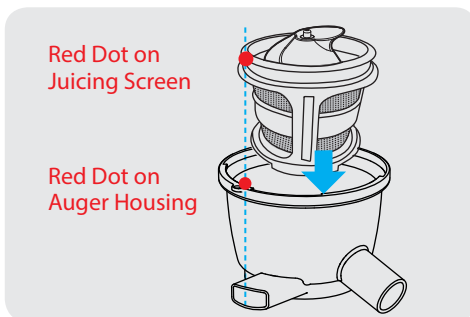

- 3** Connect the Feeding Chute Assembly to the Auger Housing. Align the mark of the "OPEN" position on the Auger Housing Lid to the red dot on the Auger housing.

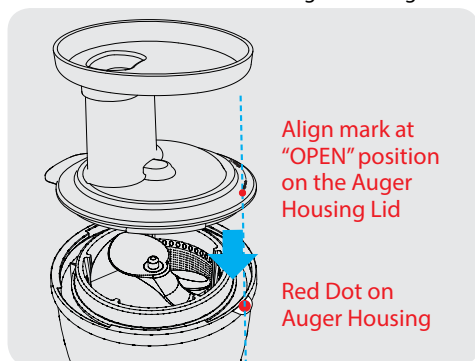

- 4** Turn the Feeding Chute Assembly clockwise until the mark of the "CLOSE" position aligns to the red dot on the Auger Housing.

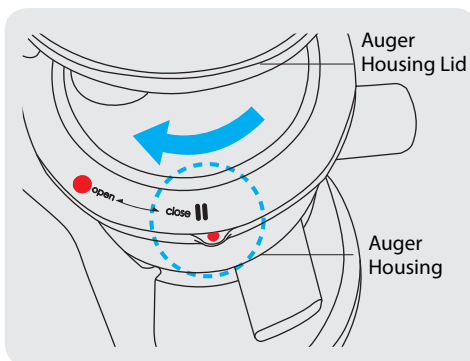

5

Assemble the entire juicing unit [Vertical Auger + Juicing Screen + Pulp Wiping Assembly + Auger housing +Feeding Chute Assembly] to the Main Body. Locate the small white arrow on the rear side of the Auger Housing Lid and set it to meet the arrow at "Open" position on the rear top of the Main Body.

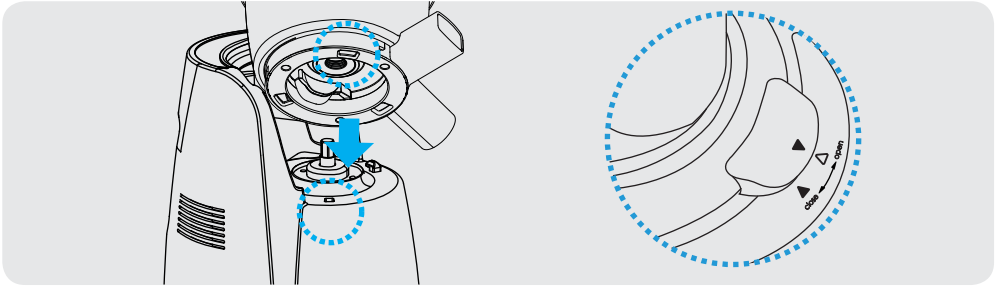

6

Turn the Auger Housing clock-wise until the arrow on the Auger Housing Lid aligns to the arrow at "Close" ▲ position of the Main Body. Make sure the aligning mark at "Close" position on the Auger Housing lid and the red dot on the Auger Housing are exactly aligned.

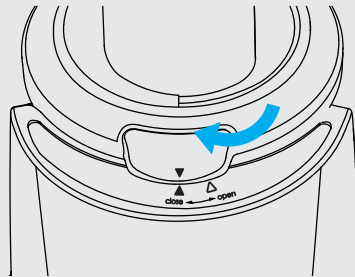

7

Properly place the Juice Container and Pulp Container at the base of the juice/pulp spouts.



HOW TO USE THE JUICER

- 1** Wash and clean the juicing foods, then cut them in the right size.
*Cut foods in a maximum length of 4-5 inches and width of 1 inch.

- 2** Check the power switch is at the OFF position. Then plug the cord into the outlet to turn it on

*Do not run the juicer without any juicing foods for more than 20 seconds. (It may cause a malfunction)

*Check if the Juice Pitcher and Pulp Collector are properly placed at the base of the spouts to prevent juice or pulp leakage.

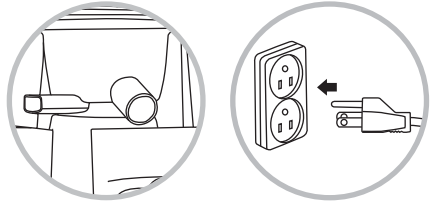

- 3** Push the switch to 'FORWARD' position to start operation. Push down the foods to extract juice. Do not operate with wet hands. (It may cause an electrical shock.)

*While in use, the appliance may make a noise. This does not constitute that the appliance has a problem with operation.

*Please insert the foods one by one, and when inserting a different food, wait until the appliance fully extracts the other food.

* Do not insert any utensils, knives, or fingers into the appliance. Please use the plunger to push down the food.

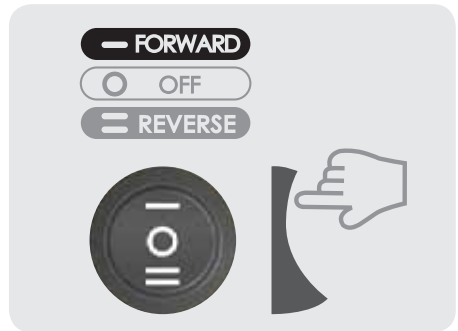

- 4** After juicing and self cleaning, turn off the machine. The Feeding Chute Assembly may not open well if the extraction is not finished. If this is the case, please see page 12 on "how to disassemble" Wash and clean the juicing foods, cut them in the right size.

If the Fruitstar suddenly stops during use

If the appliance stops in the middle of operation, please press the switch to 'OFF' position first, and then press the 'REVERSE' position and hold to push back the fruits or vegetables that might have gotten stuck between the Vertical Auger and the Auger Housing. Press the switch 'OFF' then to 'FORWARD'. (Repeat the procedures 3 times).



OFF



REVERSE



FORWARD

*While operating 'FORWARD' switch, please press 'OFF' switch and wait until the appliance stops completely before using the 'REVERSE' switch.

*If 'REVERSE' switch is pressed before the appliance stops completely, it may cause the appliance to malfunction.

*While operating in 'REVERSE' the Feeding Chute Assembly may be disassembled, so please hold onto the Feeding Chute Assembly with one hand when pressing the reverse switch.

*If the appliance still does not work, please disassemble the parts and clean the machine parts to use again.

HOW TO DISASSEMBLE

- 1** To disassemble the lid, turn the feeding chute assembly counter-clockwise.

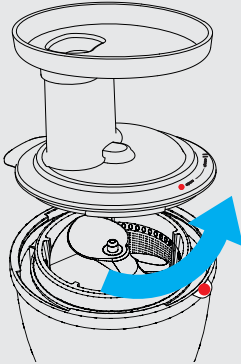

When feeding chute assembly does not open well, Do "Off" -> "Reverse" -> "Off" -> "Forward" and repeat steps over again for 1 minute to extract leftover fruit particles that might've been left inside of the juicing system.

- 2** Twist the Auger Housing by turning counter-clockwise like arrow 1 and lift it like arrow 2 to disassemble.

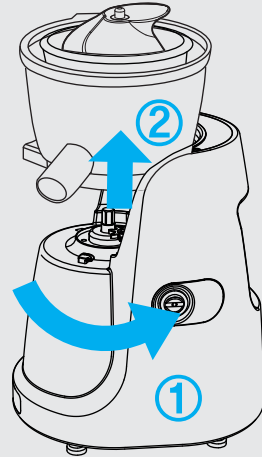

- 3** Vertical Auger, Juicing Screen and Pulp Wiping Assembly will be taken out together.

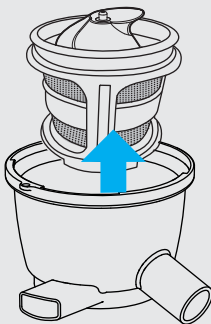

- 4** Disassemble Vertical Auger, Juicing Screen and Pulp Wiping Assembly.

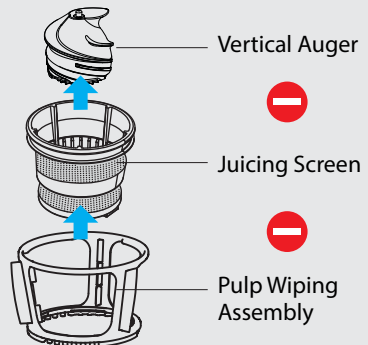

HOW TO CLEAN AND STORE

- 1** Before turn off the appliance, remove the fibers in the Auger Housing simply by pouring 1 or 2 cups of water into the Feeding Chute after each use (self-cleaning).

- 2** Turn the switch to "Off" and then unplug the cord.

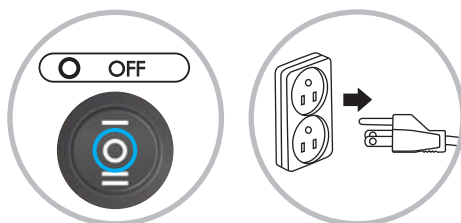

- 3** Reverse the assembly instructions to disassemble the parts, then use running water to wash the disassembled parts with the cleaning brush.

*see page 12 on "how to disassemble"

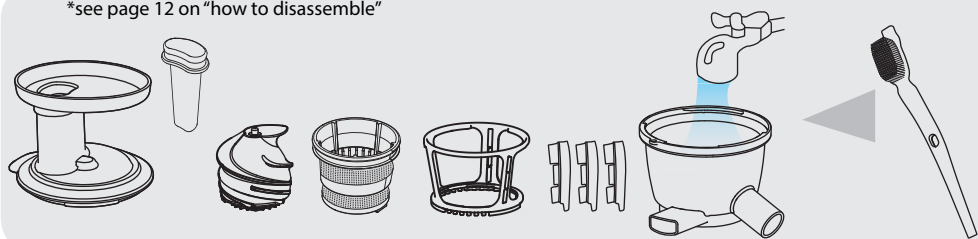

- 4** Clean the Main Body with a damp, soft towel.



TIP

If the appliance does not get cleaned properly after each usage, it will be much difficult to clean later. Neglecting to properly clean the machine may possibly result in a gradual decline in prime performance of the appliance.

The color of vegetables such as carrots and spinach may affect the color of the juicing parts. Wash it out with cooking oil first and then use soap and warm water.

Disassemble the silicone blades from Pulp Wiping Assembly and wash them. *See the page 15.

TIPS FOR EXTRACTING

Please read before juice extraction.

1. Feed the foods into the Feeding Chute piece by piece in order to properly extract juice without clogging.
2. Please cut stringy fibrous foods (celery or kale) into 4-5 inch pieces to get optimal results. For even better results, cut the foods to a width of 1 inch and insert the pieces one by one.
3. When extracting carrot juice, please cut carrots into halves or quarters in length way before feeding them into the feeding chute. (Different foods have different amounts of juice to extract.)
4. While in use, the appliance may make a noise. This does not constitute that the appliance has a problem with operation.
5. You must remove seeds from foods such as peaches and plums.
6. Fully defrost frozen fruits when you make frozen fruit sorbet. Feeding hard frozen fruit may damage the juicing system.
7. Do not overfeed to avoid clogging the machine.
8. Some portion of grounded fruit or vegetable may splash out occasionally if the plunger is not in use.

TIPS FOR SILICONE PARTS

TIP

Silicone parts are able to be disassembled and washed. Fully dry the silicone parts after washing. Please check if the silicone parts are placed correctly.

*Juice may leak if you do not assemble the silicone parts properly.

<Silicone Wiper Blade>

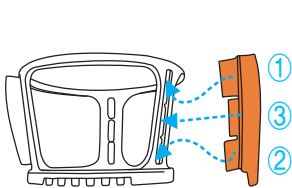

1. Disassemble

Hold the Tail portion (2 in the drawing) of the silicone blade and push upward to the middle of the blade slot, then pull outward.

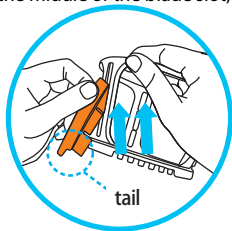

Hold the Head portion (1 in the drawing) of the silicone blade and slide downward to the middle of the blade slot, then pull outward.

2. Assemble

Insert the Head portion into the blade slot in the middle of the bracket, slide the Head upward. Insert the Tail portion into the blade slot in the middle of the bracket, slide the Tail downward.

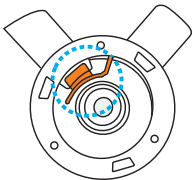

<Pressure Plug of Auger Housing>

After washing, put the Pressure Plug in correctly as shown in the picture.

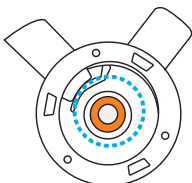

<Sealing Ring of the Auger Housing>

Sealing Ring can be easily disassembled by pushing from the bottom side of the Auger Housing (smaller silicone ring) for easy cleaning. After it is thoroughly dried, put the sealing ring properly back in its place. Push the sealing ring (with the larger side facing up) back in place from the inside of the Auger Housing.

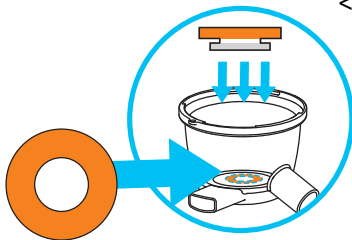

RECIPES FOR JUICE



- Based on the food's freshness and amount of moisture, juice extraction results may vary.

Tomato Juice

Tomato Juice is a refreshing and nutritious juice that is typically consumed all-year round. Lycopene is a red pigment antioxidant that causes the inhibition of cell aging and also the sour taste will boost up the citric acid which is best for morning juice. There are different tomatoes such as yellow tomatoes or green tomatoes.

1. If juicing organic tomatoes, just rinse them with running water.

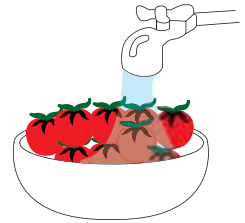

2. Feed the tomatoes into the appliance after they are sliced into quarters.

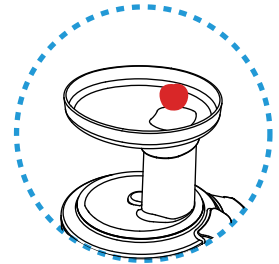

Well-being prescription

The juice is enriched with vitamin A and C which effectively prevents cancer, stroke, and heart disease. The tomato acid is great for recovering fatigue and also for relieving queasiness.

TIP Appropriateness of fruits temperature.

Apple 41 F

Orange 33.8-41 F

Tomato 53.6-55.4 F

Carrots 33.8-41 F

Grape 39.2-41 F

Peach 46.4-55.4 F

Carrot Juice

Carrot is one of the best vegetables for high nutrition and has a great taste which makes it a favorable juice to many people. Carrots have a special sweet taste which can cover the bitter taste of different vegetables when they are mixed. Carrots contain high pro-vitamin A and carotene. Consuming 2 carrots has enough of 4 times of RDA for Vitamin A.

1. Non-chemically treated carrots may be cleaned simply with running water, but chemically treated carrots should be cleaned well using food safe soap.

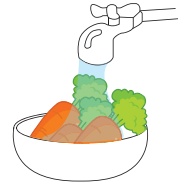

2. Please cut the carrot into the right size to insert.

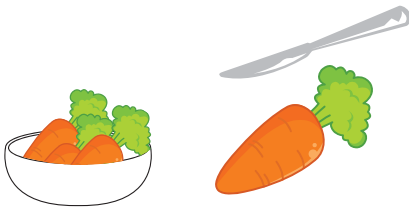

3. Insert the prepared carrots into the appliance and reinsert the extracted carrot juice into the appliance to decrease the amount of residue in the appliance. This also make the juice clearer and fresher.

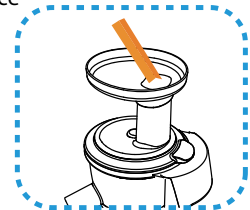

Well-being prescription

Carrot juice has a high vitamin-A content which prevents skin aging and also makes eyesight better as well as immunity. Carrot juice contains high dietary fiber which is great for diet. One carrot juice per day can normalize the body as well as decrease the chance of getting lung cancer.

TROUBLESHOOTING

Status	Check list
Motor stops during use.	<ul style="list-style-type: none">- Check if the power cord is plugged in properly- Check if all parts are assembled correctly- It may not work if lots of juicing materials are inserted at the same time.- When appliance stops in the middle of operation then turn the switch to "OFF" and press "REVERSE" switch to unclog the materials in the Vertical Auger. Then press the "FORWARD" switch to push the materials down. (Repeat this step 3 times)- Turn the switch to "OFF" and place the Main Body in a cool area. Let appliance rest for an hour to cool the motor down and work again.- Remove all the hard seeds in the juicing materials before juicing. Hard seeds may break down the juicing screen.
Amount of juice is too little.	<ul style="list-style-type: none">- Each foods have different amounts of juice depending on how fresh they are.- To extract more juice out of the refrigerated materials, soak foods in clean water before juicing.- Check if the Pressure Plug is assembled properly.
Juice Container is shaking in the middle of operation.	<ul style="list-style-type: none">- It is completely normal if the juice container is shaking a little bit during operation.
Seems like Vertical Auger is grinding.	<ul style="list-style-type: none">- Vertical Auger and Juicing Screen are stick together, so do not operate for a long time without feeding any foods.
Hearing a lot of sounds coming from the machine.	<ul style="list-style-type: none">- Turn the switch to "OFF" then check if the parts are assembled properly- Check if the appliance is operating on an uneven surface.- There may be squeaky friction noise while in use. This is a normal sound that occurs, and user should not worry about it.- Check if juicing materials are cut in the right sizes.

Status	Check list
Juice is spilled out on the appliance body.	<ul style="list-style-type: none"> - It may happen if the Pressure Plug is not assembled properly. Please check if pressure plug is assembled properly.
After extraction, the color of the Juicing parts and Juice Container are changed.	<ul style="list-style-type: none"> - After use, if the appliance does not get cleaned, then it is much difficult to clean and may even result in performance resistance. - The color of Beta-Carotene which is in Carrots and spinach may affect the color of the juicer parts. Wash it out with cooking oil first and then use soap and warm water. - Disassemble Silicone Wiping Blades and wash them separately.



Place
Stamp
Here

Fruitstar Juicer Registration

Tribest Corp.
 P.O. Box 4089
 Cerritos, CA 90703
 U.S.A.

SPECIFICATIONS

Product	Juicer
Model No.	FS-610
Electricity	120V, 60Hz
Power consumption	240W
Maximum use	Less than 30 min
Weight	7kg
Dimension	184mmX245mmX414mm
Manufacture	Tribest Corporation
Compress type.	Low speed compression



Fruitstar Registration Form

Please fill out and return within 10 days to register your product. Registration ensures that you receive timely service should any warranty service be needed for your machine.

1. Users Information

Mr. [] Mrs. [] Ms. [] Miss []
First Name: _____ Last Name: _____
Address: _____
City: _____ State: _____ Zip: _____
Telephone: (____) _____ - _____
E-mail: _____

2. Dealer Information

Dealer Name: _____
Address: _____
City: _____ State: _____ Zip: _____

3. Product Information

Model Number: FS-610
Serial Number: _____
Date of Purchase: _____ / _____ / _____
Month Date Year

WARRANTY

(Please read carefully)

We warrant to you, the end-user customer who has properly registered after purchasing the Fruitstar Juice Extractor (hereinafter referred to as "Fruitstar") for a valuable consideration, that the Fruitstar will be free from defects in materials and workmanship for a period of 10 years from the date of purchase. Some parts of Fruitstar are considered to be consumable, and therefore not subject to normal warranty. These parts include but are not limited to the Juice Container, Pulp Container, Cleaning Brush, Wiper Blade, Pressure Plug, Sealing Ring and Plunger.

In order for you to receive the benefits of this warranty, you are required to register for warranty service by completing and mailing the warranty registration card to us within ten (10) days following the purchase of your Fruitstar.

1. No warranty will be provided until after we have actually received the proper registration, with all of the requested information, within ten (10) days of the date of the original purchase. The warranty is only good for the original purchaser for value. This warranty is non-transferable.
2. If the Fruitstar exhibits defects while in normal household use, we will, upon our actual receipt of a written notice of such defects from you during the warranty period, either repair or replace, at our option, the Fruitstar that has verifiable manufacturing defects. However, we have no such obligation to repair or replace the machine until after you have, by insured mail and in properly protective packaging*, delivered the Fruitstar to the location of your service center. Replacement Fruitstar may be either new or like new. Repaired Fruitstar may contain re-manufactured or re-conditioned parts, which are equivalent to new in performance or may have been subject to incidental use.
3. We do not warrant that the operation of the Fruitstar will be uninterrupted or error-free. In no event shall our liability exceed the retail value of the Fruitstar.
4. All warranty and repair services must be performed at a warranty service center that is located in the country where the Fruitstar was originally purchased. However, in the event that: [I] the machine must be serviced at a service center that is not located within the country where the machine was purchased; or [II] there is no service center within the country where the machine is located and must be shipped to a service center in another country, then those service centers are responsible for the parts and service only, and any and all costs relating to the shipping, delivery and handling of the machine to and from those service centers shall be the sole responsibility of the Fruitstar owner.
5. This Warranty does not cover;
 - (1) damages resulting from: (a) failure to operate the Fruitstar in accordance with the instructions (b) use of parts or supplies not provided or authorized by the manufacturer (c) negligent, improper or inadequate maintenance (d) service performed or attempted by unauthorized service person (e) damages, accidental or otherwise to the Fruitstar, which are not directly caused by the manufacturer (f) damages resulting from abuse, tampering, misuse, commercial use, or unauthorized modification of the Fruitstar.
 - (2) damages caused by improper electrical connections.
 - (3) consumable parts including but are not limited to the Juice Container, Pulp Container, Cleaning Brush, Wiper Blade, Pressure Plug, Sealing Ring and Plunger.
 - (4) ordinary ware and tear.

WARRANTY

(Please read carefully)

WE MAKE NO OTHER EXPRESS OR IMPLIED WARRANTY OR CONDITION WHETHER WRITTEN OR ORAL. TO THE EXTENT ALLOWED BY LOCAL LAW, ANY IMPLIED WARRANTY OF FITNESS FOR A PARTICULAR PURPOSE OR IMPLIED WARRANTY OR CONDITION OF MERCHANTABILITY IS LIMITED TO ONE (1) YEAR. In the event that such limitation or exclusion on the duration of an implied warranty is not allowed in the state or county wherein you reside, the above limitation or exclusion may not apply. This warranty gives you specific legal rights and protection, and you may also have other rights that vary from state to state, or county to county.

TO THE EXTENT ALLOWED BY LOCAL LAW, THE REMEDIES IN THIS WARRANTY STATEMENT ARE YOUR SOLE AND EXCLUSIVE REMEDIES. EXCEPT AS INDICATED ABOVE, IN NO EVENT WILL WE BE LIABLE FOR DIRECT, SPECIAL, INCIDENTAL, CONSEQUENTIAL (INCLUDING LOST PROFIT), OR OTHER DAMAGE, WHETHER BASED IN CONTRACT, TORT, OR OTHERWISE. Some states or counties may not allow the exclusion or limitation of incidental or consequential damages. If you reside in such a state or county, the above limitation or exclusion may not be applicable.

Do not send your Fruitstar back to the warranty service center without return authorization. For a return authorization number (RMA No.), please contact us via email at service@tribest.com or call 888-254-7336 in the USA or 714-879-7150 from overseas countries.

*Save Original Shipping Box

When You Need Service

In the unlikely event that you need service on your Fruitstar, or if it fails to function properly while within the warranty period during normal household operation, contact the Fruitstar Warranty Service Center. For all service inquiries, please first contact the Fruitstar Warranty Service Center for a return merchandise authorization (RMA) number and proper routing instructions.

Fruitstar Warranty Service Center
Tribest Corporation
1143 N. Patt St.
Anaheim, CA 92801
TEL: 888-254-7336, FAX: 714-879-7140

If you need service:

- Call the Fruitstar Warranty Service Center (888-254-7336) to get a Return Merchandise Authorization (RMA) number to send your Fruitstar to the service center. Returns will NOT be accepted without an RMA number clearly written on the box.
- Pack your Fruitstar securely in the original shipping box. Make sure all affected parts are enclosed.
- Fill out the service request form below, detach it and enclose it in the shipping box.
- Seal the shipping box securely with packing tape.
- Address the box to the Fruitstar Warranty Service Center. Be sure to put your return address on the outside of the package.
- It is always wise to insure the package against possible damages or loss in transit. Ship prepaid.

✂
.....
Detach form on dotted line

SERVICE REQUEST FORM

First Name: _____ Last Name: _____

Address: _____

City: _____ State: _____ Zip: _____

Telephone: (_____) _____ - _____

Serial #: _____

Date of Purchase: _____ Model #: _____

Name of parcel/post carrier (in case of damage during delivery): _____

Reason for service request (use additional paper if more space is needed): _____

MEMO



fruitstar[®]
Fruit & Vegetable Juicer



TRIBEST[®]
making healthy living easy