

TWISTIICLEAN

Installation Instructions for: 3/4-inch Model T2C-075
1-inch Model T2C-100
1 1/2-inch Model T2C-150

Installation and Operation Guide

Pre-Installation Checklist

- A. Select a good filter location:
- Install on the pressure (outlet) side of any pumps and pressure tanks
 - In a vertical position with Purge Exit pointing down
 - Away from extreme weather conditions to protect from freezing
 - At least 12 inches away from walls or obstructions, so top handle can be twisted
 - Allow enough clearance beneath the unit to:
 - (a) attach a purge drain hose to the Purge Exit (recommended)
 - (b) remove the clear bowl assembly, to allow replacement of element as needed
- B. As a sunny outdoor installation might lead to algae growth inside the clear bowl and affect the operation of your TWISTIICLEAN, an optional Sun Shield is available.

Maximum Flow Ranges:

- T2C-075 3/4" Inlet/Outlet: 0 to 25 US gpm (0 to 5.7 m³/hr)
- T2C-100 1" Inlet/Outlet: 0 to 39 US gpm (0 to 8.9 m³/hr)
- T2C-150 1 1/2" Inlet/Outlet: 0 to 78 US gpm (0 to 17.7 m³/hr)

Maximum Pressure:

- 100 psi at 73°F (6.9 bar at 38°C)

Temperature Range:

- 32°F - 120°F (0°C - 49°C)

Mesh Sizes:

- 30 Mesh (600 Micron) Element (Brown)
- 60 Mesh (250 Micron) Element (White)
- 100 Mesh (150 Micron) Element (Gray)
- 140 Mesh (105 Micron) Element (Black)
- 200 Mesh (74 Micron) Element (Blue)

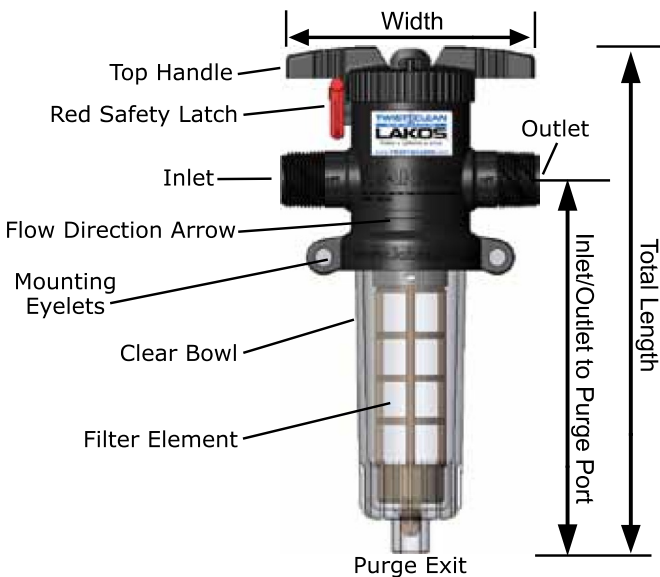

Dimensions

Model	Inlet/Outlet	Purge	Total Length	Length (Inlet/Outlet to Purge Port)	Width (inlet/outlet)
T2C-075	3/4" MPT	1/2" MPT	11 3/4"	8 3/4"	6"
T2C-100	1" MPT	1/2" MPT	11 3/4"	8 3/4"	6"
T2C-150	1 1/2" MPT	3/4" MPT	15 1/4"	11 3/4"	7 1/2"

Installation In 7 Easy Steps

1. Remove the TWISTIICLEAN from its box. Check to make sure the box also contains a small dispenser of Teflon tape and two slip/threaded adapters for use if needed.
2. Be sure the clear bowl is securely tightened (hand tighten only). The unit is shipped with the bowl loose. Lift the red safety latch and rotate the top handle a few times to make sure it will rotate 1/4 clockwise turn.
3. Prepare the piping manifold to install TWISTIICLEAN. Select the best fittings for your installation, using slip or threaded fittings as desired. Notice the direction of water flow through the unit -- a flow direction arrow is molded into the side of the unit. (Fig A).
4. Use proper PVC solvents and follow gluing instructions on solvent container. Do not spill solvent on any part of the TWISTIICLEAN unit.
5. Mounting eyelets provide for a more stable installation (Fig B). Stabilizer bolts are recommended for long term stability of your TWISTIICLEAN. Use 3/8" Hex Lag Screws plus washers and PVC pipe to connect to a secure surface. These parts are NOT supplied with your TWISTIICLEAN.
6. Once installed, test by turning water supply on slowly, allowing water to feed through the unit. Check for leaks. After lifting the safety latch, twist the top handle with a 1/4 clockwise turn to re-direct the flow for cleaning. This should lift the screen element inside the bowl and release flush water through the Purge Exit at the bottom of the unit. Twist the handle back to its "run" position, lower the safety latch and check for leaks.
7. Attach a flush drain hose (if necessary) to direct the purged particle matter and excess water to a drain or other desired area for discharge (Fig C).

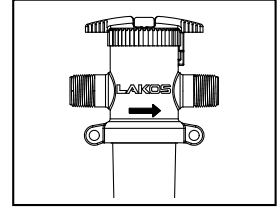

Fig A

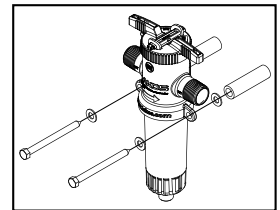

Fig B

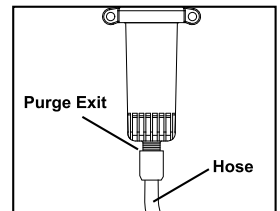

Fig C



SUN SHIELD

Optional Accessories

Sun Shield For Outdoor Installations

Black neoprene woven cover, slips over bowl to prevent growth of algae and other organics.

Model Size	Sun Shield Part Number
T2C-075 (3/4")	131355
T2C-100 (1")	
T2C-150 (1-1/2")	132240

Using Your TWISTIICLEAN

TWISTIICLEAN removes sand and organics as the water passes through the filter element. Periodic cleaning is necessary to optimize filter performance, reduce the

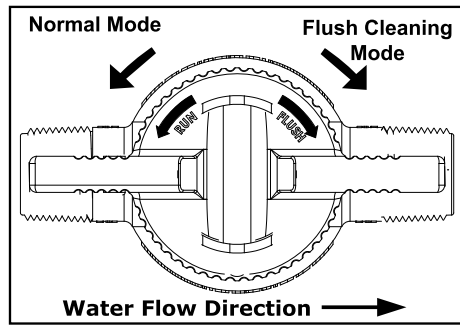

pressure loss and prolong the product life. When the filter element looks like it is filled with debris, it should be cleaned.

Just a gentle 1/4 clockwise TWIST of the top handle begins

the patented reverse flushing action. In just a few seconds, all debris are backwashed off the filter element and flushed out the bottom of the Purge Exit port. **BE SURE TO RAISE THE SAFETY LATCH BEFORE TWISTING THE HANDLE AND LOWER IT AFTER FLUSHING.**



For proper purging of your TWISTIICLEAN, lift the red safety latch prior to twisting the handle.

Maintenance and Troubleshooting

If for any reason the filter element does not clean completely during the normal Twist to Clean operation, manual cleaning may be needed. In this case, remove the bowl and clean the element with a soft nylon brush, brushing and running water across element.

Caution: If the filter bowl is to be removed, all water flow must be shut off going to the filter.

Safety Notes:

Despite the ease of installation and operation of the LAKOS TWISTIICLEAN product, certain precautions should be taken.

1. Lubricate "O" rings with NSF approved silicon grease only - Dow 111 is recommended.
2. Do not overtighten the threaded connections. Do not tighten more than a 1/4 turn past finger tight. Hand tighten the bowl, do not use tools.
3. Do not use wrenches on plastic filter parts. Use of tools on filter will void warranty.
4. For threaded connections, use the PTFE sealant tape provided with product.
5. Filter components that have "O" rings do not require thread sealant.
6. Remove clear bowl if the filter is to be installed using any solvent welding. This will prevent solvent damage to the clear bowl.
7. This filter is designed for use with water only. Other chemicals or components can damage the filter components. Evaluate all chemicals for proper usage with the filter.
8. Protect unit from freezing, as you would with any other water supply lines.
9. Follow all local and state codes, laws, and regulations when installing any filter.
10. If removal of the screen element is necessary, take care not to damage the element or the components that hold the element in place. The T2C-150 model has latching clips that hold the element in place. Do not spread the clips more than necessary to remove the element.

T2C-075 T2C-100

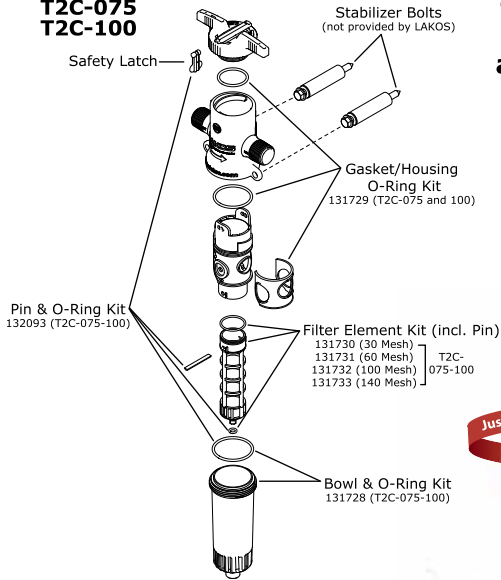

TWISTIICLEAN Exploded View and Spare Parts

T2C-150

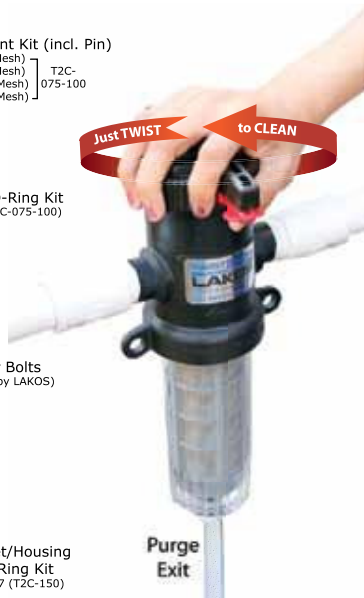
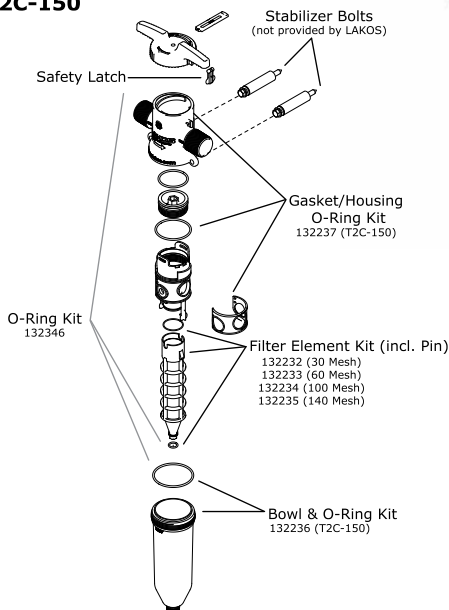

Limited Warranty

The LAKOS TWISTIICLEAN is warranted to be free of material or workmanship defects for at least one year from delivery date.

If a fault develops, notify us, giving a complete description of the alleged malfunction. Include the model number(s), date of delivery and operating conditions of subject product(s). We will subsequently review this information and, at our option, supply you with either servicing data or shipping instruction and returned materials authorization. Upon prepaid receipt of subject product(s) at the instructed destination, we will then either repair or replace such product(s), at our option, and if determined to be a warranted defect, we will perform any products, damages or injuries resulting from misuse, neglect, normal expected wear, chemically-caused corrosion, improper installation or operation contrary to factory recommendation. Nor does it cover equipment that has been modified, tampered with or altered without authorization. No other extended liabilities are stated or implied and this warranty in no event covers incidental or consequential damages, injuries or costs resulting from any such defective product(s).

TWISTIICLEAN
INLINE WATER FILTERS
LAKOS
www.TWISTIICLEAN.com