



MuscleSquad Phase 2 Freestanding Rack

Assembly & User Manual



Important – Please read these instructions fully before assembly and use.

These Instructions contain important information for assembly, safe use, and maintenance.

Contents

Safety Information	3-4
Opening Carton	5
Hardware Pack	6
Assembly	7-10
Exploded Parts List	11
Parts	12
Exercise Information	13-16
Care & Maintenance	17
Guarantee	17

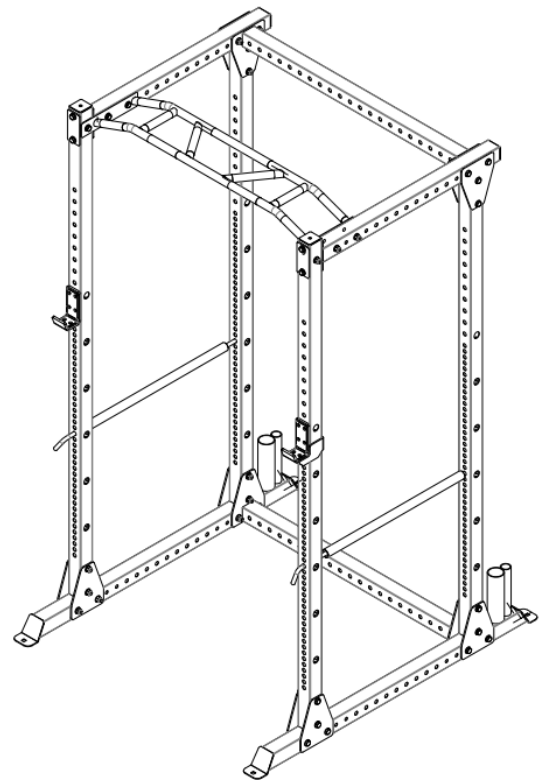

Safety Information

Note the following safety precautions:

Assembly

- Check you have all the components and tools.
- Remove all fittings from the plastic bags and separate them into their groups.
- Keep children and animals away from the work area, small parts can cause choking if swallowed.
- Make sure you have enough space to layout the parts before starting.
- The assembly of this equipment is best carried out by 2 people.
- Assemble the item as close to its final position (in the same room) as possible.
- Position the equipment on a clear, level surface.
- Dispose of all packaging carefully and responsibly.

Using

- Do not use the equipment near water or outdoors.
- Always keep children and pets away from the equipment. Do not leave children unattended in the same room with the equipment.
- Before using the equipment to exercise, always warm up with stretching exercise.
- This product is intended for domestic use only.
- If the user experiences dizziness, nausea, chest pain or any other abnormal symptoms STOP the workout at once.

****CONSULT A DOCTOR IMMEDIATELY****

- Only one person at a time should use the equipment.
- Keep hands away from all moving parts.
- Always wear appropriate workout clothing when exercising. Do not wear loose flowing clothing that could become caught in the equipment. Running or aerobic shoes are also required when using the equipment.

- Use the equipment only for the intended use, as described in this manual. Do not use attachments not recommended by the manufacturer.
- Do not place any sharp objects on or near the equipment.
- Disabled persons should not use the equipment without a qualified person or doctor in attendance.
- Never operate or use the equipment if it is damaged or not functioning properly.
- Examine the equipment frequently especially the easily damaged parts. The safety level of the equipment can only be maintained if it is examined regularly. Replace any defective components immediately. Do not use the equipment until it has been repaired.
- Parents and others responsible for children must be aware that playing on the equipment could be dangerous and lead to possible injury. Children must not be left unattended with the equipment.
- A spotter is recommended during exercise.
- This product is suitable for a maximum user weight of: 136kgs.
- Maximum capacity on bar: 100kgs (Including bar and weights)
- Your product is intended for use in clean dry conditions. You should avoid storing it in excessively cold or damp places as this may lead to corrosion and other related problems that are outside our control.
- This product conforms to: (BS EN ISO 20957) - PARTS 1.2.4 class (H) - Home Use - Class (C). This product is not suitable for therapeutic purposes.
- This exercise product has been designed and manufactured to comply with the latest (BS EN ISO 20957) British and European Safety Standard.

Safety Information – Training Area

Free area should be not less than 0.6m greater than the training area in the directions from which the equipment is accessed. The free area must also include the area for emergency dismount. Where equipment is positioned adjacent to each other the value of the free area may be shared. Keep unsupervised children away from the equipment.

Only one person should be within the training area when the equipment is in use.

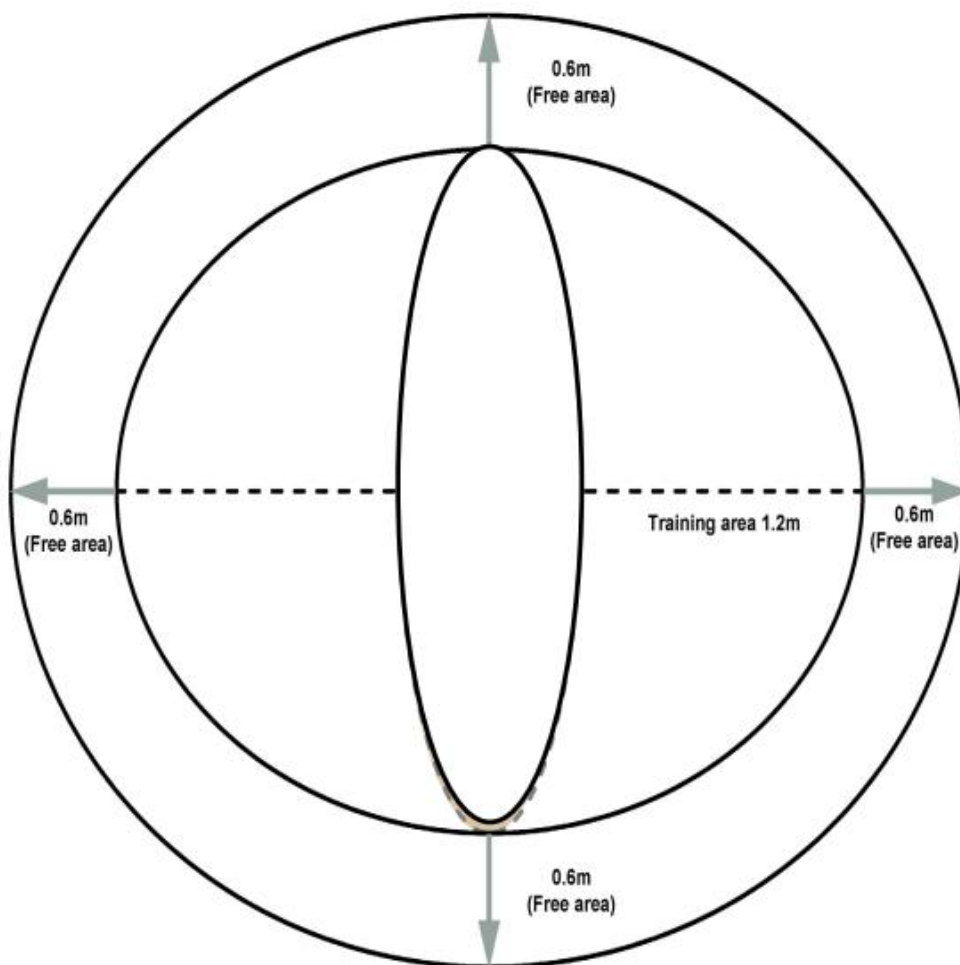

Opening the Carton

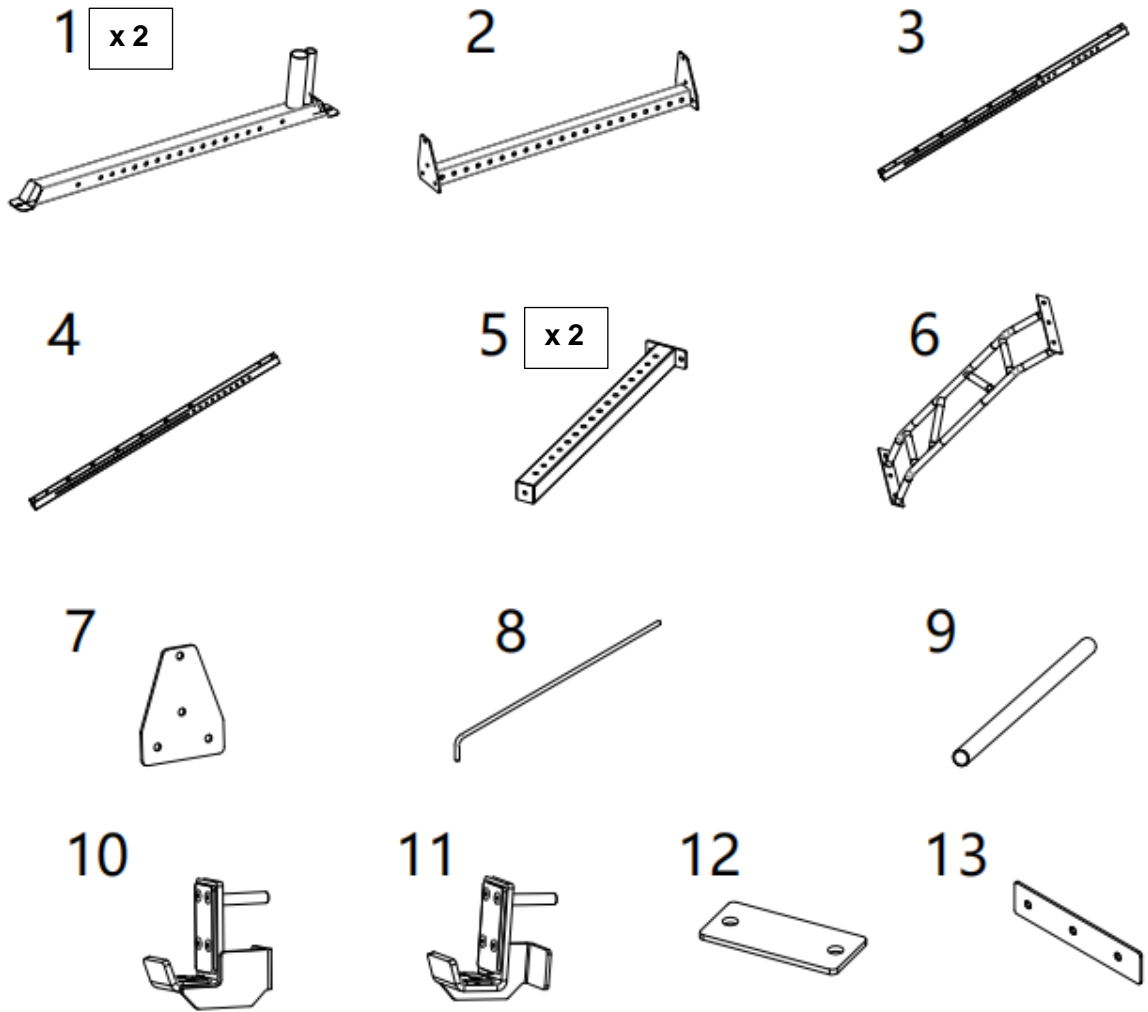

Hardware Pack1-4

Hardware Pack2-4

Hardware Pack3-4

Hardware Pack4-4

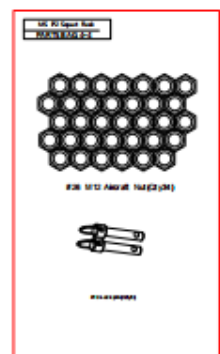
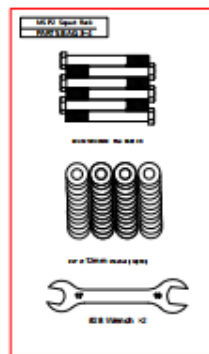
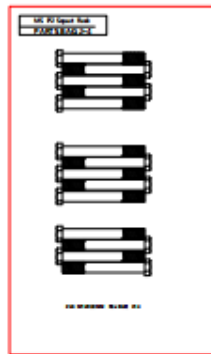
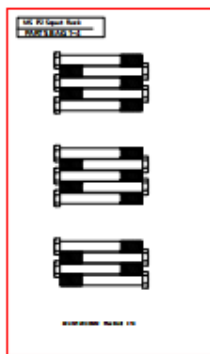

Hardware Pack

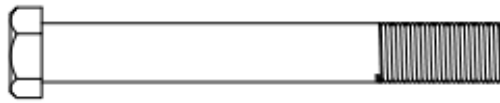

#14 M12X90MM Hex Bolt x34



#15 M12 Aircraft Nut x34



#16 Ø12mm Washer x68

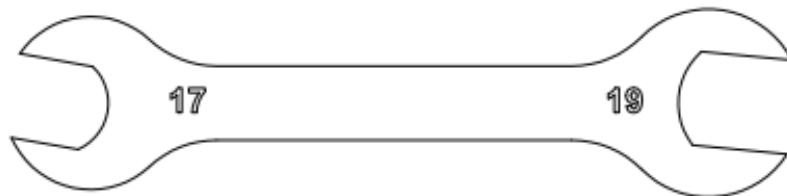

#17 Wrench x2

#18 Lock Pin

Assembly Instructions

Step 1

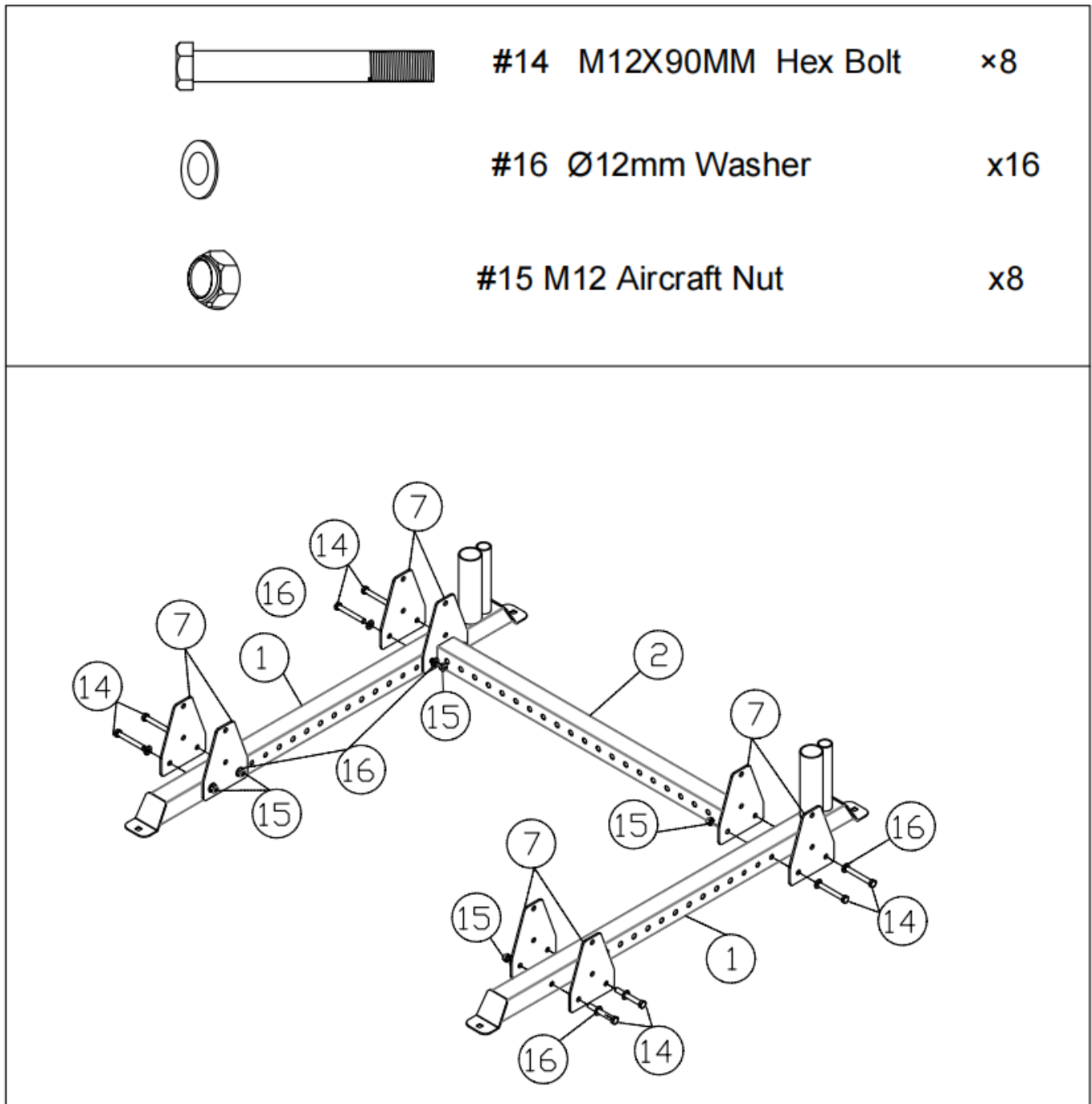

A. Place the base Cross Beam (#2) into the center of the two Base Stabilizers (#1) , Align the rear side holes and secure each of them with one Triangle Bracket (#7), two M12x90mm Hex Bolts (#14), four Ø12mm Washers (#16) and two M12 Aircraft Nuts (#15)

B. Place a Triangle Brackets (#7) to either side of the two Base Stabilizers (#1), Align two front side holes, secure each of them with two M12x90mm Hex Bolts (#14), four Ø12mm Washers (#16) and two M12 Aircraft Nuts (#15)

Assembly Instructions

Step 2

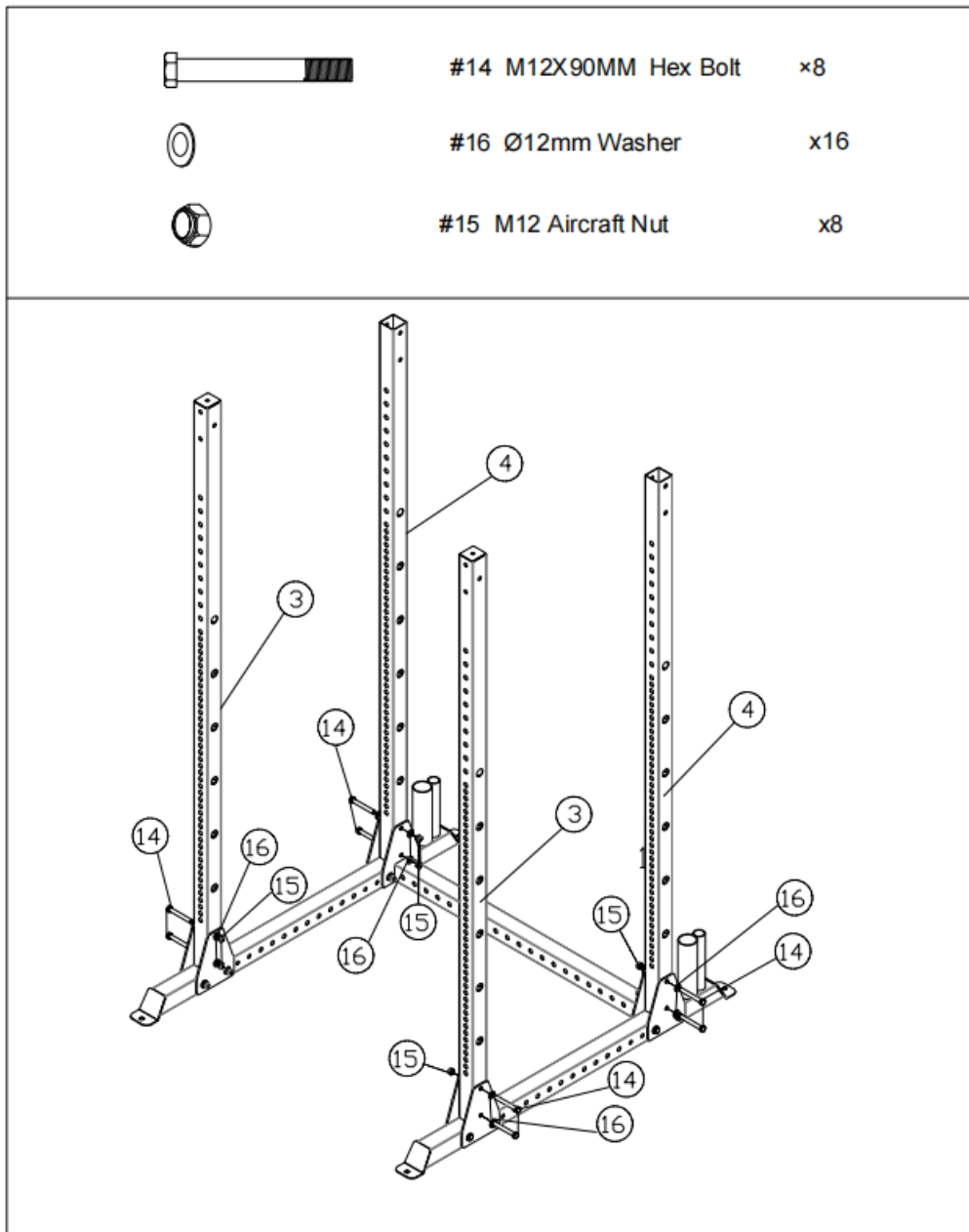

- A. Place the two Rear Upright Supports (#4) to the rear side of the two Base Stabilizers (#1) and secure the bottom side into the two Triangle Brackets (#7), Align the holes and secure each of them with two M12x90mm Hex Bolts (#14), four Ø12mm Washers (#16) and two M12 Aircraft Nuts (#15)
- B. Repeat Process A to install two Front Upright Support (#3) to the front side of the two Base Stabilizers (#1).

Assembly Instructions

Step 3

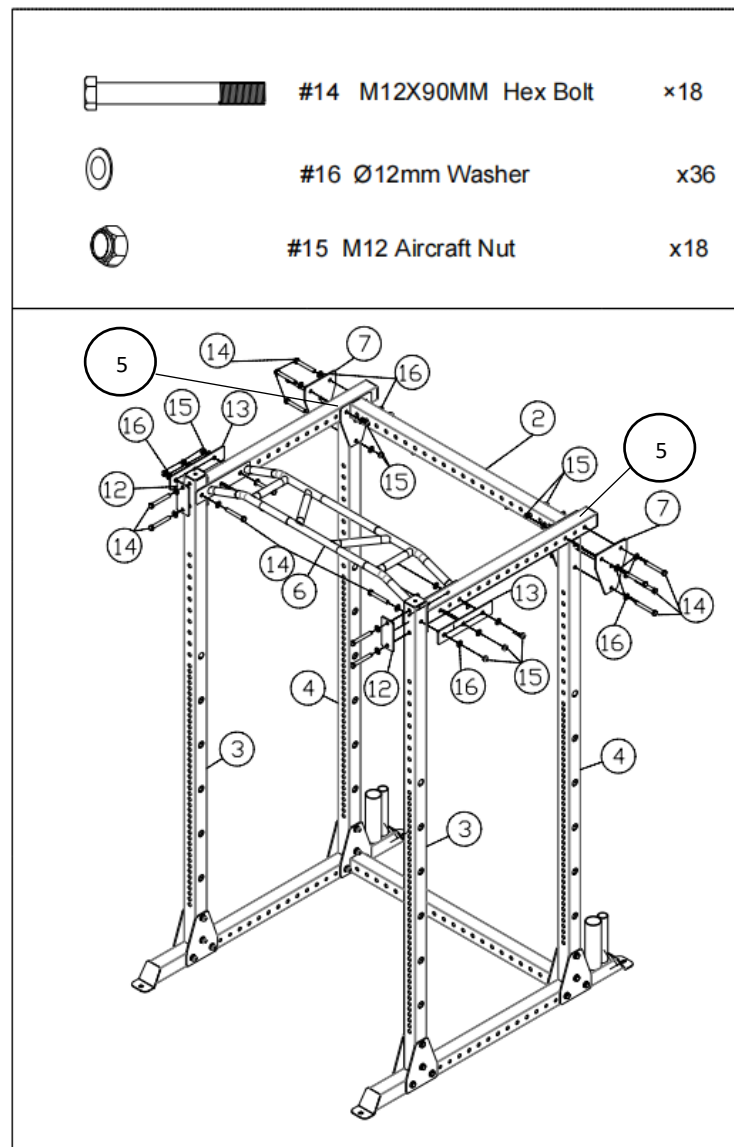

- Attach two Upper Frames (#5) to the two Front Upright Supports (#3), Align two top holes and secure each of them with one Flat Bracket (#12), two M12x90mm Hex Bolts (#14), four Ø12mm Washers (#16) and two M12 Aircraft Nuts (#15)
- Place the rear side of the two Upper Frame (#5) onto the top of the two Rear Upright Supports (#4), Place one Cross Beam (#2) into the centre of the two Rear Upright Supports (#4), Align the holes on the Upper Frame (#5), Cross Beam (#2) and Upright Beam (#4) and Secure each side with one Triangle Bracket (#7), four M12x90mm Hex Bolts (#14), eight Ø12mm Washers (#16) and four M12 Aircraft Nuts (#15)
- Attach the multi-grip pull up bar (#6) into the centre of the two Upper Frame (#5), Align the top two holes and secure each of them with one Long Flat Bracket (#13), two M12x90mm Hex Bolts (#14), four Ø12mm Washers (#16) and two M12 Aircraft Nuts (#15).

Assembly Instructions

Step 4

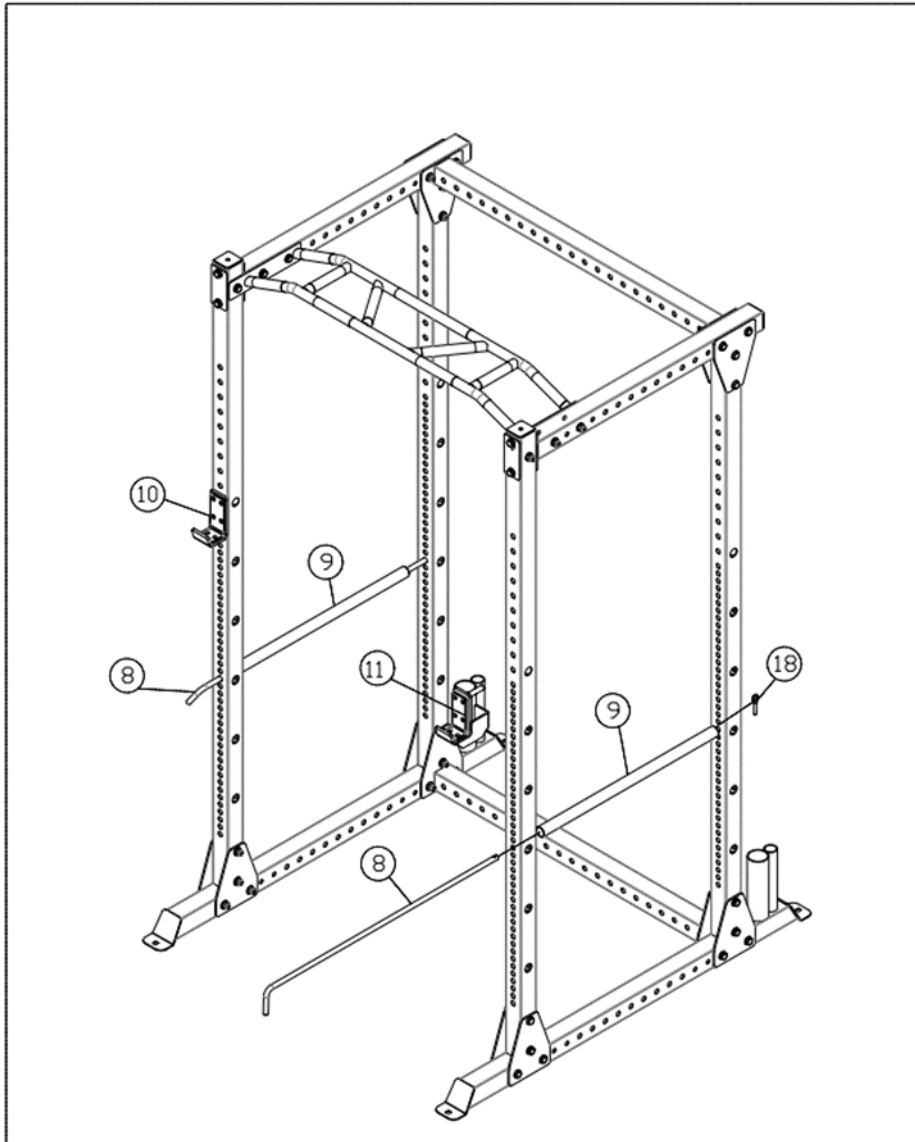

- A. Select the desired height and place the two safety bars (#8) and Sleeve (#9) into position.
- B. Select the desired height and place Left and Right J-Hook (#11 & #10) on the two Front Upright Support (#3), and lock the end with M8 Lock Pin (#18).

Exploded Diagram

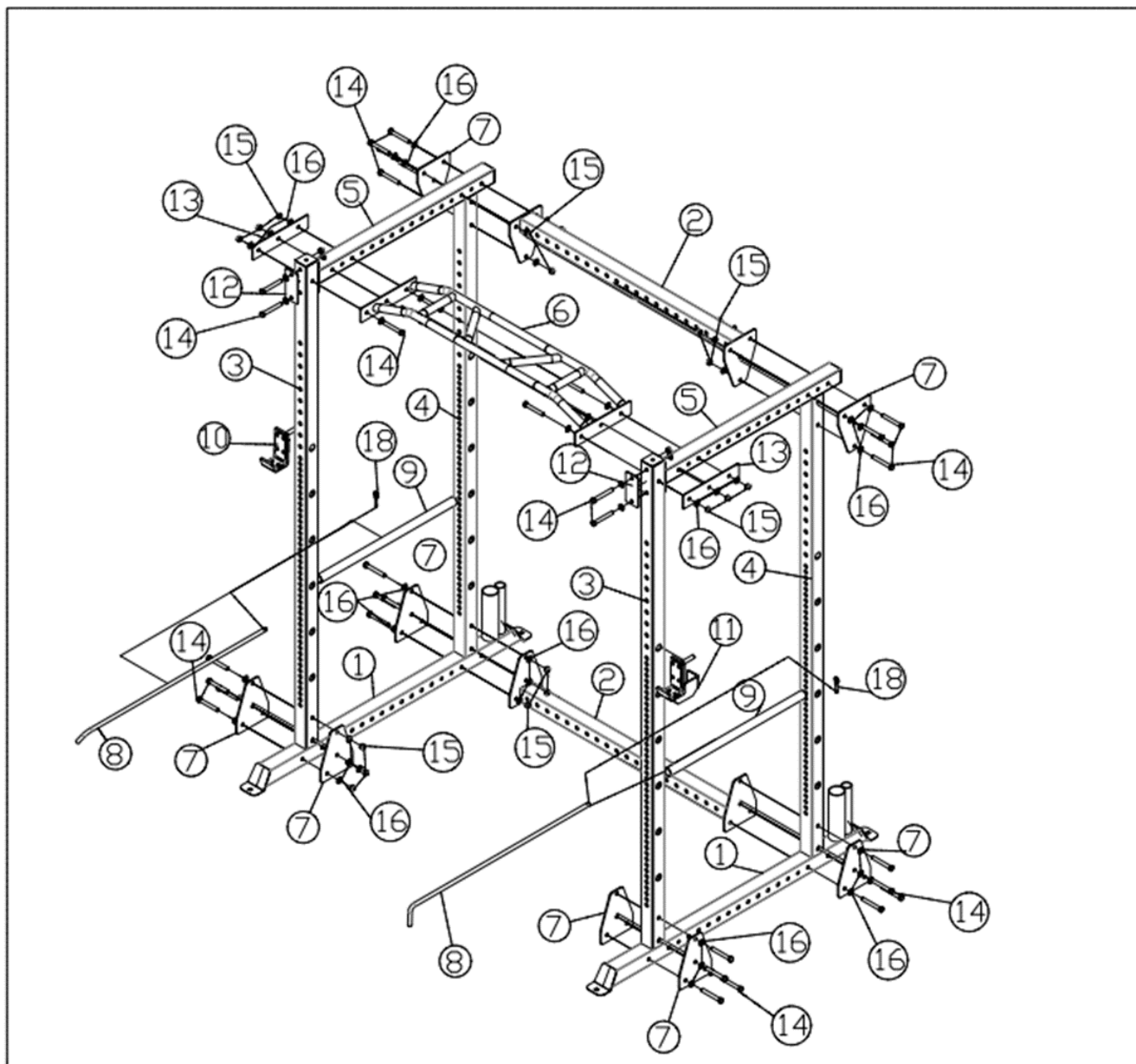

Parts List

Key No.	Description	QTY	Key No.	Description	QTY
1	Base Stabilizer	2	12	Short Flat Bracket	2
2	Cross Beam	2	13	Long Flat Bracket	2
3	Front Upright Support	2	14	M12x90mm Bolt	34
4	Rear Upright Support	2	15	M12 Aircraft Nut	34
5	Upper Frame	2	16	Ø12mm Washer	68
6	Multi Grip Pull Up Bar	1	17	17#/19# Fix Wrench	1
7	Triangle Bracket	12	18	M8 Lock Pin	2
8	Safety Bars	2			
9	Safety Bar Sleeves	2			
10	Left J-hook	1			
11	Right J-hook	1			

Exercise Information

Tailor your exercise program according to your physical condition. If you have been inactive for several years, or are overweight, you must start slowly and gradually increase your time on the equipment; a few minutes per workout increase is advisable.

Initially, you may be able to exercise only for a few minutes in your target zone; however, your aerobic fitness will improve over the next six to eight weeks. Do not be discouraged if it takes longer. It is important to work at your own pace.

Please remember these essentials:

- Have your doctor review your training and diet programme to advise you of a workout routine you should adopt.
- Begin your training programme slowly with realistic goals.
- Monitor your pulse frequently. Establish your target heart rate based on your age and condition.
- Set up your equipment on a flat even surface with an adequate training area, as prescribed in this manual.

Exercise intensity

To maximize the benefits of exercising, it is important to exercise with proper intensity. The proper intensity level can be found by using your heart rate as a guide. For effective aerobic exercise, your heart rate should be maintained at a level between 65% and 85% of your maximum heart rate as you exercise. This is known as your target zone. You can find your target zone in the table below.

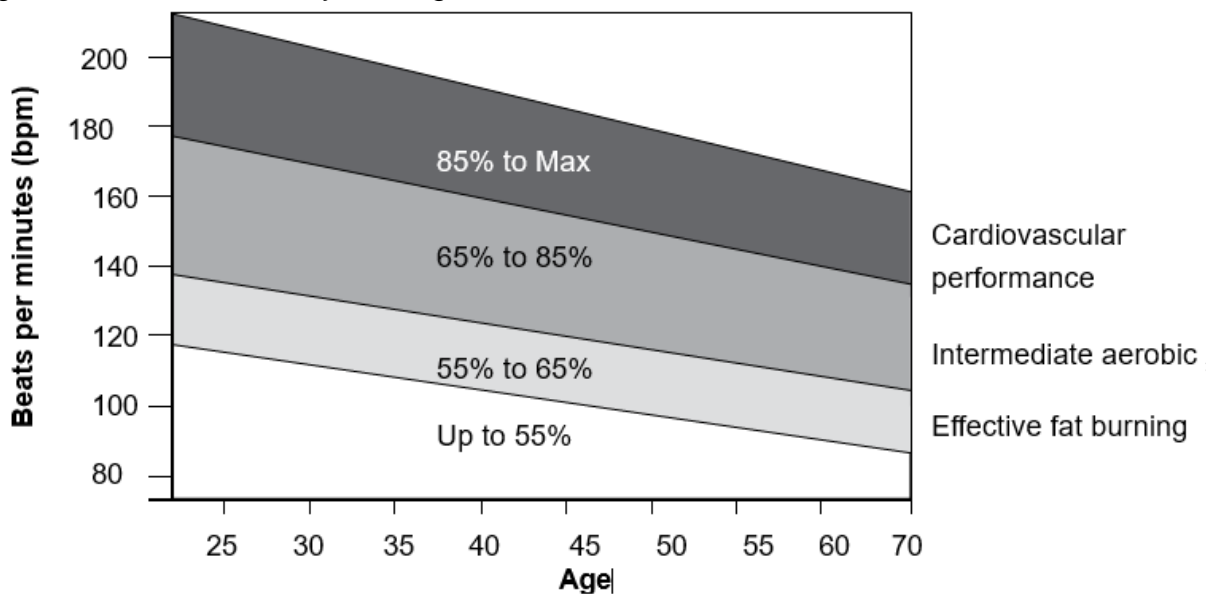

During the first few months of your exercise programme, keep your heart rate near to the low end of your target zone as you exercise. After a few months, your heart rate can be increased gradually until it is near the middle of your target zone as you exercise.

To measure your heart rate, stop exercising but continue moving your legs or walking around and place two fingers on your wrist. Take a six-second heartbeat count and multiply the results by 10 to find your heart rate. For example, if your six-second heartbeat count is 14, your heart rate is 140 beats per minute.

(A six-second count is used because your heart rate will drop rapidly when you stop exercising.) Adjust the intensity of your exercise until your heart rate is at the required level.

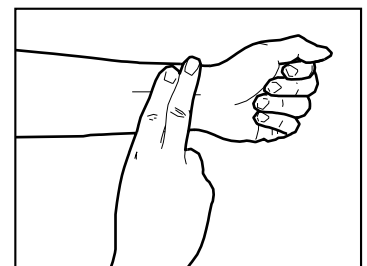

Exercise Information

Aerobic Exercise

Aerobic exercise improves the fitness of your lungs and heart - your body's most important muscle. Aerobic exercise fitness is promoted by any activity that uses your large muscles (arms, legs or buttocks, for example).

Weight Training

Along with aerobic exercising which helps get rid of and keep off the excess fat that our bodies can store, weight training is an essential part of the routine process. Weight training helps tone, build and strengthen muscle. If you are working above your target zone, you may want to do a lesser amount of reps.

Targeted Muscle Groups

The exercise routine that is performed on the training bench will develop the core muscle groups. These muscle groups are highlighted on the muscle chart below.

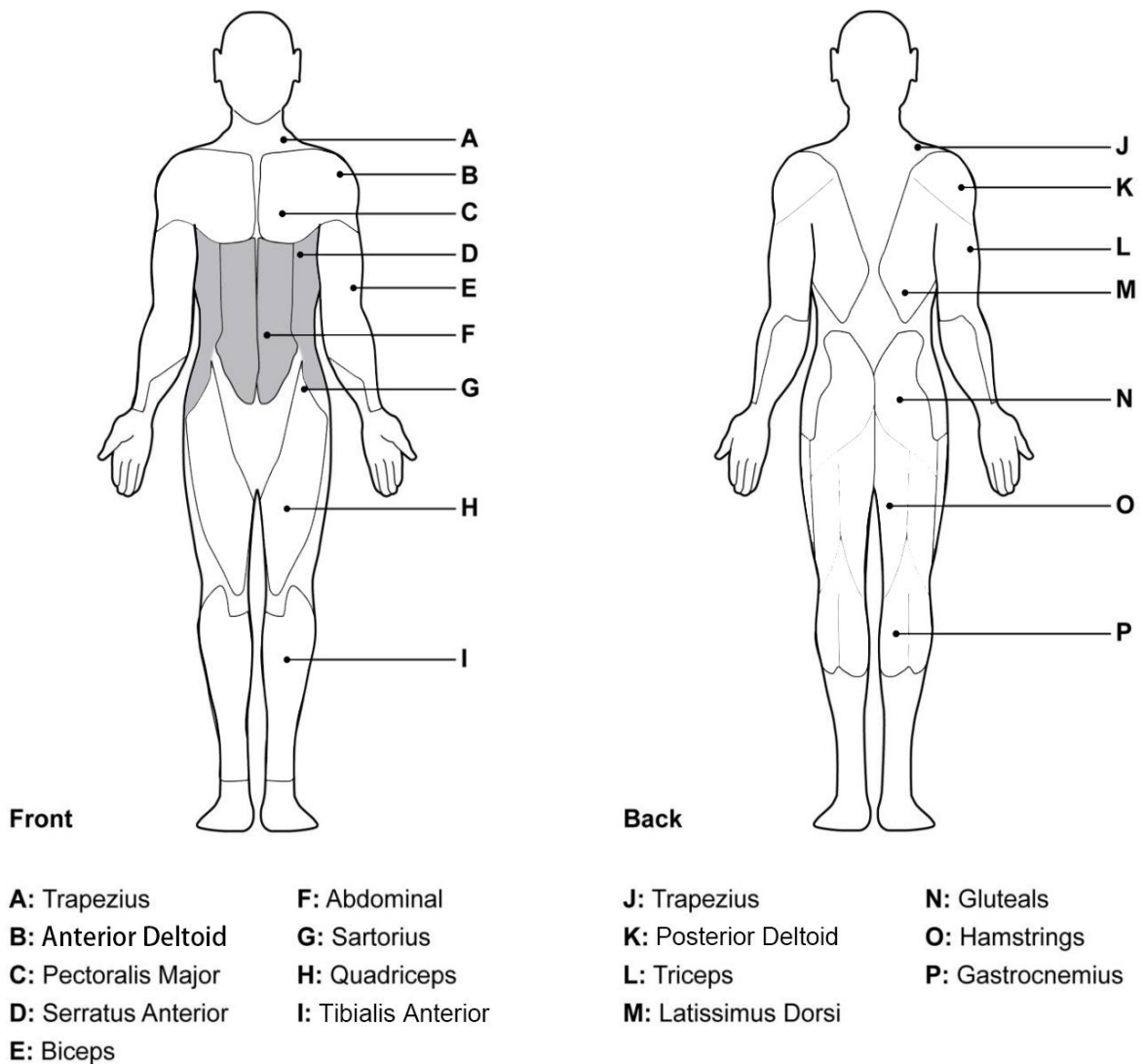

Exercise Information

Each workout should include the following three parts:

1. A warm up, consisting of 5 to 10 minutes of stretching and light exercise. A proper warm up increases your body temperature, heart rate and circulation in preparation for exercise.
2. A training zone exercise consisting of 20 to 30 minutes of exercising with your heart rate in your training zone. (**Note:** During the first few weeks of your exercise programme, do not keep your heart rate in your training zone for longer than 20 minutes.)
3. A cool down, with 5 to 10 minutes of stretching. This will increase the flexibility of your muscles and will help to prevent post-exercise problems.

Exercise Frequency

To maintain or improve your condition, plan three workouts each week with at least one day of rest between workouts. After a few months of regular exercise, you may complete up to five workouts each week, if desired. Remember, the key to success is to make exercise a regular and enjoyable part of your everyday life.

Walkout T-Rotation

Feet shoulder width apart reach down to floor and walk hands away from feet into a plank position. Twist through torso to raise one hand up to ceiling and reach back to further stretch the pectoral region. Return to plank position and repeat on other side. Walk back up to standing and repeat for 12-15 repetitions. For a little extra, add a push up each time you are in the plank position.



Wall Slides

With back and heels against the wall, raise arms up over head and place back of hands and elbows against the wall. Keeping elbows and backs of hands against the wall draw elbows down and in towards ribcage, then return to overhead position. Repeat for 12-15 repetitions.

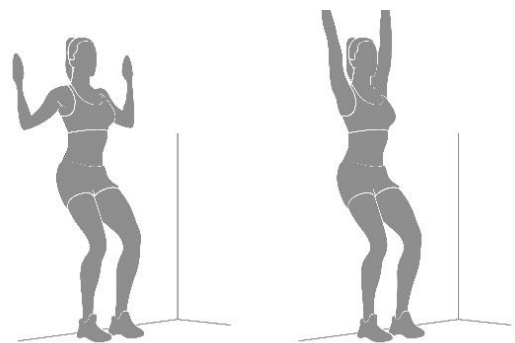

Scorpions

Laying face down on the floor, take arms out to sides with palms down (creating T shape with body if looking from birdseye view). Bring opposite heel of foot up towards opposite extended hand rotating through torso and lifting chest. Ensure arm/shoulder of extended arm you are aiming for heel to touch stays pushed down into the ground to stretch through chest and front of shoulder. Repeat on other side. Repeat for 10-12 repetitions each side.

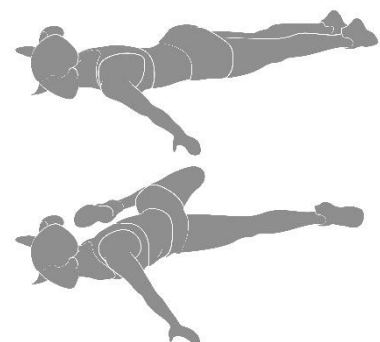

Exercise Information

Iron Crosses

Laying flat on back, take arms out to side with palms face up to create T shape with body if looking from above. Raise one leg and bring up and across body to touch down on opposite side floor (bend knee for less intense stretch and straighten to intensify). Ensure back and shoulders stay flat on floor.

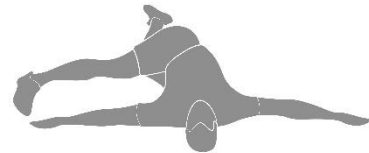
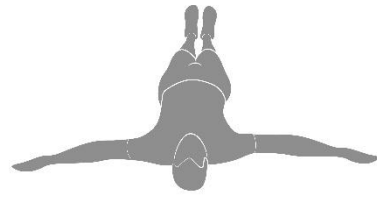

Quadruped T-Spine Rotation

In kneeling position and sitting on heels place hands in front of knees. Take palm of one hand to back of head. Draw elbow of this arm down to opposite knee, then rotate elbow up as high as you can to ceiling by turning through torso. Other hand and knees must remain flat on floor. Repeat for 12-15 repetitions each side.



Band Pull Aparts

Using a light resistance band, hold the band with hands just wider than shoulder width apart and at shoulder height. Keeping arms straight, pull arms apart from each other to stretch band across front of chest and pinch shoulder blades together. With control, and arms remaining straight, return to start position. Repeat for 12-15 repetitions. To make harder, hold band closer together. To make easier, hold band further apart.

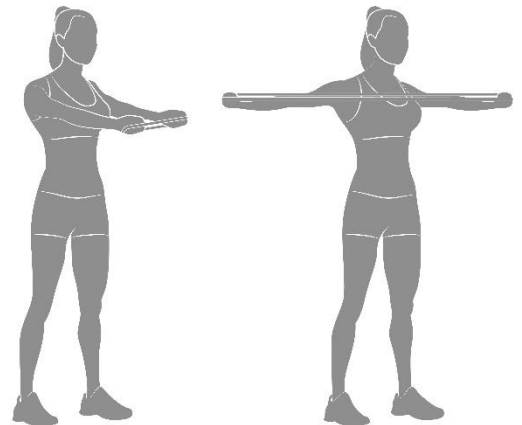

Resistance bands available at:

www.musclesquad.com

Care & Maintenance

1. The safety level of the equipment can only be maintained if it is examined regularly for damage and wear e.g. the connection points.
2. Inspect and tighten all parts before using the equipment. Replace defective components immediately and/or keep the equipment out of use until repaired. Pay special attention to the components most susceptible to wear.
3. The equipment can be cleaned using a damp cloth and mild non-abrasive detergent. **Do not** use solvents.
4. **Do not** attempt to repair this equipment yourself. Should you have any difficulty with the assembly, operation or use of your exercise product or if you think that you may have parts missing, contact the MuscleSquad on info@musclesquad.com.

Guarantee:

For guarantee purposes, please retain your purchase receipt.



All MuscleSquad Racks come with an Extended Guarantee for ultimate peace of mind.

This includes:

- 10 years frame cover
- 2 years parts cover

During this time if any repairs are needed please contact us directly so we can arrange a replacement.

**10 Year Frame
Warranty**

**2 Year Parts
Warranty**

**For ultimate
peace of mind**