

Standard Filter Specs

The Pure Company Standard Carbon Filter is designed to provide high quality drinking water through a gravity type application for municipal treated water supplies. The molded block technology is specifically designed to improve taste, clarity and odor without using water pressure or pre-wetting procedures.

Size: 2"D x 7.5"L

Working pressure: None – Gravity fed

Maximum working temperature: 100°F

Minimum working temperature: 40°F

Unrestricted flow: > 1 gallon per hour with 2 inches of head pressure

Recommend change frequency: every 12 months

The Standard Filter has been tested to meet or exceed ANSI|NSF Standards 42 + 58 for specified claim reduction



THE PURE COMPANY

Have a question? Need help?

We're here for you.

1.800.572.6228

support@thepurecompany.com

Live Chat at thepurecompany.com

(Please include your order number with your query.)

Need Replacements?

To order replacement Carbon Block Filters, visit thepurecompany.com/support.

65-00681_VA-01080

STANDARD CARBON
BLOCK FILTER
FOR THE CARBON FILTER
WATER DECANTER

QUICKSTART GUIDE

What's in this Box

Carbon Block Filter

Filter Washer

Filter Wing Nut

Getting Started

The tools you need to install your Pure Company Carbon Block Filter: your hands. Really. It's that simple.

Want to watch an assembly video? Visit us at thepurecompany.com/support

Installing Your New Carbon Block Water Filter

STEP ONE

NOTE: To prevent contamination, wash hands before proceeding.

Rinse the Carbon Block Filter under cold water for one minute to remove any loose particles and remove the upper filter container. Place it on its side on a solid surface.

STEP TWO

If replacing an existing carbon block filter, unscrew the filter wing nut that secures the Carbon Block Filter from the upper filter container and discard the used filter.

STEP THREE

NOTE: The Carbon Block Filter comes with hardware already assembled.

Remove packaging from the new Carbon Block Filter and unscrew the wing nut from the Carbon Block Filter. Place the filter stem through the hole in the upper filter container. Secure using the wing nut.

Do not over tighten.

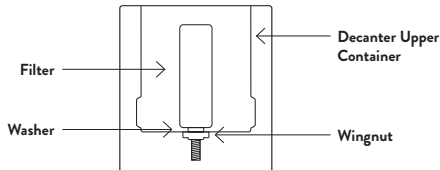

STEP FOUR

Reassemble The Pure Company Carbon Filter Water Decanter by placing the upper filter container with the installed filter securely on top of the lower water container. Place the assembled decanter into the rubber base.

Your Carbon Filter Water Filter Decanter is now ready to fill.

Reminders

- A. Use only with tap water or other potable water source.
- B. Make sure the spigot is in the off position (the handle is turned to the side) until you're ready to dispense your water.
- C. Fill the upper container with water and allow it to filter into the lower water container. The initial fill needs to full saturate the filter with water.
- D. Since fine particles of carbon may flush from the filter initially, please discard the water and then refill and discard a second time. (Please note that it may take more than an hour for each round of water to flow through the filter.)
- E. After the second batch of water has run through the filter, empty the lower water container
- F. Refill the upper filter container, and your water is ready to drink.

Important

- The Carbon Block Filter may take up to 15 minutes to begin dripping. After the initial 12–24 hours of use, micro air pockets within the filter will be fully replaced with water and the decanter will reach its maximum flow rate.
- The Carbon Block Filter should be replaced at least once a year. More frequent replacement may be required depending on frequency of use and source water.
- DO NOT clean filter with detergents or soaps.
- DO NOT allow filter to freeze.
- DO NOT place filter in a microwave oven.
- DO NOT boil purification elements.
- DO NOT store filter until completely dry.
- DO NOT allow filter to sit in the direct sun for extended periods of time.
- DO NOT place filter near a heat source or in direct sunlight.
- DO NOT use elements to filter sea water or softened water.