

Chicago Code Steel LED Exit Signs

Series models are designed for Chicago applications where a steel housing is required. The unit is designed for both initial and retrofit installations and offers high-power efficiency and uniform illumination, which are ideal for stores, offices, hospitals and school corridors.



Features

- Universal voltage ranging between 100-300VAC
- Maintenance-free nickel-cadmium battery
- 20-gauge steel housing with white finish
- Red silk-screened letter on white phosphorescent
- Heat-tempered, impact-resistant glass lens
- Steel canopy allows ceiling or end mounting
- Universal pattern knock-out on rear for direct mounting to junction box
- Two fully adjustable metal lamp head : 3.6VDC 1.84W(2)
- Temp rating: 10°-40° damp
- DOE Registered
- UL 924 Listed for damp location and City of Chicago approved

Dimensions

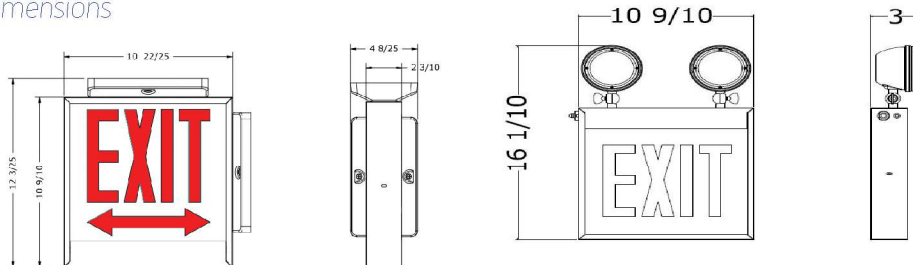

Ordering Information