

PLUG-AND-PLAY LIGHTBARS



LED SELF-DRIVEN & DIMMING LIGHTBARS

The MaxLED LED Lightbar is a flexible lighting source that offers leading-edge efficacy that is superior to Linear Fluorescent and halogen alternatives in custom applications including:

Commercial:

Sports book/gaming
General cove lighting
Accent and indirect lighting
Wall washing
Display

Residential:

Kitchen and under cabinet
General cove lighting
Accent and Indirect lighting
Base cabinet toe kick

FEATURES:

- Dimmable down to 15%
- Operating Temperature 0-104 F
- Links together with connector to make long runs
- Pressure clips and double sided tape for easy installation
- Hardwire and plug-in configurations available
- Suitable for damp locations
- 120 Vac operation at 60 Hz
- Suitable for food preparation applications

CONSTRUCTION:

Enclosure: High quality extruded aluminum

Diffuser: Architectural-grade diffuser eliminates unsightly hot spots and ensures an even, pleasing distribution of light

Driver: Integral low voltage driver maximizes efficiency without sacrificing light output

Finish: Durable powder coated finish

PROJECT NAME	
CATALOG NUMBER	
NOTES	
FIXTURE TYPE	ROOM SCHEDULE

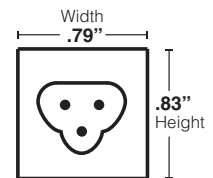

PIA'12 PRODUCT INNOVATION AWARD WINNER



Luminaire Ordering Information:

Watts	Order Number	Model Number	Delivered Lumens	Lumens Per Watt	Luminair Life (Hrs.)	Dimensions - L"	CCT
Linear Linkable Lightbar System - Up to 50 linear feet							
3.1	71217	MLSDB9627LED	125	40	50,000	6.03	2700K
3.1	72046	MLSDB9635LED	135	47	50,000	6.03	3500K
3.1	71218	MLSDB9650LED	152	47	50,000	6.03	5000K
6.1	71213	MLSDB1827LED	285	47	50,000	12	2700K
6.1	72045	MLSDB1835LED	300	53	50,000	12	3500K
6.1	71214	MLSDB1850LED	312	53	50,000	12	5000K
12	71900	MLSDB3627LED	560	47	50,000	23.78	2700K
12	72125	MLSDB3635LED	530	47	50,000	23.78	3500K
12	71903	MLSDB3650LED	560	47	50,000	23.78	5000K
24	71902	MLSDB7227LED	1125	47	50,000	47.17	2700K
24	72126	MLSDB7235LED	1125	47	50,000	47.17	3500K
24	71905	MLSDB7250LED	1125	47	50,000	47.17	5000K
Ambient Lightbars - Up to 70 linear feet							
3.6	71215	MLSDB1227LED	181	50	50,000	12	2700K
3.6	72044	MLSDB1235LED	190	55	50,000	12	3500K
3.6	71216	MLSDB1250LED	198	55	50,000	12	5000K
High Output Lightbars - Up to 30 linear feet							
8.6	71211	MLSDB3327LED	465	54	50,000	12	2700K
8.6	72043	MLSDB3335LED	480	58	50,000	12	3500K
8.6	71212	MLSDB3350LED	505	58	50,000	12	5000K

Note: Lightbars from different systems should not be used in the same lines or run, or operated using the same dimming control.



MAX12131

PLUG-AND-PLAY LIGHTBARS

LED SELF-DRIVEN & DIMMING LIGHTBARS



ACCESSORIES INCLUDED:



4" corner joiner for continuous runs



Bar-to-bar joiner

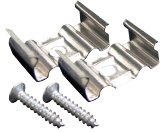

Quick-clip mounting bracket and screws



Directional mounting clips



Alternative mounting option double-sided tape

OPTIONAL ACCESSORIES:



71219-MLSDBJL40G
Joiner lead 40"



71225-MLSDBLC48G
Line cord 48" w/ molded plug to demonstrate lightbars



71221-MLSDBJL70G
Hardwired lead 70"



72139-MLSDBJL12G
Joiner lead 12"



71631-MLSDBCONNS
Lightbar connection - unpainted

71645-MLSDBCONNSW
Lightbar connection - painted



74085-MLSDB-CBOX
Lightbar connection box



74230-MLSDB-DBOX
Lightbar distribution box with on-off switch

APPROVED DIMMING CONTROL:

Lutron DVELV-300P should be used with MaxLite's LED Lightbars.



Lighting layouts and spacing criteria available upon request

All claims are backed by LM-80 and LM-79 test reports. Visit Maxlite.com to download copies of test reports.



MaxLED

lighting facts
A Program of the U.S. DOE

Light Output (Lumens)	125
Watts	3
Lumens per Watt (Efficacy)	40

Color Accuracy	81
Color Rendering Index (CRI)	

Light Color
Correlated Color Temperature (CCT) **2700 (Warm White)**

2700K 3000K 4500K 6500K

All results are according to IESNA LM-79-2008: Approved Method for the Electrical and Photometric Testing of Solid-State Lighting. The U.S. Department of Energy (DOE) verifies product test data and results.

Visit www.lightingfacts.com for the Label Reference Guide.

Registration Number: WJP2-TY16TV (1/31/2012)
Model Number: MLSDLB9627LED
Type: Cove light

MaxLED

lighting facts
A Program of the U.S. DOE

Light Output (Lumens)	181
Watts	4
Lumens per Watt (Efficacy)	50

Color Accuracy	81
Color Rendering Index (CRI)	

Light Color
Correlated Color Temperature (CCT) **2700 (Warm White)**

2700K 3000K 4500K 6500K

All results are according to IESNA LM-79-2008: Approved Method for the Electrical and Photometric Testing of Solid-State Lighting. The U.S. Department of Energy (DOE) verifies product test data and results.

Visit www.lightingfacts.com for the Label Reference Guide.

Registration Number: WJP2-TY16CC (1/31/2012)
Model Number: MLSDLB1227LED
Type: Cove light

MaxLED

lighting facts
A Program of the U.S. DOE

Light Output (Lumens)	285
Watts	6
Lumens per Watt (Efficacy)	47

Color Accuracy	81
Color Rendering Index (CRI)	

Light Color
Correlated Color Temperature (CCT) **2700 (Warm White)**

2700K 3000K 4500K 6500K

All results are according to IESNA LM-79-2008: Approved Method for the Electrical and Photometric Testing of Solid-State Lighting. The U.S. Department of Energy (DOE) verifies product test data and results.

Visit www.lightingfacts.com for the Label Reference Guide.

Registration Number: WJP2-BQJ74Z (1/31/2012)
Model Number: MLSDLB1827LED
Type: Cove light

MaxLED

lighting facts
A Program of the U.S. DOE

Light Output (Lumens)	467
Watts	8.6
Lumens per Watt (Efficacy)	54

Color Accuracy	80
Color Rendering Index (CRI)	

Light Color
Correlated Color Temperature (CCT) **2700 (Warm White)**

2700K 3000K 4500K 6500K

All results are according to IESNA LM-79-2008: Approved Method for the Electrical and Photometric Testing of Solid-State Lighting. The U.S. Department of Energy (DOE) verifies product test data and results.

Visit www.lightingfacts.com for the Label Reference Guide.

Registration Number: WJP2-MMEKVS (1/31/2012)
Model Number: MLSDLB3327LED
Type: Cove light

MaxLED

lighting facts
A Program of the U.S. DOE

Light Output (Lumens)	152
Watts	3
Lumens per Watt (Efficacy)	47

Color Accuracy	81
Color Rendering Index (CRI)	

Light Color
Correlated Color Temperature (CCT) **5334 (Daylight)**

2700K 3000K 4500K 6500K

All results are according to IESNA LM-79-2008: Approved Method for the Electrical and Photometric Testing of Solid-State Lighting. The U.S. Department of Energy (DOE) verifies product test data and results.

Visit www.lightingfacts.com for the Label Reference Guide.

Registration Number: WJP2-YS8EPE (2/16/2012)
Model Number: MLSDLB950LED
Type: Cove light

MaxLED

lighting facts
A Program of the U.S. DOE

Light Output (Lumens)	198
Watts	4
Lumens per Watt (Efficacy)	55

Color Accuracy	81
Color Rendering Index (CRI)	

Light Color
Correlated Color Temperature (CCT) **5000 (Daylight)**

2700K 3000K 4500K 6500K

All results are according to IESNA LM-79-2008: Approved Method for the Electrical and Photometric Testing of Solid-State Lighting. The U.S. Department of Energy (DOE) verifies product test data and results.

Visit www.lightingfacts.com for the Label Reference Guide.

Registration Number: WJP2-RW7PKT (2/16/2012)
Model Number: MLSDLB1250LED
Type: Cove light

MaxLED

lighting facts
A Program of the U.S. DOE

Light Output (Lumens)	312
Watts	6
Lumens per Watt (Efficacy)	53

Color Accuracy	81
Color Rendering Index (CRI)	

Light Color
Correlated Color Temperature (CCT) **5313 (Daylight)**

2700K 3000K 4500K 6500K

All results are according to IESNA LM-79-2008: Approved Method for the Electrical and Photometric Testing of Solid-State Lighting. The U.S. Department of Energy (DOE) verifies product test data and results.

Visit www.lightingfacts.com for the Label Reference Guide.

Registration Number: WJP2-H7AF4 (2/16/2012)
Model Number: MLSDLB1850LED
Type: Cove light

MaxLED

lighting facts
A Program of the U.S. DOE

Light Output (Lumens)	503
Watts	8.7
Lumens per Watt (Efficacy)	58

Color Accuracy	82
Color Rendering Index (CRI)	

Light Color
Correlated Color Temperature (CCT) **5313 (Daylight)**

2700K 3000K 4500K 6500K

All results are according to IESNA LM-79-2008: Approved Method for the Electrical and Photometric Testing of Solid-State Lighting. The U.S. Department of Energy (DOE) verifies product test data and results.

Visit www.lightingfacts.com for the Label Reference Guide.

Registration Number: WJP2-TBZKND (2/16/2012)
Model Number: MLSDLB3350LED
Type: Cove light



Lighting layouts and spacing criteria available upon request

All claims are backed by LM-80 and LM-79 test reports. Visit Maxlite.com to download copies of test reports.

