

Job/Location: _____	Job Type: _____
Contractor: _____	Date: _____
Prepared By: _____	



■ specifications: internal

The **WLX-NYC** has been designed to perform in applications where the climate would punish any standard sign. The entire internal cavity of the sign is protected from moisture ingress by an extremely resilient silicone gasket. The liquid gasketing is “hot-bonded” to the lens during the manufacturing process. This procedure eliminates any chance of the gasketing to become dry and pull away from the lens. The gasketing always holds its original form and has “memory retention” so that it effectively and consistently protects the **WLX-NYC** from moisture. The **WLX-NYC** can also be equipped with an optional thermostatically controlled heater for cold environments.

■ specifications: external

The **WLX-NYC** comes standard in grey. Four (4) polycarbonate pressure screws firmly hold the polycarbonate lens in place. Wall, ceiling or end mounting configurations are available. Ceiling and end mount versions come complete with a factory installed weatherproof steel canopy. Single or double face versions must be specified. Removable chevron arrows are standard on each unit along with an external LED status indicator and test switch.

■ ordering logic

Series	Model	LED	Face No.	Mounting	Market	Options
WLX-NYC	HT (AC only)	LR (red)	1 (single)	W (wall - no canopy)	SW8 ²	AT (autotest - for SA model only)
	SA (self-powered)		2 (double)	C (ceiling - w/canopy)		BZ (audible alarm buzzer)
				E (end - w/canopy)		FL ¹ (flashing alarm)
						PK12-W ³ (12" white pendant kit)
						PK12-B ³ (12" black pendant kit)
						PK12-BA ³ (12" brushed aluminum pendant kit)
						SW (special wording)
						120SA (120 minute emergency)
						2CK (dual circuit available in AC only)
						FAI (fire alarm interface)
						IRT (infrared testing)
						IH (internal heater - specify voltage)

NOTE 1: Only available with SA and requires AT.

NOTE 2: New York approved 8" lettering.

NOTE 3: Specify type- open/closed dry contact.

EXAMPLE: WLX-NYC-SA-LR-1-W-AT

DESCRIPTION: Self-powered, red LED, single face, wall mount, autotest.

■ dimensions (in,mm)

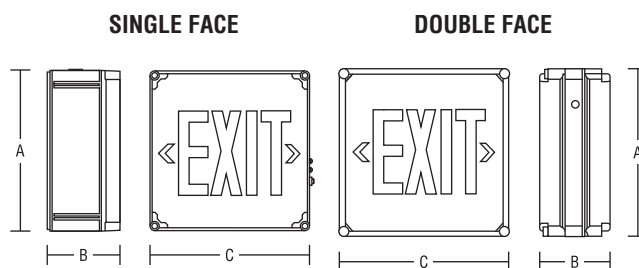

Series	A	B	C
Single Face	11 ³ / ₄ " (298mm)	7" (178mm)	11 ³ / ₄ " (298mm)
Double Face	11 ³ / ₄ " (298mm)	5" (127mm)	11 ³ / ₄ " (298mm)

■ specifications: electrical

BATTERY: The **WLX-NYC** is designed with an internal maintenance free, sealed Nickel-Cadmium battery providing a minimum emergency duration of 90 minutes. An optional 120 minute Nickel-Cadmium battery is available. Recharge time of the battery is forty-eight (48) hours. The battery operating temperature without the internal heater/thermostat option is 40°C maximum and 10°C minimum; with the internal heater (IH) option the minimum battery operating temperature is -20°C.

CIRCUIT: The **WLX-NYC** is configured with high-output red or green LEDs. Standard with 120/277V input. All LED versions consume only 2W nominal power.

■ specifications: mechanical

The **WLX-NYC** housing is constructed from durable, corrosion resistant fiberglass. The NEMA 4X housing is fully gasketed for damp and wet locations with a hot-bonded silicone gasket. Exit face(s) are made from a high clarity, clear polycarbonate that has been painted white on the internal side only, making the unit highly scratch resistant. Custom face colors and special wording / graphics are available, please specify.

■ sanitation listed

The **WLX-NYC** is sanitation listed. The Intertek verified splash zone listing is equivalent to the NSF standard 2, meeting the rigorous sanitation, electrical safety and performance standards of food service environments.

■ autotest

The **WLX-NYC** Autotest feature automatically monitors the functional operation of the unit. Autotest monitors the operation of the lamps, battery and circuitry and displays any alerts. Periodic emergency tests, up to ninety (90) minutes duration are simulated to ensure proper operation during an actual power failure. Operating status is visually indicated by multi-function LED indication.

● Steady Green:	Normal operation
● Flashing Green:	Testing under way
● Flashing Red/Green:	High Charging
● Steady Red:	Battery Disconnected
● Flashing Red:	Battery Test Failure
● Red Double Blink:	Battery Charging Failure
● Red Three Blink:	LED Failure

■ warranty

The **WLX-NYC** comes with a 5-year factory warranty. Lamps are not covered under the warranty. Deliberate damage, misuse, improper installation effectively cancel the warranty.