

ShutterGrip™ 2 User Guide

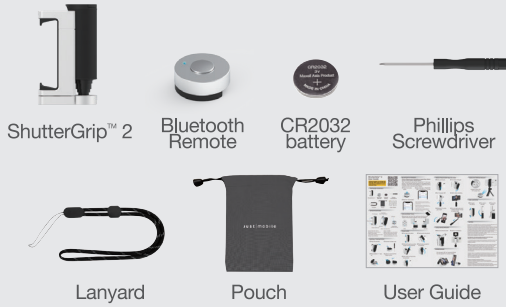

Improper operation may damage the palm grip. Before using, scan the QR code with your smartphone to view an Instruction Video.

PACKAGE CONTENT



SPECIFICATIONS



Bracket Size: 60 - 85 mm
Dimensions: 76 x 48 x 29 mm
Weight: 2.39 oz/68 g
Compatibility: Bluetooth 4.0 or later
Range: Up to 33ft (10m)

Battery: CR2032
Battery Lifetime: up to 18 months
OS: iOS 9 later/Android 5.0 later
Tripod Compatibility: UNC 1/4in
Operating Temperature: 0° to 50°C

INSTALL THE BATTERY

- 1 Insert the remote
- 2 Unscrew to open cap



- 3 Place battery "+" sign up
- 4 Latch on one end first. Tighten screw



BLUETOOTH PAIRING

Device Requirement: Smartphone supporting volume up key as the shutter release button.

After successfully pairing the ShutterGrip™ 2 with your phone, if the remote control button is not responding to presses, check the phone settings to make sure you're using the volume key as shutter release.

- 1 Press the shutter button
- 2 Open Settings -> Bluetooth. Click "ShutterGrip 2" to pair.

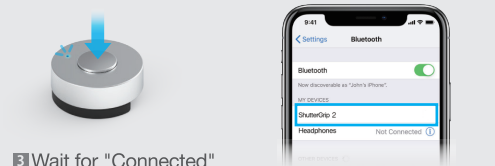

- 3 Wait for "Connected"



- When smartphone is more than 33ft (10m) away, the remote may disconnect with the phone.
- ShutterGrip will go to sleep when it is idling in the pairing mode (flashing LED) for more than 3 minutes.
- ShutterGrip will go to sleep when it is paired but idling (no flashing LED) for more than 10 minutes.

HEX-SCREW TOOL

Use the hex tool under the silicone cover to tighten 3 screws.

- ⚠ Avoid over-tighten which may break the hinge.
- ⚠ Use the hex tool only. Any other drivers may cause damage.

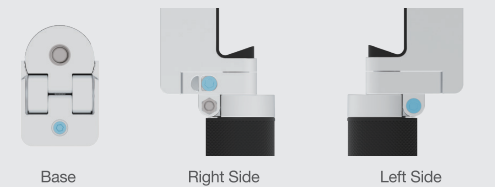

PALM GRIP

- 1 Pull open the clamp
- 2 Clamp onto the phone



- 3 Extend the grip up a little longer than the bracket
- 4 Push grip up against the bracket



- 5 Push down to lock onto the bracket

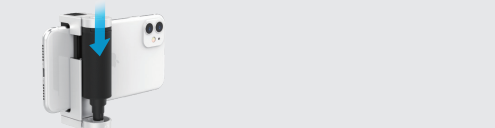

VIDEO PALM GRIP/SELFIE ARM

- 1 Push up the grip
- 2 Turn down the grip



- 3 Turn the grip 180°
- 4 Start video recording



- 5 Rotate 90° for side grip mode
- 6 Pull out selfie stick and install bluetooth remote for selfie mode



COLD SHOE MOUNT

- 1 Remove silicone cover
- 2 Latch on accessory



STAND MODE

Turn the grip 180° for horizontal Mode
Turn the grip 90° for vertical Mode



BUILT-IN TRIPOD MOUNT



Support tripod with 1/4" screw hole

USE LANYARD

- 1 Pull open the clamp
- 2 Turn down the grip
- 3 Tie up the lanyard



NOTES

- ShutterGrip is compatible with any smartphone supporting Bluetooth 4.0 or higher, and using the side volume buttons as shutter release.
- ShutterGrip is warranted to be compatible with the smartphone OS and Bluetooth versions that ShutterGrip was first released, New OS upgrades may cause incompatible issues that won't be covered by the warranty.
- ShutterGrip does not have a physical on/off button. To make sure ShutterGrip is off for an extended period of time, unpair it from Bluetooth settings.
- ShutterGrip is warranted for one year. Please register your product or present proof of purchase to get warranty service.
- Please use the included hex tool when needed. Any other screwdrivers may cause product damage and void warranty.

FCC Statement: This device complies with part 15 of the FCC Rules. Operation is subject to the following two conditions:

(1) This device may not cause harmful interference, and (2) this device must accept any interference received, including interference that may cause undesired operation.

NOTE: This equipment has been tested and found to comply with the limits for a Class B digital device, pursuant to part 15 of the FCC Rules. These limits are designed to provide reasonable protection against harmful interference in a residential installation. This equipment generates, uses and can radiate radio frequency energy and, if not installed and used in accordance with the instructions, may cause harmful interference to radio communications.

However, there is no guarantee that interference will not occur in a particular installation. If this equipment does cause harmful interference to radio or television reception, which can be determined by turning the equipment off and on, the user is encouraged to try to correct the interference by one or more of the following measures:

- Reorient or relocate the receiving antenna.
- Increase the separation between the equipment and receiver.
- Connect the equipment into an outlet on a circuit different from that to which the receiver is connected.
- Consult the dealer or an experienced radio/TV technician for help.
- Changes or modifications not expressly approved by the party responsible for compliance could void the user's authority to operate the equipment.