

PACKAGE CONTENTS

- 3 x Hi-Output 5W Garden Spots
- 3 x Spikes
- 1 x Remote Solar Panel with attached Battery Box
- 1 x 3-way Splitter and Accessories
- Colour Filters: 3 x Amber, 3 x Red, 3 x Green, 3 x Blue



FEATURES

- Dusk to Dawn Automatic Operation
- 6-8 hours Operation per day
- Spike Mounted Base

INSTALLATION METHOD

- Remove contents from packaging.
- On the back of the solar panel, connect the male cable from the panel to the female cable attached to the battery box. Secure the cables via the threaded connection lock.
- Connect the 3-way splitter to the male cable attached to the battery box and secure the threaded connection lock. Connect the cable from each garden spot light to the 3-way splitter and secure the threaded connection lock.
- Locate the silver "ON/OFF" switch on the back of the battery box, press once so that it becomes depressed (See **FIGURE 1**)
The lights will flash once indicating that the built-in controller is now activated. Your kit will automatically turn off once the solar panel is exposed to any form of artificial light or sunlight and turn on when the solar panel is in complete darkness.
- Mount the solar panel in a suitable location where it will receive maximum direct sunlight during the day. Spike each light into your desired location, making sure the length of cable will reach the solar panel.



FIGURE 1

IMPORTANT NOTES

- This solar product is designed for outdoor use only and is powered by a solar panel. In order for this fitting to perform correctly the solar panel needs to be placed in a position that receives direct sunlight with the solar panel facing the sun as much as possible.**
- Be aware that with overcast/cloudy days, the solar panel will still charge. However, not as efficiently as a sunny day, so the battery may not reach full capacity. Therefore turning off earlier than specified.
- It is best not to install these lights underneath a street light, porch light, etc. This may stop the automatic day-night sensor triggering and result in your lights not turning on.
- The Solar panel is made with glass components, please take care during the installation process and do not drop, strike or crush the solar panel.
- Regular cleaning of the Solar Panel is recommended to prolong the life of your fitting, a soft cloth and warm soapy water is best for cleaning.

TROUBLE SHOOTING

Phenomenon	Cause	Inspection Method	Solution
Light won't turn on	Switch hasn't been turned on	Determine what position the switch is in	Turn the switch on
	Battery has run flat	Period of rainy or cloudy weather or installation site doesn't provide enough direct sunlight	Charge the light in direct sunlight for 1-2 days then check again
The light only stays on for a short amount of time	Low Battery	1. Bad installation site for the solar panel 2. Dust or leaves are covering the panel 3. Long period of overcast weather	1. Charge the battery in direct sunlight for 1-2 days with the switch off, then check again 2. Clean the solar panel
	Battery Failure	1. Access the light and replace battery 2. Battery has matured	Contact SLD Customer Service to buy new batteries

HOW TO INSTALL THE COLOUR FILTER

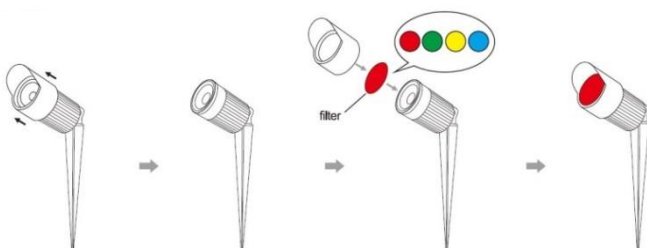

HOW TO ADJUST LIGHT HEAD ANGLE

