

QTY.	BOLTS
1	10MM x 110MM SHA
5	10MM x 80MM SHA
1	10MM x 55MM Socket Head Allen
1	10MM x 25MM Low head Allen
3	8MM x 25MM Hex Head Bolt
3	10MM Nylon Insert Lock Nuts
3	10MM x .875" x .125" Washer

QTY.	SPACERS
1	1" x .600 Stepped Idler Spacer
3	3/4" x 2.299" Spacer
1	3/4" x 2.000" Spacer
1	3/4" x 2.000" Threaded Spacer

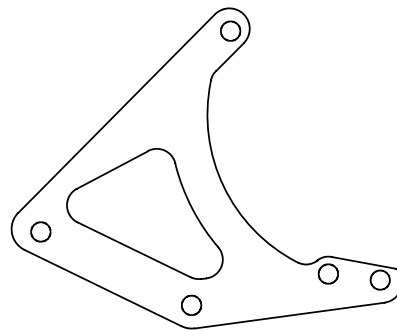

QTY.	PARTS
1	Front Bracket
1	Rear Bracket
1	60MM Smooth Idler Pulley

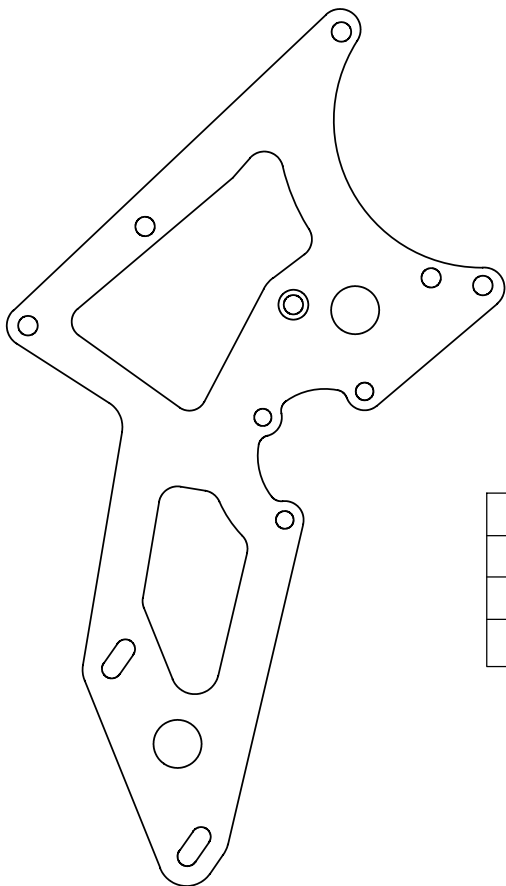
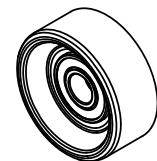

Installation Notes:

- do not torque bolts until all parts are installed
- some early LS1 blocks have only 1 mounting boss on the block, hardware is provided to mount the idler pulley if your block does not have both mounting bosses (see steps #2 and #3)

1: Attach the front and rear plate to the engine as shown

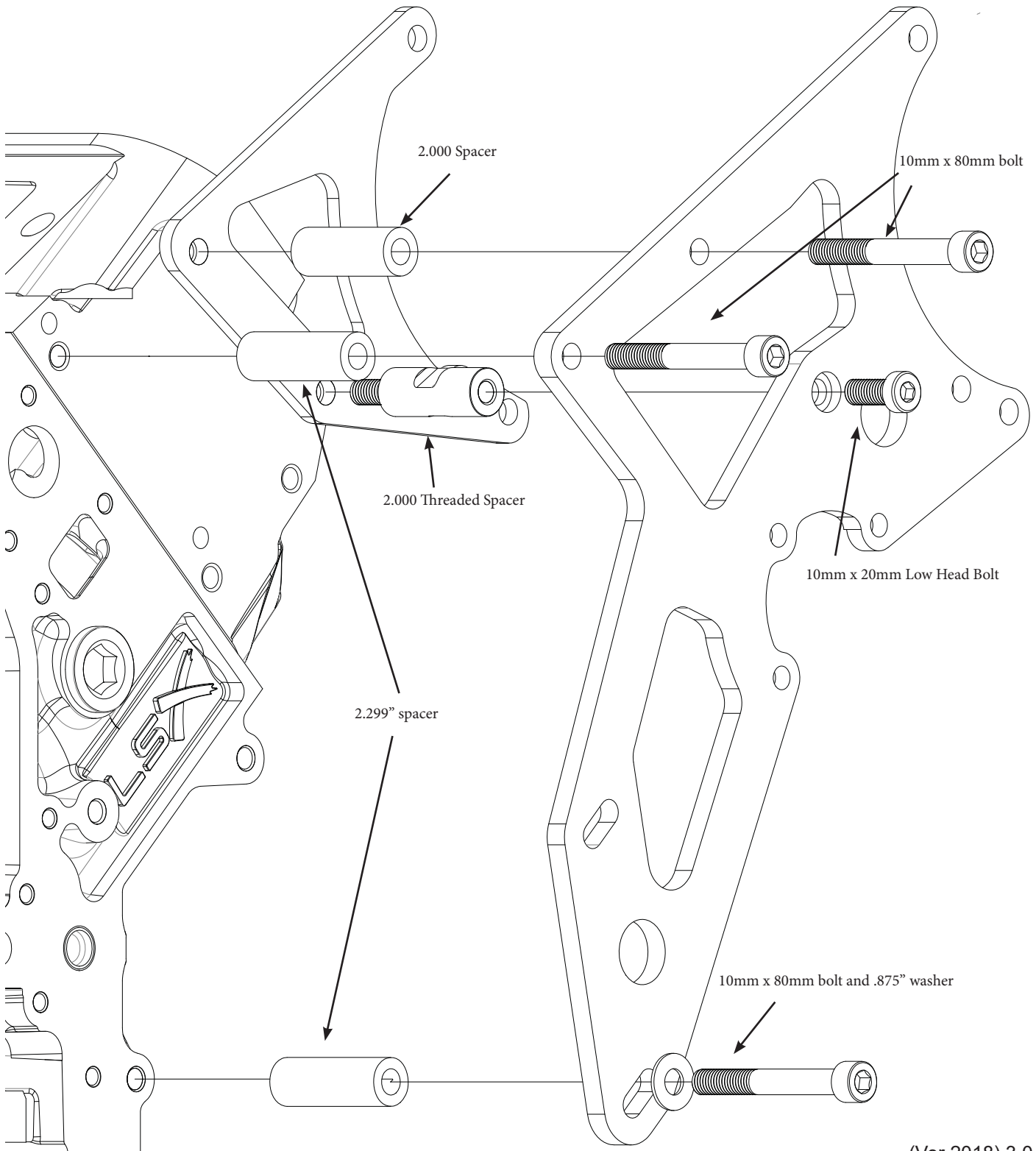

2: If your block has the upper mounting boss as shown the picture, mount the idler pulley using method 1, If your block does not have the mounting boss use method 2 for mounting your idler pulley

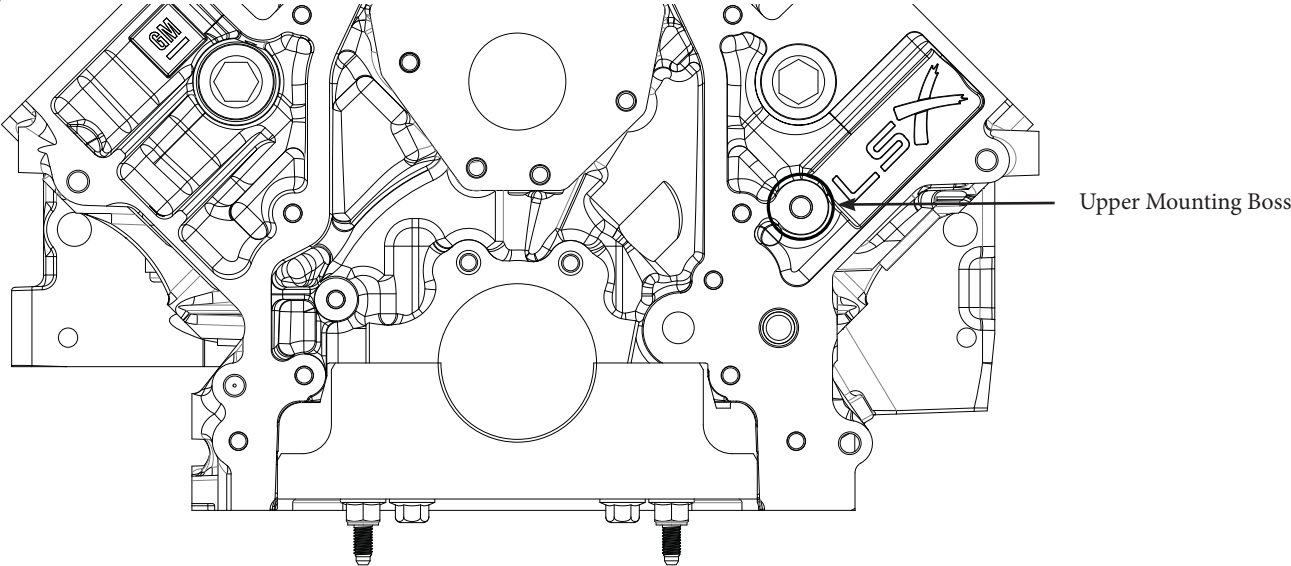

Method 1:

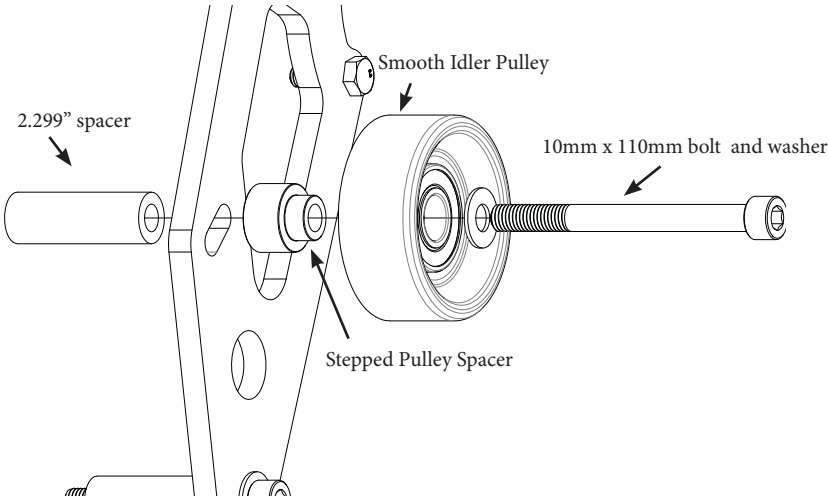

Method 2: Slide pulley/bolt towards the top of the slot

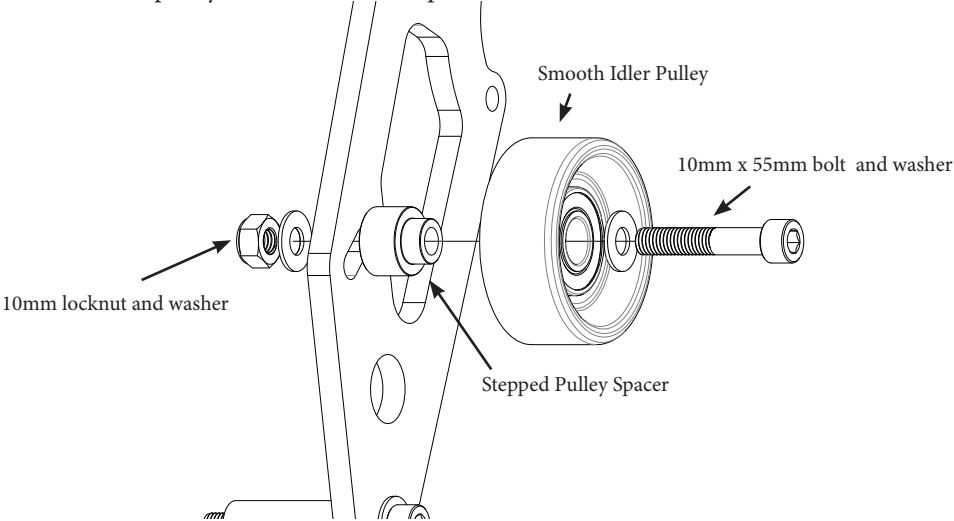

3: Attach the alternator

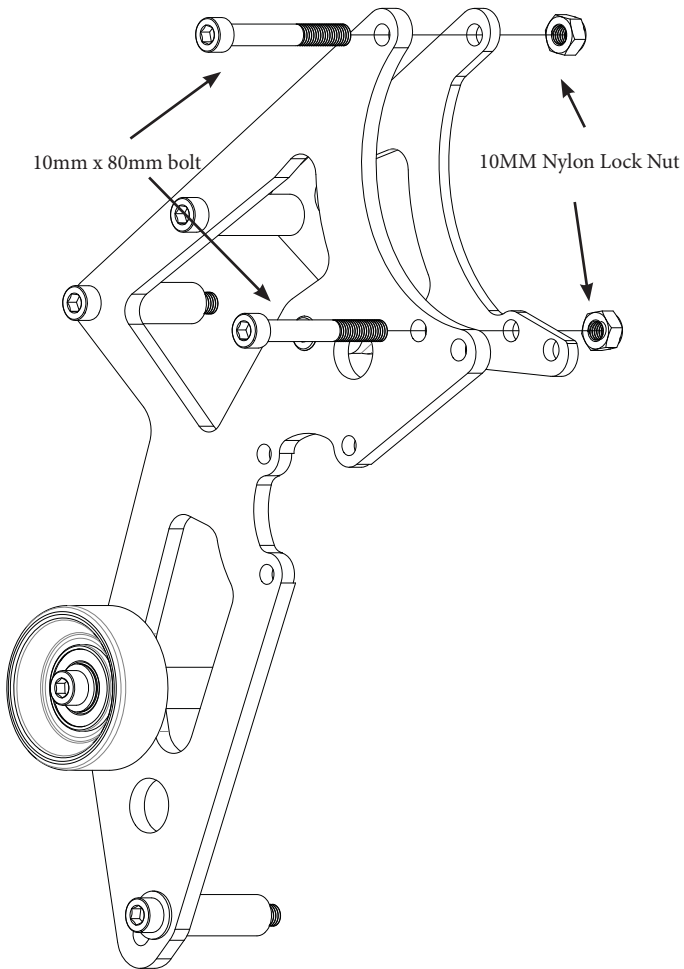

4: Attach the power steering pump

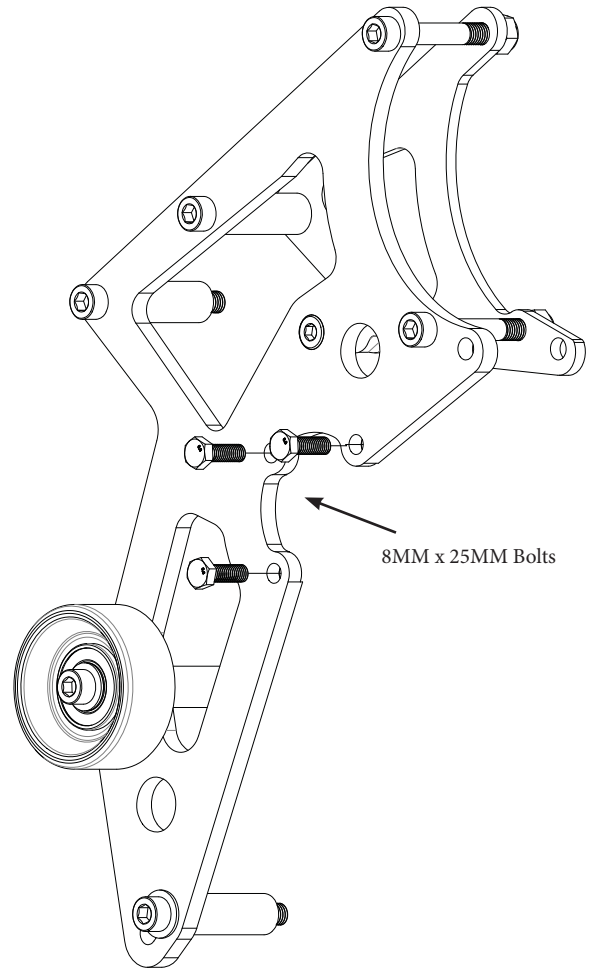

7: Torque Bolts

- torque all 10mm bolts to 25 ft-lbs (34 N-m)
- torque all 8mm bolts to 15 ft-lbs (20 N-m)

We do recommend using blue loctite 242 on all bolts threaded into the cylinder heads and block