

INSTRUCTION MANUAL

POWER SOURCE

This unit uses two (2) "AAA" batteries.

LOCATIONS OF CONTROL

1. TIME/ALARM LCD Display
2. ALARM STOP/LIGHT/SNOOZE button
3. HR (Hour) Button
4. MIN (Minute) Button
5. SET/LOCK Switch
6. SNOOZE/ALARM Switch
7. 12HR/24HR Switch
8. PRESS Button

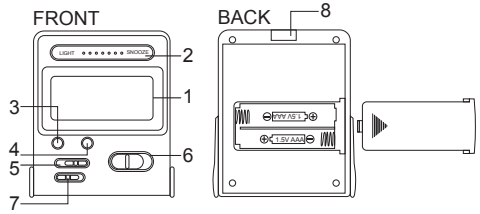

BATTERY INSTALLATION

Slide and open the battery compartment on the rear of the unit and insert two (2) "AAA" batteries following the polarity diagram.

NOTE: remove the clear film label over the LCD panel so LCD panel is visible.

TO OPEN THE FLIP COVER

Press the "PRESS" button (8) to open the plastic cover, flip the cover over to make the clock in a standable position.

TO SET TIME

Slide to CLOCK SET (5), press HR (3) or MIN (4) button to set your desired time.

TO SET ALARM

- Slide to ALM SET (5) position, the "AL" sign will appear on the display. Press HR (3) or MIN (4) button to set your desired alarm time.
- Slide to ALARM ON (6) position, the  sign will appear on the time display. The alarm function is activated.
- Slide to SNOOZE (6) position to activated the Snooze Alarm.

"LOCK" FUNCTION

- After you set time and alarm time, slide to the LOCK (5) position to protect the set time and alarm time against unnecessary changes caused by touch of buttons.

USING THE SNOOZE ALARM

Slide to SNOOZE (6) position, the sign Z_z will appear on the display. The SNOOZE function is activated. Once the alarm starts to ring, you can activated the snooze by pressing the ALM STOP/LIGHT (2) button. The alarm will stop for 8 minute and it will start to ring again. To completely stop the alarm, slide the ALARM SWITCH (6) to the OFF position. Alarm Duration: 1 minute

12HR / 24HR INTERNATIONAL TIME DISPLAY

- Simply slide the 12HR/24HR (7) switch to choose your desired format.
- In 12HR format, a "PM" sign will appear indicating PM hours.

USING THE SUPERGLOW BACKLIGHT

You may check the time anytime in the dark by simply pressing the ALM STOP/LIGHT button (2) once. The display will light up with a soft glow that lasts for a while. You can read the time easily and clearly.

NOTE: Frequent use of this feature will affect battery life.

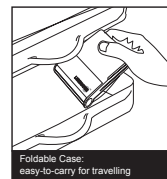
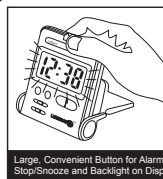
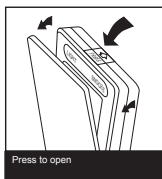

CARE OF YOUR CLOCK

- Avoid exposing your clock to extreme temperatures, water or severe shock.
- Avoid contact with any corrosive materials such as perfume, alcohol, or cleaning agents.