

## Soap Dispenser Installation

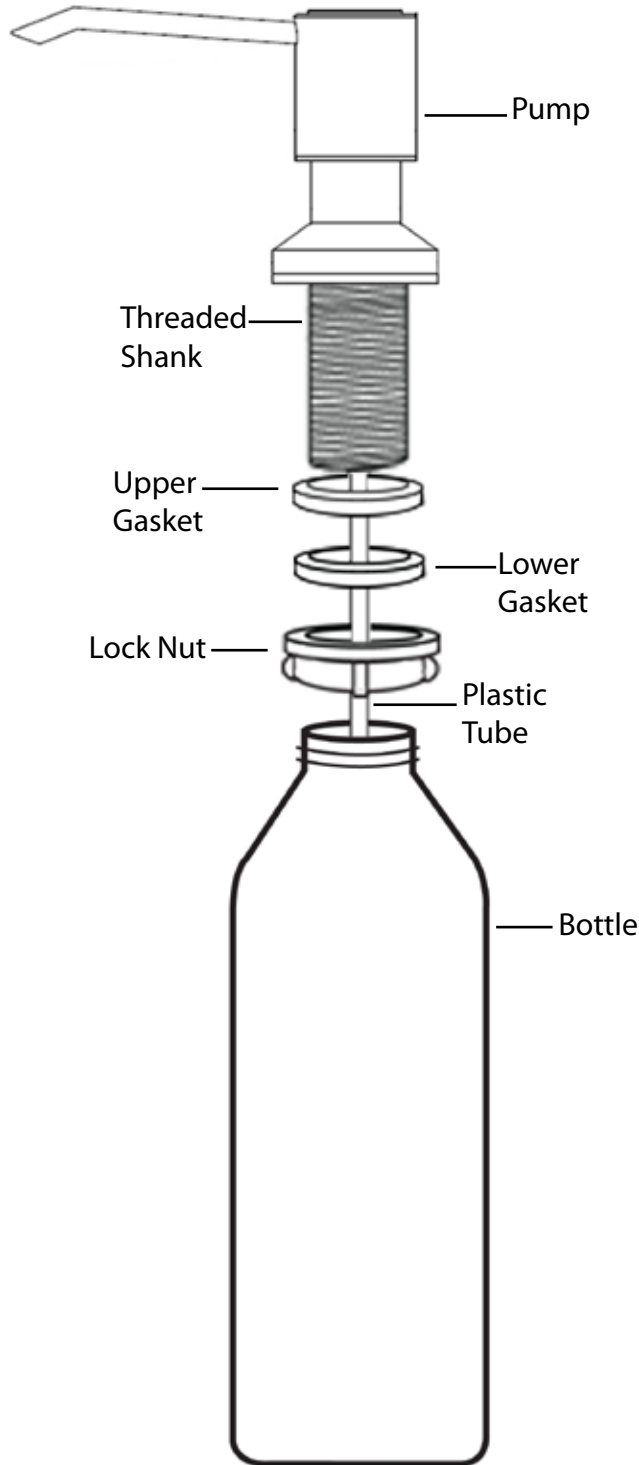

1. Place the threaded shank of the pump through the upper gasket and then through the sink hole.

2. From beneath the sink, place the lower gasket through the threaded shank.

3. Screw the lock nut up the threaded shank until the screw nut is secure.

4. Attach the plastic tube into the base of the threaded shank.

5. Fill up the bottle with liquid soap (not included). Then screw the bottle into the base of the threaded shank.