

Apron Sinks require a different cabinet compared to a standard undermount sink. Furthermore, installing an apron sink, and a counter top is also different.

Take a look at these two cabinets:

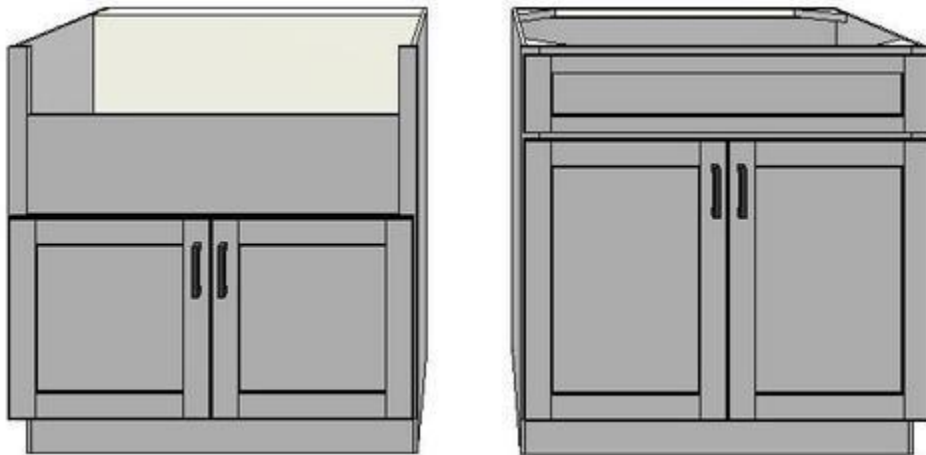

The cabinet on the left is made for an apron sink. This is called a country sinkbase cabinet. Note the shorter doors. The space taken from the height of the doors is given to the space occupied by the height of the apron sink face,

The cabinet on the right is a standard sink base. Note the taller doors and panel at the top, known as a false drawer front.