

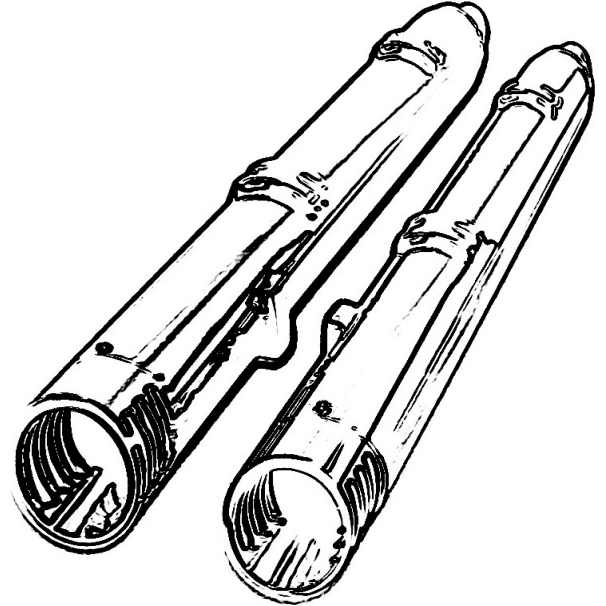

Warning: Our pipes are illegal for EPA, CALIFORNIA and CARB. Only for off-road racing use.

Warning: This muffler only fit Indian OEM Stock header pipe. May not work with aftermarket brands headers, like Vance Hines, Cobra, Rinehart, etc.

If you have aftermarket headers, please check the muffler inlet with your header inside pipe before install.



ITEM SUPPLIED:

- 1-LEFT SLIP-ON MUFFLER
- 1-RIGHT SLIP-ON MUFFLER
- 1-A PACK OF HARDWARE
- 1-INSTALLATION INSTRUCTION

FITMENT: 2014-UP

- CHIEF
- CHIEFTAIN
- ROADMASTER
- SPRINGFIELD

SUGGESTED TOOLS:



15MM LONG HANDLE SOCKET



13MM SOCKET WITH EXTENSION
1/4", 1/2", 5/16"



8MM WRENCH



6MM HEX DRIVER

PLEASE SURE THAT THE BIKE IS COMPLETELY COOLED DOWN BEFORE ANY OPERATION.

INSTALLATION INSTRUCTIONS

FOR 4.0" SLIP-ON MUFFLERS

FOR INDIAN CHIEF, CHIEFTAIN, ROADMASTER, AND SPRINGFIELD:

Please use the bolts and nuts come with the pipes.

1. Before doing any actions to your bike. Please sure your bike is right parked. Do not easy to fall down when you are pulling or installing the exhausts.

2. Before installing the new SHARKROAD 4.0" pipes for Indian models. We need to remove the stock slip-on mufflers first.

3. First of all. We need to remove the saddlebags if the bike installed with them. If they are touring models, please skip the step involves saddlebags.

4. Gently pull the plate (**Figure 1**) out to unplug the single wiring latch (**Figure 2**) for the saddlebags. Then unlock the levers or screws (**Figure 3**) for the saddlebags. Next, you can remove them easily. (If your bike does not involve with saddlebags, please ignore these steps.)

NOTE: Be careful, put the saddlebags on a soft platform and do not scratch the surfaces.

5. Now we start to remove the right stock pipe first.

6. Use 6mm screwdriver to loosen the **exhaust shield A** first. (Shown in **Figure 4**) Do not need to get the hose clamp out. Just to loosen it for pulling the stock pipe out.

7. Use 15mm socket to loosen the **nuts for the clamp B**. (Shown in **Figure 4**)

8. Before starting to remove the bolts and nuts on the bracket. Please sure if there is an antenna on the bracket to the pipes or not. If your bike is without an antenna, please ignore the steps revolved to it.

9. For with antenna bikes. Here is the way to disconnect the antenna.

Get the top rubber boot out. There is another rubber boot in the back for covering the nut for antenna. Use 5/16 socket to get the nut out. Then a big washer, a small washer, until you can pull the antenna out from the back. (Shown in **Figure 5**)

NOTE: Please keep track the certain order of the nuts and washers. Otherwise, your radio may not work.

NOTE: This is the only difference between bikes with antenna and without antenna.

Moreover, it is also the only difference of the left pipe and right pipe for bikes with antenna.

10. Now, we can see 2 bolts in the back to hold the right pipe. Please use 13mm socket to loosen the bolts and get them out. There is a antenna bracket between the pipe bracket and the exhaust. Pull it out and put it aside. We will reuse it later.

11. Carefully remove the muffler without hurting the head pipe; Slightly twist it and pull the muffler out until it slides off the head pipe. (Shown in **Figure 6**)

12. Get the clamp off the stock pipe. And mount it to the new pipe. (Shown in **Figure 7**)

13. And make sure they are oriented the same way that came off. So you can tighten it.

14. Now. Slide the new mufflers back to the head pipes until the mounting holes align. (Shown in **Figure 9**)Then reverses all the steps how we off the right pipe. Fix the bolts and antenna bracket (Slot Position Down-**Figure 8**)back and tighten them.

15. Then install the antenna back to the hole and connect the wire before install the small washer, the big washer, and the nut. Use 13mm socket to tighten the nut. Next, plug the back and the top rubber boot back to cover the nut and the joint of the antenna.

NOTE: Make sure the antenna wire, nuts and washers are installed in the right order. Otherwise, your radio may not work.

16. So we can set the saddlebags back now. Some bags have levers inside, some not. Use the levers or the bolts to sit the bags back to the position. Then connect the latch back, and plug the deco-plate back.

17. Then tighten the clamps for the muffler and head pipe. And tighten the heat shield hose clamp. (**Figure 10**)

18. Next, remove and install the left mufflers the same as the previous steps not involved with antenna.

Note: If your bike do not involves with antenna, then remove and install the right side pipe and ignore the steps for the antenna.

19. Finally, be sure to wipe all fingerprints or oil stain off after installation, before start the engine.

Note: If you leave a fingerprint to it, the chrome may discolor when it heats up!

Figure 1



Figure 2

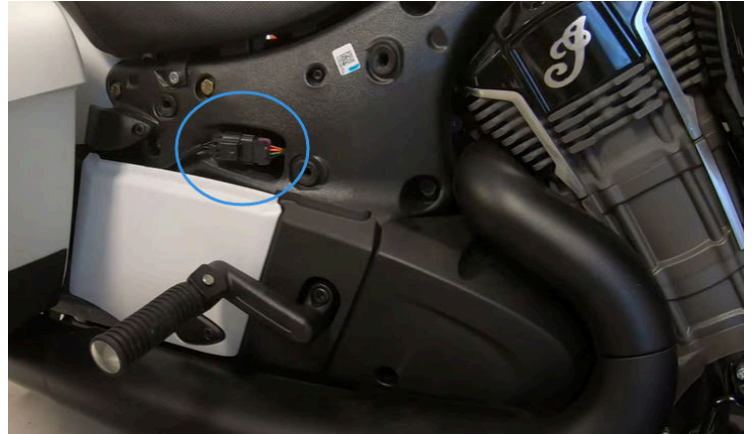

Figure 3

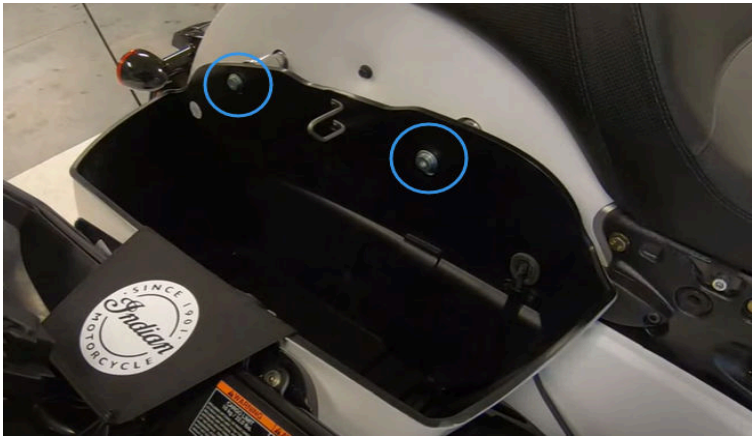

Figure 4

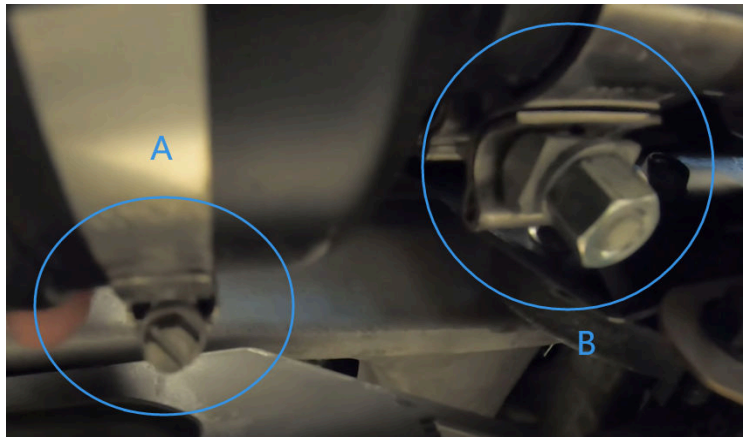

Figure 5

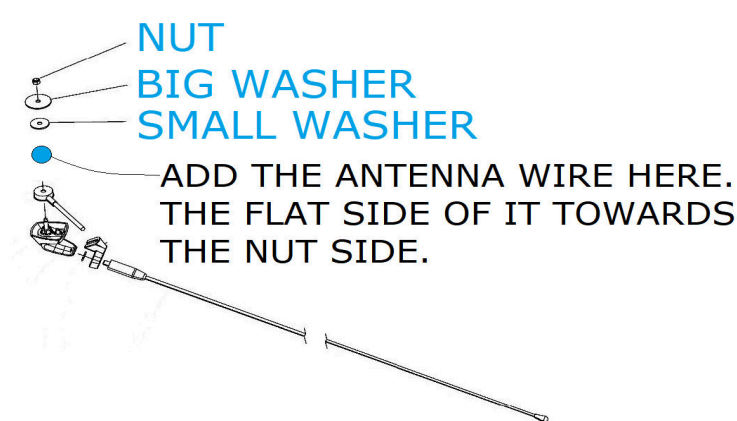

Figure 6



Figure 7



Figure 8



Figure 9



Figure 10



Be sure to tighten all hardware before starting your engine. Retighten after the first 100 miles.

Discoloration: DOES NOT WARRANTY ANY CHROME EXHAUST PRODUCTS AGAINST DISCOLORATION!

Discoloration is not a defect in chrome. All chrome exhaust systems will turn color. Chrome discoloration is a result of heat. The more heat the chrome is exposed to, the quicker and more severe the discoloration will be.

Tuning: It is strongly recommended by SHARKROAD. Better flowing, less restrictive exhaust will require more intake, so please consider upgrading your air cleaner along with your fuel-management system. Working with high-flow intake, Fuel Management system, and correct profession re-mapping, the bike would gain a more better performance.

C.A.R.B.: California does not allow the use of aftermarket exhaust systems that remove original equipment catalyts, (except for racing use only) unless the Air Resources Board has issued an Executive Order for that system.

Returns: When you want to return, please contact us in 72 hours after received the product so we can help you out immediatly. We only accept return in 30 days after your order. International Return is not acceptable. For return shipping cost to our warehouse, If the product have quality or shipping damage issue, We will send you shipping label or pay the cost after you send out. If you don't like the product or buy by mistake, Buyer should stand this shipping cost.

Warranty: SHARKROAD products are warranted for one year against defects in material and workmanship. This warranty does not cover chrome discoloration or rust. Also SHARKROAD will not warranty any abused, misused, improperly installed or modified system.

Wearing a helmet while riding is always recomended. Please never go for a ride while under the influence of alcohol and/or drugs. Enjoy the new voice and the fresh look of your motorcycle and please ride safely.