

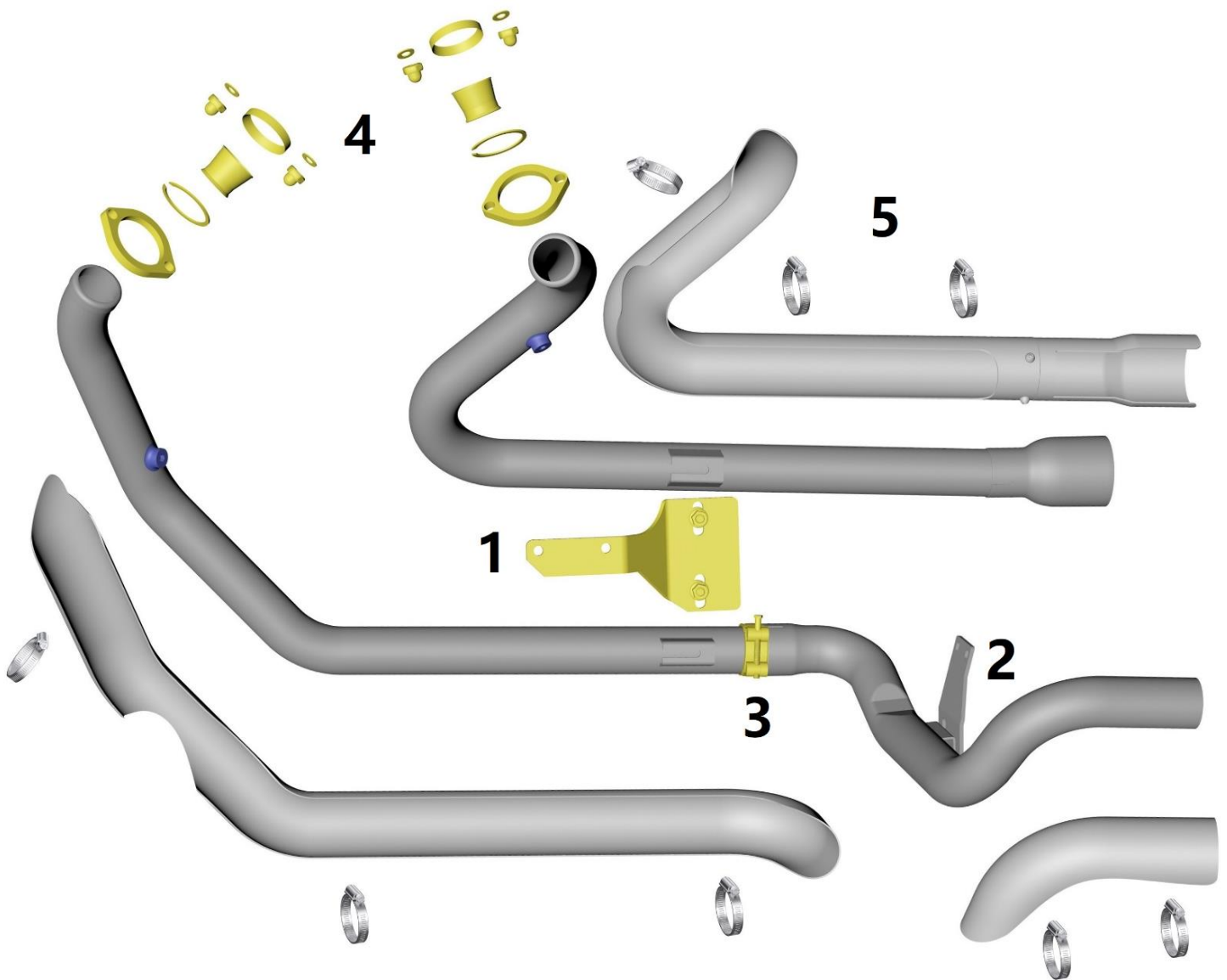

**Warning:** Our pipes are illegal for EPA, CALIFORNIA and CARB. Only for off-road racing use.

**Warning:** Checking with your local state and Federal Laws before you take any action on your head pipes. Our true dual pipes are only for off-road using, not for street riding. Please note.

## HDEX-14 TRUE DUAL HEADERS FOR 2017-UP HARLEY TOURING MODELS



**ITEM SUPPLIED:**

- 1-LEFT HEAD PIPE WITH HEAT SHIELD
- 1-RIGHT HEAD PIPE WITH HEAT SHIELD
- 1-A PACK OF HARDWARE
- 1-INSTALLATION INSTRUCTION

**FITMENT:**

2017-UP HARLEY TOURING MODELS  
**EXCEPT Trike Models**

PARTS COMES WITH HEAD PIPES: (Torque Cone Sold Separated)

- 1# - Flange Kit (Flange 2+Snap Ring 2+Gasket 2+ Stud Screw 4) - 1 PACK
- 2# - 18mm O2 Sensor Port Plug - 2 PCS (INSTALLED ON THE HEADERS.)
- 3# - O2 Sensor Transfer 18~12mm - 2 PCS
- 4# - Bracket for Underneath Crossover Pipe -1 PCE
- 5# - Bracket for Front Engine Port Pipe - 1 PCE
- 6# - 5/16-18\*2" Hex-head Bolts - 2 PCS
- 7# - L13\*I.D.12\*O.D.16mm Aluminum Spacer for 5/16-18 - 2 PCS
- 8# - 3/8-16\*2-1/4" Hex-head Bolt - 1 PCS
- 9# - 3/8-16\*3-1/2" Hex-head Bolt - 1 PCS
- 10# - L25\*I.D.15\*O.D.19mm Aluminum Spacer for 3/8-16 - 2 PCS
- 11# - 5/16-18\*3/4" Carriage bolts & nuts for 5/16-18 head pipes - 3 SETS
- 12# - 5/16" Flat washers & lock washers for Carriage Bolts - 3 SETS
- 13# - 3/8" Flat washers for 3/8" Hex-head Bolts - 2 SETS
- 14# - Hose Clamps (27~51mm) - 9 PCS
- 15# - Clamps (48~51mm) - 2 PCS
- 16# - Black Zipper Tie - 1 PCE

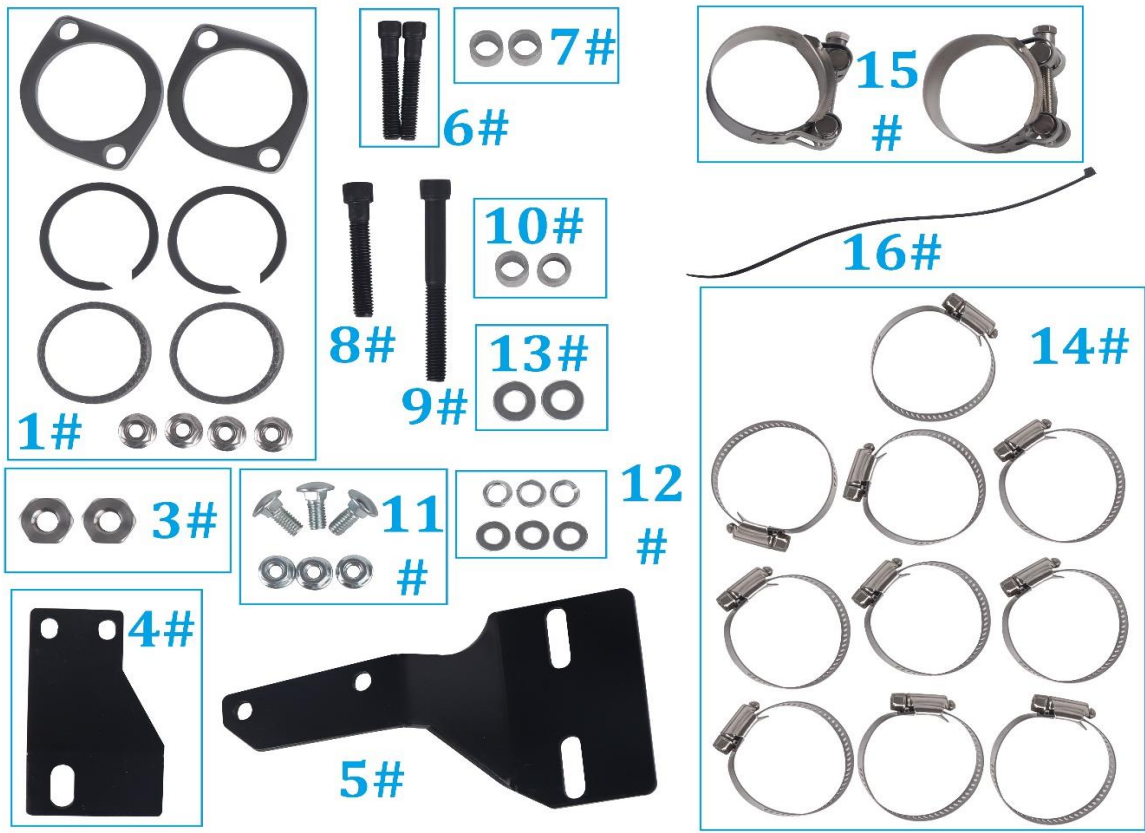

**SUGGESTED TOOLS:**



15MM LONG HANDLE SOCKET



6MM HEX DRIVER



8MM WRENCH



**Make sure that THE BIKE is completely cooled down before ANY OPERATION.**

## **INSTALLATION INSTRUCTIONS**

### **TRUE DUAL HEAD PIPES FOR 2017-UP HARLEY TOURING MODELS:**

**Please use the bolts and nuts come with the pipes.**

1. Before doing any actions to your bike. Please sure your bike is right parked. Do not easy to fall down when you are pulling or installing the exhausts.

**Note: According to various bike conditions or working site issues, we are not responsible for any injury when installing the pipes or exhausts.**

2. Before installing the new SHARKROAD HDEX-14 TRUE DUAL headers on, we need to remove the stock slip-on mufflers and head pipes first.

3. Release the quarter-turn pins (2 pins/bag) of the saddlebags, then remove the saddlebags carefully. Put them on a carpet or some sort of soft surface from scratching. (Shown in **Figure 1**)

4. Use a 15mm (9/16") long handle socket to loosen the exhaust clamps for connecting exhaust and mufflers. (Shown in **Figure 2**) Use a 13mm (1/2") regular socket to loosen the nuts for bracket plates holding the left and right mufflers. (Shown in **Figure 3**)

5. Carefully remove the left and right muffler without hurting the head pipe; Slightly twist it and pull the muffler out until it slides off the head pipe. Remove both sides mufflers in this way. (Shown in **Figure 4**)

6. Now, we need to use a 15mm (9/16") long handle socket to loosen the stock or original bracket for supporting crossover pipe. (Shown in **Figure 5**) Remove the part away when nuts off. (Shown in **Figure 6**)

7. Then, now we can start to remove the clamp for the header system to the crossover. Use a 16 mm (5/8") socket to loosen the nuts next to the crossover pipe bracket support we just removed. (Shown in **Figure 7**) Then carefully disconnect the crossover pipe.

8. All right. Now we will use a 8mm (5/16") hex head with a 15mm (9/16") wrench to remove the floorboard on the engine port side of the bike. It may in the way when removing the old headers or intalling the new one. (Shown in **Figure 8 / 9**)

9. Now we need to open the side panel to unplug the O2 sensor wires and let the wire out with the system later. (Shown in **Figure 10 / 11 / 12**)

**NOTE: GRAY O2 SENSOR WIRE- for FRONT HEAD. BLACK O2 SENSOR WIRE- for REAR HEAD. Make sure put them back on SHARKROAD TRUE DUAL in the corret order.**

10. Now get an extension with a 13mm (1/2") socket to remove the old flange nuts. (Shown in **Figure 13 / 14**)

11. The last step before we can remove the whole old header system is to remove the long flat top bolt main support near the oem catalytic converter. Use a 15mm (9/16") socket. (Shown in **Figure 15 / 16**)

12. Ok. We can get enough space to remove the whole head pipe system now. Because the new true dual system comes with a full-coverage heat shield. So we just need to reomeve the old headers with shields.

13. Finally, with everything released. Now we can get the whole old header system off the bike. (Shown in **Figure 17**)

14. After that, we need to get the stock O2 sensor wire off the system with a 14mm (9/16") wrench for a 12mm O2 sensor. We will use them on the new true dual.  
(Shown in **Figure 18**)

**Note: If your O2 sensor wire is a 18mm wider one, please use a 22mm (7/8") wrench to disconnect it.**

15. Before we dive into the new true dual system. We need to get rid of the stock bracket for OEM headers. And the bracket underneath the crossover as well.  
(Shown in **Figure 19 / 20 / 21**)

16. Use a 7mm (1/4") hex-head Allen to remove the stock bracket for OEM headers. Then install the new bracket on the position with the stock bolts.  
(Shown in **Figure 19 / 20**)

17. Next, use a 5mm (3/16") hex-head Allen to remove the stock underneath bracket for crossover pipe. And install the new bracket by utilizing the stock bolts.  
(Shown in **Figure 21 / 22**)

18. First, marking the hose clamp position on the pipes before installing, then you can tell where each of the hose clamp goes through. It will help when we hang the heat shield to the pipes. (Shown in **Figure 23**)

19. Now we can start to get the true dual pipes ready for installing now. Install the new flanges and snap rings coming with the pipes on to the header. (Shown in **Figure 24**)

**Note: Be very careful while inserting retaining rings onto headers, wear some type of safety gloves for the retaining rings may spring back and cause injuries. The slot on the flange for the snap ring should be faced to the engine port side.**

20. Before installing the pipe, please make sure the gasket at the engine port is in good condition. Or you need to change them with the new gaskets coming with the pipes.

**Note: Be very careful while removing or inserting the gasket. Do not damage the sphere engine port.**

21. Great. Now need to re-connect the **GRAY** O2 sensor wire into the bung on the front pipe (The pipe with underneath crossover section). The gray goes to the front engine port. The O2 Sensor port is I.D.-18mm. Use a 8mm (5/16") Hex Allen wrench with a ball end to remove the bung. If your wire end is I.D.-12mm. You might need a O2 sensor transfer (come in the parts bag) for altering the 18mm O2 sensor hole to a 12mm one. Then use a 14mm (9/16") wrench to snug this down.

**Note: O2 sensor I.D.-18mm wider one, then use a 22mm (7/8") wrench. And ignore the o2 sensor transfer step. If you do not want to reconnect the O2 sensor wire, then please leave the sensor plug in.**

22. After installing the Gray O2 sensor wire to this pipe, we can start to install the torque cone (**SOLD SEPARATED**) to the head pipe. Then install the pipe to the front engine port. (Shown in **Figure 25**) First, finger started to fix the nuts to the flange bolts. Then use a 13mm (1/2") socket. Do not tighten them this time. Because we might need some flexibility to adjust the pipe.

**Note: Please use the nuts coming with the pipes.**

**Note: Torque cone is a necessary for keeping the end torque and gain better performance. Our torque cone is special. You can not find on other place. (Torque cones sold separately.)**

23. Then mount the head pipe to the bracket with a 5/16" carriage bolt and nut coming with the pipes. (Shown in **Figure 26 / 27**) Do not tighten them this time. Because we might need some flexibility to adjust the pipe after install the mufflers.

24. Ok. Now we will connect the crossover pipe to the head with a clamp (48-51mm) coming with pipes. After that, we hang the crossover pipe to the underneath bracket with a 5/16" carriage bolt and nut. (Shown in **Figure 28 / 29**)

**Note: Please sure that the clamp bolt head down for tighten later. And the clamp bolt side should not against the heat shield.**

**Note: Do not tighten the bolts all the way down this time. Because we also need to align the true dual pipes with mufflers first. Then we can tighten them at the very end.**

**Note: Beware of the bracket facing. Because this bracket has a little bent angle.**

25. Ok. Now we can start to align the stock or original muffler with the left side header. Insert the clamp and slide the muffler to glove the header end. Then hang the muffler with stock exhaust hanger kit. (Shown in **Figure 30**) Then bolt the heat shield to the header pipe. Complete that, check the pipe and muffler is aligned correct and properly. Then please proceed to tighten way to the end.

**Note: Only stock mufflers, or aftermarket mufflers which compatible with stock headers are right fo this true dual system.**

**Note: Highly recommend you install SHARKROAD MUFFLERS for touring models. They are all compatible with stock headers and contribute awesome sound with better power performance.**

26. Great. Now we can thread the BLACK O2 sensor wire into the bung on the rear pipe. The black goes to the rear pipe. (The short pipe.) Using a 14mm (9/16") wrench. Not tighten them yet. We need to install the muffler back. It may need a little adjustment. Once the mufflers are aligned to the head pipe correct. Then tighten all the bolts and clamps. (Shown in **Figure 31**)

27. Then mount the pipe to the bracket with a 5/16" carriage bolt and nut coming with the pipes. Do not tighten them yet. Because we might need some flexibility to adjust the pipe when install the muffler back. (Shown in **Figure 31**)

28. Now we connect the extra section pipe to the rear pipe (the right leg side) with the 48-51mm clamp coming with the pipes. The extra extra section is for installing the muffler with 2.5" inlet. (Shown in **Figure 32 / 33**)

29. Then, slide the your mufflers back to the headpipes until the mounting holes align. Make sure the expansion slots was totally covered after mufflers go onto the head pipe. Before we start to tighten all the bolts and nuts. We should check all of the pipes are aligned correct. Complete that, proceed to tighten all of them. (Shown in **Figure 34**)

**Note: Only stock mufflers, or aftermarket mufflers which compatible with stock headers are right fo this true dual system.**

**Note: Highly recommend you install SHARKROAD MUFFLERS for touring models. They are all compatible with stock headers and contribute awesome sound with better power performance.**

30. Once the previous steps has been completed, install the pipes with heat shields with hose clamps coming with pipes. (Shown in **Figure 35**)

31. Awesome. We are almost there. Now we can use a 8mm (5/16") hex head with a 15mm (9/16") wrench to mount the floorboard for foot back. 3 sizes of bolts, aluminum spacers, and washers were packed for verious installing need. Please use the spacers, screws and washers included in the kit coming with the pipe. (Shown in **Figure 36**)

32. Before starting your bike, please check all the bolts, nuts, clamps, and screws are all tighten down. No rattling sound or other issue.

34. Finally, be sure to wipe all fingerprints or oil stain off after installation, before start the engine.

**Note: If you leave a fingerprint to it, the chrome may discolor when it heats up!**



**Figure 1**



**Figure 2**



**Figure 3**



**Figure 4**



**Figure 5**



**Figure 6**



**Figure 7**



**Figure 8**





**Figure 9**



**Figure 10**



**Figure 11**

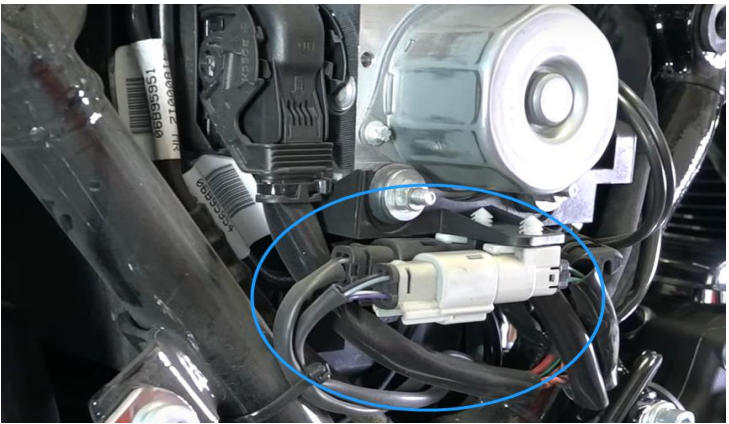

**Figure 12**

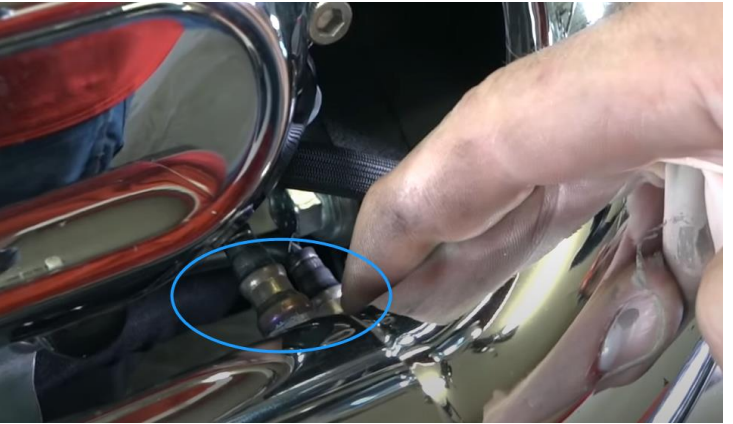

**Figure 13**

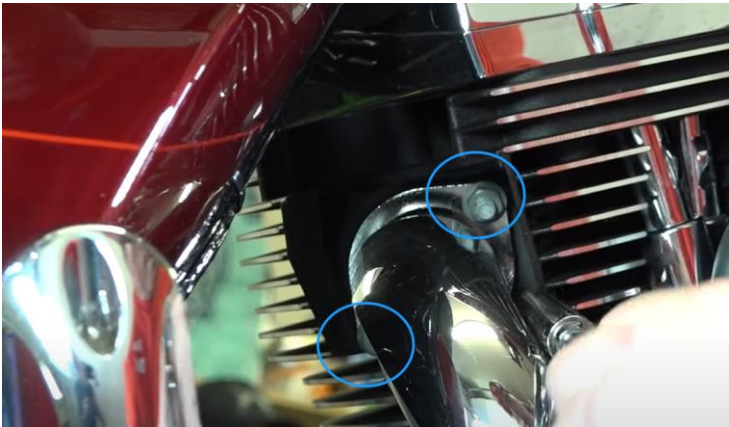

**Figure 14**



**Figure 15**

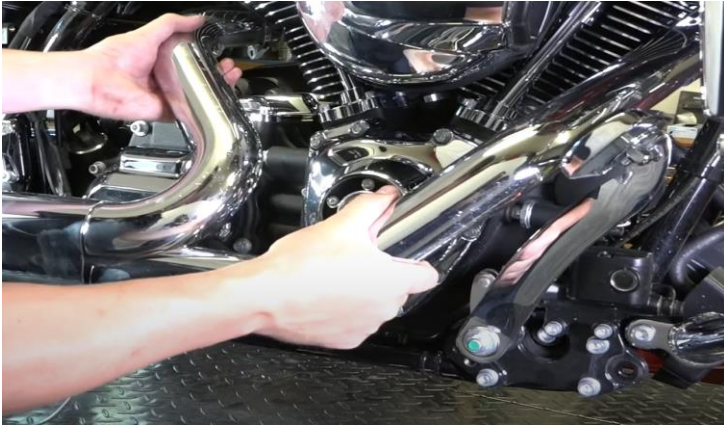

**Figure 16**

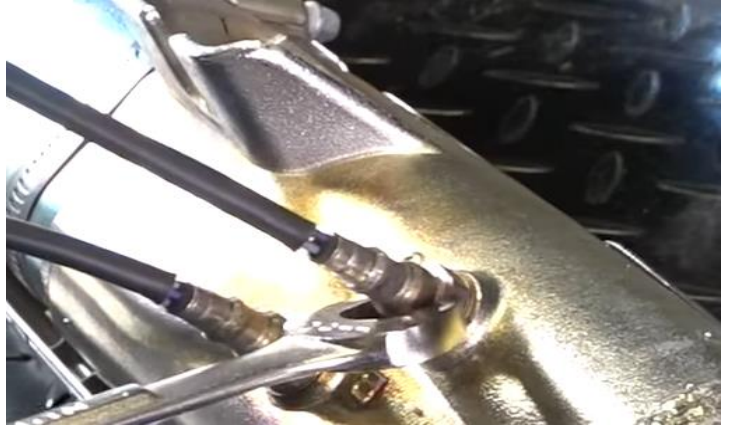



**Figure 17**



**Figure 18**



**Figure 19**

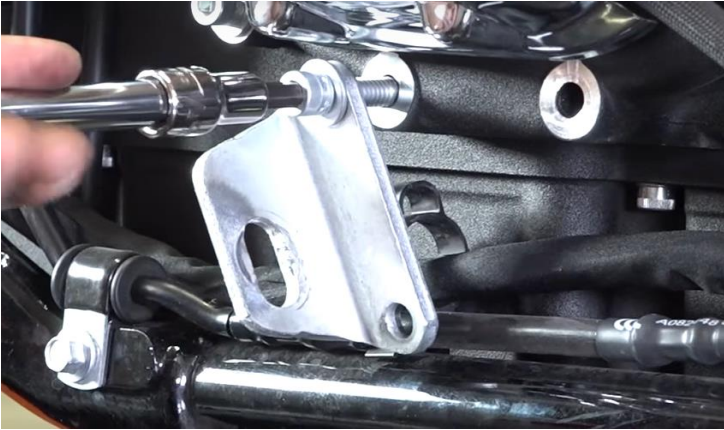

**Figure 20**



**Figure 21**



**Figure 22**



**Figure 23**



**Figure 24**





**Figure 25**



**Figure 26**



**Figure 27**

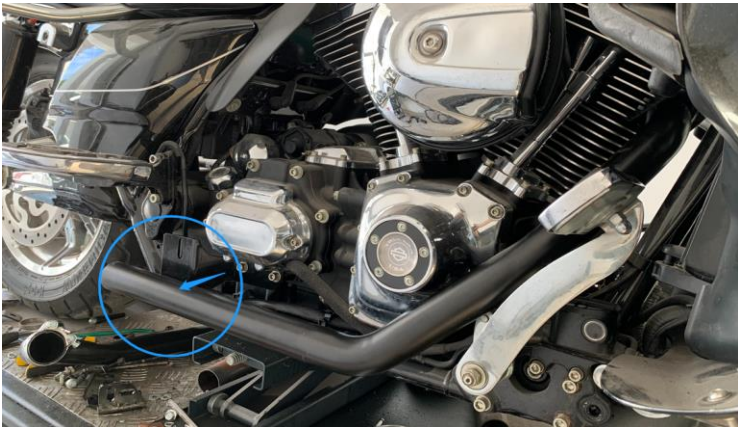

**Figure 28**

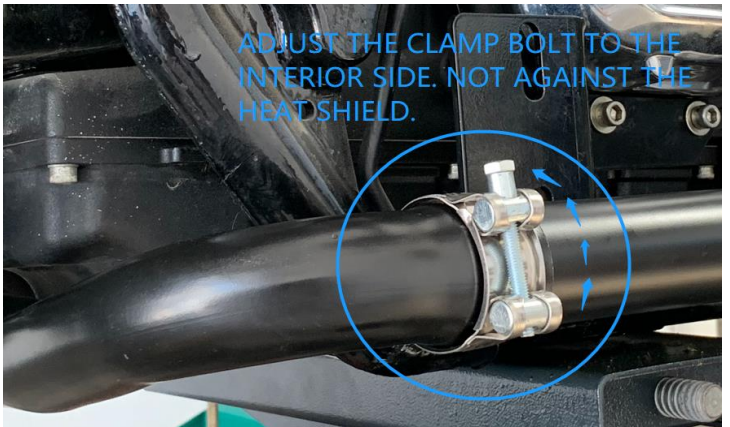

**Figure 29**

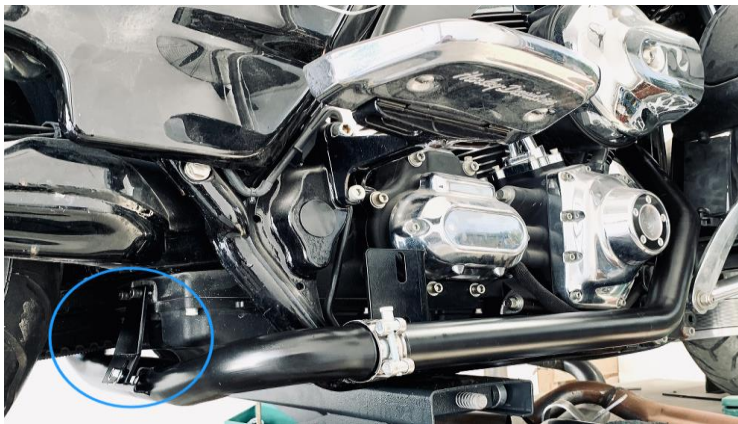

**Figure 30**



**Figure 31**

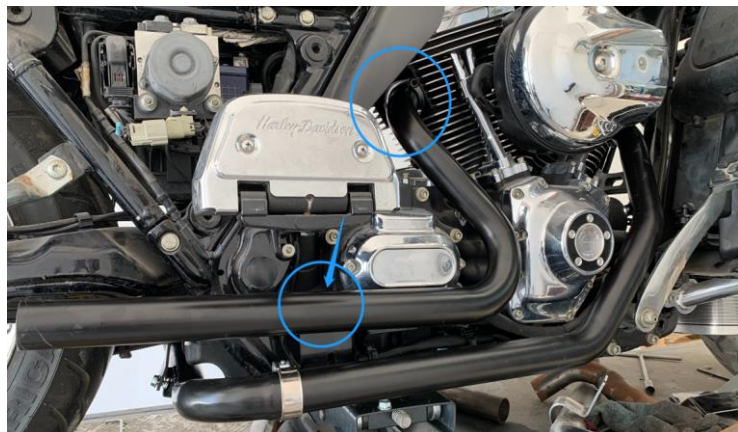

**Figure 32**

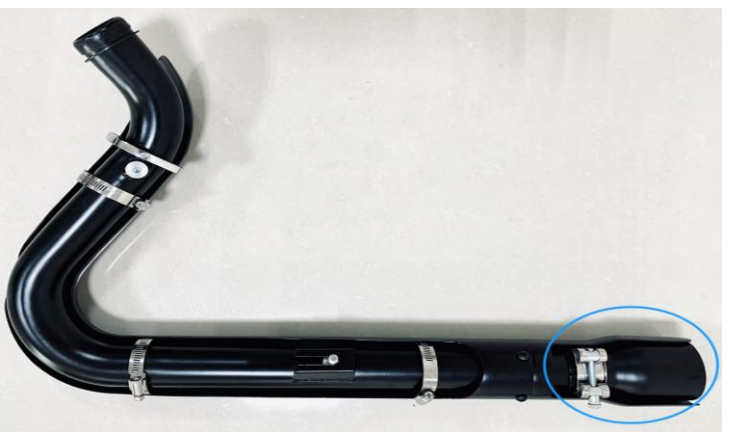



Figure 33

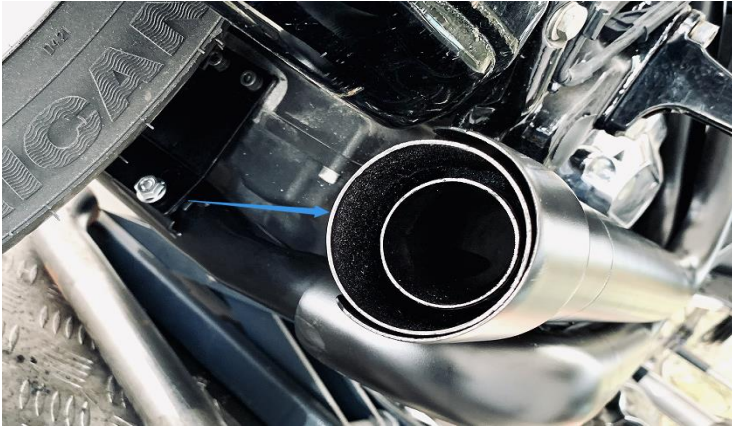

Figure 34

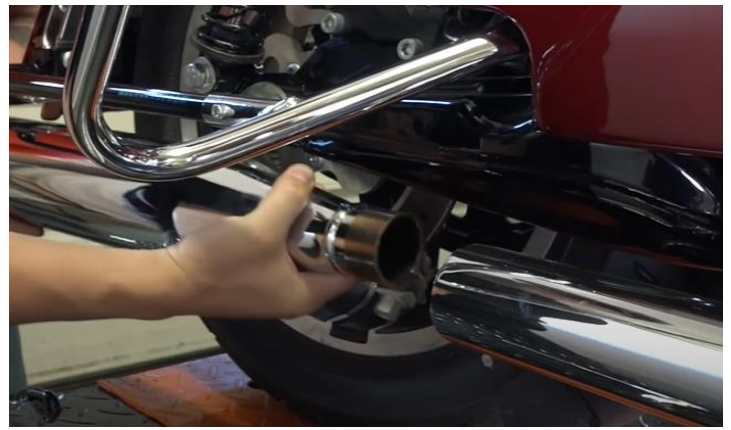

Figure 35



Figure 36



- 1. Please retuning your motorcycle immediately with Dyna Tuning Map after changing head pipes.**
- 2. Be sure to tighten all hardware before starting your engine. Retighten after the first 100 miles.**

**Discoloration:** DOES NOT WARRANTY ANY CHROME EXHAUST PRODUCTS AGAINST DISCOLORATION!

Discoloration is not a defect in chrome. All chrome exhaust systems will turn color. Chrome discoloration is a result of heat. The more heat the chrome is exposed to, the quicker and more severe the discoloration will be.

**Tuning:** It is strongly recommended by SHARKROAD. Better flowing, less restrictive exhaust will require more intake, so please consider upgrading your air cleaner along with your fuel-management system. Working with high-flow intake, Fuel Management system, and correct profession re-mapping, the bike would gain a more better performance.

**C.A.R.B.:** California does not allow the use of aftermarket exhaust systems that remove original equipment catalyts, (except for racing use only) unless the Air Resources Board has issued an Executive Order for that system.

**Returns:** When you want to return, please contact us in 72 hours after received the product so we can help you out immediately. We only accept return in 30 days after your order. International Return is not acceptable. For return shipping cost to our warehouse, If the product have quality or shipping damage issue, We will send you shipping label or pay the cost after you send out. If you don't like the product or buy by mistake, Buyer should stand this shipping cost.

**Warranty:** SHARKROAD products are warranted for one year against defects in material and workmanship. This warranty does not cover chrome discoloration or rust. Also SHARKROAD will not warranty any abused, misused, improperly installed or modified system.

**Wearing a helmet while riding is always recommended.**

**Please never go for a ride while under the influence of alcohol and/or drugs.**

**Enjoy the new voice and the fresh look of your motorcycle and ride safe.**