

MPC150 Wireless Indoor Pet Barrier



www.mypetcommand.com

Email: - Sales@mypetcommand.com Tel USA: - 888 686 6495

Tel Australia: - 1300 416 703

Tel UK: - 020 3936 1156

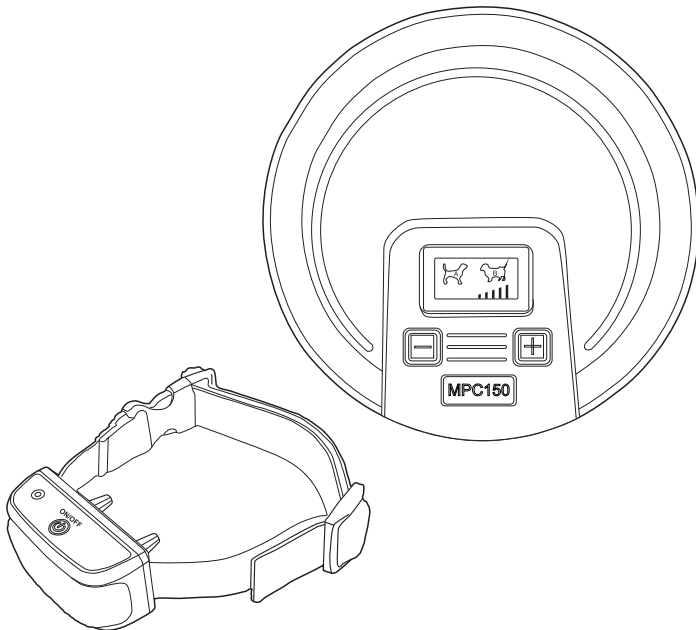

operating and training guide

PLEASE READ THIS ENTIRE GUIDE BEFORE BEGINNING



Important Safety Information

Explanation of Attention Words and Symbols used in this guide



This is the safety alert symbol. It is used to alert you to potential personal injury hazards. Obey all safety messages that follow this symbol to avoid possible injury or death.

WARNING

WARNING indicates a hazardous situation which, if not avoided, could result in death or serious injury.

CAUTION

CAUTION, used without the safety alert symbol, indicates a hazardous situation which, if not avoided, could result in harm to your pet.

NOTICE

NOTICE is used to address safe use practices not related to personal injury.

WARNING

Not for use with aggressive dogs. DO not use this product if your dog is prone to aggressive behavior. Aggressive dogs can cause severe injury or death to their owners and others. If you are not sure that this product is right for your dog, please talk to your veterinarian or a certified trainer.

CAUTION

This System is NOT a solid barrier. The system is designed to act as a deterrent, using Static Correction to condition pets to remain outside of the established barrier area. It is important that you reinforce training with your pet on a regular basis. Since the tolerance level to Static Correction varies from pet to pet, We CANNOT guarantee that the system will in all cases keep a pet outside of the established barrier area. Not all pets can be trained to avoid entering the barrier area. Therefore, if you have reason to believe that your pet may harm himself or pose a danger to others if he is not kept from entering the barrier area, you should NOT rely solely upon this system to restrict your pet. We shall NOT be liable for any personal injuries, property damage, injury to or death of your pet, economic loss or any consequential damages sustained as a result of any animal entering the barrier area.

CAUTION

Proper fit of the collar is important. A collar worn for too long or made too tight on the pet's neck may cause skin damage. Ranging from redness to pressure ulcers; this condition is commonly known as bed sores.

- Avoid leaving the collar on the dog for more than 12 hours per day.
- When possible reposition the collar on the pet's neck every 1 to 2 hours.
- Check the fit to prevent excessive pressure; follow the instructions in This manual.
- Never connect a lead to the electronic collar; it will cause excessive pressure on the contacts.
- When using a separate collar for a lead, don't put pressure on the electronic collar
- Wash the dog's neck area and the contacts of the collar weekly with a damp cloth
- Examine the contact area daily for signs of a rash or a sore.
- If a rash or sore is found, discontinue use of the collar until the skin has healed.
- If the condition persists beyond 48 hours, see your veterinarian.

These steps will help keep your pet secure and comfortable. Millions of pets are comfortable while they wear stainless steel contacts. Some pets are sensitive to contact pressure. You may find after some time that your pet is very tolerant of the collar. If so, you may relax some of these precautions. It is important to continue daily checks of the contact area. If redness or sores are found, discontinue use until the skin has fully healed. You may need to trim the hair in the area of the Contact Points. Never shave the dog's neck; this may lead to a rash or infection.

- To prevent an unintended correction, do not perform set up procedures while the Receiver Collar is on your pet.
- If you are using a collar and leash for training, be sure the extra collar does not put pressure on the Contact Points of the Receiver Collar.

NOTICE

To avoid damage to the transmitter do not use on wet surfaces, in damp or wet locations or around swimming pools. This product is designed for indoor use only. Do not expose to rain or snow.

Table of Contents

Components	5
Other Items You May Need	5
How the System Works	6
Key Definitions	8
Operating Guide	9
Install the Barrier Transmitter	9
Set Up the Barrier Transmitter	9
Test the Barrier Area	10
Fit the Receiver Collar on Your Pet	11
To Re Thread the Collar	12
Charge the Receiver Collar	13
To Turn Collar on	13
Additional Features	13
Time Out Feature	13
Mode A, B, and AB Feature	13
Programming the Mode Settings	15
Training Guide	16
Begin Your Pet's First Session	16
Further Training.....	16
Additional Information	16
Troubleshooting	17
Warranty	17

Components

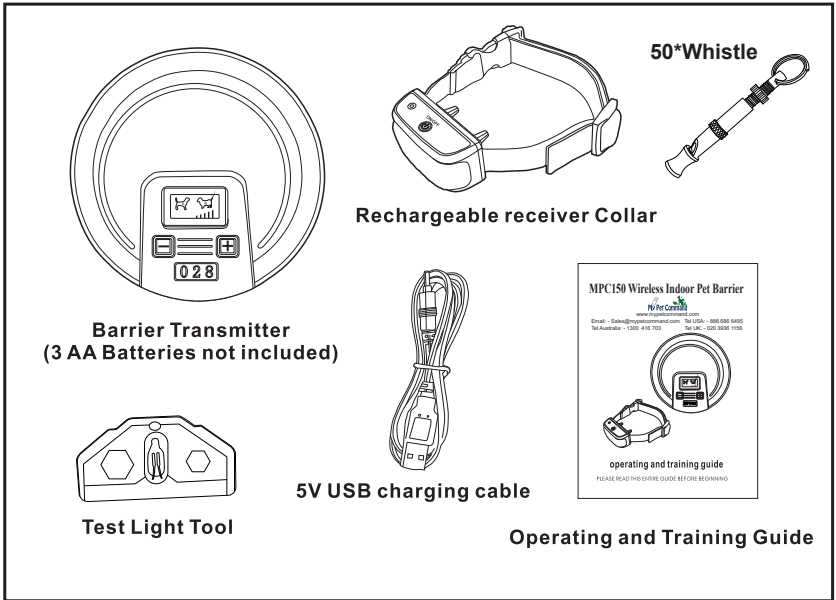

Other Items You May Need

- Drill and mounting hardware
- Non metallic collar and leash
- Scissors
- Lighter

How the System Works

The MPC150 indoor pet barrier keeps your pet away from a certain room, away from trash, off of furniture etc.... just Place the barrier transmitter near the area your pet should avoid. The Barrier Transmitter creates a circular radio signal hidden fence adjustable from approx 1-8 ft in Radius. When your Pet enters the Hidden fence area, the collar will sound warning tone first and then Depending on the mode the collar is set to will either provide safe static corrections via the contact points on the collar or tone only to train and keep your pet away from the desired area.

Charging The Collar: -Charge the collar by removing the circular Screw and use the Charging Cable provided and connect to any Standard USB power port (5VDC) such as wall adapter, cell phone Charger, PC USB Port Etc.... always allow approx. 3-4 Hours continuous charge of the collar and ignore any of the charging light indicators when charging the collar. Please note when plugging in the collar to charge, the collar will always turn to the OFF Position automatically even if the collar is on before plugging in the charging cable. After charging the collar fully, remove the Charging cord and screw back the cover and turn the collar on by long pressing and holding down the on/off button for 2-3 seconds. When you see solid or Flashing LED Light on the collar, the collar is in the ON Position

Turning Collar ON/OFF: - To turn the collar ON or OFF Press down on the ON/OFF button for 2-3 seconds (Long Hold). One Beep turns the collar ON. And when you Hear 2 Beeps, the collar turns OFF. Please Note whenever the collar is Turned ON within 5 Feet of the Barrier Transmitter box when Barrier TX Box is ON, the collar will be Matched to MODE A or MODE B or MODEA/B depending on the switch position on the barrier box. Refer to Section "Programming the mode settings" further in the manual for more info.

If you don't want to change the collar's pairing Channel when turning on, always switch on the collar at least 15 FT away from the TX Box etc....

Collar Modes (Dual Function): - The collar has a **dual function, Mode.**

Mode 1: (Tone + Static correction): - When Collar is on and is in Mode 1 the LED will Blink once every 5 seconds

Mode 2: (Tone only): - When Collar is ON and is in Mode 2, LED will blink twice every five seconds.

To toggle/Change from either mode, short press the on/off button each time

For Mode 1: - when collar enters the radio hidden fence boundary area the collar will work as follows: -A warning beep is emitted at 0 to 4 seconds, a beep + shock is emitted at 4 to 60 seconds, only a warning beep is emitted at 60 to 90 seconds, a second beep + shock is emitted after 90 to 150 seconds, only a warning beep is emitted at 150 to 180 second, a second beep + shock is emitted after 180 to 240 seconds, and only a warning beep is emitted after 240 seconds so collar is perfectly safe for your pet to use If the dog leaves the signal fence and then enters the fence again, the same cycle starts all over again

For Mode2: - there is no shock/static correction, collar to beep all the time if the pet enters the hidden area.

Choose the appropriate mode as required for your pet. Tip: - You May want to start with Mode 1 first and once your pet is fully trained, you may want to have it on Mode 2 if your pet can stay away from no go zone with audible tone only. Use Metal Prongs for Shock and use the silicone covers if you don't want metal to touch dog skin. The Silicone covers will still allow the static correction to go through. If you don't want any static correction use plastic covers or use the collar in mode 2.

Please note the MPC150 Pet Barrier has been proven safe, comfortable and effective for pets at least 6 months old weighing in at 5 pounds or more. It is not recommended that any pet wears these type of collars for more than 12 hours at a time. Collars are IP54 waterproof rated only and can handle light rain etc.... but dogs cannot swim with these collars

Turning ON/OFF Barrier Transmitter box and adjusting fence Radius Range: - Turn Barrier Transmitter box on by pressing the + Key on the box. Adjust range by increasing or decreasing with + and – Keys. To Turn off the Barrier Box, press – Key till the LCD Display goes off
Barrier Transmitter Box Batteries and running time: - Always Use 3 x New Good Quality AA non rechargeable type Batteries in the form of either alkaline or lithium type. If the Transmitter box is Left in the ON position all the time, you should get approx. 1.5 months' worth of Battery time before the Batteries need to be replaced on the transmitter box.

Collar Battery run Time: - If Collars are left on all the time, you should get approx. 3-4 days Battery life from the collar before you will need to recharge the collar again with the supplied USB Charging Cord.

To Conserve Battery, always switch of both the collar and the barrier transmitter box when not in use.

Key Definitions

Barrier Transmitter: Transmits the wireless radio signal

Barrier Area: Area that you want to prevent your pet from gaining access to

Receiver Collar: Receives the radio signal from the Barrier Transmitter.

Contact Points: deliver the safe Progressive Static Correction when your pet enters the Barrier Area

Progressive Static Correction (Mode 1): - when collar enters the radio hidden fence boundary the collar will work as follows: -

a warning beep is emitted at 0 to 4 seconds, a beep + shock is emitted at 4 to 60 seconds, only a warning beep is emitted at 60 to 90 seconds, a second beep + shock is emitted after 90 to 150 seconds, only a warning beep is emitted at 150 to 180 seconds, a second beep + shock is emitted after 180 to 240 seconds, and only a warning beep is emitted after 240 seconds so collar is perfectly safe for your pet to use

If the dog leaves the signal fence and then enters the fence again, the same cycle starts all over again

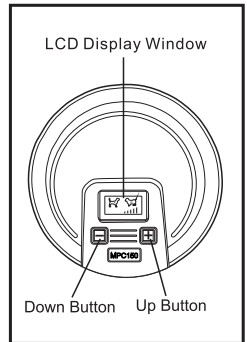
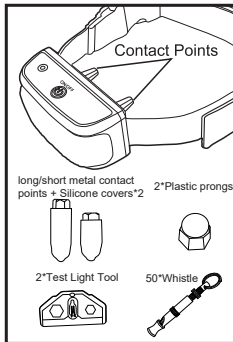
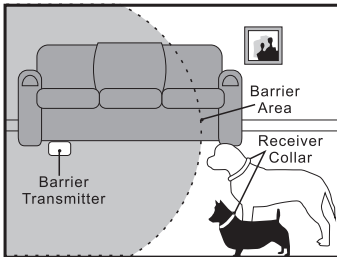

Step 1 **Operating Guide**

Install the Barrier Transmitter

The Barrier Transmitter emits a radio signal from all sides in a spherical pattern. The signal may transmit through a wall or the ceiling/floor. The Barrier Transmitter can be placed laying flat on a surface or hung on a wall. If you choose to hang the Barrier Transmitter, note that the signal becomes very directional- the signal will be strongest directly in front of and behind the unit. The signal is weakest to the side of the unit.

Do not:

- ◆ Hang unit on a metal wall
- ◆ Place Barrier Transmitter on metal surfaces
- ◆ Place Barrier Transmitter near large metal objects such as refrigerators, washers, etc.
- ◆ Place Barrier Transmitter near audio speakers

To keep the Barrier Transmitter in place on smooth surfaces

NOTICE To avoid damage to the transmitter do not use on wet surfaces, in damp or wet locations or around swimming pools. This product is designed for indoor use only. Do not expose to rain or snow.

Step 2 **Set Up the Barrier Transmitter**

CAUTION To prevent an unintended correction, never perform set up procedures while your pet is wearing the Receiver Collar.

1. Turn over the barrier Transmitter and open the barrier door. Install three AA alkaline batteries and replace the battery door.
2. Turn the Barrier Transmitter up and press the UP (+) arrow button once to turn ON the Barrier Transmitter. Dog A with a black bar will show on the LCD display window indicates that the Barrier Transmitter is set to mode A* (2A).
3. Each segment represents approximately two feet of diameter. You can create a Barrier Area of 2 feet in diameter up to 8 feet in diameter. Using the UP(+) AND DOWN(-) buttons, adjust the range to fit the desired pet Barrier Area.

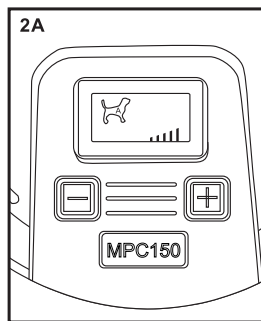

*All Indoor Barriers and Receiver Collars are preset to mode A. The A and B mode feature is designed to be used in multiple pet households where you may want one pet to be able to access an area while preventing access by another pet. For single pet households, you will not need to operate the Barrier Transmitter in any mode other than A. Please see the Additional Features section of this operating and training guide (beginning on page 11) for instructions on how to utilize mode A and B.

Step 3 Test the Barrier Area

4. Press and hold on/off button till 1 beeps to turn the receiver on.
5. Hold the Receiver Collar with the Contact Points facing up. Place the Test Light Tool on the Contact Points so that the wire in the Test light TOOL touches the Contact Points (3A) The on/off button/logo on the Receiver Collar should face the Transmitter.
6. Hold the Receiver collar at the approximate height of your dog's neck (3B). Start outside of the range and walk slowly toward the Barrier Transmitter AS you reach the Barried Area, the Receiver Collar emits a series of high pitched tones. For each tone you hear, you should notice the Test Light flashing which indicates that a Progressive Static Correction is being delivered. The Reviver Collar's tone is easily heard by dogs but may be at a volume level difficult for some humans to hear.
7. Check the range of the Barrier Area from multiple angles to ensure you are getting the desired coverage.

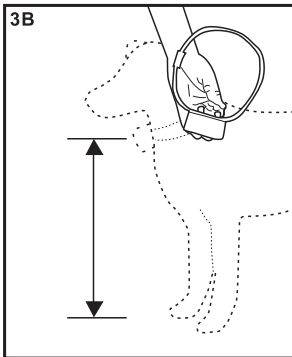
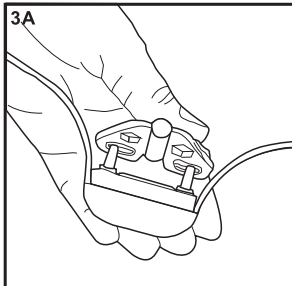

Note: Should you find that you are not getting the desired range at the maximum setting, move the Barrier Transmitter a few feet, or change from its standing-on end position to laying flat. Metal objects can alter the magnetic field and change the transmitting signal range. The effect on the range depends on the size and shape of the object Signal range can be reduced if the Barrier Transmitter is placed on a concrete floor due to steel reinforcement in the concrete For best range results, place the Barrier Transmitter on a nonconductive surface, i.e., wood floor or table. Placing the Barrier Transmitter beneath sofas and beds can reduce the range due to the metal springs altering the magnetic field.

Step 4 Fit the Receiver Collar on Your Pet

Important: Proper fit and placement of your Receiver Collar is necessary for effective operation. The Contact Points must have direct contact with your pet's skin on the underside of his neck.

CAUTION Proper fit of the collar is important. A collar worn for too long or made too tight on the pet's neck may cause skin damage Ranging from redness to pressure ulcers; this condition is commonly known as bed sores.

- ◆ Avoid leaving the collar on the dog for more than 12 hours per day.
- ◆ When possible reposition the collar on the pet's neck every 1 to 2 hours.
- ◆ check the fit to prevent excessive pressure; follow the instructions in this manual
- ◆ Never connect a lead to the electronic collar it will cause excessive pressure on the Contacts.
- ◆ When using a separate collar for a lead, don't put pressure on the electronic collar.
- ◆ Wash the dog's neck area and the contacts of the collar weekly with a damp cloth
- ◆ examine the contact area daily for signs of a rash or sore.
- ◆ If a rash or sore is found, discontinue use of the collar until the skin has healed.
- ◆ If the condition persists beyond 48 hours, see your veterinarian
- ◆ For additional information on bed sores and pressure necrosis, please visit our website.

These steps will help keep your pet secure and comfortable. Millions of pets comfortable while they wear stainless steel contacts. Some pets are sensitive to contact pressure. You may find after some time that your pet is very tolerant of the collar. If so, you may relax some of these precautions. It is important to continue daily checks of the contact area. If redness or sores are found, discontinue use until the skin has fully healed. You may need to trim the hair in the area of the Contact Points. Never shave the dog's neck; this may lead to a rash or infection.

To assure a proper fit, please follow these steps:

1. Make Sure the Receiver collar is fully charged, have enough power
2. Start with your pet standing comfortably (4A).
3. Place the Receiver collar on your pet so that The on/off button logo is facing your pet's chin. Center the Contact Points underneath your pet's neck, touching the skin. If your pet has a long or thick coat then it may be necessary to trim the hair around the Contact Points to make sure that contact is consistent.

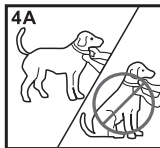

4. Adjust the tightness of the receiver Collar to fit your pet's neck. Check the tightness of the Receiver Collar by inserting one finger between the end of a Contact Point and your pet's neck. the fit should be snug but not constricting (4B),
5. Allow your pet to wear the Receiver Collar for several minutes then recheck the fit. Check the fit again as your pet becomes more comfortable with the Receiver collar
6. Once you are satisfied with the fit of the Receiver Collar then you may trim any excess collar strap as follows (4C):
 - a. Mark the desired length of the Receiver Collar with a pen. Allow for growth if your pet is young or grows a thick winter coat.
 - b. Remove the Receiver Collar from your pet and cut off the excess.
 - c. Before placing the Receiver Collar back onto your pet, seal the edge of the cut collar by applying a flame along the frayed edge.

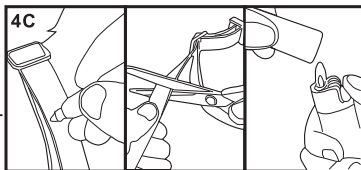
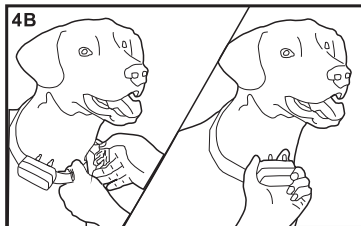

To Re-Thread the Collar

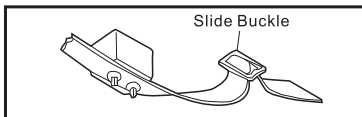

The slide buckle prevents the collar from becoming loose around your pet's neck.

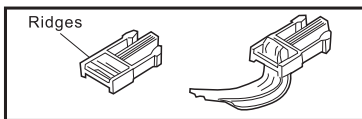

The ridges must be facing up; the collar will slip if it is not properly threaded.

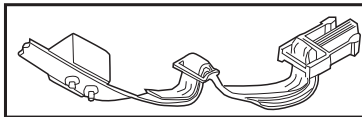

Charge the Receiver Collar

1. Use 1 Corn to open the plastic cover as arrow show.
2. Connect the Receiver Collar Charger with the USB Charger.
3. Green light will flash when the charger is properly seated and charging.
4. If you get stable green light, it means fully charging (Normally charging 1 hour then fully charged).
5. Use 1 Corn to close the plastic cover as arrow show once fully charged.

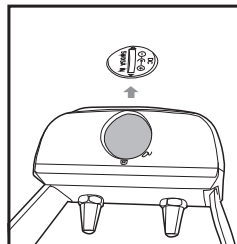
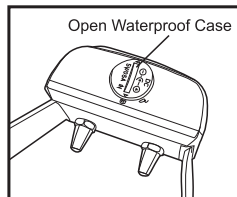

To Turn Collar on

Hold the ON/OFF button until it beeps once
To Turn Collar on.

Hold the ON/OFF button until it beeps twice
to turn off.

Additional Features

Mode A, B, and AB Feature

For multiple pet households, additional Receiver Collars can be purchased to work with one or more Indoor Barrier Transmitters.

You can set up an unlimited number of Barrier Transmitters in your home and an unlimited number of Receiver Collars can be used with one or more Barrier Transmitters. If you have multiple pets, you may want to allow one pet access to an area while denying access to another pet. With the purchase of additional Receiver Collars and Barrier Transmitters, you can accomplish this by using the Mode A and Mode B functions. All Indoor Barrier Transmitters and Receiver Collars come preset to mode A. Each Receiver Collar can operate in one of two different modes—A or B. Each Barrier Transmitter may be set to either A, B or AB mode to allow for multiple configurations.

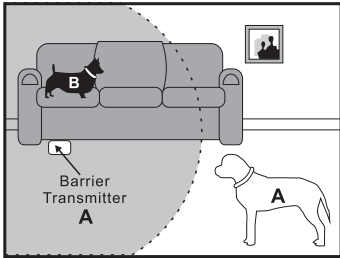

When the Barrier Transmitter and Receiver Collar are set to mode A, the Barrier Transmitter denies access to pets wearing a Receiver Collar programmed to mode A. Receiver Collars set to mode B will not pick up the signal from a Barrier Transmitter set to mode A.

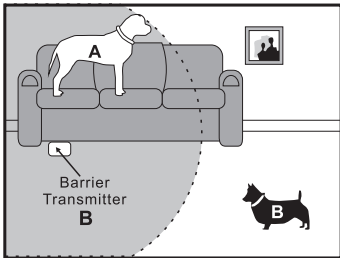

When the Barrier Transmitter and Receiver Collar are set to mode B, the Barrier Transmitter denies access to pets wearing a Receiver Collar programmed to mode B. Receiver Collars set to mode A will not pick up the signal from a Barrier Transmitter set to mode B.

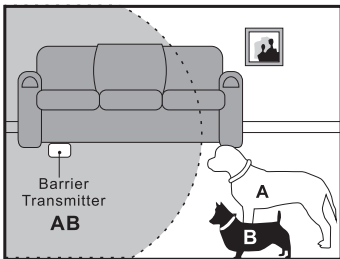

When the Barrier Transmitter is set to mode AB, the Barrier Transmitter denies access to all pets wearing the Receiver Collar, no matter which mode the receiver is programmed to.

Programming the Mode Settings

All programming is done through the Barrier Transmitter and the programming is synchronized with the Receiver Collar. The Receiver Collar cannot be programmed separately from the Barrier Transmitter.

You may synchronize multiple Receiver Collars to a single Barrier Transmitter at one time.

However make sure any Receiver Collar you do not wish to synchronize is turned OFF during the programming procedure. Any collar that is within 5 feet of the Barrier Transmitter and turned ON may be reprogrammed. Familiarize yourself with the steps outlined below before attempting to program the Barrier Transmitter and Receiver Collar.

CAUTION To prevent an unintended correction, do not perform set up procedures while the Receiver Collar is on your pet

1. Gather the Receiver Collar(s) you wish to synchronize with the Barrier Transmitter. Turn the Receiver Collar(s) OFF and place less than one foot from the Barrier Transmitter.
2. Turn the Barrier Transmitter ON by pressing the UP (+) button until there is a dog and bar(s) displayed in the LCD window.
3. Push the switch to A, there is dog A and bar(s) displayed in the LCD window then start the receiver collar, it automatically enters into code matching mode in 15 seconds, If the receiver collar beeps, it means code match succeeds.
4. Push switch to B and use the above-mentioned method to match B receiver.
5. Once the Receiver Collar has been programmed, press the UP (+) arrow button to turn the Barrier Transmitter ON. Check to make sure the black bar(s) appear on the LCD screen indicating the mode you have selected (5B) and reset the Barrier Transmitter to the desired range.

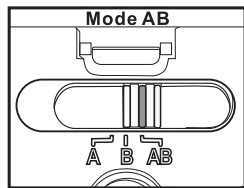
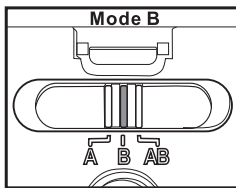
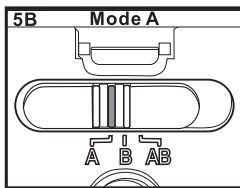
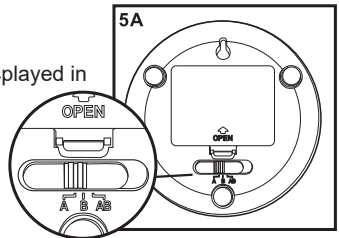

Training Guide

The MPC150 Indoor Pet Barrier operates on the principle of positive and negative reinforcement. Your pet will learn to avoid the Barrier Areas you have set after receiving a Progressive Static Correction (negative reinforcement) and your pet will learn that he is more comfortable when he avoids the Barrier Areas (positive reinforcement). In some cases, it may not be necessary to train your pet. You can let your pet wander freely to determine the new boundaries. Monitor your pet during his first session, Pets learn at different rates and it may take several times for your pet to successfully understand and honor the Barrier Areas,

Begin Your Pet's First Session

1. Move your pet away from the Barrier Area.
2. Turn the receiver collar ON.
Place the Receiver Collar around your pet's neck. Be sure that the Receiver is directly under your pet's neck.
3. Allow your pet to wander freely to learn the new boundaries.

Further Training

If your pet is confused or unsure how to avoid the Barrier Areas then you may need to teach your pet how to do so by following these easy training steps:

1. Place a second non metallic collar on your pet ABOVE the Receiver Collar and attach a long leash.

CAUTION Be sure the extra collar does not put pressure on the Contact Points of the Receiver Collar.

2. Walk your pet toward the Barrier Area. As soon as you hear the tone or you see that your pet is receiving a Static Correction, gently pull him away from the Barrier Area and back into the safe zone.
3. Reward your pet with praise each time he leaves the Barrier Area.
4. Practice this technique a few times until you feel that your pet is mastering avoidance of the Barrier Areas.

Be sure to never force or entice your pet to enter the Barrier Areas.

Additional Information

- ◆ The system should only be used with healthy pets, Contact your veterinarian if you have concerns about the medical condition of your pet (medication, pregnant, heart conditions, etc).
- ◆ This system is not for vicious or aggressive pets. If your pet may pose a threat to others, **DO NOT USE THIS SYSTEM**. If you are unsure if your dog is aggressive, please consult your veterinarian or a certified trainer.

Troubleshooting

Barrier Transmitter does not appear to work,	<ul style="list-style-type: none">◆ Check segment indicator on Barrier Transmitter.◆ Check/replace batteries in Barrier Transmitter◆ Increase the Barrier Area range on the Barrier Transmitter.◆ Check that the Barrier Transmitter setting corresponds to the Receiver Collar setting, (i.e. Barrier Transmitter is set to mode A and Receiver Collar is synchronized to pick up mode A)--refer to Additional Features section beginning on page 11 for instructions.
Barrier Area range is too low	<ul style="list-style-type: none">◆ Make sure the receiver collar have enough power◆ Adjust Barrier Transmitter range to increase Barrier Area size.
Barrier area range is too high.	<ul style="list-style-type: none">◆ Adjust Barrier Transmitter range to decrease Barrier Area size.
Pet seems to receive no stimulation.	<ul style="list-style-type: none">◆ Make sure the receiver collar have enough power◆ Use Test Light Tool to check for static correction.◆ Check Receiver Collar fit to ensure Contact Points have direct skin contact.◆ Check the setting on the Barrier Transmitter.
Unable to hear Receiver Collar tone.	<ul style="list-style-type: none">◆ Make sure the receiver collar have enough power◆ Pets easily hear tone but it may be a volume level that is difficult for you to hear◆ Use the Test Light Tool to check Receiver Collar for static correction.
No segments on Barrier Transmitter.	<ul style="list-style-type: none">◆ Press the UP (+) arrow button◆ Check/replace batteries in Barrier Transmitter.

Any Help/support make contact with us at:



www.mypetcommand.com

Email: - Sales@mypetcommand.com

Tel USA: - 888 686 6495

Tel Australia: - 1300 416 703

Tel UK: - 020 3936 1156