

Instructions for Use My Pet Command PET DRYER MPC2800



**My Pet Command**



USA 888 686 6495

Australia 1300 416 703



Sales@mypetcommand.com

◆ Instructions for use:

Open the dryer box, take out the dryer, and check there is no damage; go on with following steps:

1. Place or fix the dryer, connecting the hose with connection screw, fastening clockwise with 45 degree.



2. Plug in the dryer (please make sure the power supply voltage matches the voltage as marked on the machine);



4. If the motor does not work after plug into power and switching the machine ON, please turn off heat switch immediately to avoid damage to heating element.

5. Do not let minors and children be close to or to play with the machine!

Maintenance Instructions

1. The shell of the machine can be cleaned with a soft cloth and neutral detergent solution (to avoid spoiling the paint work) then use a dry cloth to clean it;

2. Use water or strong fan to clean the filters regularly. Note that filters cannot be put back into the machine until it is totally dry, as the water may damage the machine.

3. When the machine runs out of the internal carbon brush, Please take it to professional service centre to replace with new Carbon Brush.

Product Features and Parameters

See the label of the machine.

Functions & Features

1. Soft Start:

Thanks to the protection from current buffers, when started, the dryers will not discharge any impulse current, exerting no adverse influence upon the neighbouring working electrical equipment.

2. Low Noise and Powerful Airflow

The specially-designed noise reduction devices at air inlets are conducive to improving the working environment, and has been designed to offer the lowest noise possible for its power ratio. With 10%-greater airflow than any other single-motor dryers, this model can dry your pets quickly and benefit the pet's health.

3. Full Function:

This model is especially designed with high speed setting, which can work at full speed, as well as minimum airflow and high-heat settings, which have all the functions of handheld dryer. Please adjust the front panel controls as required for your operation

4. Special Humanized Design

Plastic material for whole dryer shell makes the dryer more safely use after it turns on. Equipped with quick locking system for the hose connecting part, and this makes the dryer much convenient to install. Added handle on the hose to prevent from hot temperature after using long time.

1	Air outlet	3
2	Components for the heat-insulating cover	1
3	retractable hose	1
4	Front cover component	1
5	electric heating component	1
6	heat and radiation shield	1
7	motor stand	1
8	electric fan	1
9	anti-vibration pad for motors	1
10	case component	1
11	inner noise elimination cover	1
12	filter	1
13	trail cover	1
14	outer noise elimination cover	1
15	screw nuts for trail cover	1
16	power switch signal	1
17	power switch	
18	velocity adjustment knob	1

19	heating switch	1
20	heating signal	1

Structure Representation

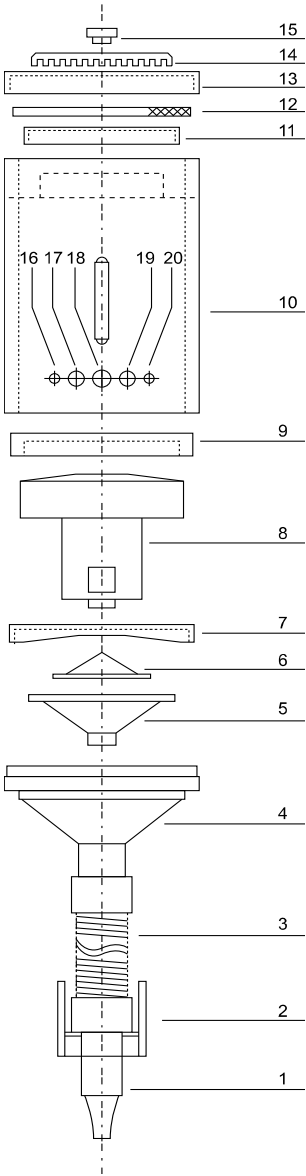

For any Help or Support Please contact us at



My Pet Command



USA 888 686 6495

Australia 1300 416 703



Sales@mypetcommand.com