

Bolt Together Flat Utility Bench

ASSEMBLY INSTRUCTIONS

TOOLS NEEDED:

- 1/2" WRENCHS
- 15/16" WRENCHS

DISCLAIMER:

RESISTANCE TRAINING, GYMNASTICS TRAINING, AND ACTIVITIES AT HEIGHT ARE POTENTIALLY DANGEROUS AND MAY LEAD TO SEVERE INJURY OR EVEN DEATH. THIS EQUIPMENT MUST BE USED BY COMPETENT AND RESPONSIBLE PERSONS OR UNDER THE GUIDANCE AND SUPERVISION OF COMPETENT PERSONS. BE SURE YOU ARE VERSED IN PROPER TECHNIQUE AND METHODS BEFORE USING ANY EQUIPMENT. THE USER ASSUMES ALL RISKS AND RESPONSIBILITIES FOR ALL DAMAGE, INJURY OR DEATH WHICH MAY OCCUR DURING INCORRECT USE OF THIS EQUIPMENT. SORINEX BEARS NO LIABILITY ABOVE REPLACEMENT VALUE OF THE EQUIPMENT IN QUESTION. BENCH COULD WOBBLE IF FLOOR IS NOT PERFECTLY LEVEL.

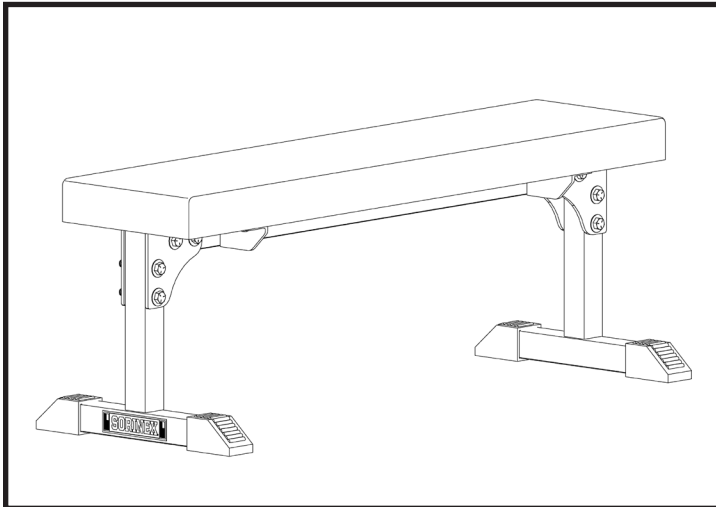

ITEM NO.	PartNo	DESCRIPTION	QTY.
1	003307	Bolt Together Flat Utility Bench - Spine (SORINEX)	1
2	003308	Bolt Together Flat Utility Bench - Base (SORINEX)	2
3	003310	Bolt Together Flat Utility Bench - Flange (SORINEX)	4
4	003301	Bolt Together Flat Utility Bench - Pad (SORINEX)	1
5	000045	2" x 2" Angled Rubber Foot	4
6	003318	5/8-11 x 3 3/4" Gr5 Hex C/S, Zinc	8
7	000527	5/8-11 Nylon Insert Hex Lock Nut Zinc	8
8	003317	5/8" SAE F/W, Zinc	16
9	000350	1/4-20 x 1-1/4" Gr5 Hex C/S, Zinc	4
10	000032	1/4" L/W, Zinc	4
11	000337	1/4" USS F/W, Zinc	4

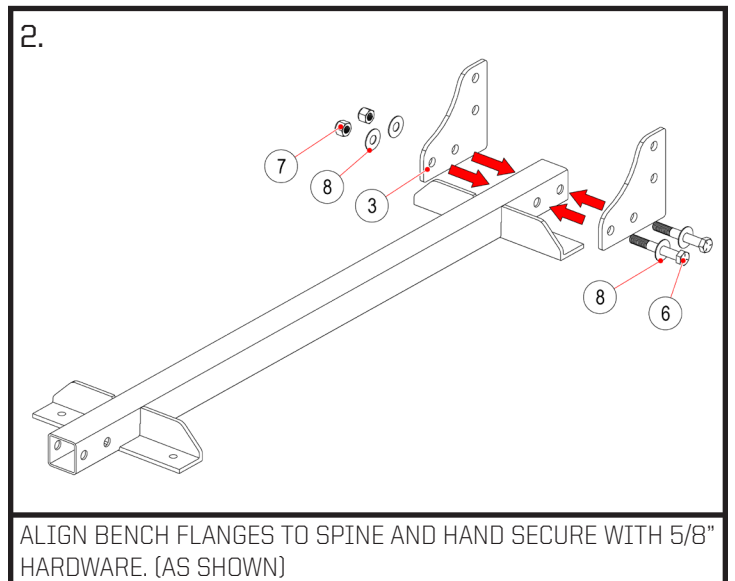
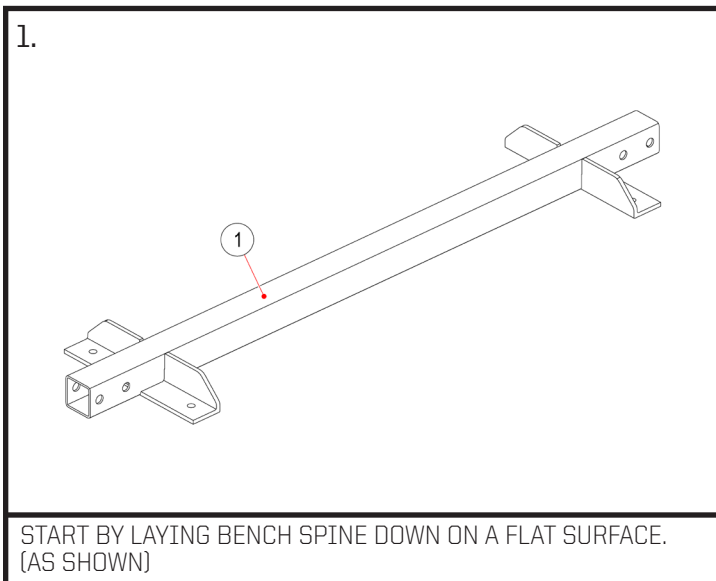

Sorinex Exercise Equipment | 193 Litton Drive | Lexington, SC 29073 | 1-877-SORINEX | info@sorinex.com
 THE INFORMATION CONTAINED IN THIS DRAWING IS THE SOLE PROPERTY OF SORINEX INC.
 ANY REPRODUCTION IN PART OR AS A WHOLE WITHOUT THE WRITTEN PERMISSION OF SORINEX INC. IS PROHIBITED.

3.

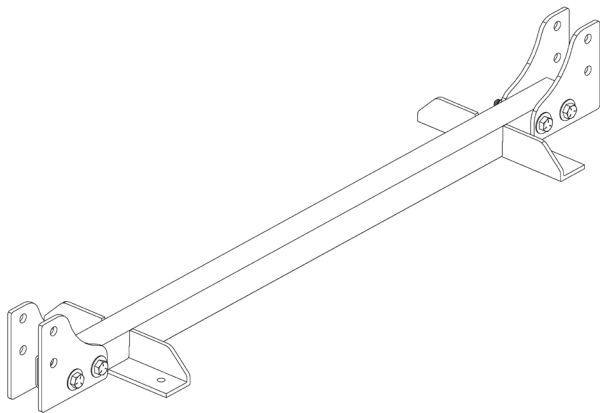

REPEAT STEPS FOR OTHER SIDE.

4.

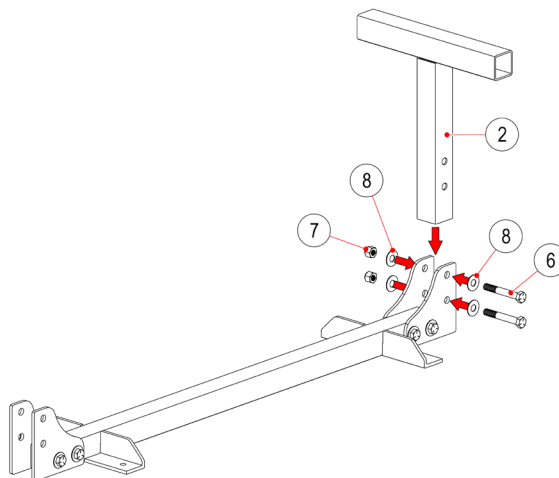

ALIGN BENCH BASE TO FLANGES AND HAND SECURE WITH HARDWARE. SORINEX BRANDING SHOULD FACE OUTWARD.

5.

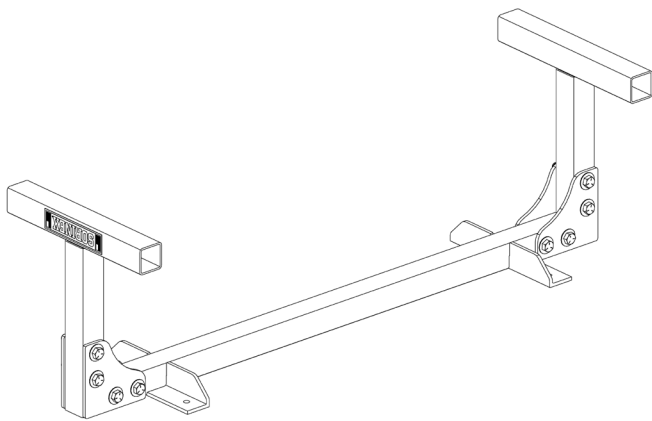

REPEAT STEPS FOR OTHER SIDE.

6.

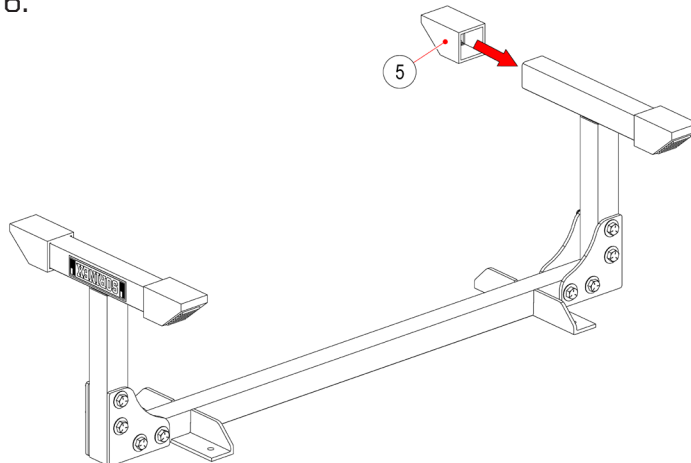

SLIDE ON RUBBER FEET TO BENCH BASE. (AS SHOWN)

7.

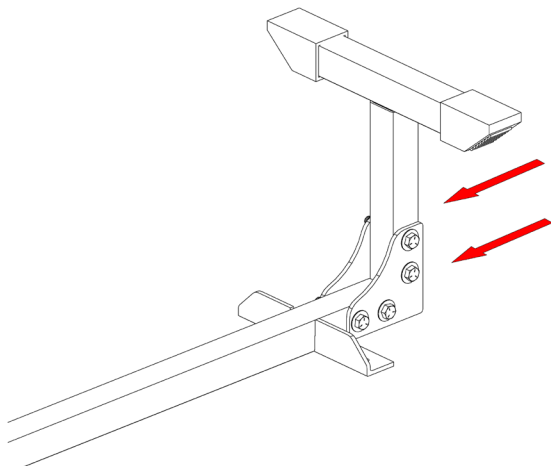

APPLY PRESSURE IN DIRECTION SHOWN. WHILE PRESSURE IS APPLIED, SECURE ALL 5/8" HARDWARE WITH 13/16" WRENCHES.

8.

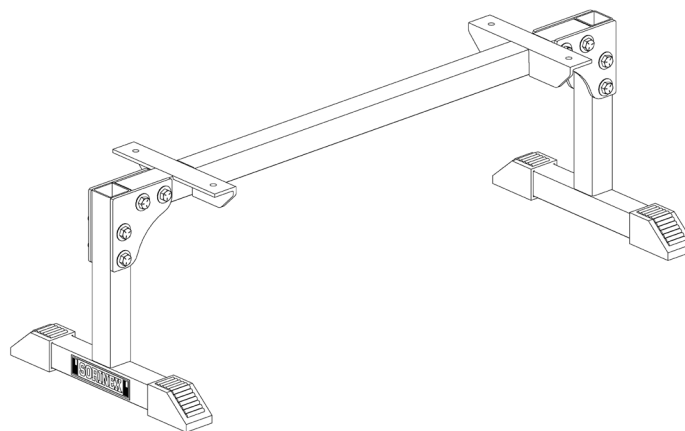

TURN OVER BENCH TO STANDING POSITION.

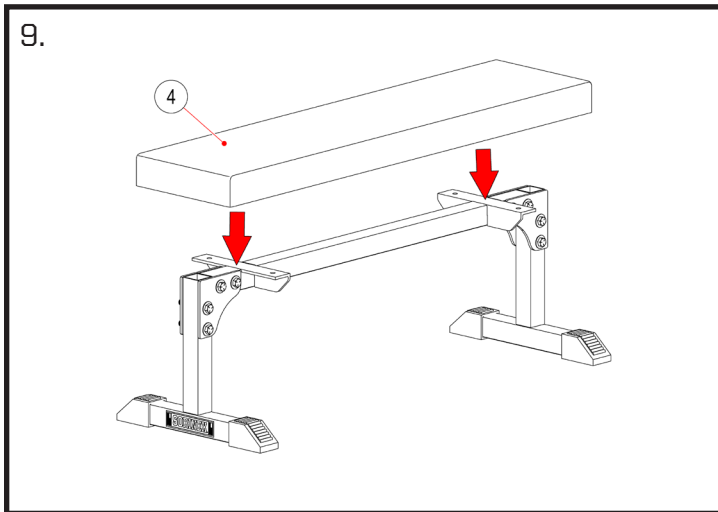

ALIGN PAD TO THE FOUR BOLT HOLES. (AS SHOWN)

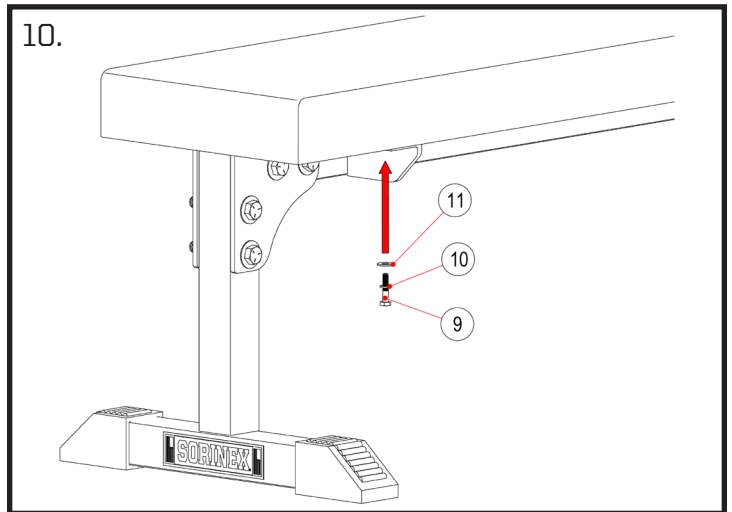

SECURE 1/4" HARDWARE WITH 1/2 WRENCH.

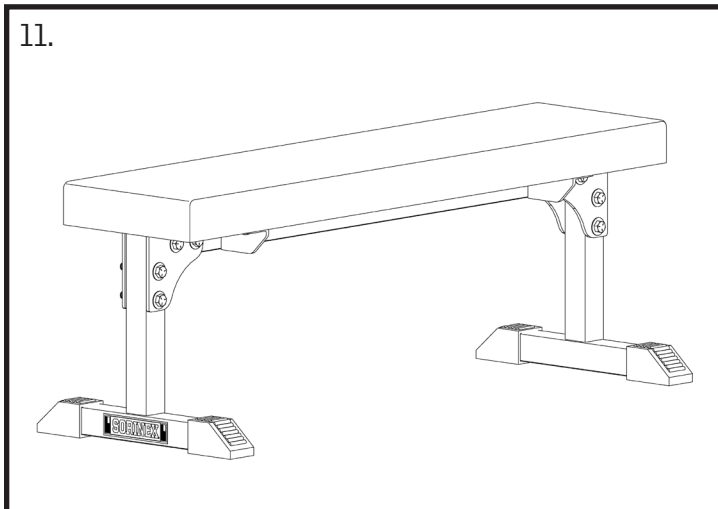

IF BENCH WOBBLER, LOOSEN 5/8" BOLTS. ALLOW BENCH TO SETTLE TO FLOOR, THEN RE-TIGHTEN BOLTS.