

Catalogue

Contents

Important Safety Instructions	1
Safety attention	2
Use attention	6
Remote control instructions	8

Use instruction

Confirmation before use	10
Method of use	11
Note of use	12

Cleaning and maintenance method

Daily cleaning and maintenance	13
Disassembly and cleaning	14
When the nozzle function is weakened	15
Batteries of remote control replacement	15
Long time placement when not using	16

Dangerous of winter freeze	17
Fault judgement	18
Specification	19

Important Safety Instructions

Please follow the safe operation When using electronic products,
Include : Please read the instructions carefully before installation and use.

 Danger - In order to reduce the possibility of electric shock

1. Please do not put the produce to the wet place.
2. Please do not put the remote control into the water.
3. Please do not spray water into the product or plug part.

 Warning –In order to prevent burning, electric shock, fire and the possibility of injury.

1. Please adjust the temperature to the lowest or close off the seat temperature when the children & people who is not sensitive to temperature.
2. Please do not use the company's subsidiary equipment, products are limited to the function listed in this specification.
3. Please do not continue use our produce and send it to the designated maintenance center for inspecting, repairment or adjustment when the line or the plug of product is damaged or fault, the product is damaged or fell into the water.
4. Please confirm the line is good.
5. Please do not use this produce in sleep.
6. Please do not put any other produce on to the produce rim & pipe.
7. Please do not use our produce outside.





Please keep this safety instructions

Safety Precautions

Please obey **Please read the safety precautions carefully and obey the content of safety precautions after use.**

Mark and meanings as follows

For example: Mark specification

 Warning	It is possible to cause serious injury or death if not obey and operate the safety precautions		 NO disassembly, it means should not do.
 Attention	It is possible to cause serious injury or property loss if not obey and operate the safety precautions		 Obey, it means should be do

Warning



Please don't put the water or detergent into the produce body or power plug. It is possible to cause a fire or an electric shock. NO water, it is possible to cause the toilet damage.

This product belongs to electronic products, please do not install in damp places. Please install the exhaust fan in order to keep the air dry & circulation when the bathroom use.

It is possible to cause a fire or an electric shock

The socket for the power wiring is as follows

It is possible to cause a fire or an electric shock if you do not follow the operation.

a. Please use the high sensitive and fast electric switch (Rated induction current below 15mA) or insulated transformer (below 1.5KVA and 3KVA) for protection

b. Socket installation should be sure to 0.3m above the ground, please try to stay away from the bathtub.



The ground wire of produce must be grounded. It is possible to cause an electric shock if the ground wire of produce is not grounded.

When the bathroom use

Please confirm that the power plug has been used for waterproofing silicone. It is possible to cause a fire or an electric shock if you not do the waterproofing.

Warning



NO used in damp places.
It is possible to cause a fire or an electric shock



NO disassembly
It is possible to cause
a fire or an electric shock



NO wet hands
It is possible to cause
an electric shock



**NO damage the power
cord or the seat connecting
line** It is possible to cause
a fire or an electric shock



NO use when the produce fault.
When the following conditions
happen, pull out the power plug,
close the water inlet valve.

Include:

- * Produce body leak
- * Produce body crack
- * Abnormal sound
- * Produce temp abnormal high
- * Toilet block



**NO use the multiple
power plug.**
It is possible to cause
a fire or an electric shock



**Use the electricity
220v**



**NO use the Instable power
plug.** It is possible to cause
a fire or an electric shock



**NO use other warter
except tap water**

Attention





Attention to low temperature burning.

Please adjust the temperature of the toilet to the normal gear when you sit for a long time.

Please adjust the temperature of the toilet to the normal gear who can not control the temperature & children.

Warning

 NO fire near the produce

 Please not use fingers or other objects into or blocking the warm air outlet Please not put the hand or clothes to the warm air outlet and It is possible to cause burning or an electric shock.

 Please do not stand on or put on the heavy objects on the seat, cover or body, it is possible to damage the toilet or hurt people



 Please use the diluted kitchen detergent (neutral) and not use the produce as below (Toilet detergent Residential detergent / gas / Banana oil / Decontamination powder etc)

 It is not allowed to move the water inlet filtering net or the plug when the water inlet angle valve is opened.

 Please do not distort or damage the inlet hose.

 Please do not wash anything except the excrement or urine.



 Please pull out the plug when you don't need it for a long time.

 Please close the water inlet angle valve and stop the water When leakage happens.

 Please tigh it firmly when install the water filter net

 Please increase the temperature of the toilet for warming to prevent the damage caused by freezing



Please check and confirm the power plug is good.
NO use the Instable power plug. It is possible to cause a fire
or an electric shock
Please pull out the plug when you don't need it for a long time



Please check and confirm the power plug is good.
NO use the Instable power plug. It is possible to cause
a fire or an electric shock
Please pull out the plug when you don't need it for a long time



Please do not put the produce on the sunshine.
It is possible make the produce change the colour or grack.

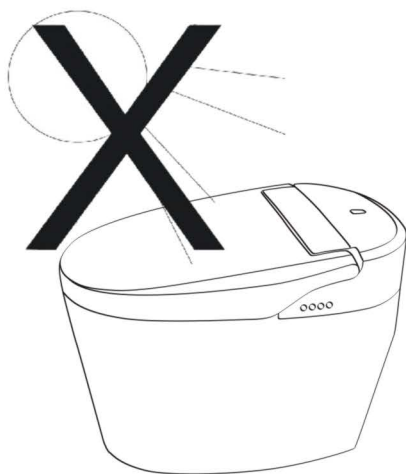

Use attention

Please observe the following 

The reason of damage

Please do not use a dry cloth or toilet paper and other products to wipe the body (not include porcelain) and toilet cover



NO wash by water



The reason of failure

Please do not pour the urine on the body and the nozzle.

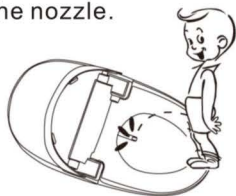

Please pull out the power plug when it is thunder



Bad action

Please do not cover the sensor of the seat, the human body detection sensors and the sending and receiving signals of the remote control

Please do not lean back against the toilet lid.

It is possible to damage the cover

Please observe the following 



Please increase the temperature of the toilet for warming to prevent the damage caused by freezing

Please do not put heaters near the produce
It is possible make the produce change the colour or crack.

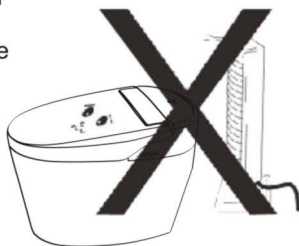

Please do not rough open the toilet cover

Remote control instructions



Power: ON / OFF

Stop: Stop the function being executed

Light: when the power-on, Light on/ Light off

Hip washing/lady washing / dry: On the function (Hip washing/lady washing 60 second / per time, dry 180 second / per time)

Wash position: Adjust nozzle comfortable for position clear Third gear cycle adjustment

Adjust: On the function, washing / dry divided into three for cycle water and wind

Move washing: Nozzle position repeated washing on the front and back, press this button to return to the origin location washing

Water temp /seat temp: Adjust water temp /seat temp, it divided into low / middle / high

Flushing: Automatic flushing porcelain

Confirmation before use

 Please confirm the following for the beginning

Insert the power plug into the socket

1. power plug: AC 220V

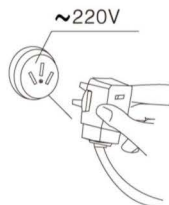

2. Confirm the following light



Confirm the water inlet valve is open

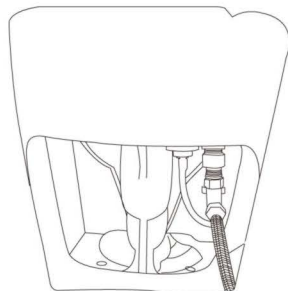
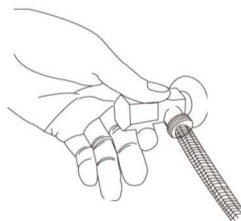

Confirm the inlet valve and reducing valve is open

 **Warning**



The ground wire of produce must be grounded. The power plug of the product have hree phase plug.

It is possible to cause an electric shock when failure or leakage occurs.

Confirmation before use

Confirmation before use

1. Use the water absorbent paper to check drying the water pipe whether leaking or not.
2. Press the seat with induction, whether there is a buzzer sound drops
3. Checking the washing /dry / deodorization/ automatic flushing is ok
4. Damping buffer is normal

Seat sensor position



Warning
Use the electricity 220v



Key operation instructions



Before use: Power: ON / OFF
Hip washing/lady washing: Adjust water temp /seat temp
Dry: Automatic flushing porcelain
After use: Stop: Stop the function being executed
Hip washing/lady washing / dry: On the function

Digital display panel instructions



Hip washing/lady washing / dry: On the function
Water temp /seat temp: Display water temp /seat temp
Shift:Display the shift of function

Note of use

Save function

It is effective to save energy as following
Put off the toilet cover

Don't adjust the water temp /seat temp to high shift

It is preferred to adjust the temp to the comfortable

Adjusted the temp depend on the season

Use a power saving device

Cut off the power when it is not use for a long time

Please increase the temperature of the toilet for warming to prevent the damage caused by freezing

Close the toilet seat and lid slowly

Automatic toilet have damping buffer device for protecting

Seat sensor

Because of the sitting sensor, it will not spray water spray even you make the wrong operation by pressing the switch when you are not seat,

will not spray water spray. The Hip washing/lady washing can not working when lady not seat on the toilet. The sitting sensor can not work if the following occurs

No sensor range if you seat outside of sensor device.

Water is leak out of the nozzle

Before and after cleaning or warm water switch is set at the time of opening, there is water around the sprinkler head, it is a normal phenomenon, not a failure



Please close the water valve and cut off the power and contact the seller when the water outflow.

Remote control

Please replace the battery in time if the light dimmed or no display

Daily cleaning and maintenance

Attention

Please cut off the power when cleaning and maintenance

The way of intelligent toilet clearing

Please use a soft and wet cloth to wipe it will become difficult to clean If it is not timely wipe, please use a soft and wet cloth to wipe
Water can prevent the generation of static electricity, and the static electricity adsorb dust, the toilet will become black & dirty

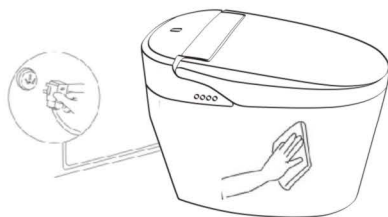

The way of nozzle maintenance

Please clean with a toothbrush if the nozzle is dirty.
Don't stretch, bend the nozzle.

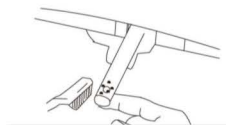

Warning



Please use the dry cloth to wipe the power plug after cut off the power.

Disassembly and cleaning

The way of disassembly

The way of the toilet cover disassembly

1. cut off the power plug

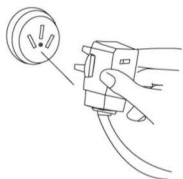

2. Close the water inlet angle valve and stop the water



3. Lift the lid of the toilet seat and remove it from the seat.



4. Put on the cushion gently

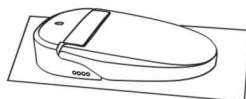

1. Cut off the power plug
The dry heater can cause fire.

2. Do not connect the power line or the water pipe by original. It is possible to cause an electric shock.

3. It should be carefully when you are disassembly and cleaning.

4. Do not pour the cover upside or directly on the ground.



When the nozzle function is weakened

When the nozzle function is weakened after use long time, Please clean the filter in the following

The way of filter cleaning

1. Close the water inlet angle valve and stop the water

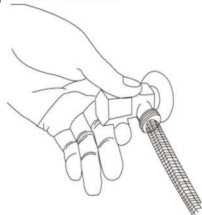

3. Please clean the filter with a toothbrush and water

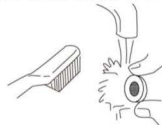

2. Take out the filter rotating



4. Put in the filter and tighten the water supply pipe



5. Open the water inlet

6. Reference Pg10

It should be close the water inlet angle valve when you disassemble filter
It should be tighten the water inlet angle valve when you disassemble install the filter.

Note: The positive and negative electrodes of the battery must be the same as the remote control.
Use the alkaline battery.

Batteries of remote control replacement

Please replace the battery in time if the light dimmed or no display.

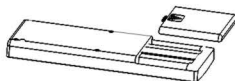

Long time placement when not using

Please drain the water when you travel or not live for a long time, the water will be freezing or contaminated, it is effect the toilet.

Ddrain the water and cut off the power plug

1. Close the water inlet angle valve and stop the water

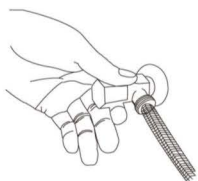

3. Connect to power

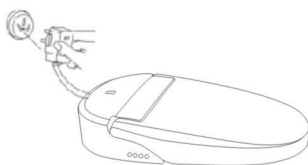

2.Ddrain the water from the hose



4. Be sure to try it again.

Be careful

When removing the water supply hose, be sure to close the water inlet valve and install the water supply hose. 

Easy to cause the leakage of indoor water.

If water hose or a water supply connecting part frozen, spray out the water, please soaked in hot water cloth covered the water supply tube and a water supply connecting part, the thaw, or increase the indoor temperature, until their natural thawing.

Be careful

Do not pour hot water or blowing hot air into the water supply hose, which may cause the damage of the main body water supply pipe.

Dangerous of winter freeze

In the cold winter, in order to keep the toilet running, please operation as below:
Please cut off the power plug



Normal prevent freezing measures

1. Adjust the water temp & seat temp high and cover the cover

b. Drain the water from the hose



2. Indoor heating
a. Close the water inlet angle valve and stop the water

c. Be sure to try it again



Be careful

When removing the water supply hose, be sure to close the water inlet valve and install the water supply hose.



Easy to cause the leakage of indoor water.

If water hose or a water supply connecting part frozen, spray out the water, please soaked in hot water cloth covered the water supply tube and a water supply connecting part, the thaw, or increase the indoor temperature, until their natural thawing.

Be careful

Do not pour hot water or blowing hot air into the water supply hose, which may cause the damage of the main body water supply pipe.

Fault judgement

Some failures can be eliminated by simple operation, please confirm following



Fault	Reason	Elimination method	
Nozzle without water	Power outlet not energized	Elimination method	
	Power is off	Confirm whether there is electricity	
	Power plug not inserted into socket	Open the power	
	Water valve is off	Power plug inserted into socket	
	Filter clogging	Open the water valve	
	Link inlet pipe blockage	Clean the filter	
	Not in a limited range of sensors.	Reorganize the link inlet pipe	
	Cleaning nozzle clogging		Adjust the range of sensors
			Clear the nozzle
Water supply hose is freezing	Please increase the temperature of the toilet for warming to prevent the damage caused by freezing		
Nozzle water is not warm	The water temp is not adjust to the appropriate range.	Press water temp shift and adjust the appropriate range	
Seat temp is not warm	The seat temp is not adjust to the appropriate range.	Press water temp shift and adjust the appropriate range	
Deodorant effect is not good	Dust clogging	Clear the the deodorant box and the suction inlet	

Specification

Category		Specification
Rated voltage		alternating current 220V $\pm 10\%$, 50HZ/60HZ
Power		1700W
Cleaning function	Hip washing	about 700ml / min
	lady washing	about 700ml / min
	Outlet temperature	normal atmospheric temperature、34℃、37℃、40℃ (4Stall)
	Warm water heating mode	Heat type
	Heater power	1600W
	Safety device	Water temp sensor, Temp fuse wire, Temp controller, Leakage protector
Dry function	Warm air temp	48℃、55℃、62℃ (3Stall)
	Wind speed	>4m/s
	Heater function	Average about 220W (Max about 350W)
	Safety device	Double metal sheet, Temperature fuse wire
Seat heating	Seat temp	normal atmospheric temperature、34℃、37℃、40℃ (4Stall)
	Heater function	about 50W
	Safety device	Temp sensor, Temperature fuse wire
Deodorant	Type	Activated carbon filter catalyst
Moving clearing		Move front to back about 1.5CM
Nozzle position		Adjust position
Temp of water supply		3~40℃
Static pressure of water supply		0.15-0.75mpa