



G-WALL

Introducing

G-ROOF

Modular Green Wall &
Green Roof System

Another Innovative
Solution from

 **PLATIPUS**
— The Professionals Choice —

CREATING URBAN GREEN SPACES

With urban areas continuing to grow around the world, the need to utilise the green spaces available is at an all-time high. The use of living walls and green roofs has become the established solution for maximising these urban green spaces and enjoying the many benefits that they bring.



From our world-famous D-MAN® anchor and structural systems, to our brand new G-WALL and G-ROOF solutions, Platipus is proud to be involved in the complete solution by offering these robust and effective products to assist the integrator with transforming green spaces.

BENEFITS OF URBAN GREEN SPACES

Where living walls and green roofs are effectively installed into the urban green space the benefits are significant:

Improved air quality

Living walls and green roofs are known to increase the oxygen levels, in both interior and exterior environments. Studies have shown that they can also reduce nitrogen dioxide and particulate matter by between 40-60%.

Sound insulation

Living walls reduce the sound levels both indoors and outdoors because of the foliage refracting and reflecting sound.

Reduction of energy costs

Living walls can absorb sun energy through a process known as evapotranspiration, keeping the area cool. Buildings with exterior living walls can be up to 20° cooler than their counterparts. The layer of thermal insulation also helps keep the building insulated during winter.

Aesthetic and protecting the building façade

A properly installed and maintained living wall will improve the look of any building. It will also add a layer of protection to the building's exterior walls from harsh elements such as sunlight, hail and rain.

Biodiversity

Living walls also become an extension of the natural environment for species of butterflies, insects and bees.



LIVING WALLS, RE-IMAGINED



G-WALL incorporates our already hugely successful and patented D-MAN® cell to ensure guaranteed strength and security for your living wall project. The modular nature of the G-Wall allows for incredibly simple vertical and horizontal expansion, using interlocking, omnidirectional cells with an individual cell capacity of 580ml.

These cells use 'jigsaw' integration rails and are easily connected using lightweight hand tools. This makes our system incredibly versatile so that anyone can start using the system straight from the box.

G-WALL SYSTEM

G-WALL Unit Assembly:

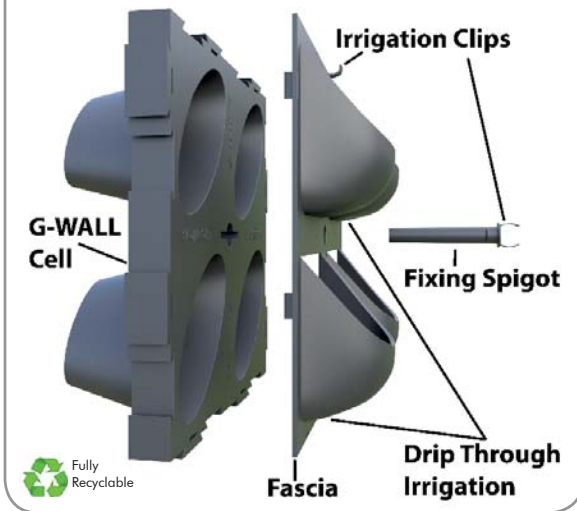

The Platipus G-WALL is a unique, modular green/living wall system for integrators.

Key Benefits

- Quick & easy to assemble / build
- No batons, rails, hanging grids or membranes
- UV inhibited materials
- Each cell provides 4 pockets for planting
- Accepts standard 13 / 14mm irrigation pipe
- Unique pocket 'drip-through' water system
- Plant temperatures moderated by cool air flow behind the cell

G-WALL IRRIGATION

Due to a wide range of plant species requiring different amounts of water and the impact of local conditions, an effective irrigation system is vital. Not only does it deliver the required amount of water, it also can be used with a fertiliser dosing pump to get the correct nutrients directly to the root zone.

Whilst we do not supply the irrigation system, G-WALL is ready to accept a standard 13/14mm pipe for irrigating plants growing from the cells. Our unique pocket 'drip-through' solution minimises irrigation piping and allows for an environmentally friendly, discreet and aesthetic finish to any living wall. As hot air rises it draws cool air up and around the cells, allowing for plant temperatures to remain moderated. The airflow reduces water evaporation and waste.

Key Benefits

- Immediately ready for standard 13 / 14mm irrigation pipe
- Individual plant watering
- Easy maintenance and access to watering system
- Pocket 'drip-through' system supplies water to all plants
- Plant temperatures moderated by cool air flow

How G-WALL Integrates

Our modular G-WALL solution allows you to integrate your own drainage, lighting, bordering and irrigation to suit the design of any project.

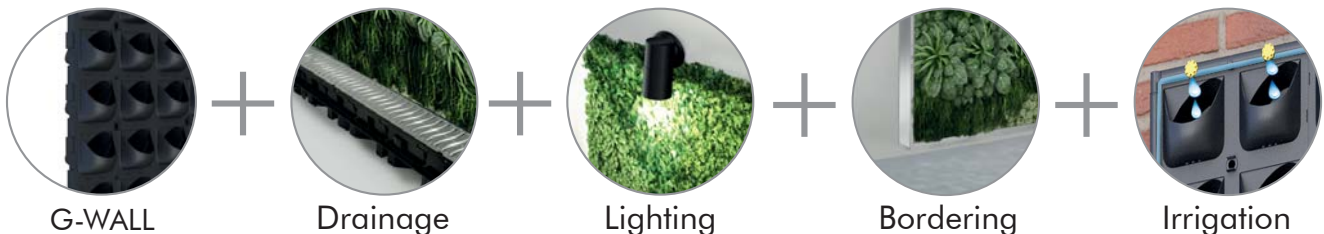

G-ROOF SYSTEM

The benefits of green roofs, podiums and terraces are well established. Platipus has designed a system to make construction easier and more effective. The G-ROOF is a modular structural and drainage support system ideal for intensive and extensive roof gardens. The durable G-ROOF cells can be connected and placed directly on a waterproofed surface and the rigid system provides ideal load bearing support without the need for a root barrier and other layers. By stacking and rotating cells 90° planting area levels can be constructed quickly. Trees and shrubs can be secured in any location using anchor slots designed within the cell and include large integrated cups for valuable water storage.

Key Benefits

- Lightweight and easy to transport
- Quick to assemble and construct
- Planting area levels can be constructed quickly by stacking and rotating cells 90°
- G-ROOF integrates with standard Platipus Tree Anchoring Systems to allow trees and shrubs to be secured in any location
- Cells contain integrated cups for valuable water storage (1m² panel with 60% soil compaction retains ≤10L)
- Allows air to flow and surface water to run underneath the cells

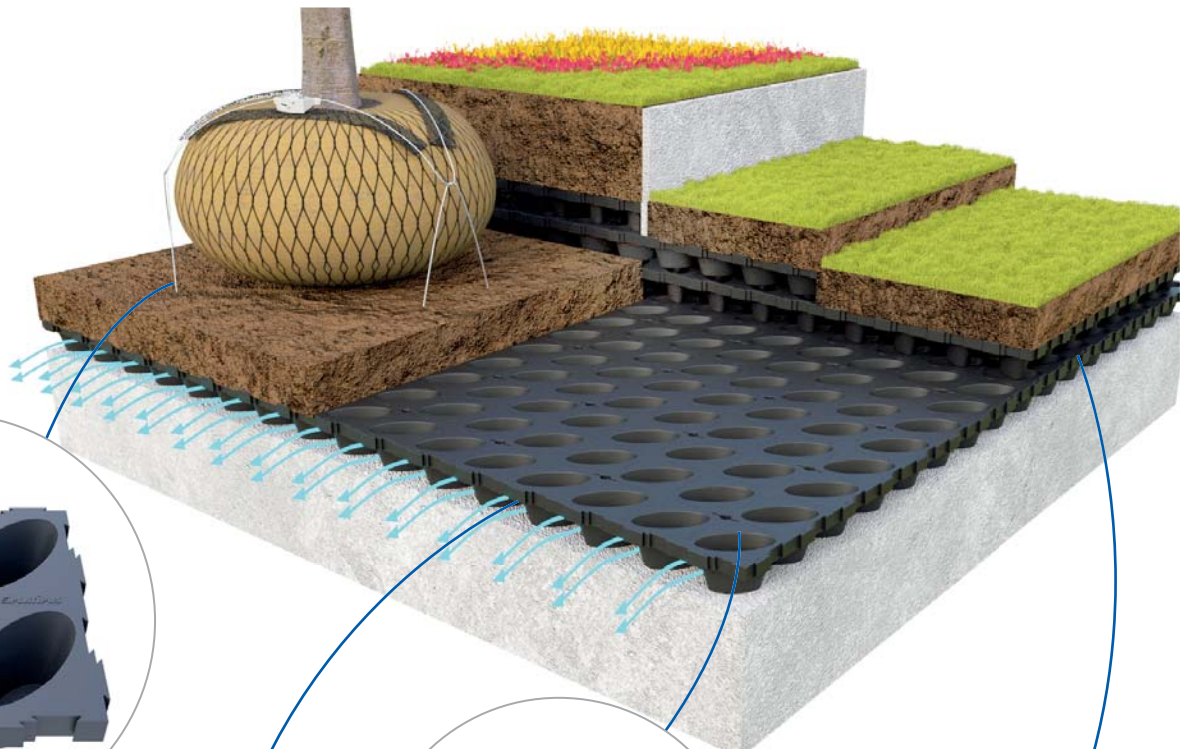

Slots for easy anchor installation to allow trees & shrubs to be secured in any location

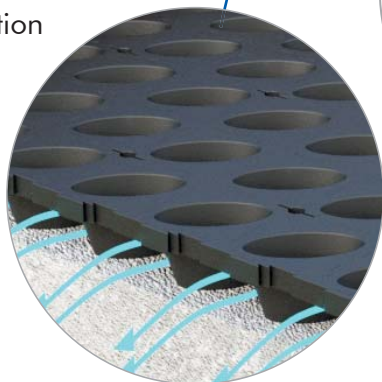

Allows air to flow and surface water to run underneath the cells

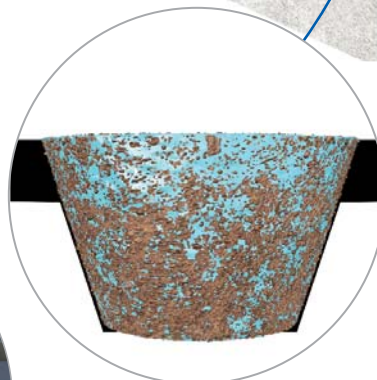

Large integrated cups for valuable water storage



Planting area levels can be constructed quickly by stacking and rotating cells 90°

G-WALL INSTALLATION GUIDE

G-WALL Single Panel (1m²)

Kit



Tools Required

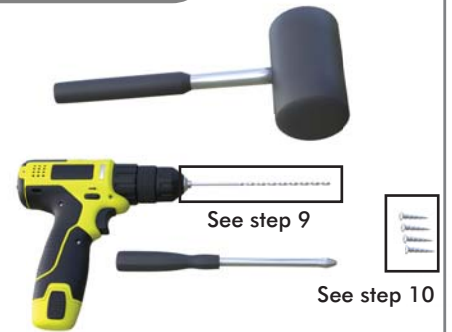

1



Connect two G-WALL cells together using a rubber mallet.

2



Repeat step 1 to create the desired shape and size of your living wall.

3



Connect the fascia to the front of the G-WALL cell by lining up the clips with the slots in the G-WALL cell.

4



Ensure that the fascia clips are properly seated in the slots in the G-WALL cell.

5



Repeat steps 3 & 4 for every G-WALL cell.

6

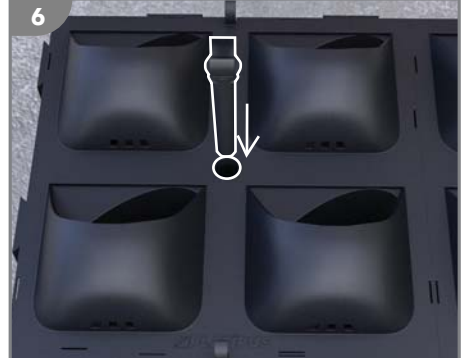

Insert the fixing spigot into the hole in the centre of the fascia and G-WALL cell, ensuring that it clicks into place.

7



Repeat step 6 for each G-WALL cell.

8



Place the G-WALL in its intended location.

9



Drill a 30mm deep hole into the wall through the centre of the fixing spigot.



Hand screw a screw into the pilot hole so that the G-WALL cell is secured to the wall. We recommend a DeWalt WALL DOG.

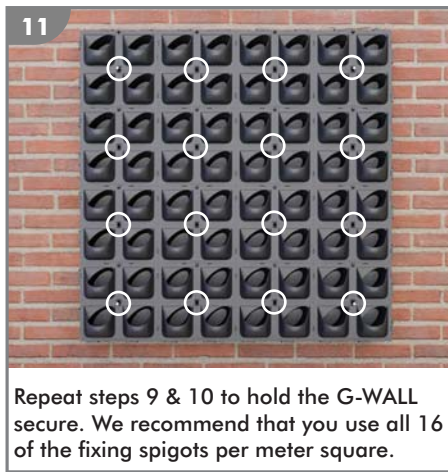

Repeat steps 9 & 10 to hold the G-WALL secure. We recommend that you use all 16 of the fixing spigots per meter square.



Fix a permanent irrigation system in place using the irrigation clips. Use extra irrigation clips on the spigots if necessary.



Fill each pocket of the G-WALL with a plant (P9 pot size) and pack out with additional soil.



Adjust the drip through watering system to ensure that all of the plants receive the correct amount of water.

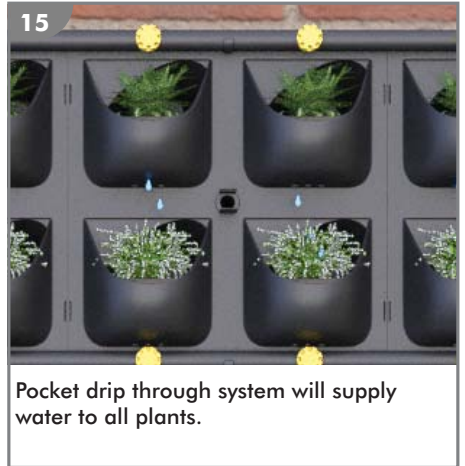

Pocket drip through system will supply water to all plants.

	G-WALL CELL	
	Size (mm) - 1 unit	250(H) x 250(W) x 75(D)
	Weight (kg) - 1 unit	0.5

	G-WALL Single Panel 1m²	
	Size (m) -	1(H) x 1(W) x 0.145(D)
	Weight unplanted (kg)	11.2

	G-WALL FASCIAS	
	Size (mm) - 1 unit	245(H) x 245(W) x 70(D)
	Weight (kg) - 1 unit	0.2

	DeWALT WALL-DOG	
	An all steel, tension-free, one piece, threaded fastener. Use to fasten various fixtures directly to drywall, wood, concrete, sand-lime stone or brickwork, no rawplug needed.	

G-WALL Multiple Panel Installation

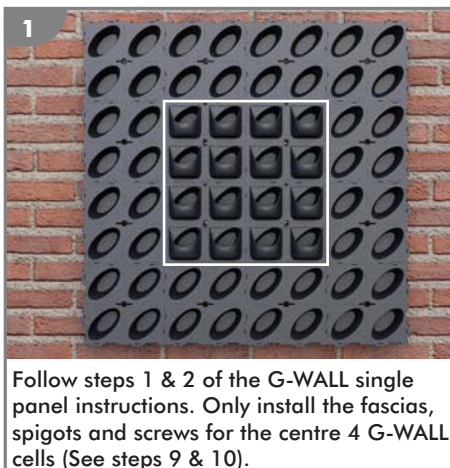

Follow steps 1 & 2 of the G-WALL single panel instructions. Only install the fascias, spigots and screws for the centre 4 G-WALL cells (See steps 9 & 10).

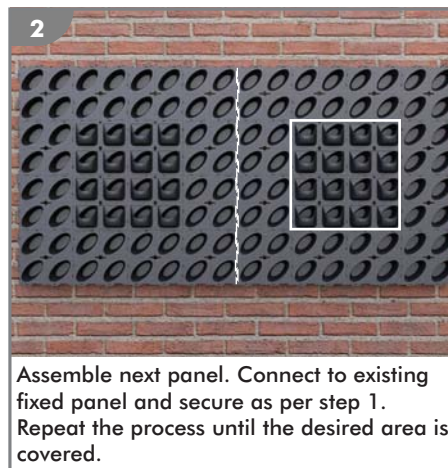

Assemble next panel. Connect to existing fixed panel and secure as per step 1. Repeat the process until the desired area is covered.

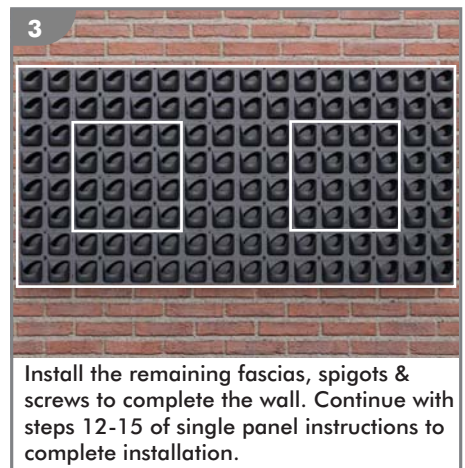

Install the remaining fascias, spigots & screws to complete the wall. Continue with steps 12-15 of single panel instructions to complete installation.

CAD drawings for our G-WALL and G-ROOF are available



PDEA®, ARGGS® and ARVS® are Registered Trademarks of Platipus Anchors.
 Platipus Anchors technology is protected by International Patents, Trademarks and Registered Copyright.

PLATIPUS
 TREE ANCHORING SYSTEMS
www.platipus-anchors.com

Platipus Anchors Limited,
 Kingsfield Business Centre, Philanthropic Road,
 REDHILL, Surrey, RH1 4DP, England.
 T: +44 (0) 1737 762300
 E: info@platipus-anchors.com

Platipus Anchors Inc,
 1902 Garner Station Boulevard,
 Raleigh, NC 27603, USA.
 T: Toll Free (USA): (866) 752-8478 T: (919) 662-0991
 E: trees@platipus.us