

# TURBRO

---

 *Neighborhood*

# USER MANUAL

DOG HOUSE HEATER



MODEL: DH800A SMART

# CONTENTS

SAFETY INSTRUCTIONS .....	01
ELECTRICAL SAFETY .....	02
SPECIFICATIONS .....	03
INSTALLATION .....	04
OPERATION .....	06
CONNECTION .....	08
CLEANING AND MAINTENANCE .....	12
WARRANTY .....	13

# SAFETY INSTRUCTIONS

## Read all instructions before installing or using this heater.

When using electrical appliances, basic precautions should always be followed to reduce the risk of fire, electric shock, and injury to persons, including the following:

1. This heater is hot when in use. To avoid burns, do not let bare skin touch hot surfaces. Keep combustible materials, such as furniture, pillows, bedding, papers, clothes, curtains, etc. at least 3 feet from the front of the heater and keep them away from the sides and rear of the heater.
2. Extreme caution is necessary when any heater is used by or near children or invalids and whenever the heater is left operating and unattended.
3. Do not operate any heater after it malfunctions. Turn off the power switch and unplug the power cord and have the heater inspected by a reputable electrician before reusing.
4. To disconnect the heater, switch the power bottom off and remove the plug from the outlet.
5. Do not insert or allow foreign objects to enter any ventilation or exhaust opening as this may cause an electric shock or fire, or damage the heater. This includes ALL types of bedding.
6. Do not block air intake or exhaust holes in any manner.
7. Do not use it in areas where gasoline, paint, or flammable vapors or liquids are used or stored.
8. Use this heater only as described in this manual. Any other use not recommended by the manufacturer may cause fire, electric shock, or injury to persons.
9. Do not alter the heater or cord in any way. This greatly increases your risk of fire and/or injury.
10. Any alterations to the heater, heater parts, or cords will void all warranties.
11. Dutiful compliance with regular maintenance is required for safe and effective operation. See “CLEANING AND MAINTENANCE” for further details.

## ELECTRICAL SAFETY

- Check the power cord and plug carefully before use, to make sure that they are not damaged.
- If the supply cord is damaged in any way, it must be replaced by the manufacturer or its service agent or a similarly qualified person in order to avoid a hazard.
- Electrical outlet wiring must comply with local building codes and other applicable regulations to reduce the risk of fire, electrical shock, and personal injury.
- To protect against electric shock, do not immerse cord or plug in water or any other liquid.
- Do not use this item if the heater has been submerged in water. Immediately turn off the power and call a qualified service technician to inspect the item.

# SPECIFICATIONS

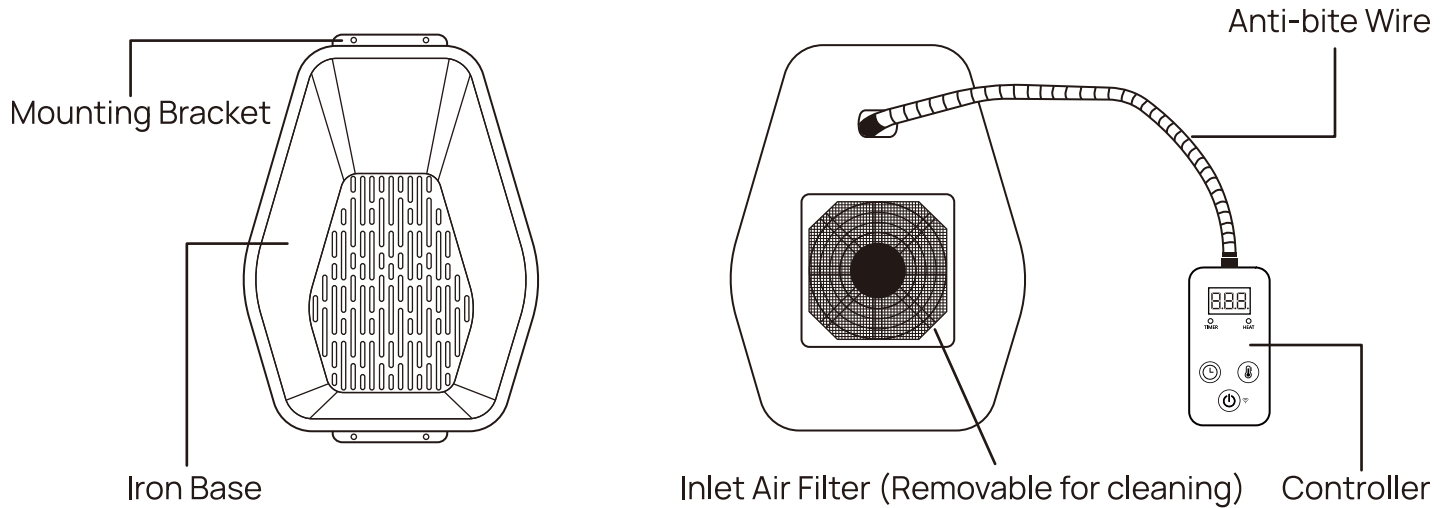

Model Number	DH800A SMART
Power Supply	120V/60 Hz
Rated Power	800W
Cord Length	9.8 Feet/ 3 Meters
Item Dimensions	10.6 x 7.7 x 3.1 Inch
Item Weight	4.2 Lbs
Heating Type	PTC Ceramic Heating

# INSTALLATION

## Tools Required (not included):

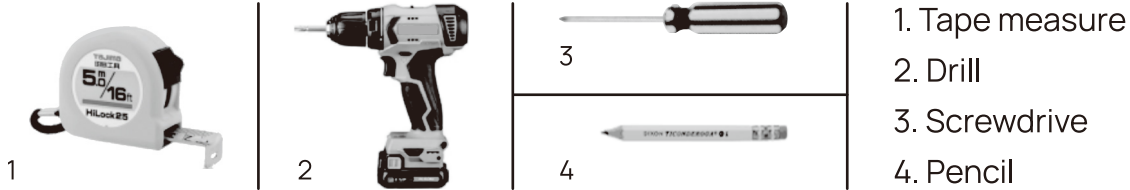

## Installation Steps

### Step 1

Ensure the proper position.

Choose a proper position and use a pencil to mark the mounting location. Place the heater as high as possible with a minimum of at least 3 inches from the ceiling.

Caution: The heater must be mounted on a vertical wall of your pet house. Do not mount it on the ceiling or floor.

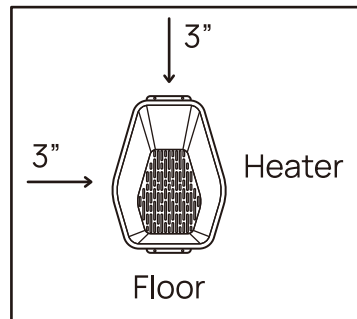

## Step 2

Fix the power cord.

Use a drill bit drill to bore a hole through the wall of the pet house, and then put the power cord through the hole in the house.

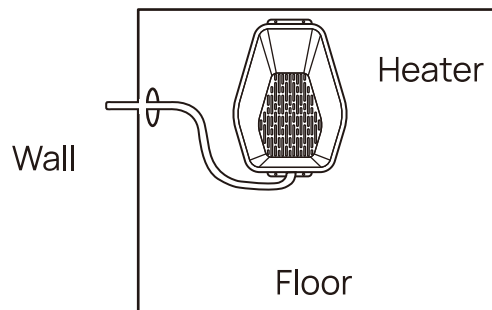

## Step 3

Attach the heater with screws.

Note: The power cord should be installed through the wall of the pet house before fixing the heater.

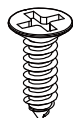
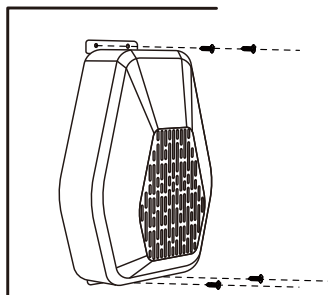

## Step 4

Ready to use.

Plug the unit into a proper wall outlet.

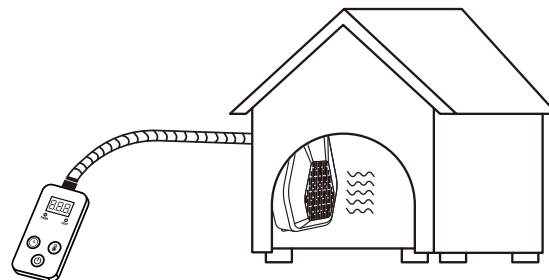

# OPERATION

Due to dog houses being of different sizes, shapes, insulation values, with varying outside temperatures, etc., reaching the desired temperature will vary greatly, and will also affect the effect of heating. Having insulated walls and preferably a door/flap is very important for keeping your pet house warm.

## Controller Operation

### ● Power button “ 1. Press the power button to turn on/off the heater.

Note:

① When turn on, the heater will enter the standby mode: the digital screen shows the ambient temperature after 50s, (will show the last power off temperature on the first time) and it will work 90s to preheat, allowing enough time to set up the dog heater.



### ② Work mode

A. Not reach the setting temperature

The dog heater will continue to heat and stop when it reaches the setting temperature.

B. Reach the setting temperature

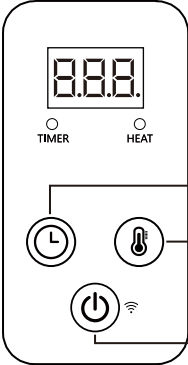
The dog heater will stop 90s and work 90s to maintain the temperature.

2. Press “

The diagram shows a rectangular control panel for a dog heater. At the top is a digital display showing '8.8.8.'. Below the display are two small circular indicators labeled 'TIMER' and 'HEAT'. Below these are three larger circular buttons: a clock icon labeled 'Timer', a thermometer icon labeled 'Temperature/WI-FI', and a power button icon labeled 'Power'. The power button also has a small Wi-Fi symbol next to it.



### ● Timer button “ Long press “● Temperature button “ Long press into the setting mode, short press to setting the temperature :70-115°F (20-46 °C), and after 5s of no operation, it will confirm and exit the temperature setting. Then the display resumes showing the ambient temperature after 5 seconds.

Note : When the heater is arrive the setting temperature, the heater will stop heating.

### ● Child lock

Long press “

### ● F° change to C°

Long press “

### ● EF

1. The product is in over heating protection, please turn off and reopen the heater after it cooling down.
2. When the ambient temperature lower than 5°F (-15°C), the heater will stop work and show “EF”.

### LED Light Meaning:

LED light	Function
Heat	Light on: heating      Light off: stop heating
Time	Light on: setting timer      Light off: no setting
Heat and time	Enter the child lock mode

# CONNECTION

## Connect to AIR.ai App

Use the AIR.ai app to control your dog house heater from your iPhone or Android device even when you are away from the dog house.

### System requirements

- Supported wireless routers must have an available 2.4 GHz operating frequency
- Standard: 802.11b/g/n bands
- Supported smartphone systems: Android 6.0 or later / iOS 11.0 or later



AIR.ai



### Step 1

Long press “

Note: if fail to connect, it will into the standby mode, please check the Wi-Fi and reset the WIFI connection by long press “

08

## Step 2

Connect your phone to the 2.4 GHz network your heater will use.  
Open AIR.ai and tap the “+” icon in the top right corner.  
It will appear an added page, click “Go to add”.

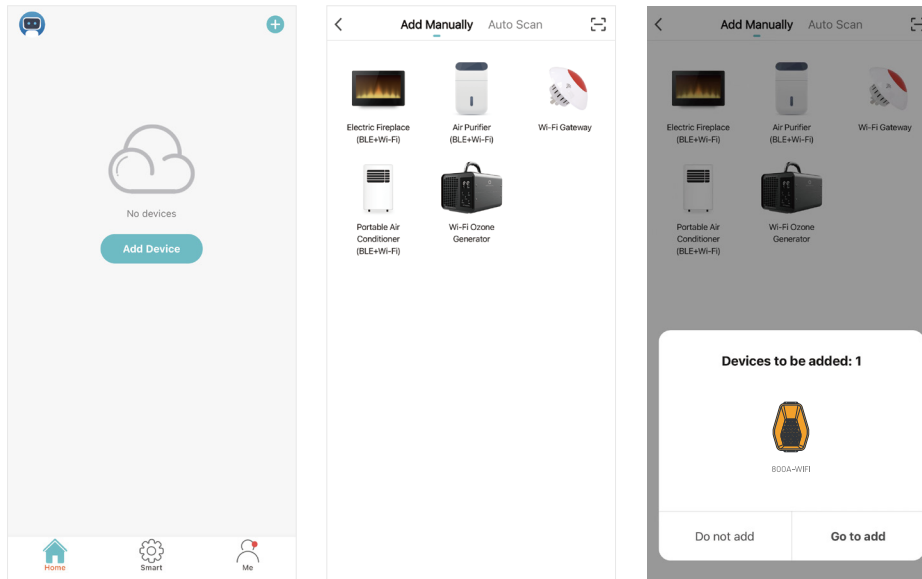

## Step 3

Go to the next step.

Enter the password of your Wi-Fi network when prompted (same Wi-Fi network on which your smartphone is connected) and then click confirm.

**Important note:** The heater must be connected to a 2.4 GHz Wi-Fi network. If your router (internet box) broadcasts 2 Wi-Fi bands (2.4GHz and 5GHz), consult your router user manual to learn how to select the 2.4 GHz Wi-Fi band.

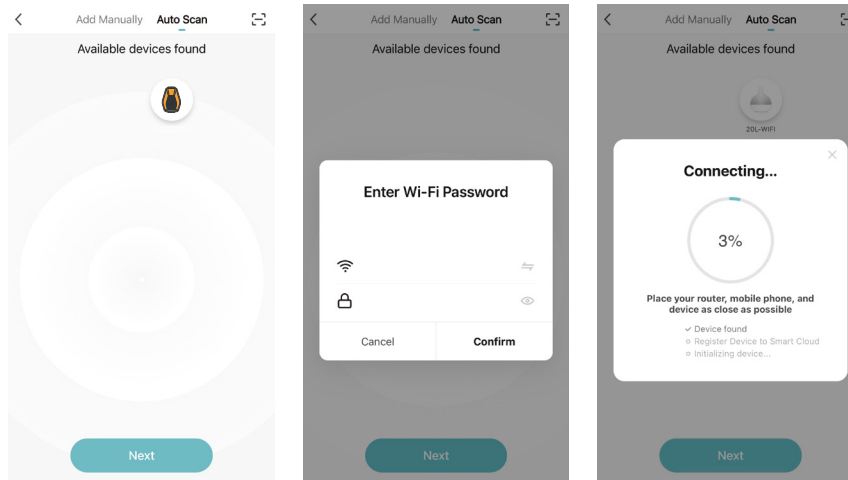

## Step 4

Your device is now connected successfully. You can find the dog heater in the device list.

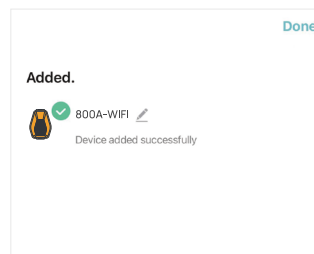

## APP Operation

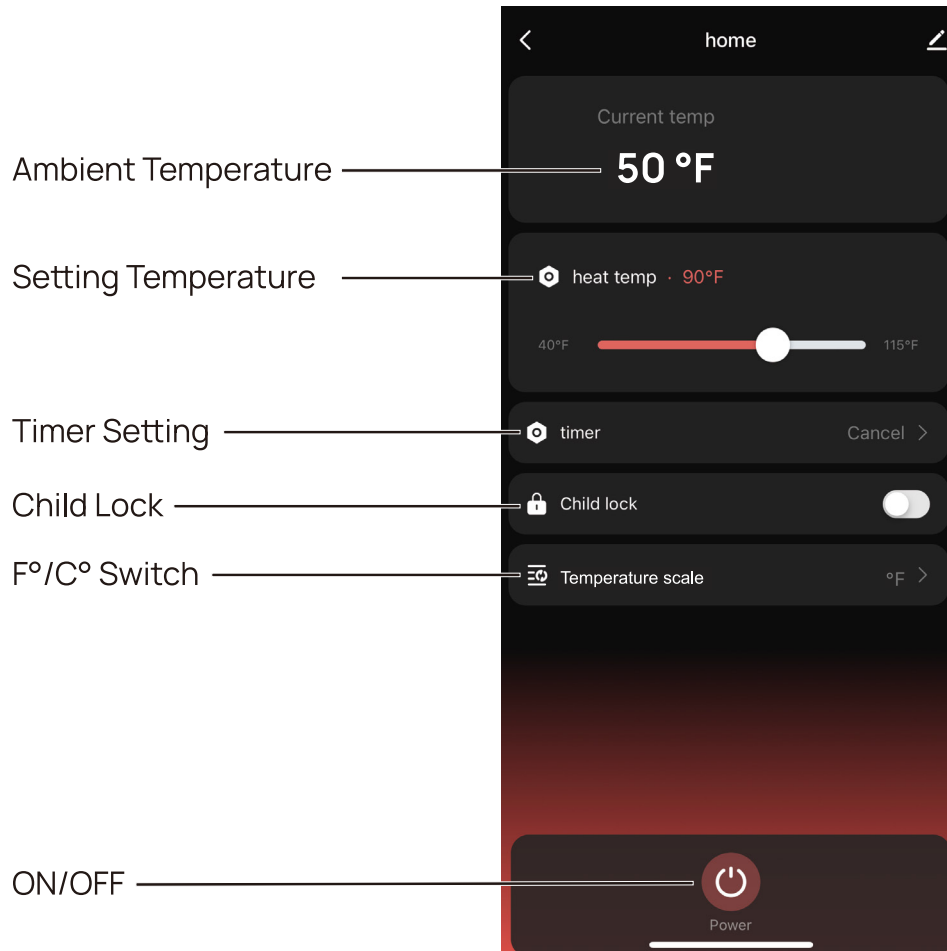

## CLEANING AND MAINTENANCE

Regular maintenance is important to the functionality and safety of the unit. The filter must be cleaned per 3 months to keep the unit safe and working normally.

### To clean and maintain your appliance, please follow below instructions:

1. Turn off the heater and unplug the power cord before cleaning your heater.
2. Make sure the heater is cool before cleaning.
3. Remove the front cover and inspect for hair, dust, and debris. Ensure the fan is free from hair, dust, and debris and is able to spin freely.
4. It's recommended to wipe it out with a lint-free towel and/or a soft-bristled brush. You may use a mild detergent if necessary.
5. After cleaning, dry the unit with a soft cloth.
6. Wait until the heater is completely dry before using.

\*Note: Do not immerse the heater in water or let liquids enter the heater.

### Disassembly steps:

- ① Remove the fan case

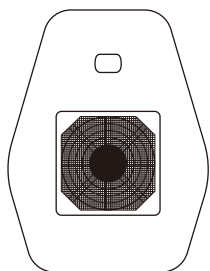

- ② Take out the filter to clean

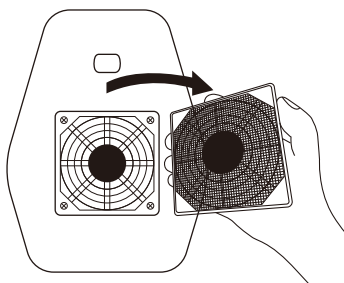

- ③ Ensure the filter dry before installing

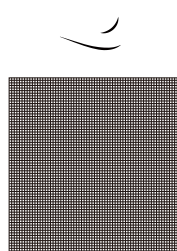

- ④ Reassemble both the filter and case

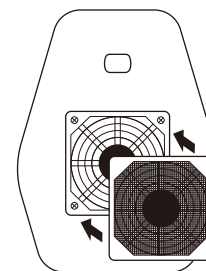

# WARRANTY

## 1 YEAR WARRANTY

TURBRO provides 1-year limited warranty for TURBRO Neighborhood Heater, from the date of purchase, subject to the following conditions and limitations.

### What is covered?

- Any alteration misuse of the product will nullify this warranty.
- This warranty is non-transferrable, which is effective for the original buyer from the authorized seller only.
- This warranty is limited to the repair or replacement of part(s) proved to be defective in material or workmanship, after saiddefectis confirmed by the manufacturer's inspection.

### What's NOT covered?

- Damage caused by the owner when attempting to fix or alter the product themselves.
- Damage caused by misuse, abuse, neglect, alterations, or unauthorized repair.
- Natural depreciation
- How to request warranty services?

To obtain the benefit of this warranty, please leave a message online (<https://www.turbro.com/pages/contact-us>), or send an email to support@turbro.com, Our customer service will address your issue within 24 hours.

### What will TURBRO do?

- Replace the item.
- Refund the item under certain circumstances.

# TURBRO



© Katmai Technology Limited

✉ [support@turbro.com](mailto:support@turbro.com)

🌐 [www.turbro.com](http://www.turbro.com)

☎ [\(323\) 438-3334](tel:(323)438-3334)