

USER MANUAL

TURBRO

Neighborhood Tripod Stand

MODEL NO. : TN30A

ASSEMBLE & OPERATING INSTRUCTIONS

PLEASE READ THIS MANUAL IN ITS ENTIRETY
AND SAVE FOR FUTURE REFERENCE.

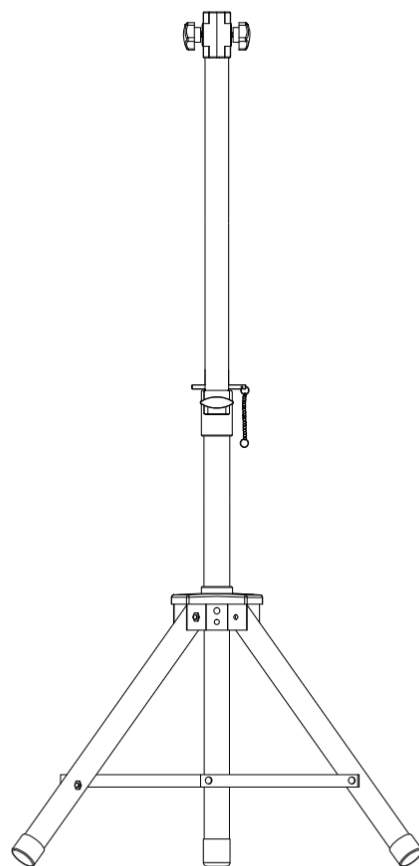

Contents

Safety Instructions 01

Operation 01

 Dimensions 01

 Tripod Mount Installation 02

Limited Warranty 03

Safety Instructions

THESE INSTRUCTIONS SHOULD BE READ CAREFULLY AND RETAINED FOR FUTURE REFERENCE. We cannot be liable for any damages caused by failure to observe these instructions.

1. Please read before first commissioning the safety instructions carefully and observe the safety instructions to prevent damage due to misuse, improper operation, and improper environmental conditions to be avoided.
2. Please check the device before using the product, if there are any parts missing or defective, please keep the packaging and contact TURBRO support team via support@turbro.com.
3. Do not put the unit in case of suspected corruption in operation and consult a specialist.
4. The recyclable packaging material must not be stored or disposed accessible for children, and must be disposed of properly.
5. This appliance is only for the purpose for which it was explicitly developed. Any other use is regarded as improper and dangerous.
6. The supplier is not liable for damage to persons and / or property damage due to an improper or incorrect use.
7. This appliance does not allow be used by children.
8. This appliance does not allow the persons with reduced physical, sensory or mental capabilities or lack of experience and knowledge, unless if they have been given supervision or instruction concerning use of the appliance in a safe way and understand the hazards involved.
9. Please make sure to place the device on a suitable and waterproof surface, so that spilled liquids cannot cause harm.
10. Repairs to electrical appliances must only be carried out by trained personnel only.
11. Improperly performed repairs and alterations to the equipment can have dangerous consequences for the user.

Operation

Dimensions

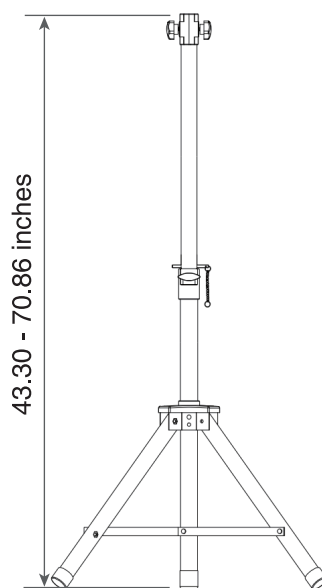

Tripod Stand

Tripod Mount Installation

Accessories: L shape bracket ; Screws & Nuts



Installation:

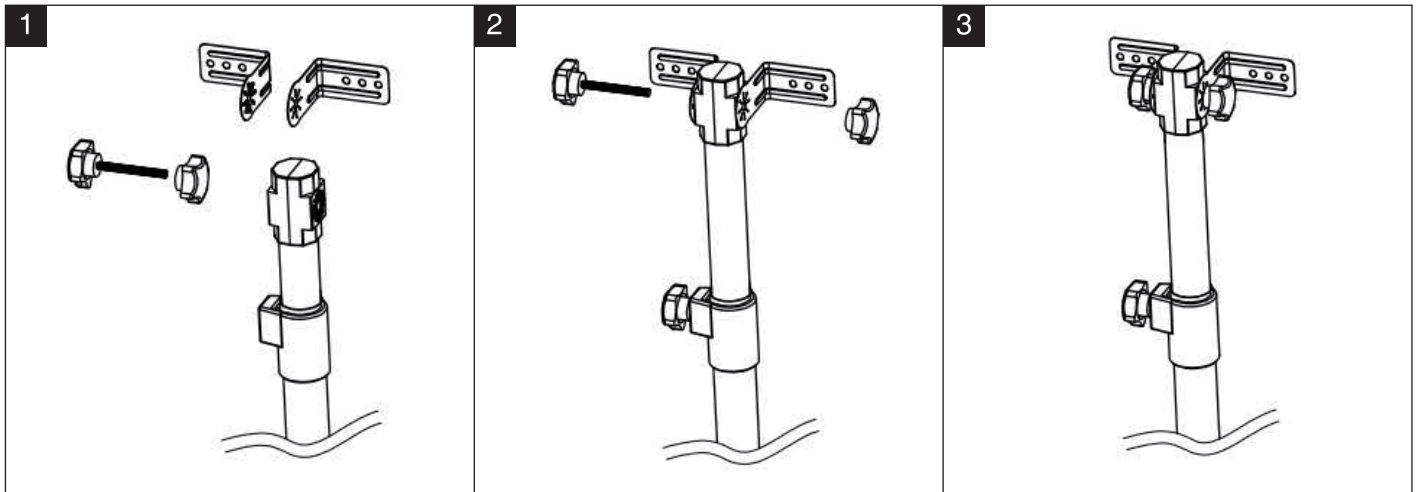

1. Attach the L-shaped bracket to tripod stand.
2. Secure the L-shaped bracket to stand with screw.
3. Moving the slip panels to the proper place.
4. Secure the L-shape bracket to slip panels on product with screws.
5. Adjust the height of stand from 43-71 inches.
6. After assembled the product on the stand, please fill the sand/rock/ dirt (5kg/bag) in the bags and attach the bags on the stand legs as below:



Limited Warranty

We provide 1-year warranty on this product. For more information, please visit www.turbro.com/warranty.

What's covered?

Defects due to faulty materials and/or workmanship of the product

What's not covered?

1. Damage caused by the owner when attempting to fix or altering the product by himself or herself.
2. Damage caused by misuse, abuse, neglect, alterations, or unauthorized repair.
3. Natural depreciation.

Warranty Period

Warranty becomes effective from the date of original purchase and will last for 1 years.

Who's covered?

This limited warranty is only effective for the original purchaser. It is non-transferable.

How to request warranty services?

To obtain the benefit of this warranty, please email support@turbro.com. Our customer service team will address your issue as soon as possible!

TURBRO



© Katmai Technology Limited

support@turbro.com

www.turbro.com