

TURBRO

 Fireside

Portable Outdoor Fire Pit

Model Pluto R19



FOR OUTDOOR USE ONLY

- THIS MANUAL IS A GENERAL VERSION, THE STAINLESS STEEL FIRE PIT PICTURE IS FOR REFERENCE ONLY.
- READ ALL INSTRUCTIONS BEFORE USE, AND RETAIN THIS MANUAL FOR FUTURE REFERENCE.

Table of Content

User Warnings	01
Parts List	03
Assembly Instruction	04
How to Use Your Fire Pit	05
Storage and Care	07
Maintenance	09
Warranty	10

User Warnings

- Do not use Pluto Fire Pit until you have read the operating instructions and user warnings.
- Pluto Fire Pit is not for commercial use.
- Always place Pluto Fire Pit on a level, non-combustible surface.
- The use of alcohol, prescription, or non-prescription drugs may impair the consumer's ability to operate Pluto Fire Pit safely.
- Do not alter or modify Pluto Fire Pit in any manner.
- Serious injury, death, and/or property damage may occur if the instructions are not followed exactly.

Fire Hazards

- Do not use Pluto fire pit indoors. Pluto Fire Pit is designed for outdoor use only. Never use your fire pit in a building, garage, or any enclosed area. Toxic carbon monoxide can accumulate and cause asphyxiation and possibly death.
- Pluto Fire Pit is not to be used in a boat or recreational vehicle.
- Do not use Pluto Fire Pit in windy conditions.
- Always use Pluto Fire Pit in accordance with all applicable local, state, and national codes. Contact your local fire department for details.
- Do not use Pluto Fire Pit near automobiles, trucks, vans, or recreational vehicles.
- Do not use Pluto Fire Pit in any explosive environment.
- Keep the area around the Pluto Fire Pit clear and free of any combustible materials, gasoline, or any other flammable liquids.
- Do not use gasoline, kerosene, diesel fuel, lighter fluid, alcohol or any other flammable liquid to light or relight Pluto Fire Pit.
- Do not wear flammable or loose clothing when operating Pluto Fire Pit.
- Keep all electrical cords away from Pluto Fire Pit.
- Do not lean over Pluto Fire Pit when lighting or when it is in use.
- Avoid breathing smoke from the fire and avoid getting smoke in your eyes.
- Do not store or use LP gas cylinders within 30 feet of Pluto fire pits while in operation.

Cleaning Safety

- Do not move or clean or store Pluto Fire Pit until all ashes and coals are extinguished and all surfaces have cooled completely. Never touch ashes or coals to see if they are hot.
- All surfaces of the fire pit will become extremely hot when in use. To avoid burns, don't touch any part of the fire pit until it's completely cool.
- Pluto Fire Pit should be inspected and cleaned regularly after each use.
- Do not use water to extinguish the fire as this could cause damage to the Fire Pit as well as injury to the user.

Child Safety

- Exercise the same caution as you would with any open fire. When using your fire pit, never leave it unattended, especially when children and pets are nearby.
- Pluto Fire Pit is not to be operated by children.

Parts List

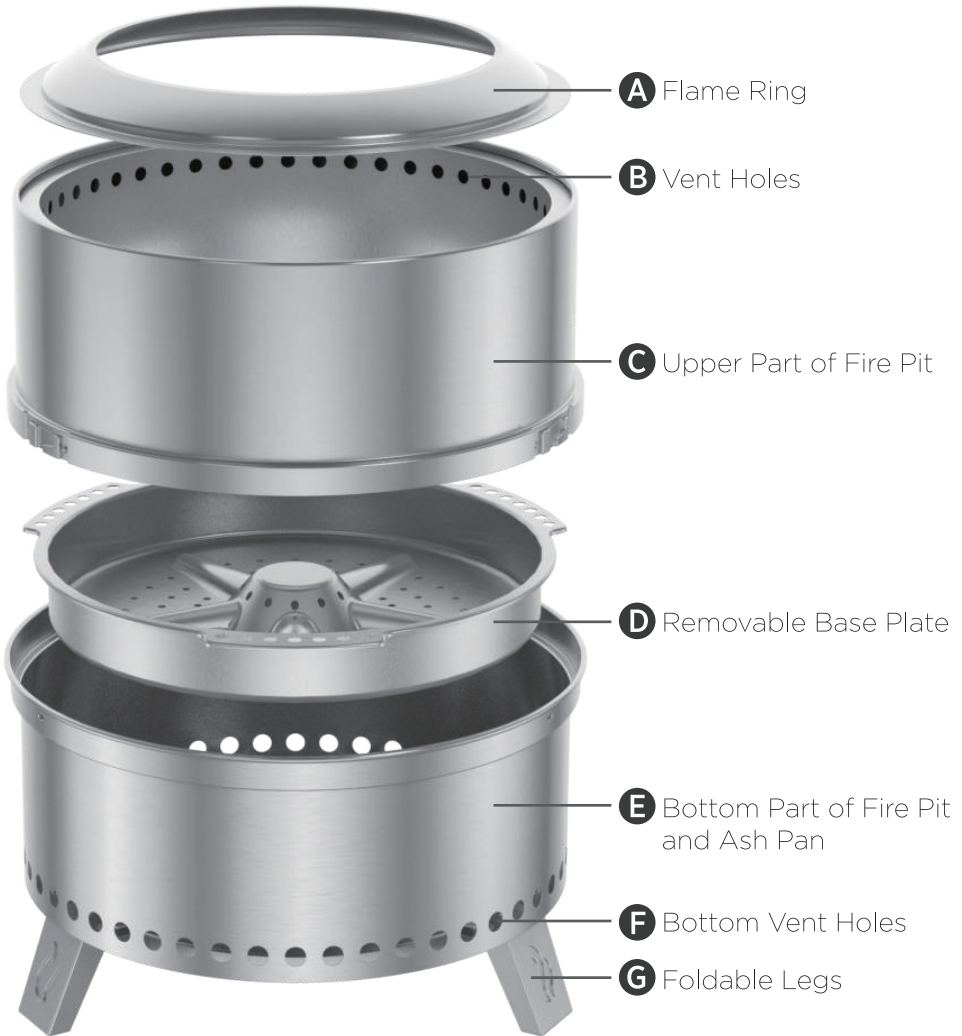

Assembly Instructions



Step 1

Put the Removable Base Plate **D** insert into the Bottom Part **E**. Please make sure the Removable Base Plate is flat on the bottom and snapped into place.

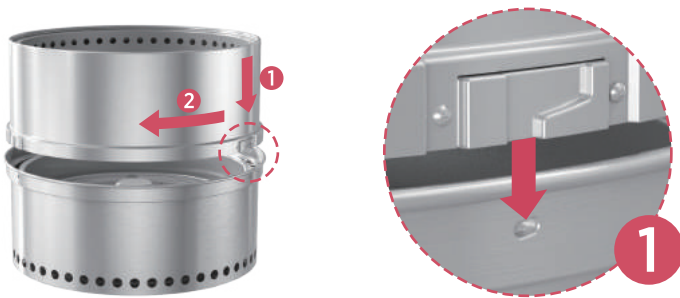

Step 2

Connect the Upper Part **C** with the Bottom Part **E** of the fire pit, then rotate the Upper Part until the slot at the joint is fully engaged with the Bottom Part.



Step 3

Open the Foldable Legs **G** and place the fire pit on stable ground.

Note: Please ensure the legs are fully extended.



Step 4

Place the Flame Ring **A** on the top. Please note that the angled edges pointing upward.

How to Use Your Fire Pit



Step 1

Remove the nested Flame Ring **A** and set it aside.



Step 2

Using logs that are 16" or shorter, stack your logs tightly inside the fire pit along and light it up. Starts with small kindling twigs or fire starters.

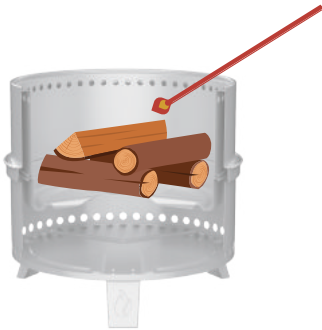

Step 3

Light your fire.

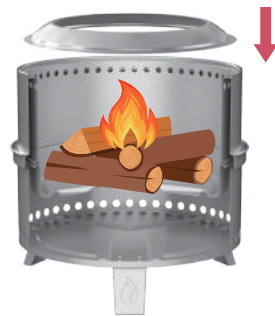

Step 4

Place the Flame Ring **A** back on top of the fire pit. The flame ring will provide protection from the wind and enhance the look of the flames.

Suggested Fuel: Dry firewood logs. Hardwood is best for a long burn.

Recommended firewood size: length \leq 16 inches, with diameter \leq 4 inches.



Suggested Placement Directions of Firewood

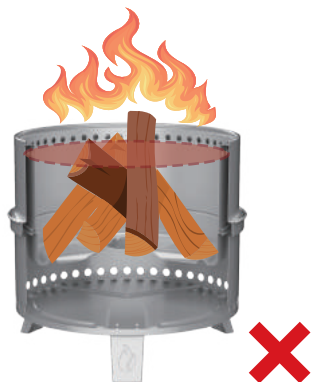

Step 5

Gently add additional logs as needed. For best results, do not overfill the fire pit with logs that cover or extend above the top air holes.

Tips for Using

- Three factors that will lead to excess smoke: lack of heat, lack of oxygen, or using the wrong fuel. The air vents can provide sufficient oxygen, but when there is insufficient heat in the furnace cavity or using the wrong fuel, especially wet wood or other non-flammable things, more smoke may be generated. Overfilling the fire pit above the top air holes will also decrease efficiency and will produce more smoke.
- It will produce some smoke when starts burning, using paper or wet wood as fuel may generate more smoke when burning.
- When you first use your fire pit, the unique double-wall airflow within the unit will take approximately 3-15minutes to achieve full efficiency. The more evenly your fire burns inside the fire pit, the more prominent the flame pattern showing the secondary combustion will appear.



- Do not cover the bottom vent holes while lighting up the firewood or it's burning. The bottom vent holes keep the fresh air enters the fire pit continuously and replenish oxygen, making the firewood burn better.

Storage and Care

Before cleaning or storing, please ensure the firewood and charcoal are all burned out and that the fire pit has cooled down to normal temperature. Let the fire pit burn out on its own, or extinguishing it by sand or fire extinguisher.

DO NOT EXTINGUISH FIRE WITH WATER AS IT MAY DAMAGE THE FIRE PIT.

After the fire pit has completely cooled down, rotate to uninstall the fire pit upper part, take out the removable base plate and turn the ash pan over to empty any remaining ash.



Step 1
Take off the Flame Ring **A**.



Step 2
Fold the Legs **G**.



Step 3
Take off the Upper Part **C** of the fire pit.



Step 4
Take out the Removable Base Plate **D**.



Step 5
Flip over the Ash Pan (Bottom Part) **E** to get the ashes out.



Step 6
Wipe the fire pit with a soft cloth.

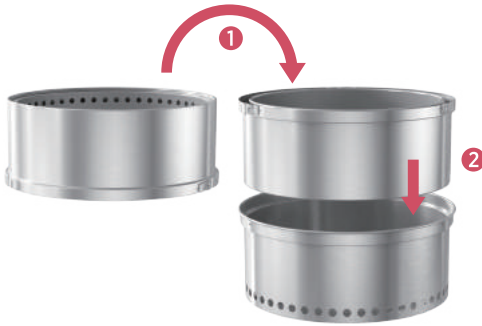

Step 7

Reverse the Upper Part **C** of the fire pit and put it into the bottom part.



Step 8

Put the Removable Base Plate **D** into the Upper Part as well.



Step 9

Reverse the Flame Ring **A** and put into the fire pit.



Step 10

Place your fire pit into the carry bag and store in a cool and dry location. Prolonged exposure to harsh weather will increase rust and discoloration.

WARNING

The products emitted when it's burning can expose you to chemicals including carbon monoxide, which is known by the State of California that may cause birth defects or other reproductive harm. For more information go to www.P65warnings.ca.gov.

Maintenance

Caring for your fire pit correctly will prolong its look and usability.

- The Pluto fire pit should not be left outside uncovered when not in use.
- Do not touch hard or sharp objects, to prevent scratches on the coating.
- After a period of time use, the coating may appear to be discolored and carbonization due to high temperature/humidity/polluted air, which is a normal phenomenon and does not affect the use.
- Please ensure the Flame Ring was installed on the fire pit before you use it every time, to prevent the flame retardant jumps around and touching the coating directly. Touching the flame/high temperature for an excessively long time may lead to the coating discoloring, carbonizing, or melting.
- Always place your fire pit in its carrying bag (which can also be used as a temporary outdoor cover) and store it in a cool/dry location.
- Due to extremely high temperatures, discoloration of the fire pit will occur and is considered normal. Stainless steel has increased resistance to rust; however, it is not rust-proof completely.
- Prolonged exposure to moisture may result in increased staining and/or rusting. Due to extremely high temperatures the inside of the fire pit may show signs of staining/rust. This is normal and will not affect normal use.

1-YEAR WARRANTY

TURBRO provides 1-year limited warranty for Pluto Fire Pit , from the date of purchase, subject to the following conditions and limitations.

What is covered?

- Any alteration misuse of the product will nullify this warranty.
- This warranty is non-transferrable, which is effective for the original buyer from the authorized seller only.
- This warranty is limited to the repair or replacement of part(s) proved to be defective in material or workmanship, after said defect is confirmed by the manufacturer's inspection.

The manufacturer may, at its discretion, fully discharge all obligations with respect to this warranty by refunding the wholesale price of the defective part(s)

What's NOT covered?

- Damage caused by the owner when attempting to fix or alter the product themselves.
- Damage caused by misuse, abuse, neglect, alterations, or unauthorized repair.
- Natural depreciation.

How to request warranty services?

To obtain the benefit of this warranty, please leave a message online (<https://www.turbro.com/pages/contact-us>), or send an email to support@turbro.com. Our customer service will address your issue within 24 hours.

What will TURBRO do?

- Repair the item.
- Replace the item if not repairable.
- Refund the item under certain circumstances.

ALL EXPRESSED AND IMPLIED WARRANTIES, INCLUDING THE WARRANTY OF MERCHANTABILITY, ARE LIMITED TO THE PERIOD OF THE LIMITED WARRANTY.

TURBRO



© Katmai Technology Limited

 support@turbro.com

 www.turbro.com

 [\(323\) 438-3334](tel:(323)438-3334)

