

RECOMMENDED TOOLS

- 5/32" "T" handle allen wrench —
- Phillips screwdrivers - Normal and Large
- Clean rags
- Shop vac or compressed air

SERVICE KIT PARTS LIST

Qty	Diagram	Description
4	A	Head Screw
1	B	O-Ring Gasket
1	C	Rec-Ring Gasket
2	D	Valves
2	E	Short Keeper
1	F	Long Keeper
2	G	Valve Screws
Reuse	H	Retainer Screw
1	I	Cylinder Sleeve
1	J	Teflon Cup

VALVE PLATE TOP

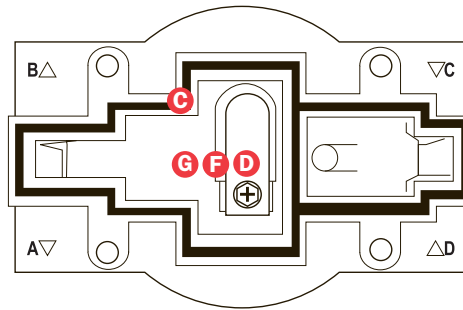

VALVE PLATE BOTTOM

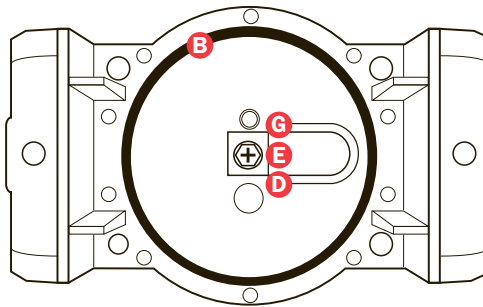

CAUTION: Improper assembly or use of damaged parts may lead to premature failure and further damage to compressor.

WARNING: Unplug the compressor before disassembly. Disconnect unions, remove the compressor from the cabinet. Assemble all tools and check rebuild kit parts

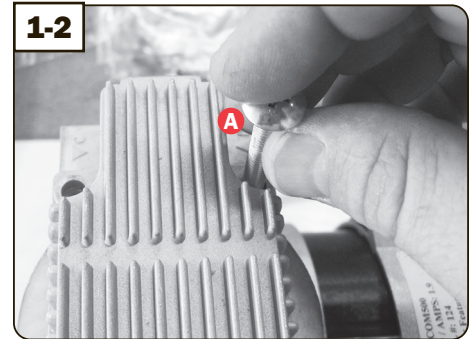

1. Clean loose dirt from the compressor exterior.
2. Use screwdriver or cordless drill with a large Phillips head bit to remove bolts [A] from head plate cover.

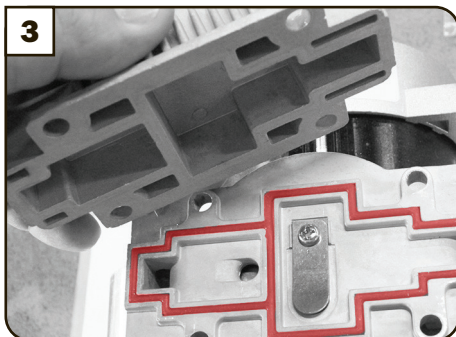

3. Remove head plate cover from compressor and set aside.

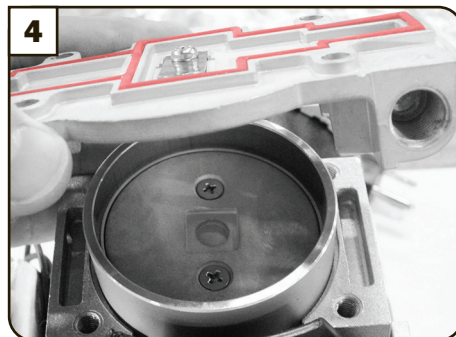

4. Remove valve plate from compressor to change parts needed.

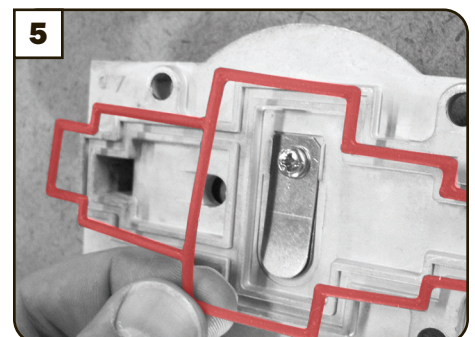

5. Remove o-ring [B] and rec-ring [C] gaskets from valve plate.

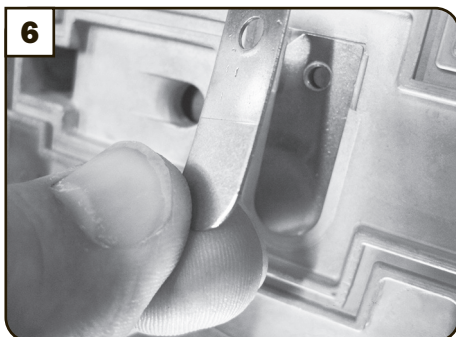

6. Top valve plate - remove screw from flapper valve parts [D,F,G] and replace with new parts in same order as when removed or also as shown in diagram above. Make sure [F] Long Keeper is curved up when replacing.



7. Bottom valve plate - remove flapper valve parts [D,E,G] and replace with new parts in same order as when removed or also as shown in diagram above.

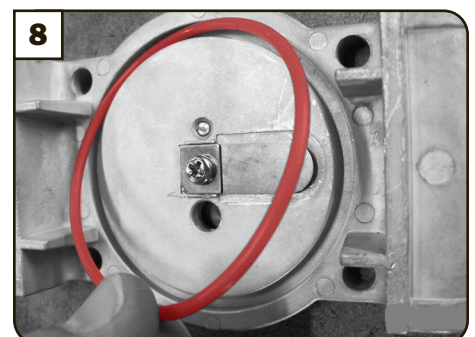

8. Add o-ring [B] gasket and rec-ring [C] to valve plate and set valve plate aside.

PISTON ASSEMBLY

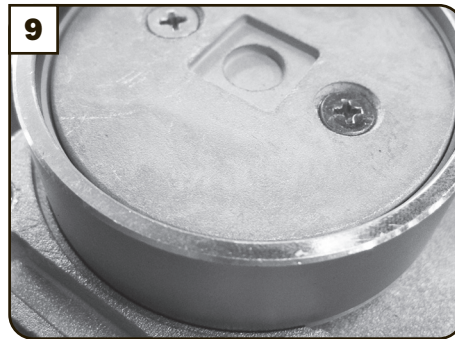
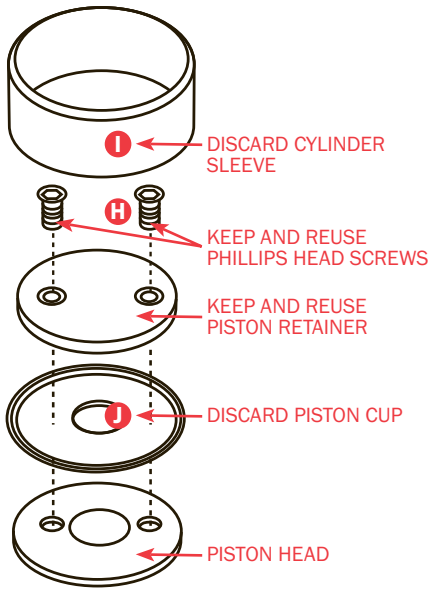

9. Remove fan guard and rotate fan to raise piston shaft to its highest point.

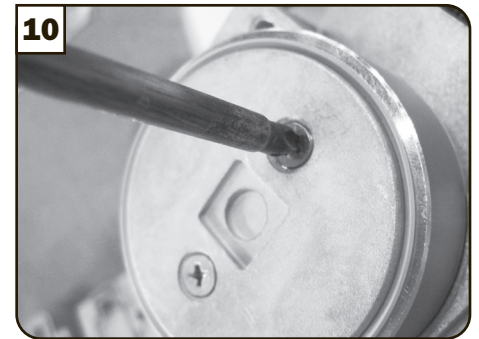

10. Use regular screwdriver to remove retainer screws [H]. **Do not throw away, you will re-use them!**

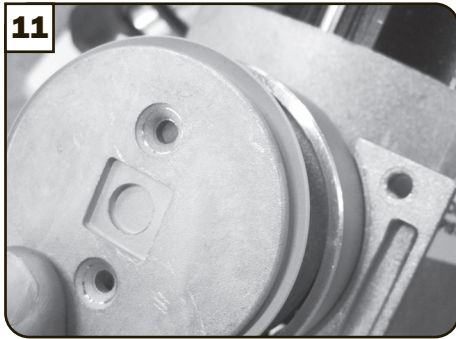

11. Remove retainer but keep it to reuse. Discard old cylinder sleeve, and teflon piston cup.

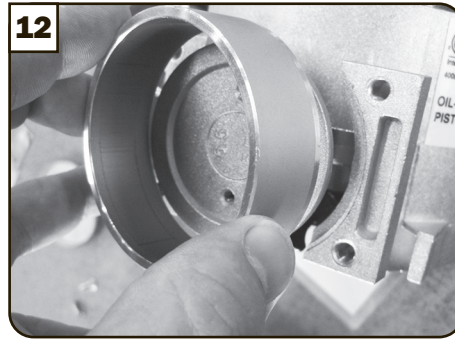

12. Mount new piston cylinder sleeve [I] around piston top with notched end facing down.

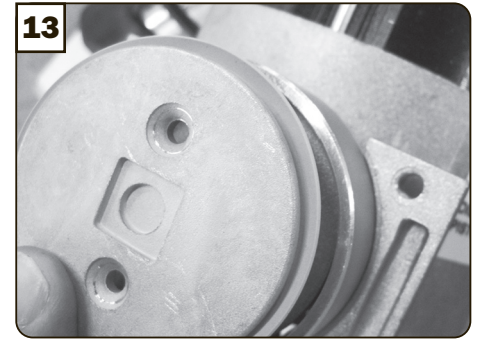

13. Insert new teflon piston cup [J] with curved edge facing up on top of piston head, then place retainer on top of piston cup.



14. Insert Piston retainer screws [H] and while pressing down on the retainer. Start the two screw until they have a couple of threads initiated. Once that has been achieved, rotate the internal fan which will pull the piston cup and retainer evenly into piston sleeve. Then continue with screwing in the two screws completely and tightly.

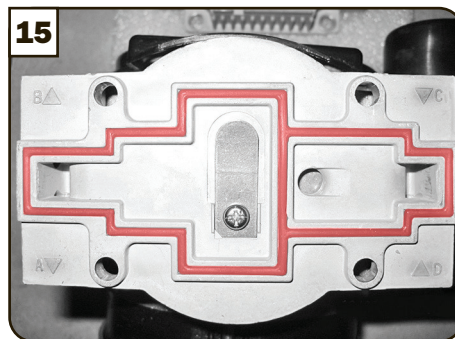

15. Add valve plate onto cylinder as shown in picture matching the letter markings

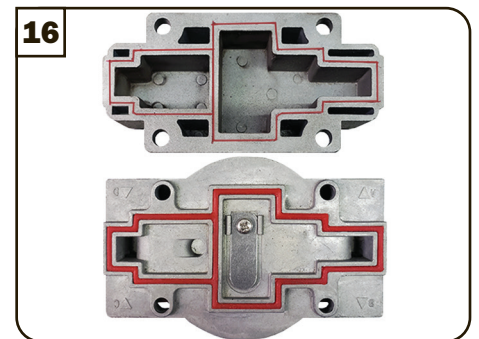

16. Match inside of compressor head cover to flapper valve plate, line up head screws [A] and retighten in a crisscross pattern with large Phillips head screw driver till all screws are tightened.