

ASSEMBLY

NOTE: All references in this manual to the left or right side and front or back of the tractor are from the operating position only. Exceptions, if any, will be specified.

NOTE: Some components may come already assembled. If they are already assembled, skip ahead to the next step.

Preparation

Before beginning installation, remove all the contents from the crate and all the hardware from the pack to make sure everything is present.

Contents of Crate

- Tractor
- Battery Charger
- Hood Topper (If equipped)
- Front Bumper (If equipped)
- Dash Cap (If equipped)
- Steering Wheel
- Seat Assembly
- Operator's Manual
- Charger Operator's Manual
- Hardware Bag

Recommended Tools for Assembly

- 5/16" wrench and/or socket
- 7/16" wrench and/or socket
- 1/2" wrench and/or socket
- 5/8" wrench and/or socket
- Phillips screwdriver
- Standard screwdriver

Manually Moving the Tractor

⚠ CAUTION

Never tow your tractor. Towing the tractor with the rear wheels on the ground may cause severe damage to the drive motors.

The tractor can be moved as long as the parking brake is not set. The tractor can be pushed slowly.

Install Operator's Seat Assembly (If necessary)

To install the seat proceed as follows:

NOTE: The seat is shipped with the seat switch and seat pan attached.

1. Cut any straps securing the seat assembly to the tractor. Remove any packing material.

NOTE: Be careful not to cut the wiring harness connecting the seat and the seat switch.

2. Remove the two shoulder bolts (a) and flange lock nuts (b) in the seat pan as shown in Figure 1.

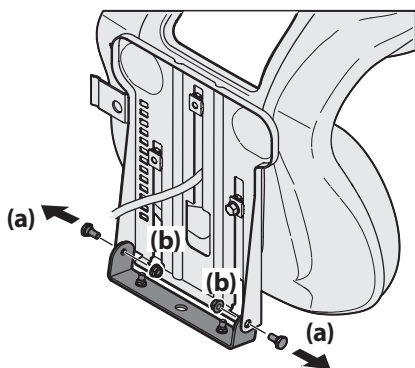

Figure 1

3. Rotate the seat into position and slide a Phillips screwdriver through one of the seat-securing holes and seat bracket for alignment.
4. With the previously removed shoulder bolts (a) and flange lock nuts (b) secure one side of the seat and seat bracket. While supporting the seat, remove the Phillips screwdriver and secure the other side of the seat. Be careful not to crimp or damage the wire harness while installing the seat. See Figure 2. Torque to 84-103 in-lbs (9.5-11.6 N-m).
5. Using the harness clip attached to the harness, secure the excess wire to the fender by snapping the harness clips in place as shown in Figure 3.

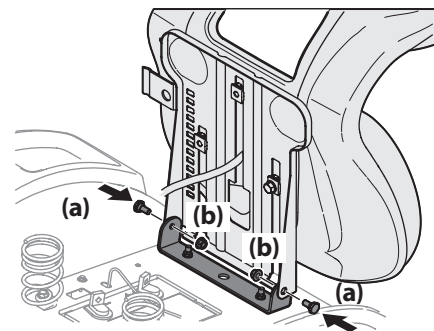

Figure 2

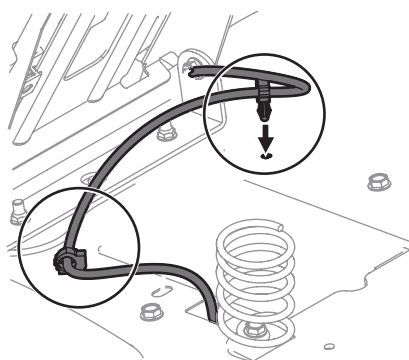

Figure 3

Lower Deck Discharge Chute Deflector

⚠ WARNING

Never operate the tractor deck without the chute deflector installed and in the down position.

1. Check the tractor deck for a shipping brace that may be holding the chute deflector upward for shipment. If the brace is present, it must be removed before operating the tractor. Holding the chute deflector fully upward, remove the shipping brace. Lower the chute deflector and discard the shipping brace. See Figure 4.

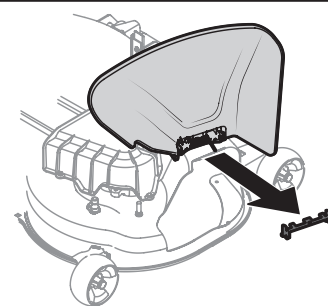

Figure 4

Installing the Screw-On Hood Topper (If necessary)

NOTE: Be careful not to damage the headlight harness when installing the screw-on hood topper.

1. Set the hood topper up against the top of the hood with the hood open, and align the holes on the hood.
2. Secure the screw-on hood topper (a) from below, hand-tighten the screws (b) on the rear half of the hood and then securely tighten them. See Figure 5.

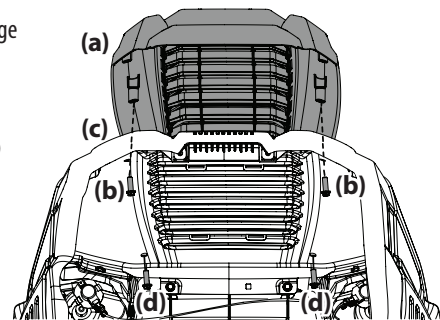

Figure 5

ASSEMBLY

- With the rear screws in place, align the holes in the hood topper (a) with the holes in the hood (c) and secure in place with remaining two screws (d). See Figure 5.
- Tighten all four screws to 16-24 in-lbs (1.8-2.7 N-m).

Installing the Snap-On Hood Topper (If necessary)

- To install the snap-on hood topper (a), line up the holes on the hood topper (a) with the tabs (b) in the hood frame as shown in Figure 6.
- Insert the tabs (b) into the hood topper and pull back to lock into place.
- Once the hood topper is in place, the two locking tabs near the rear of the hood need to be pushed upward to lock the hood topper in place. See Figure 7.

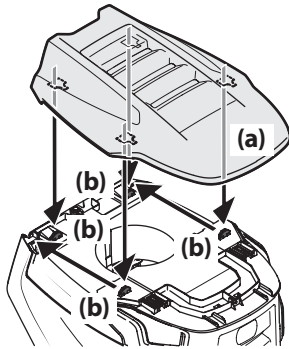
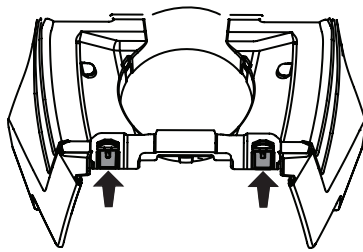

Figure 6



Hood Topper Not Shown for Clarity

Figure 7

Installing the Dash Cap (If necessary)

- To install the dash cap (a), line up the tabs (b) on the dash cap (a) with the holes in the upper dash as shown in Figure 8.
- Slide the tabs (b) into the holes in the upper dash and push forward on the dash cap (a) to lock into place.

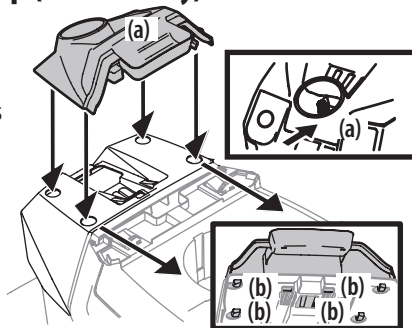

Figure 8

NOTE: Be sure to press on the lower part of the dash cap (a) facing the operator position to ensure the lower tabs on the dash cap are in place.

Installing the Steering Wheel (If necessary)

The hardware for attaching the steering wheel has been packed within the steering wheel, beneath the steering wheel cap. Carefully pry off the steering wheel cap and remove the hardware.

- With the wheels of the tractor pointing straight forward, align the steering wheel (a) by using the center-line (b) on the front of the steering wheel (a) pointing straight ahead and the flat section (c) of the steering wheel (a) facing toward the seat, place the steering wheel (a) over the steering shaft (d). See Figure 9.

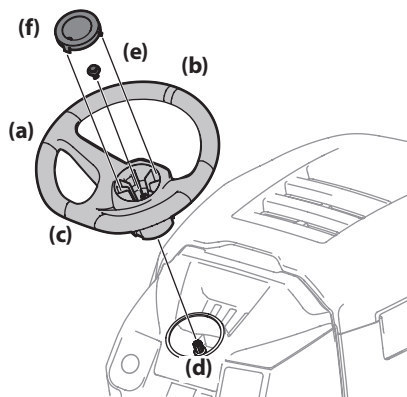

Figure 9

- Secure the steering wheel (a) with the hex bolt (e) from under the steering wheel cap (f) and torque to 18-22 ft-lbs (24.4-29.8 N-m).
- Place the steering wheel cap (f) over the center of the steering wheel (a) and push downward until it "clicks" into place.

NOTE: The hex bolt (e) securing the steering wheel (a) has thread locker applied to it, so if it is removed, it is recommended that the hex bolt (e) be replaced or thread lock re-applied.

Installing the Front Bumper (If necessary)

The hardware for attaching the front bumper is shipped installed into the bumper.

- Remove the four hex screws (a) from the bumper (b).
- Position the bumper brackets to the **inside** of the tractor's frame and secure it in place with the four hex screws (a). Torque to 332-405 in-lbs (37.5-45.75 N-m). See Figure 10.

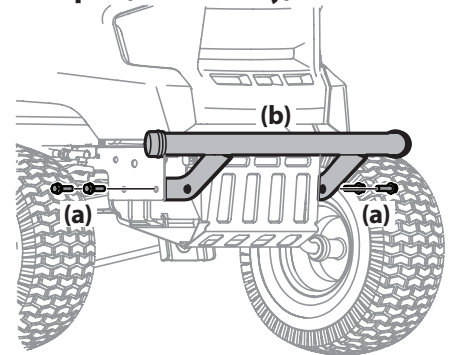

Figure 10

Adjusting the Seat

To adjust the position of the seat:

- Lift the seat adjustment lever up.
- Slide the seat forward or rearward to the desired position.
- Release the adjustment lever. Make sure seat is locked into position before operating the tractor. See Figure 11.

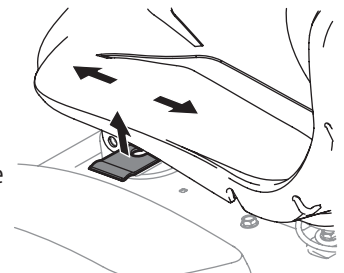

Figure 11

WARNING

Before operating the tractor, make sure the seat is engaged in the seat-stop. Engage the parking brake. Stand behind the tractor and pull back on seat until it clicks into place.

Checking Tire Pressure

See the tire sidewall for the proper inflation pressure. Proper inflation pressure should be maintained at all times.

NOTE: The tires on your tractor may be over-inflated for shipping purposes. If necessary, reduce the tire pressure before operating the tractor.

Setting the Deck Wheels (If equipped)

NOTE: The deck wheels are an anti-scalp feature of the deck and are not designed to support the weight of the cutting deck.

Move the tractor to a firm and level surface, preferably pavement, and proceed as follows:

- Check the tire pressure, make sure the pressure is correct per the inflation pressure listed on the sidewall.
- Make sure the deck is level, both front-to-back and side-to-side. See the Service and Maintenance section for deck leveling information and instructions.
- Select the height position of the cutting deck by placing the deck lift lever in the normally desired mowing height setting.

ASSEMBLY

- Check the wheels for contact or excessive clearance with the surface below. The deck wheels should have between 1/4" and 1/2" (6.4-12.7 mm) clearance above the ground. Proceed as follows to adjust the wheels:

- Raise the deck lift handle to its highest setting.
- Remove the front (a) and rear (b) deck wheels by removing the flange lock nuts (c) and shoulder bolts (d) that secure them to the deck. See Figure 12.

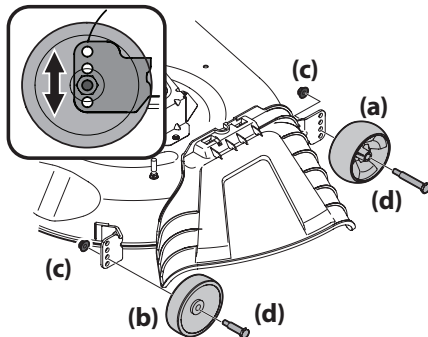

Figure 12

- Place the deck lift lever in the desired mowing height setting.
- Reinsert the shoulder bolt (with each deck wheel) into the index hole that leaves approximately 1/2" (12.7 mm) between the bottom of the wheel and the pavement. Tighten the flange lock nut and shoulder bolt to 25-30 ft-lbs (33.9-40.7 N-m).

NOTE: Refer to Adjusting the Deck in the Service and Maintenance section of this manual for more detailed instructions regarding various deck adjustments.

Charging the Battery

⚠ WARNING

- California Proposition 65: Cancer and reproductive harm – www.P65Warnings.ca.gov.
- The battery contains corrosive fluid and toxic material — HANDLE WITH CARE. Keep away from children. Do not puncture, disassemble, mutilate, or incinerate. Explosive gases could be vented during charging or discharging. Charge in a well ventilated area, away from sources of ignition.
- Recharge only with the charger provided with this tractor. A charger that is not suitable for this tractor may damage the batteries or create the risk of fire.
- Do not charge or operate the tractor in the rain or in wet conditions.

Refer to the manual packed with your battery charger (T56XXX Series) for further information and instructions on charging the battery. The charging port on the tractor is located on the left side of the dash.

To charge the battery:

- Lift the charging port cover (a). See Figure 13 for Style 1 and Figure 14 for Style 2.

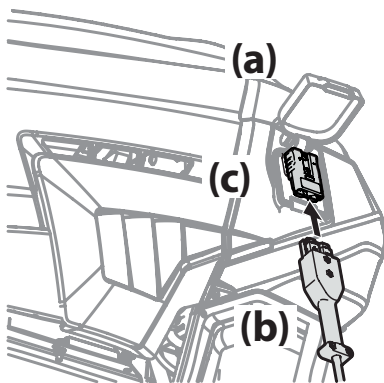

Figure 13

- Insert the charging cord (b) into the charging port (c). See Figure 13 for Style 1 and Figure 14 for Style 2.
- Plug charger power cord into wall receptacle (outlet).

NOTE: It will take approximately 4 hours to fully charge the battery.

NOTE: The battery icon on the Vehicle Control Module (VCM) will blink continuously when charging and the LCD display will display percentage of charge. The battery is completely charged when the battery icon is solid and the LCD displays 100%.

NOTE: When the charging cord is plugged into the tractor and not yet plugged into the wall, the battery icon will illuminate continuously until the cord is plugged into the wall.

If at any time your charger displays a fault while charging your battery, follow these procedures:

- Power off the tractor.
- Unplug the charging cord from the tractor.
- Unplug the charger power cord from the power source.
- Plug the charger power cord back into the power source.
- Plug the charging cord back into the tractor.
- If the fault persists contact qualified service personnel.

NOTE: Rechargeable batteries degrade with time and use. The battery may eventually need to be replaced. To have the battery replaced, contact your authorized service dealer.

NOTE: Using an old or faulty battery could cause a system fault that results in loss of power.

Battery Charging Tips

- The battery should be fully charged before initial use.
- The battery should be fully charged after each use. Storing the battery in a discharged state could reduce performance.
- The battery will turn off automatically after a complete charge.
- It will take approximately 4 hours to fully charge the battery. Leaving the battery connected to the charger for more than 4 hours will not damage the battery.
- The battery does not develop a memory and does not need to be fully discharged before recharging.
- Always disconnect battery charger (or extension cord, if used) from the electrical receptacle (outlet) first, then disconnect the charging cord from the charging port.
- Never charge a frozen battery.
- It is recommended that the tractor be charged once every month during off-season storage.

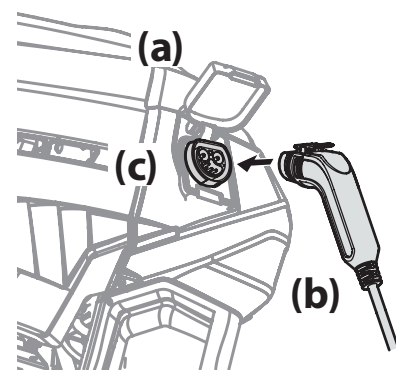

Figure 14