

SUPER 104[™] DECK WING FLEX FORKS[®] KIT

PART NUMBER: 606671

PACKING LIST:

Listed below are parts included in this kit. If any parts are missing or damaged, please contact the Hustler[®] Parts Department. Retain these instructions for replacement parts.

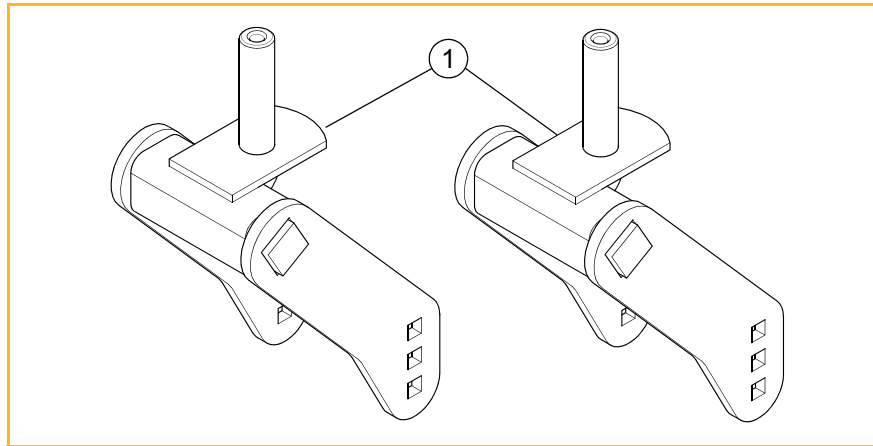

INDEX NO.	DESCRIPTION	QTY.
1	FLEX FORKS	2

ASSEMBLY:

1. Park the mower on a solid, level surface; set the park brakes; raise the deck wings; shut-off engine and remove ignition key.
2. Remove the front wheel and tire from the deck. Retain the hardware.
3. Remove the existing fork from the deck. Retain the hardware.
4. Attach the flex fork to the mower using the existing hardware. Make sure that all hardware is replaced exactly as it was removed. FIG. 1
5. Apply one drop of LocTite[®] 242 to the bolt threads, then torque the bolt to 75 ft-lbs (102 N•m). FIG. 1
6. Attach the wheel and tire to the new flex fork using the existing hardware. Tighten the nut, then back it off so the wheel spins freely. FIG. 1

7. Repeat steps 2–6 for the other side.
8. Apply grease to the zerks where applicable (see your Operator's Manual). The mower is now ready to operate.

NOTE: Flex forks when first installed will raise the front of the mower about 1" depending upon which model they are on. It is not necessary to re-level the deck at this point. The flex forks will settle after about 20 minutes of driving time. After operating for 20 minutes, if the flex forks are still higher than the original forks were, the deck can be re-leveled. Refer to the unit's general service manual for deck-leveling procedures.

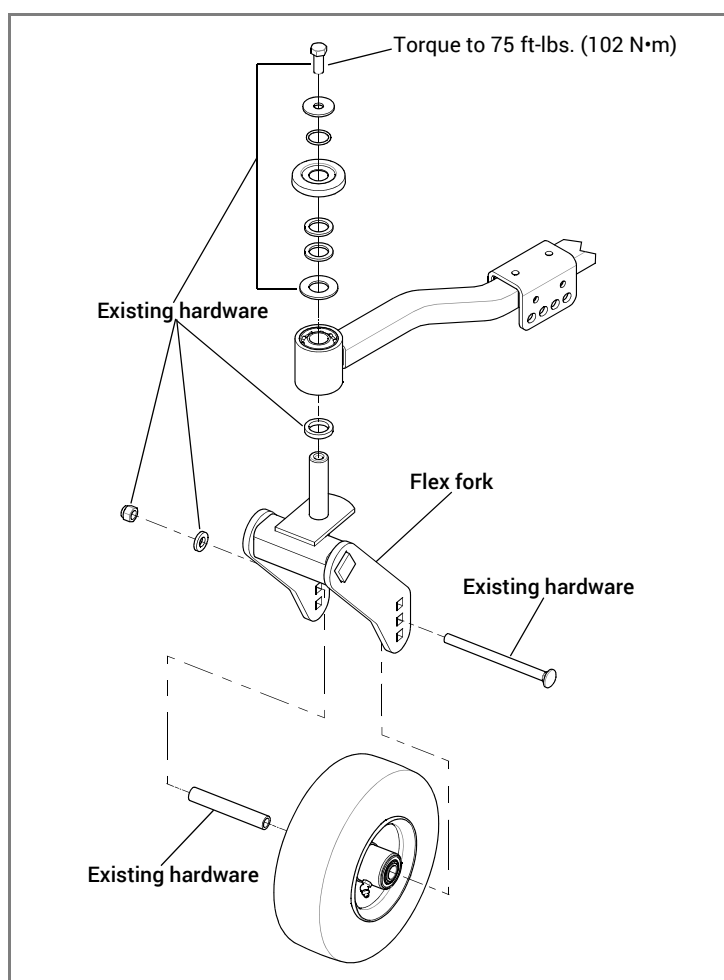

FIG. 1