

# SUPER 88 LIGHT KIT

**PART NUMBER:** 125987

**PACKING LIST:**

Listed below are parts included in this kit. If any parts are missing or damaged, please contact the Hustler® Parts Department. Retain these instructions for replacement parts.

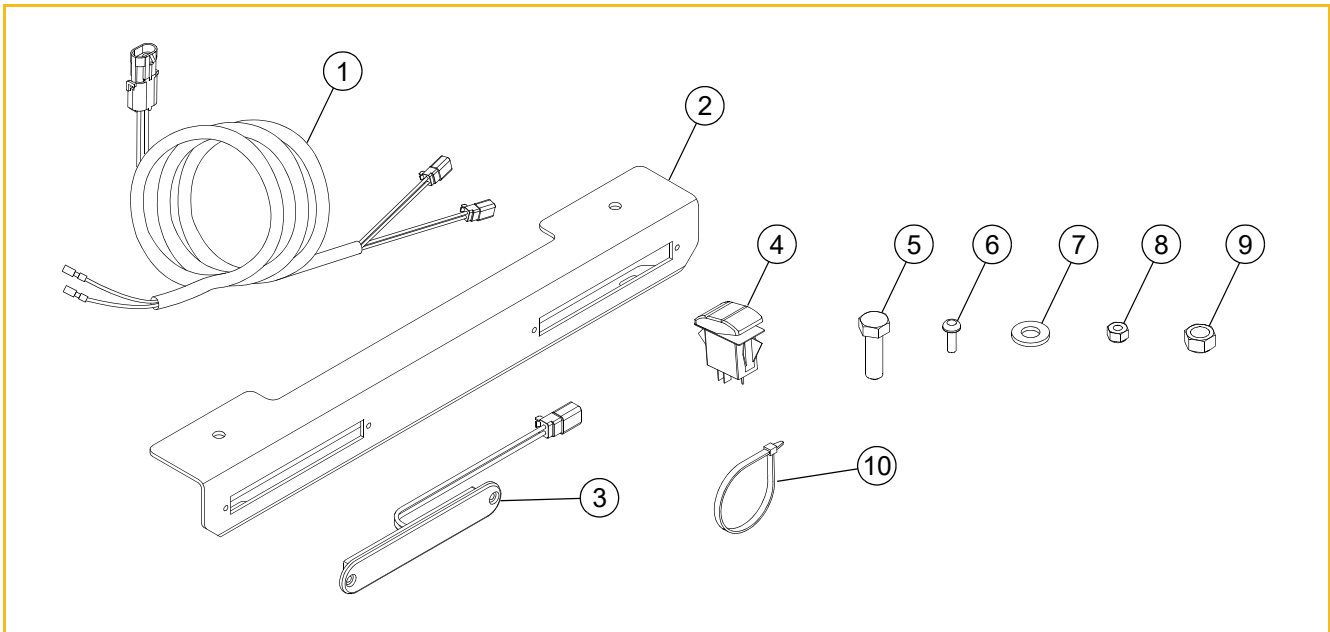

INDEX NO.	PART NO.	DESCRIPTION	QTY
1	607720	LIGHT HARNESS	1
2	125986-1	LIGHT SUPPORT	1
3	605003	LIGHT	2
4	601116	SWITCH	1
5	036236	CS .312-18 X 1.000 HX G5	2
6	605209	CS #8-32 X .500 PH TRX	4
7	768523	FW 0.343 SAE	4
8	605208	NT #8-32 HX G2 NL ZY	4
9	058776	NT .312-18 NL G5	2
10	000331	WIRE TIE	8



Use extreme caution if it becomes necessary to operate the unit, transporting or mowing, after dark or in low light situations. Only operate in open areas where there are no overhead obstructions; i.e. guide wires, tree branches, low overhangs, etc. Operate only in areas where the operator is thoroughly familiar with the terrain and any potential hazards. The lights are designed to illuminate forward and down and will not illuminate to the side or upward.

#### ASSEMBLY:

**NOTE:** Installing this light kit will require access to the mower's electrical system beneath the instrument panel. The following tools are needed:

- 7/16" and 11/32" wrenches
- T20 (Torx) screwdriver
- Utility knife or other sharp knife (for cutting the instrument panel decal)
- Side-cut pliers or equivalent (for trimming wire ties)



Shorts caused by battery terminals or metal tools touching metal mower components can cause sparks. Sparks can cause a battery gas explosion which will result in personal injury.

1. Park the mower on a solid, level surface; set the park brakes; shut off the engine; and remove the ignition key. Disconnect the negative battery cable.

2. Attach the lights to the light support using the hardware shown. FIG. 1

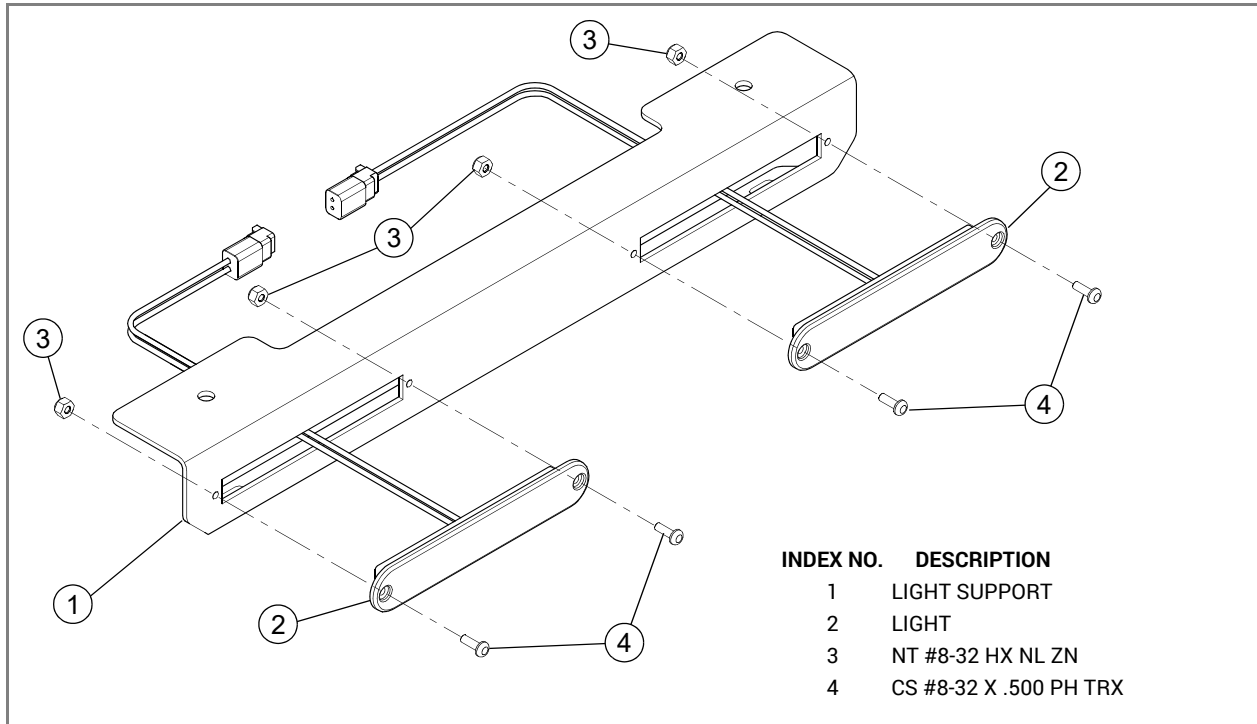

FIG. 1

**3. Mount the light bracket assembly to the frame using the hardware shown. FIG. 2**

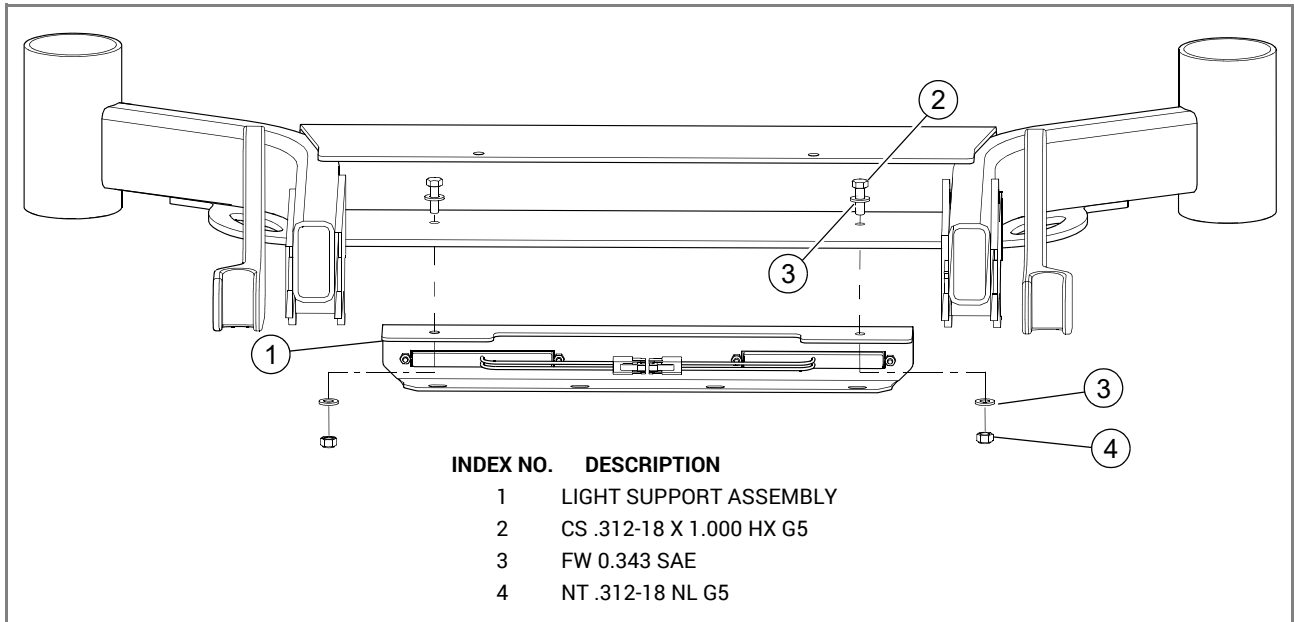

FIG. 2

**4. Connect the light harness to the lights. FIG. 3**

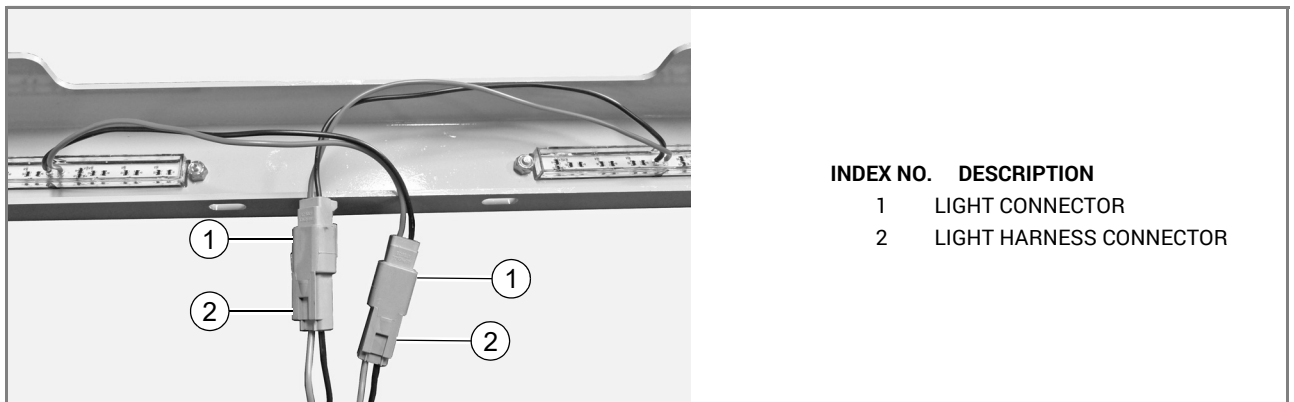

FIG. 3

5. Secure the light wires and light harness to the light support using the wire ties. FIG. 4

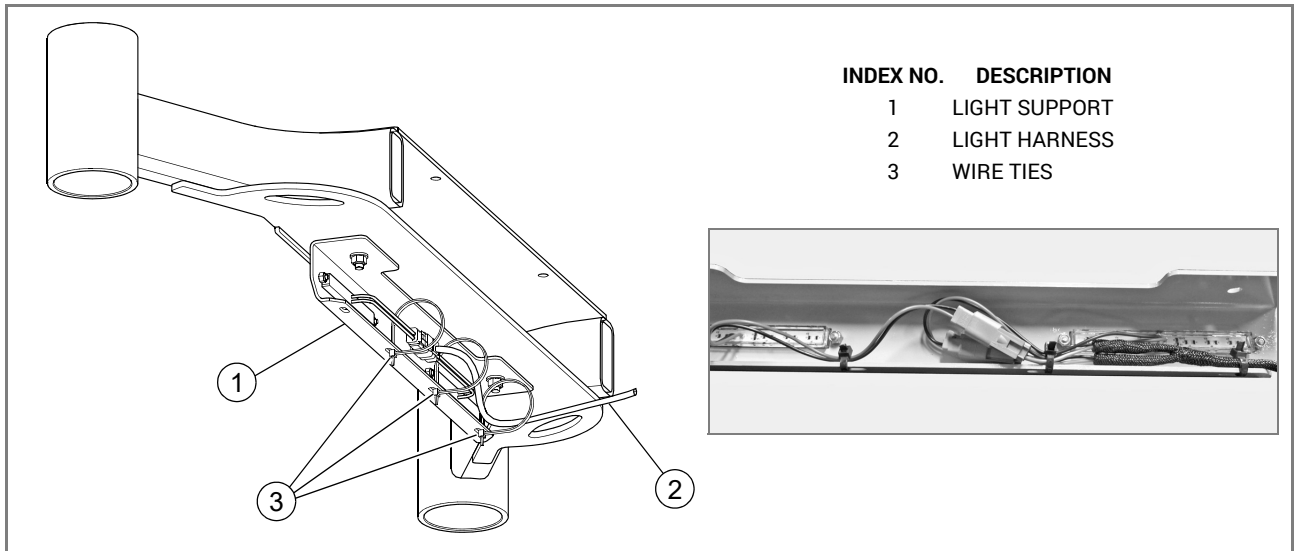

FIG. 4

6. Route the light harness along the inside of the right frame. Insert the wire ties through the holes in the mower frame and loosely secure the light harness in place with the wire ties. FIG. 5

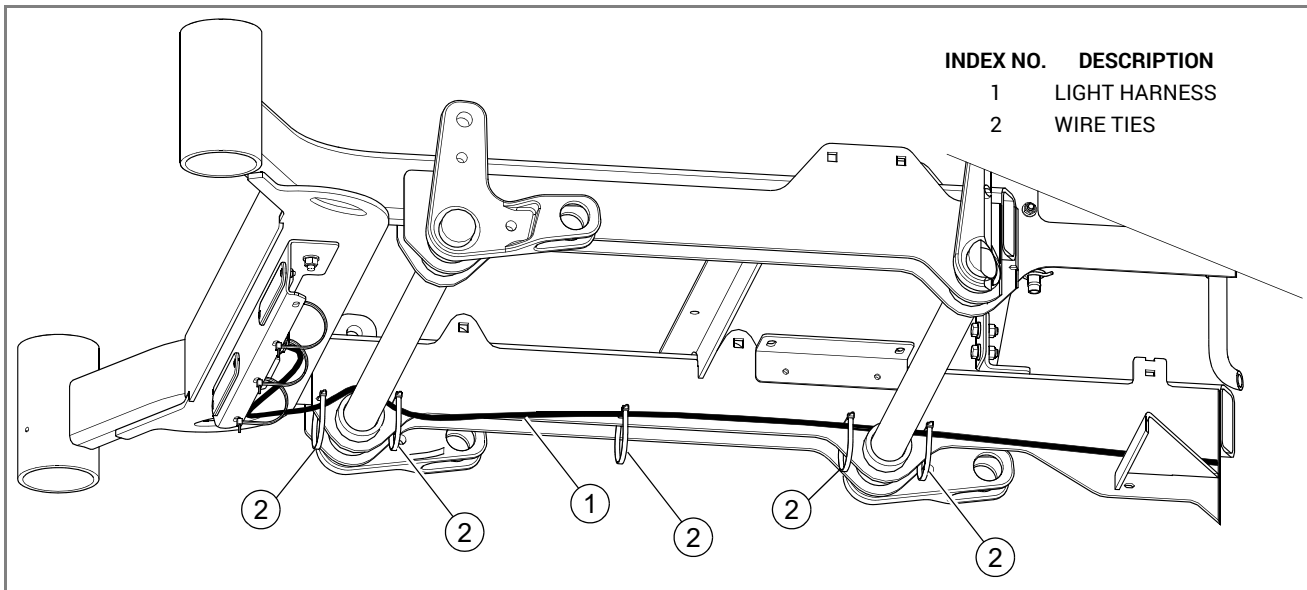

FIG. 5

7. Locate the auxiliary connector in the mower wire harness as shown in FIG. 6. Remove and discard the plug from the auxiliary connector.
  8. Plug the light harness connector into the mower wire harness auxiliary connector.
- FIG. 6

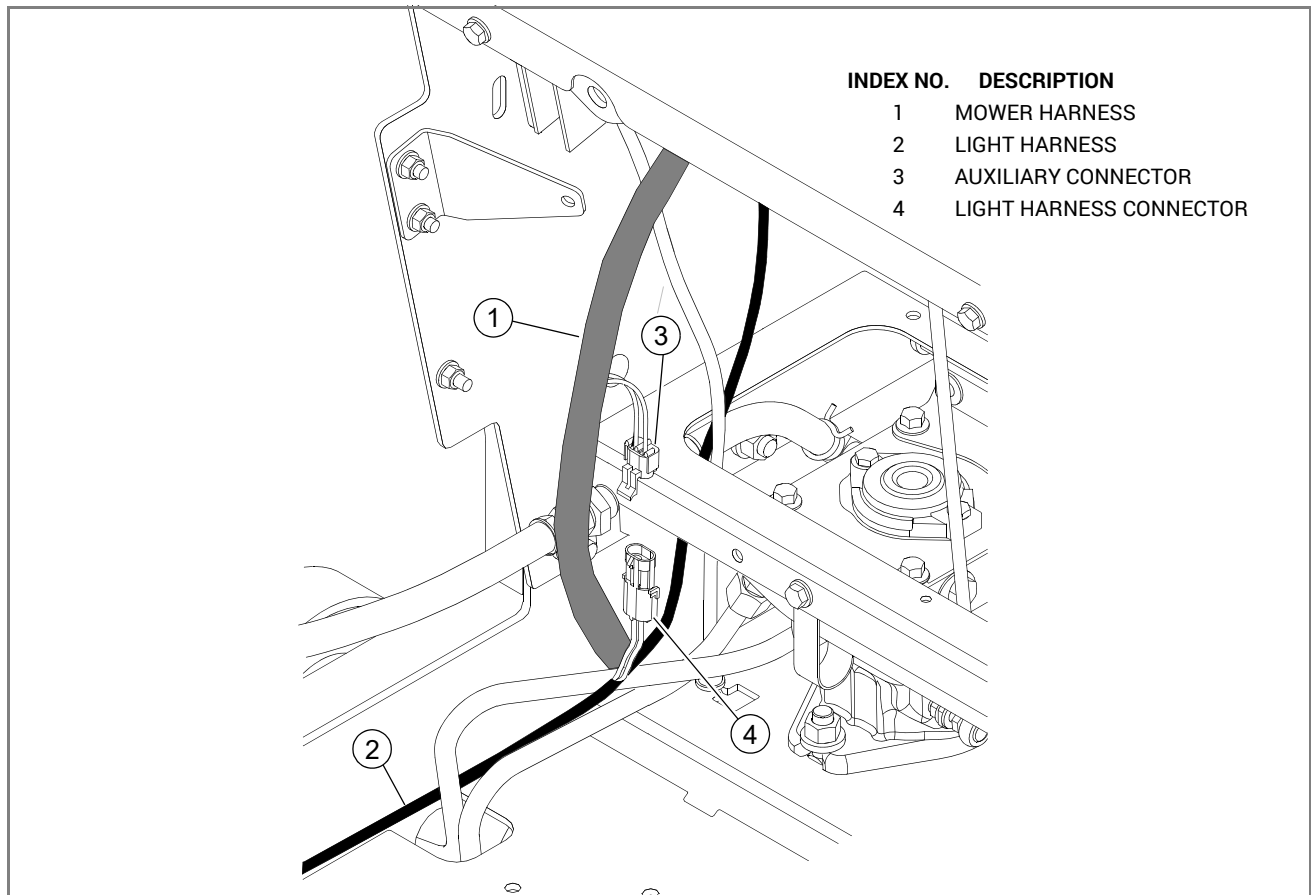

FIG. 6

9. Check the light harness routing and make sure the harness does not come in contact with any moving parts. Correct as necessary. Tighten the wire ties and cut off the excess wire tie ends. FIG. 7
10. Remove the hardware holding the control panel in place. Keep the hardware. Pull the panel up and out to access the back of the control panel. FIG. 7
11. Locate the rectangular panel tab between the deck clutch switch and the hour meter in the control panel. Using the panel tab as a guide, cut through the decal from the back of the control panel. Finish cutting the decal from the front side of the control panel if necessary. FIG. 7
12. Use a small pry bar to remove the panel tab. FIG. 7

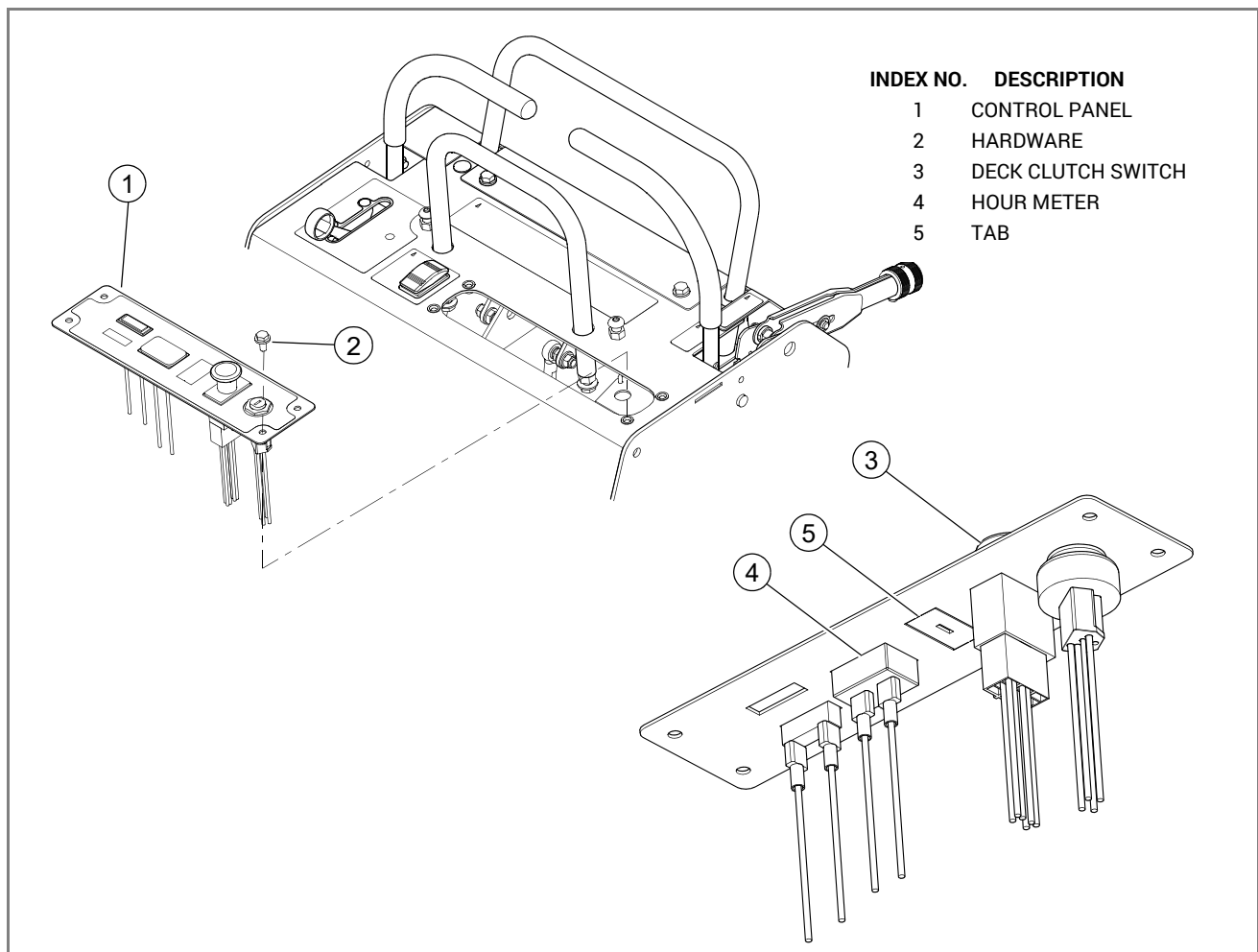

FIG. 7

13. Insert the light switch into the cut-out, oriented as shown in FIG. 8. It will snap into place.

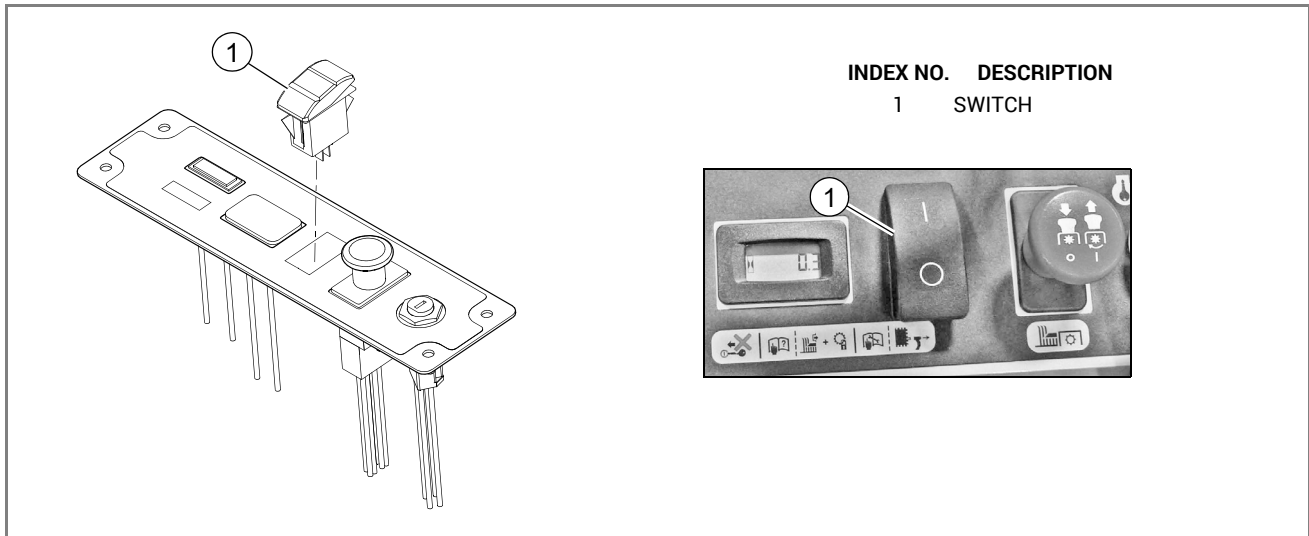

FIG. 8

14. In the control panel wiring area, locate the light harness and connect the two female blade terminals to the back of the light switch (polarity is not critical). FIG. 9

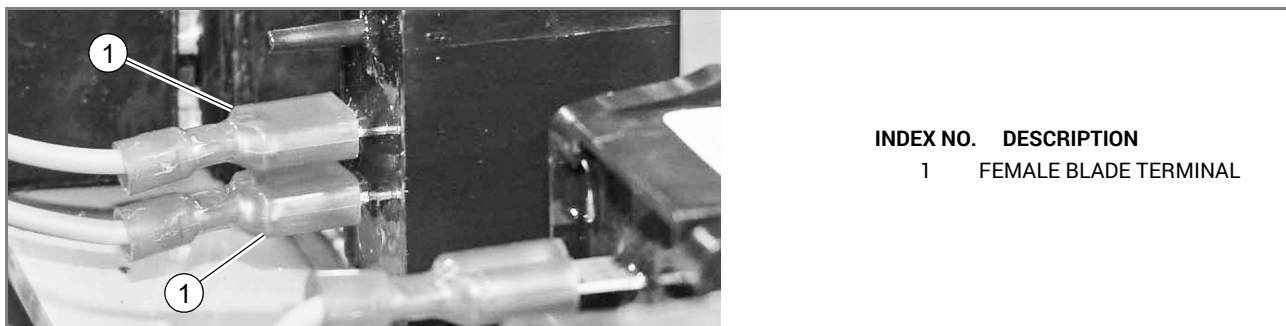

FIG. 9

15. Install the instrument panel.  
16. Connect the negative battery cable.  
17. The mower is ready to operate.