

Packing List

This kit is for side catcher 125225. This kit is intended to be a permanent installation. Listed below are parts included in this kit. If any parts are missing or damaged, please contact Excel Parts Department. Retain these instructions for replacement parts.

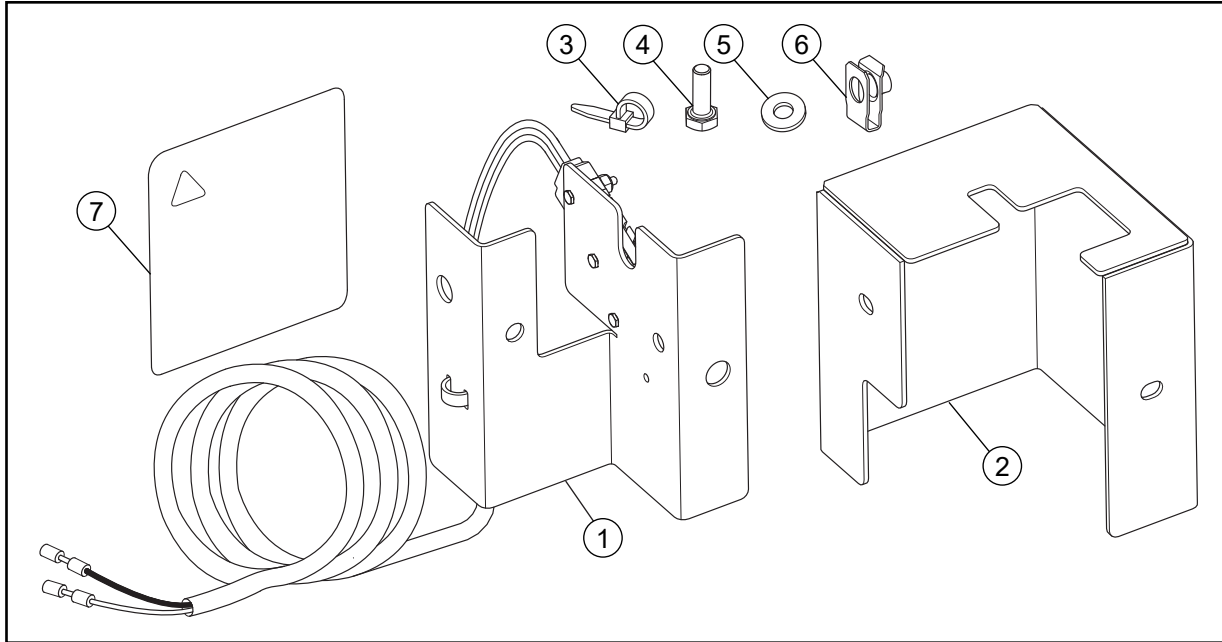

INDEX NO.	PART NO.	DESCRIPTION	QTY
1	125117-3	SWITCH MOUNT PLATE,	1
2	554995	SWITCH COVER	1
3	000331	WIRE TIES, SMALL	3
4	055939	CS .250-20 X 0.75 HX G5 ZY	2
5	768515	FW 0.281 SAE	2
6	601982	CN .250-20 X .150 MAX THK	2
7	607352	SAFETY DECAL	1

Safety and Instruction Decals

The decals are designed to give the operator brief information needed in the daily operation and service of the mower. These decals are not intended to be used in place of this manual but instead are to be used as an extension of this manual. These decals should not be removed or obliterated. Replace these decals if they become unreadable.

It is the owner's responsibility to make certain that the operators and mechanics read and understand this manual and all decals before operating this mower.



It is also the owner's responsibility to make certain that the operators and mechanics are qualified and physically able individuals, properly trained in the operation of this equipment.

All operators and mechanics must become familiar with the safe operation of the equipment, operator controls and decals.

Never let children or untrained people operate or service the equipment. Local regulations may restrict the age of the operator.

The owner/user can prevent and is responsible for accidents or injuries occurring to themselves, other people or property.

The owner should also ensure that the operators/mechanics know that they are responsible for their own safety as well as the safety of other persons within the vicinity. Remember, the operator is responsible for accidents or hazards occurring to other people or their property.

 **WARNING** 

Specific safety warning decals are located on the equipment near the immediate areas of potential hazards. These decals should not be removed or obliterated. Replace them if they become non-readable.

Refer to the mower's operator's manual for illustrations showing the various safety decals that are located on the mower. A brief explanation, for those requiring one, is shown to help the operator understand the meanings of these decals.

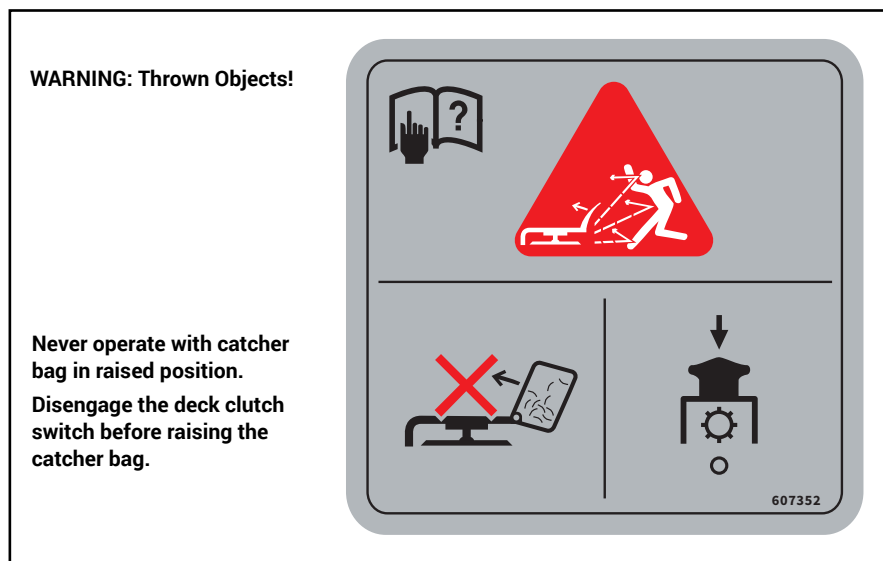

FIG. 1

Assembly

1. Park the mower on a solid, level surface; set the park brakes; shut-off the engine; and remove the ignition key. (Disconnect the negative battery cable.)
2. Remove the catcher bag. Fig. 2

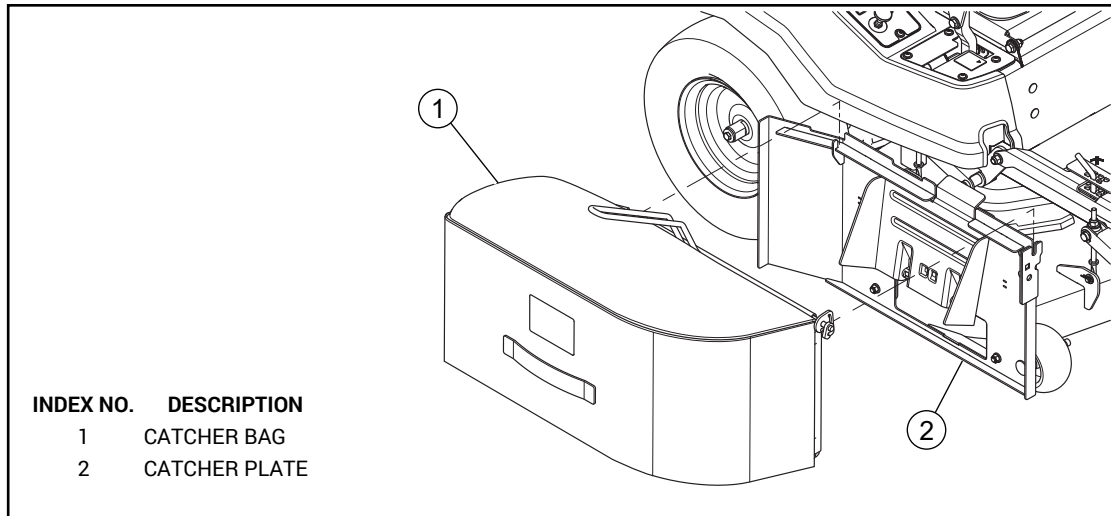

FIG. 2

3. Remove the top set of existing hardware from the catcher plate as shown. Fig. 3

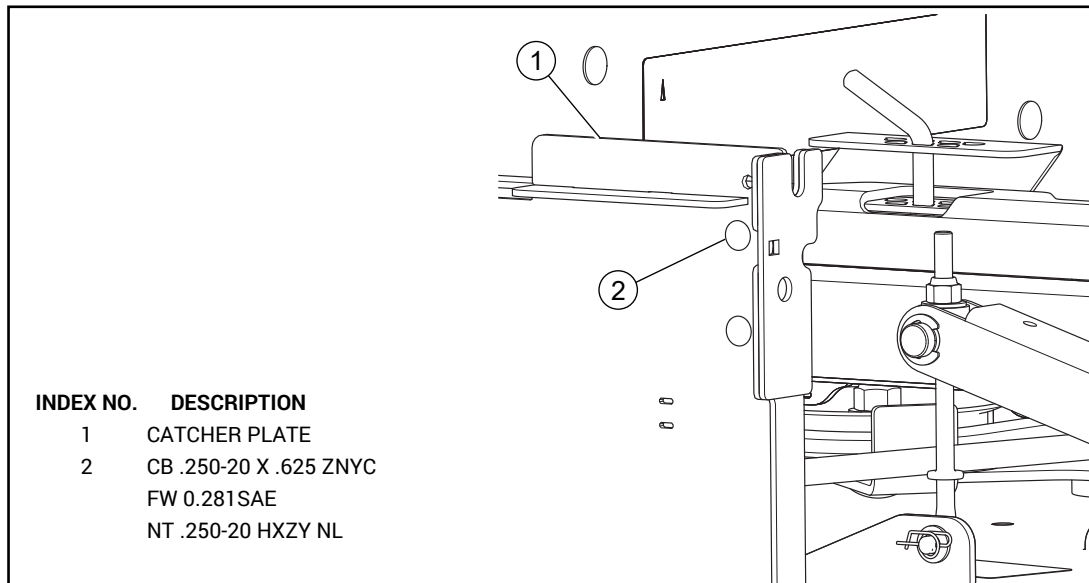

FIG. 3

4. Attach the switch plate to the catcher plate with the existing hardware. Fig. 4

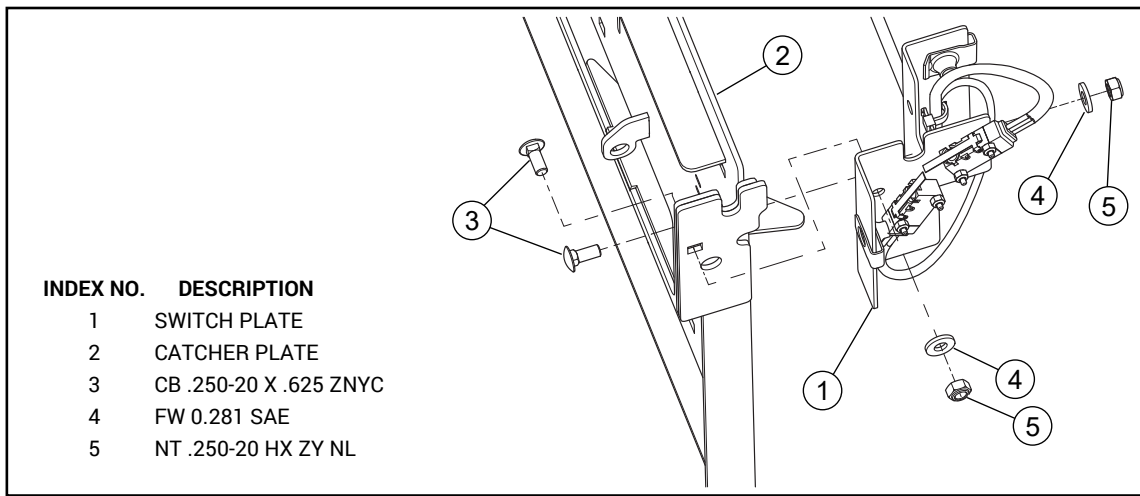

FIG. 4

5. Attach the switch wire harness to the backside of the catcher plate with the wire ties in the first two places as shown. Do not install the rear wire tie at this time. Fig. 5

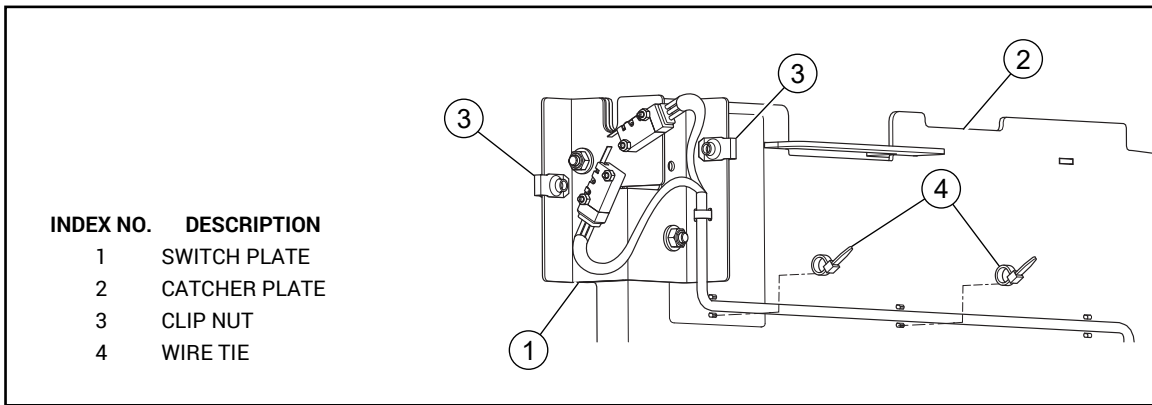

FIG. 5

6. Slide the switch cover into place and secure with the hardware provided. Fig. 6

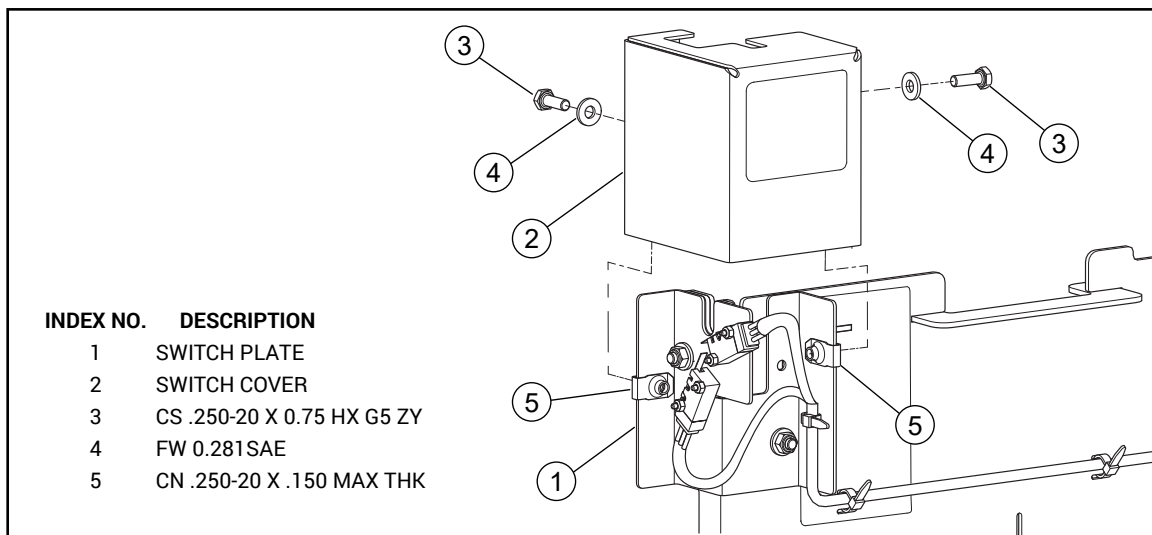

FIG. 6

7. Locate and unplug the mower wiring harness connector from the deck clutch switch.

8. Locate the orange wire with the red stripe. Cut the orange wire with the red stripe about 5" from the connector. Strip 1/4" of the covering from each side of the cut wire. Fig. 7
9. Locate the red wire connector on the dump from seat kit wire harness. Insert the orange/red wire that is coming from the deck clutch switch harness connector into the connector on the red wire and crimp securely. Fig. 7
10. Insert the orange/red wire coming from the mower wire harness into the connector on the black wire coming from the dump from seat kit wire harness and crimp securely. Fig. 7

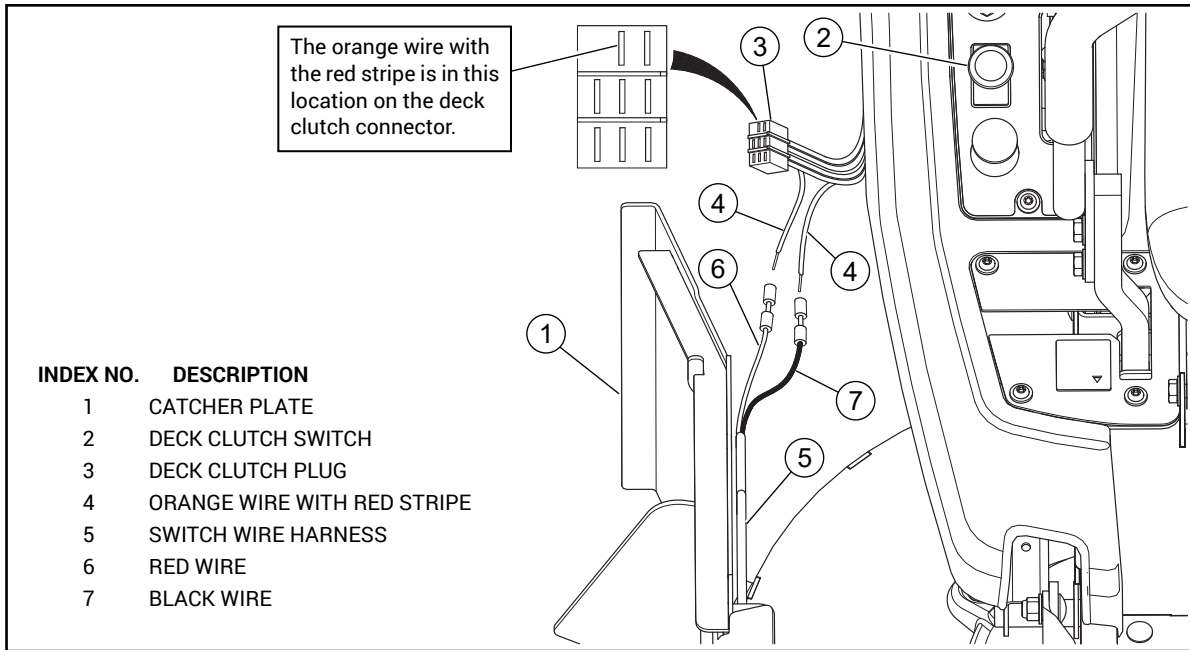

FIG. 7

11. Coil the excess DFS wire harness from the DFS switch. Secure with the wire tie. Fig. 8

WARNING

Make sure to leave enough of the wire harness loose for full range of moving the deck through different cutting heights.

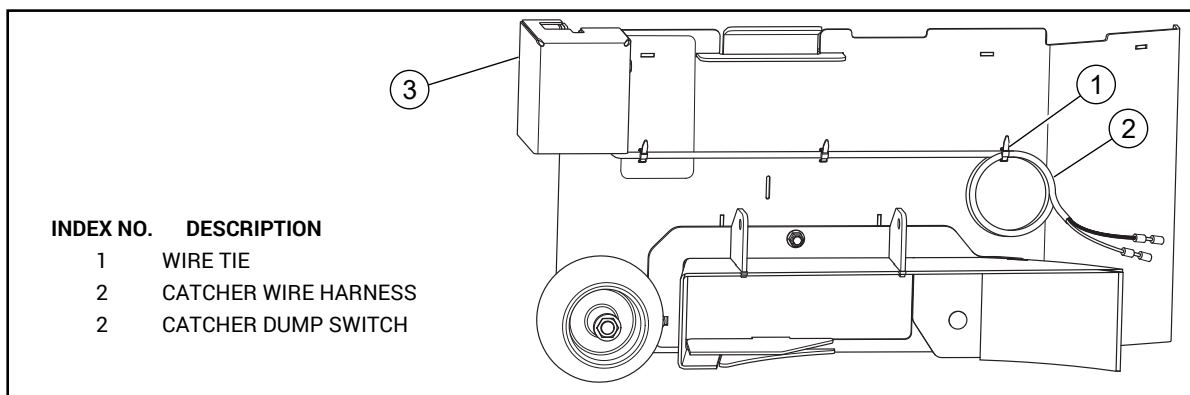

FIG. 8

12. Remove the excess material from the catcher washer to allow the bag assembly to pivot for dumping.
IMPORTANT: Do not remove too much material. Make sure no burrs exist on the catcher washer. Fig. 9

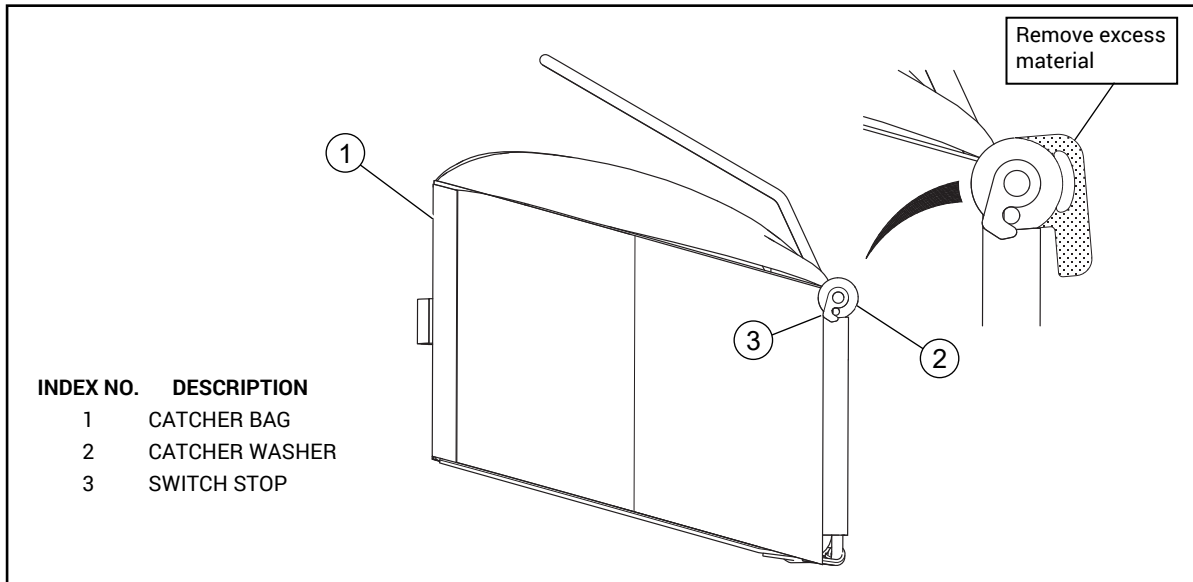

FIG. 9

13. Raise the catcher chute to the upright position. Fig. 10

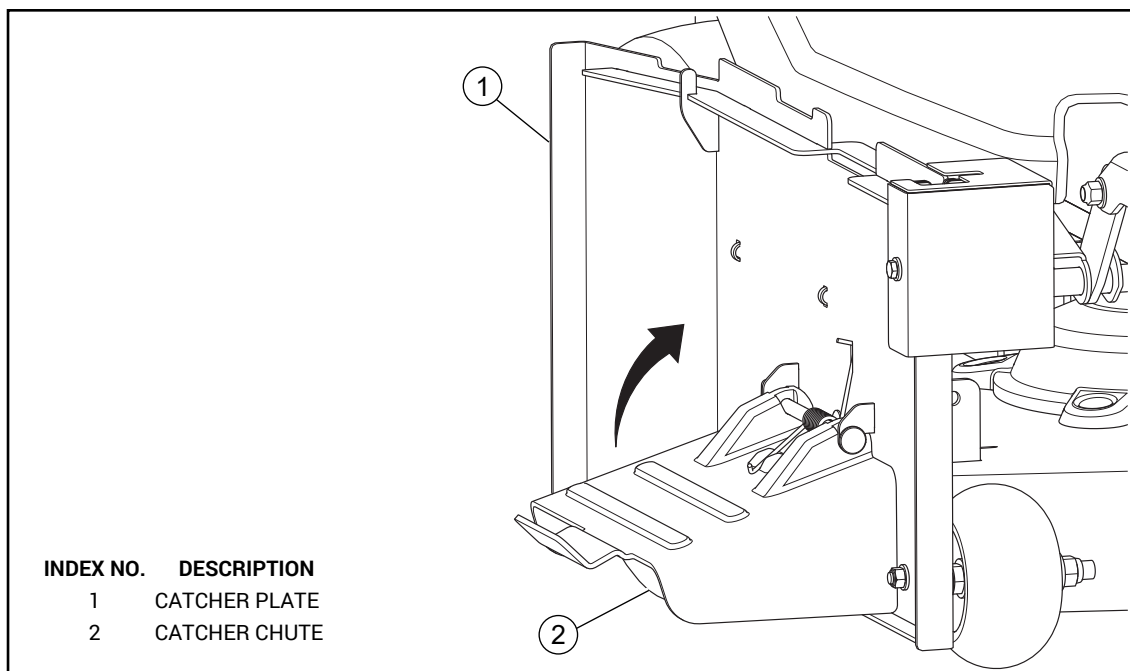

FIG. 10

14. Install the catcher bag. Make sure the switch stop is correctly inserted into the DFS switch assembly. Fig. 11

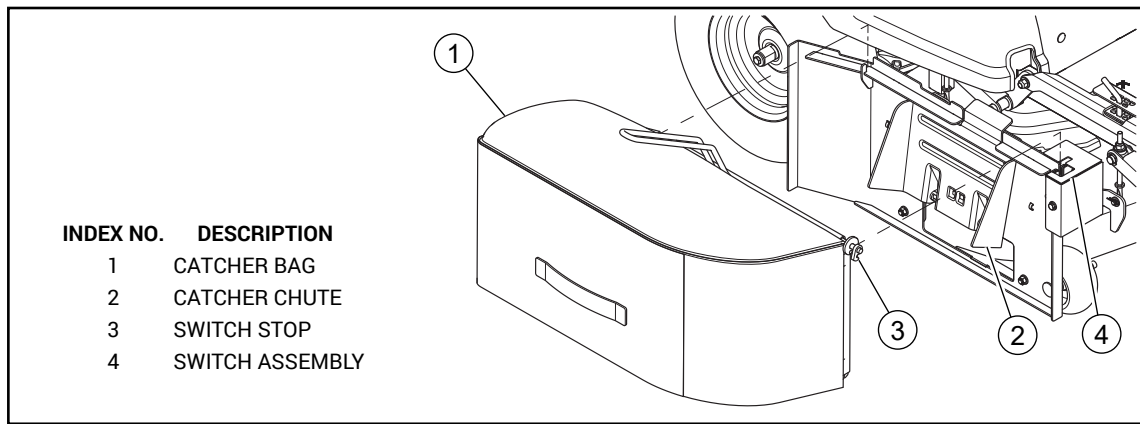

FIG. 11

15. Connect the negative battery cable.

Check the Catcher Switch.

16. From the operator's position, place both steering control levers in the park brake position. Start the engine and allow it to warm up to operating temperature.
17. Make sure the surrounding area is clear of bystanders. Engage the deck clutch switch. Raise the handle on the catcher bag toward the seat. Make sure the deck clutch disengages. Fig. 12
18. Lower the handle on the catcher bag to make sure the deck clutch engages. Fig. 12

NOTE: During normal operation it is recommended the operator disengage the deck by depressing the deck clutch switch. The mower can be driven away from clippings and the operator can lower the bag into operating position.

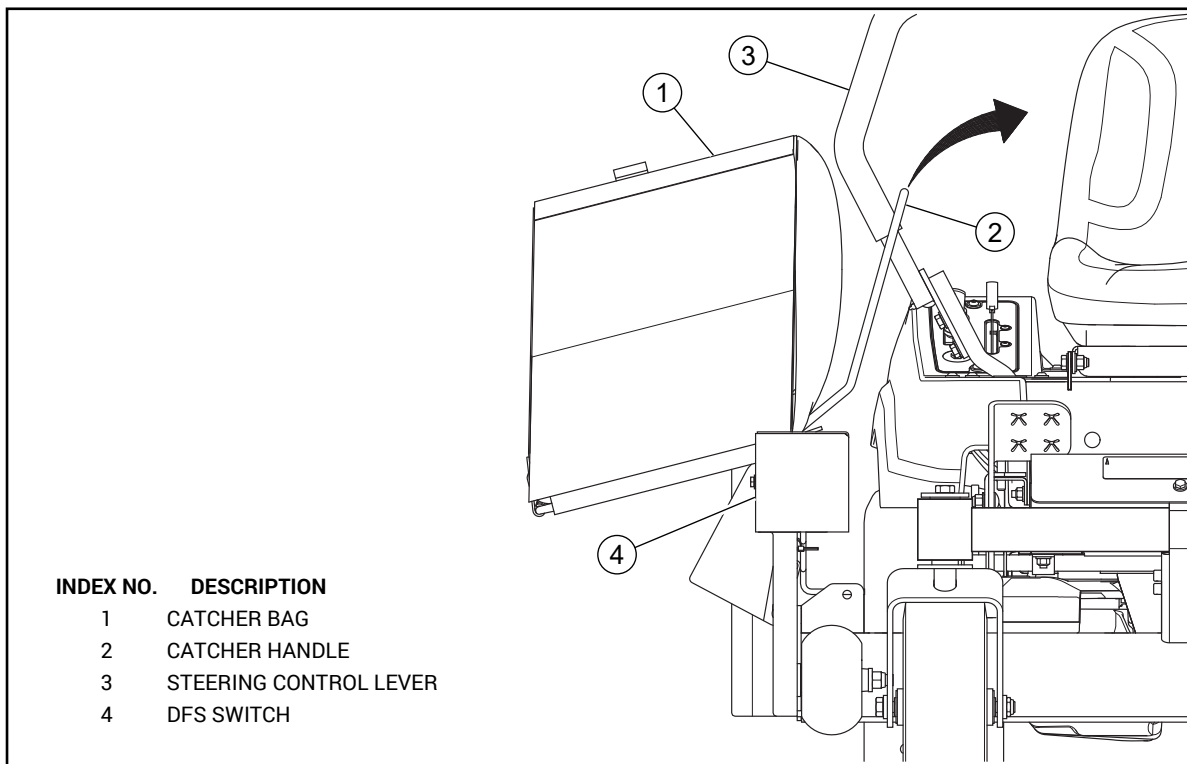

FIG. 12

19. The mower is ready for use.
20. To convert the mower to side discharge remove the catcher bag. The catcher discharge chute will automatically drop into place. The mower is ready to operate in the side discharge mode.

Operating

When the catcher is in operating position both switch plungers are fully depressed. Fig. 13

In the operating mode the bag presence switch and the bag closed switch are fully depressed. In the dumping mode the bag closed switch is disengaged. The deck will automatically disengage.

NOTE: During normal operation it is recommended the operator disengage the deck by depressing the deck clutch switch. The mower can be driven away from clippings and the operator can lower the bag into operating position.

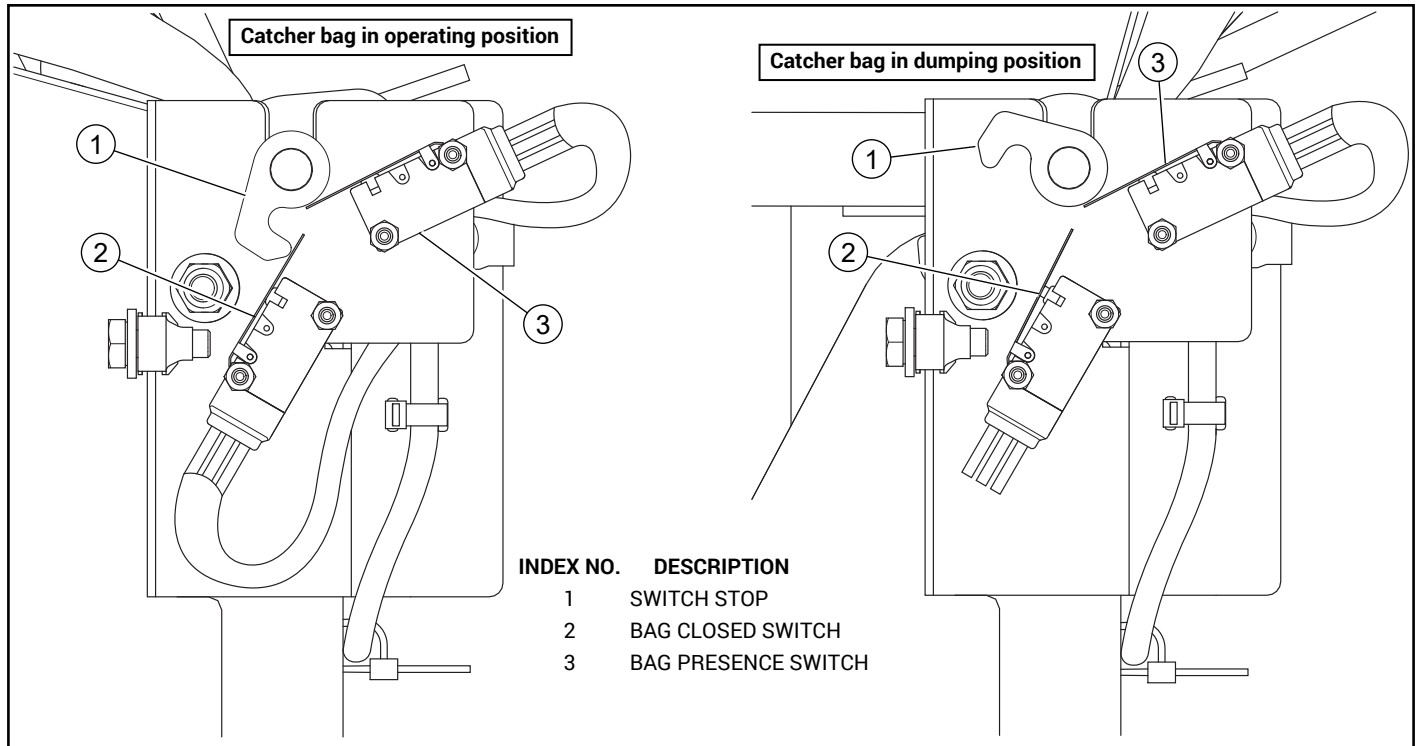

FIG. 13

If you continue to catch grass after the dust baffle has deflated you may need to remove blockage that has clogged the deck. Fig. 14



DANGER



Stop the engine before removing the grass catcher or unclogging the discharge chute. Never clear the discharge chute with the engine running. Turn off the engine and be sure the blades have stopped before cleaning. Use a stick to clear a plugged discharge area.

Never use your hand!

Remove bag assembly from catcher mount after the blades have stopped. Use a stick to clear the discharge area. Never use your hand to clear debris from the discharge area.

The air flow dust baffle inflates during operation. The air flow dust baffle begins to deflate as the catcher bag fills. Empty the catcher bag before the air flow dust baffle completely deflates. Fig. 14

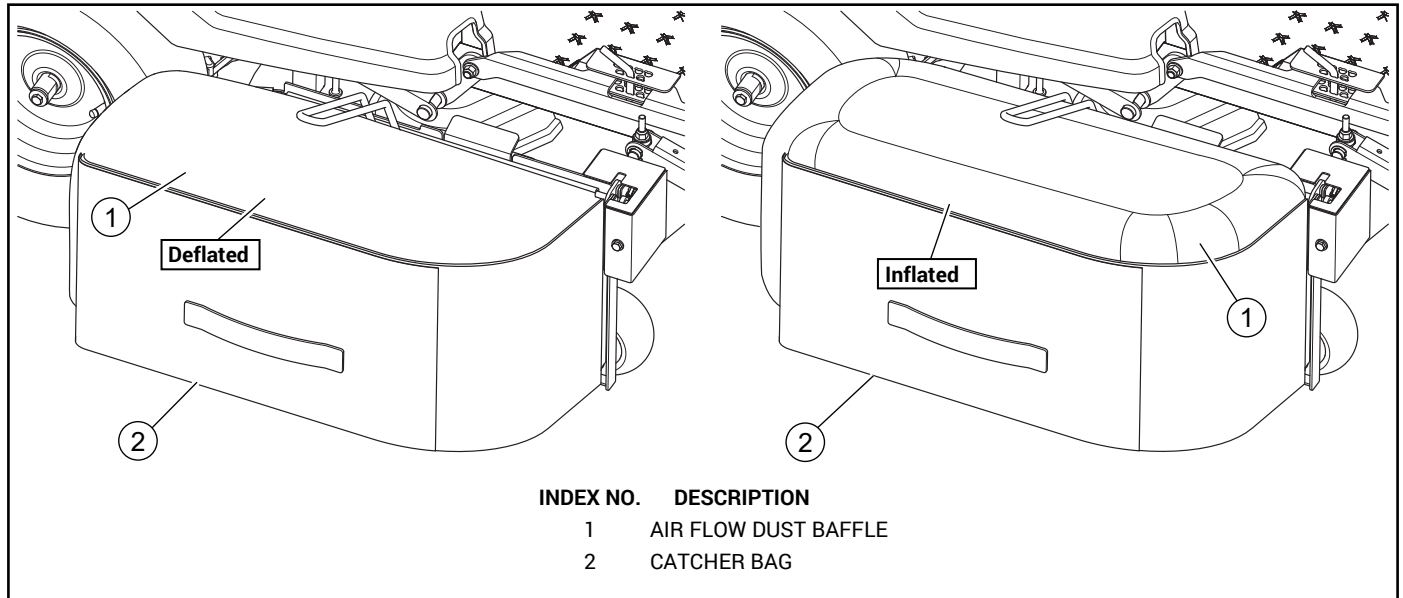

FIG. 14

Trouble Shooting

Mower will not start:

- Check that the negative battery cable is connected.
- Check that the steering levers are in the outward (park) position.
- Check that the deck clutch switch is fully depressed (off position).
- Contact your dealer.

Deck will not engage:

- Inspect catcher bag assembly to insure it is seated properly and switches are engaged.
- Clean grass clipping and other debris from unit. Never use high pressure water to clean the mower especially around the switches as damage can occur.
- Inspect all wires for damage or loose connections.
- Check the connector to the deck clutch switch to ensure it is pushed all the way onto the switch.
- Contact your dealer.

Deck will not disengage while dumping:

- Turn machine off and remove the key.
- Inspect switches to ensure hardware has not become loose or switches have become damaged.
- Never operate catcher with switch cover plate removed.
- Contact your dealer.

Blades do not turn when engaging deck:

Inspect catcher bag assembly to insure it is seating properly and engaging switches.

Clean grass clipping and other debris from unit. Never use high pressure water to clean unit, especially around the switches as damage can occur.

Inspect all wires and switches for damage or loose connections.

Contact your dealer.

Bag not filling all the way:

Slow down. Driving too fast for conditions may result in deck becoming clogged.

Cut less material at a time. See Excel Side Catcher Manual (P/N 125225) for further operation instructions.

Use standard blades that came with unit. Keep blades sharp. Check deck for being level with a ¼" pitch from front to rear.

Check for damaged bag. Replace any worn or damaged parts.

Contact your dealer.

Unable to rotate bag assembly for dumping clippings:

Inspect bag assembly for correct removal of tab. See steps 12 & 13, Fig. 9 & Fig. 10.

Contact your dealer.

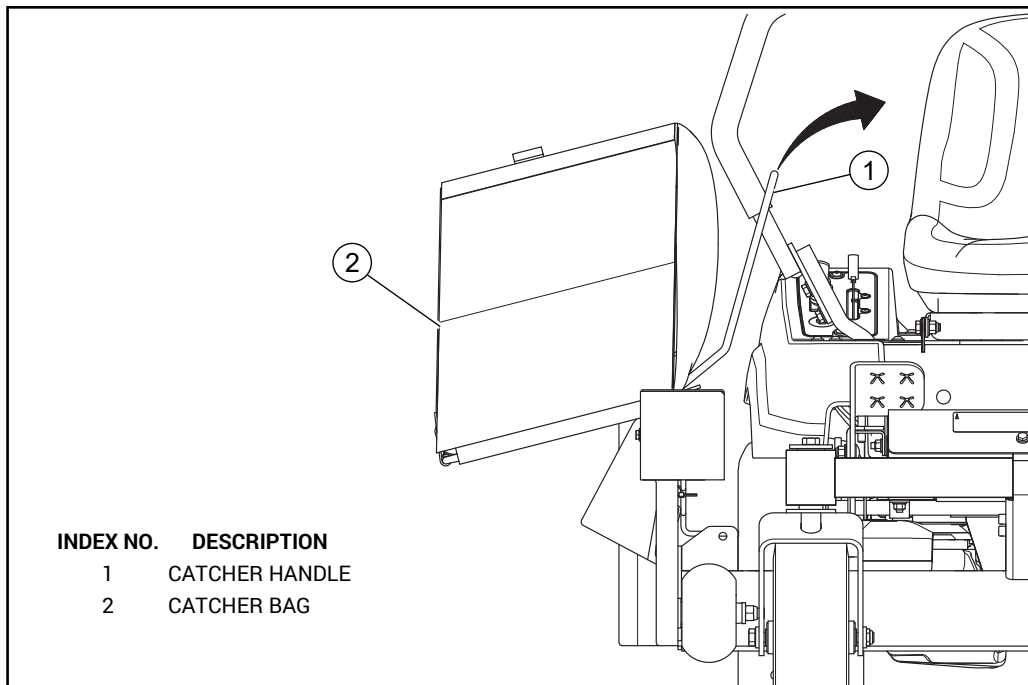

FIG. 15