

ENGINE GUARD KIT

PART NUMBER: 121696

PACKING LIST:

Listed below are parts included in this kit. If any parts are missing or damaged, please contact the Hustler® Parts Department. Retain these instructions for replacement parts.

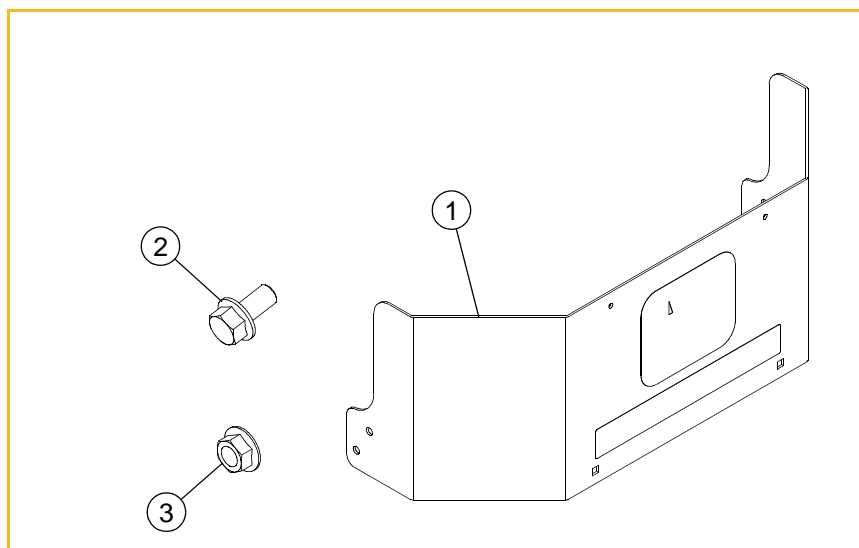

INDEX NO.	PART NO.	DESCRIPTION	QTY.
1	552968	ENGINE GUARD (WITH DECAL)	1
2	029629	CS .375-16 X .75 HX FLK	4
3	016899	NT .375-16 HX FLK ZNYC	4



WARNING



Allow the engine and muffler to cool before beginning installation.

ASSEMBLY:

1. Park the mower on a solid, level surface; set the park brakes; shut-off the engine; and remove the ignition key.
2. Remove the existing hardware as shown in FIG. 1.
3. Attach the engine guard to the rear of the mower frame using the hardware provided, as shown in FIG. 1. The right and left sides are similar.

NOTE: Make sure the engine guard does not make contact or interfere with the engine air cleaner.

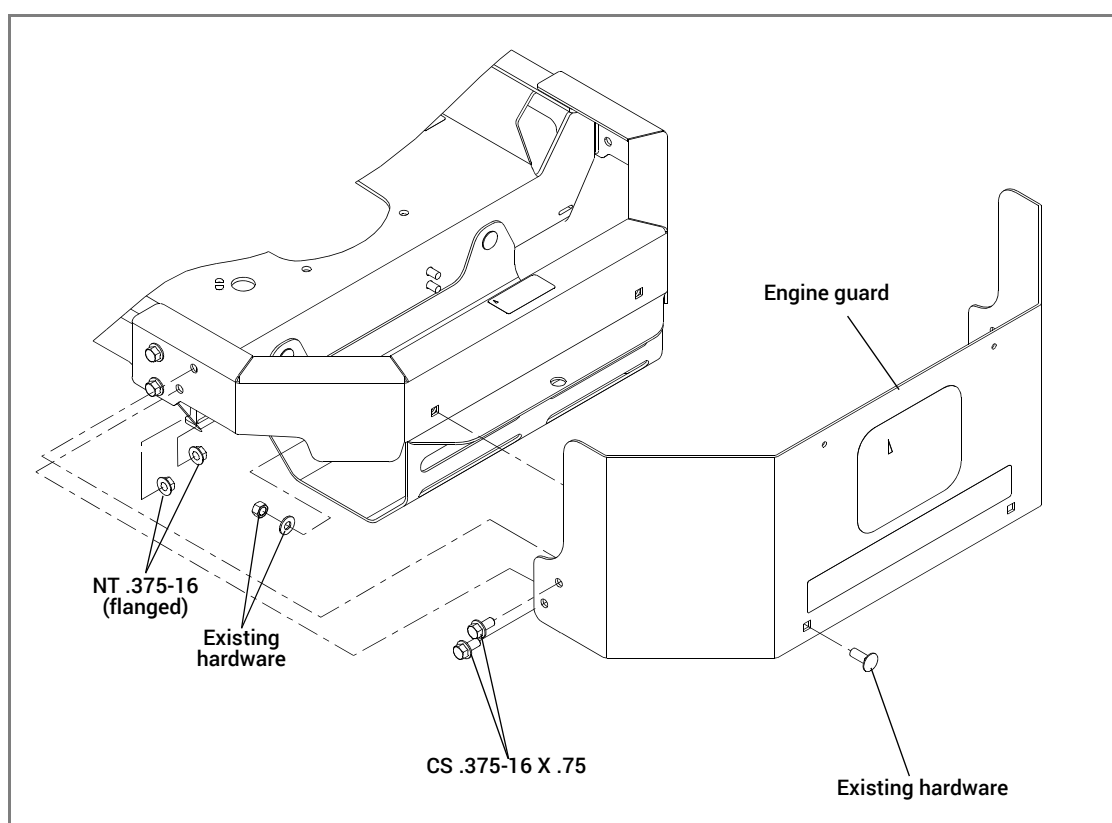
**FIG. 1**