

Packing List

Listed below are parts included in this kit. If any parts are missing or damaged, please contact the Hustler® Parts Department. Retain these instructions for replacement parts.

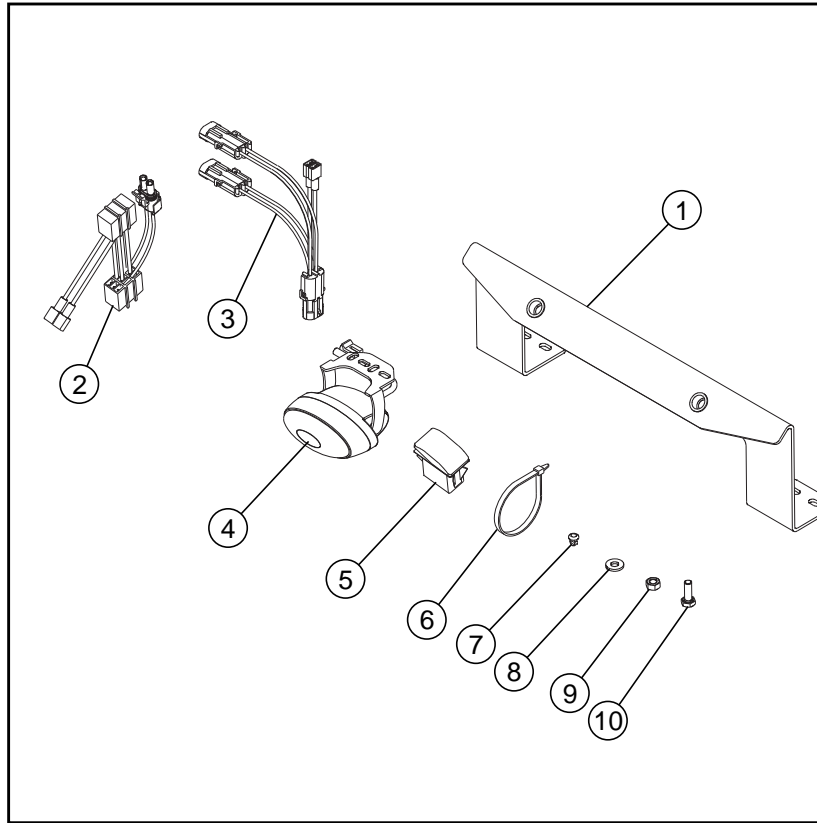

INDEX NO.	PART NO.	DESCRIPTION	QTY.
1	552721	BRACKET	1
2	604506	KEY SWITCH PIG TAIL	1
3	601832	WIRE HARNESS	1
4	601831	12 VOLT OVAL LIGHT	2
5	601116	SWITCH	1
6	000331	WIRE TIE	7
7	604307	PUSH BUTTON MOUNT	3
8	768515	FW .281 X .625 X .051/.080H	8
9	024927	NT .250-20 HX G5 ZNYC	4
10	055939	CS .250-20 X .75 HX G5	4



WARNING



Use extreme caution if it becomes necessary to operate the unit, transporting or mowing, after dark or in low light situations. Only operate in open areas where there are no overhead obstructions; i.e. guide wires, tree branches, low overhangs, etc. Operate only in areas where the operator is thoroughly familiar with the terrain and any potential hazards. The lights are designed to illuminate forward and down and will not illuminate to the side or upward.

Installing this light kit will require access to the mower's electrical system beneath the instrument panel and the battery area beneath the seat. The following tools are needed:

- 7/16" and 9/16" wrenches,
- Utility knife or other sharp knife (for cutting the instrument panel decal),
- Side cut pliers or equivalent (for trimming wire ties).

Assembly

1. Park the mower on a solid, level surface; set the park brakes; shut-off the engine; and remove the ignition key.
2. Lift the seat and disconnect the negative battery cable.



WARNING



Shorts caused by battery terminals or metal tools touching metal mower components can cause sparks. Sparks can cause a battery gas explosion which will result in personal injury.

3. Access the wiring connections and the bottom of the instrument panel on the right side fender by removing the 1/4" bolt, lifting the front edge of the instrument panel, sliding it forward and lifting it far enough away from the fender to allow disconnecting the ignition switch (Fig. 1).
4. Locate the rectangular opening to the rear of the ignition switch in the instrument panel. Using the panel as a guide, cut a rectangular hole in the instrument panel decal for the switch (Fig. 1).
5. Insert the switch into the rectangular cut-out oriented as shown in Fig. 2. It will snap into place.

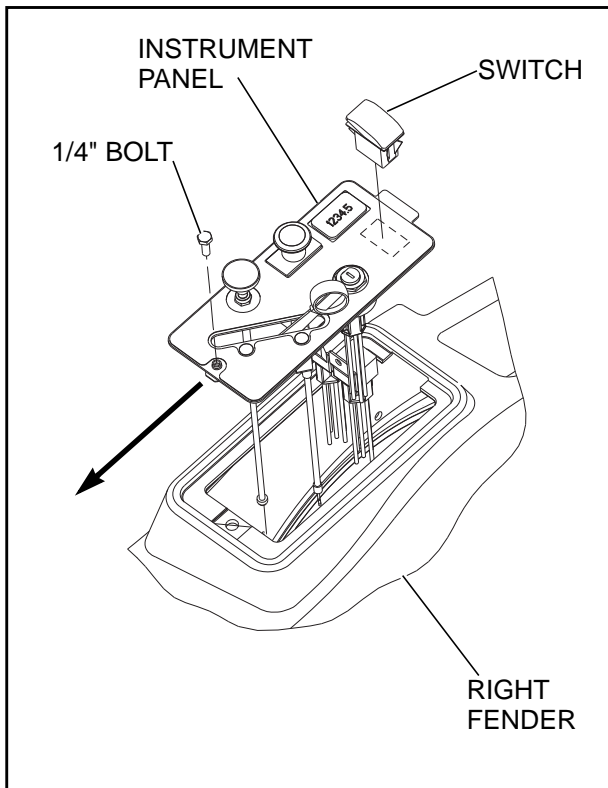

FIG. 1

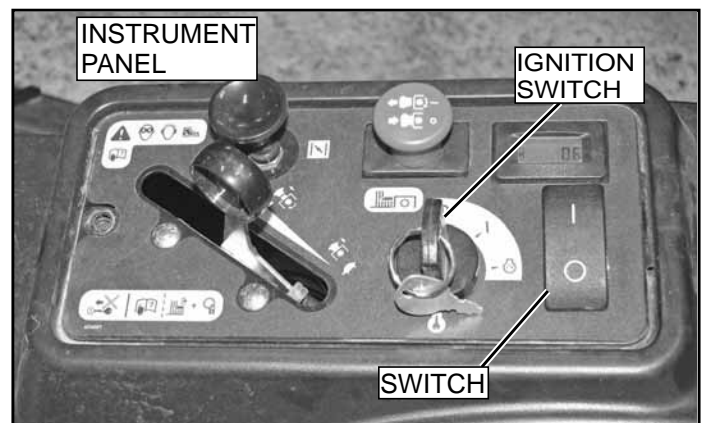

FIG. 2

6. Route the new wire harness from the inside area beneath the seat through the opening in the bottom of the right fender into the instrument panel opening. (Fig. 3).
7. Connect the pigtail harness to the ignition switch and to the mower's wire harness (Fig. 4).

8. Connect the weather pack connector on the wire harness to the weather pack connector on the pig tail harness and the female blade terminals on the wire harness to the switch (polarity is not critical). (Fig. 4).

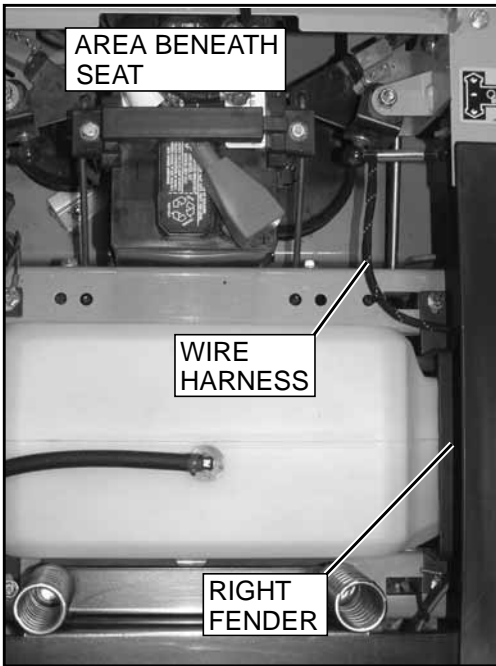

FIG. 3

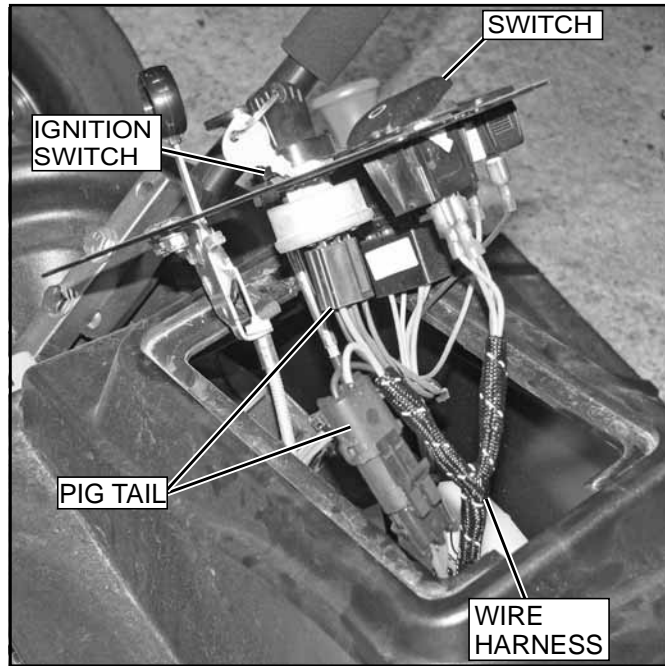

FIG. 4

9. Reinstall the instrument panel reversing the procedure in step 3.
10. Secure the harness to the mower frame cross member and to the brake bell crank mount, using wire ties (Fig. 5). Leave the wire ties loose.

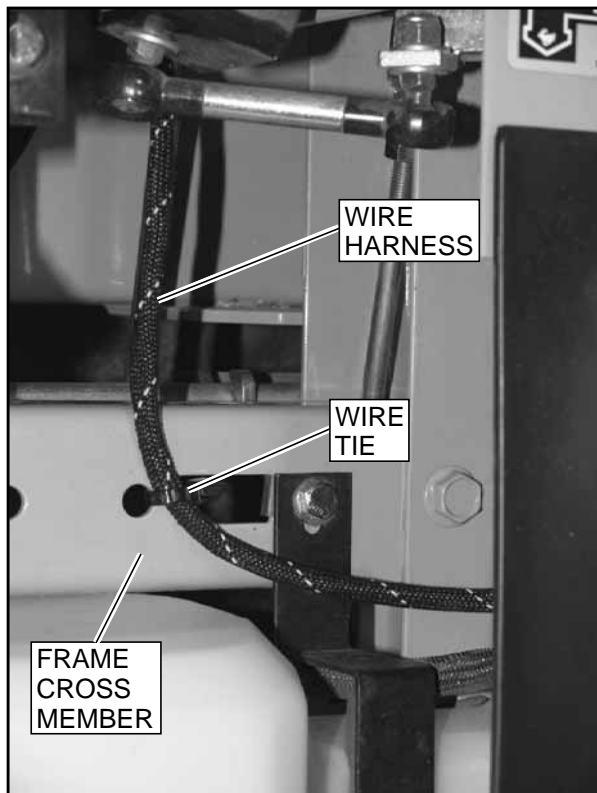

FIG. 5

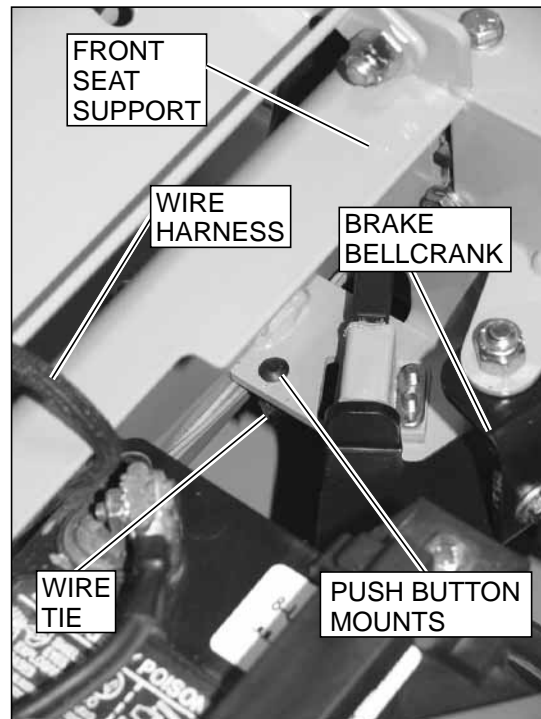

FIG. 6

11. Install the push button mounts in the right side frame rail of the mower (Fig. 7). I

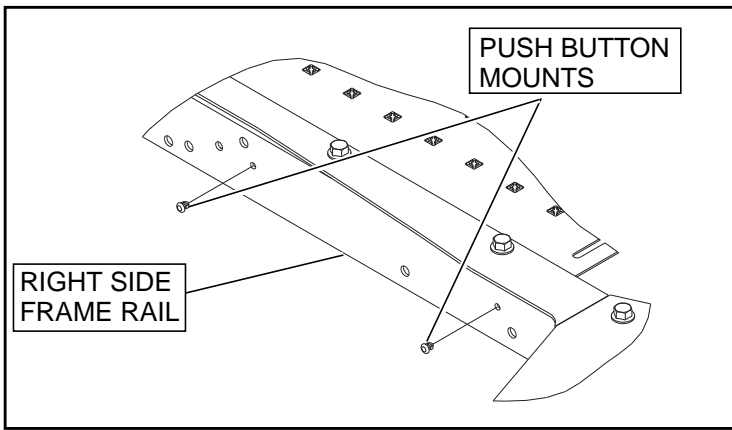

FIG. 7

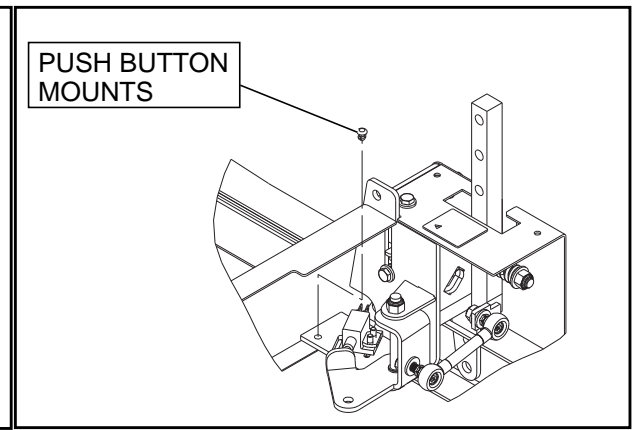

FIG. 8

12. Route the wire harness along the inside of the frame rail to the front of the mower (Fig. 9 & Fig. 10).

13. Secure the wire harness to the push button mounts, using wire ties (Fig. 9 & Fig. 11). Leave the wire ties loose.

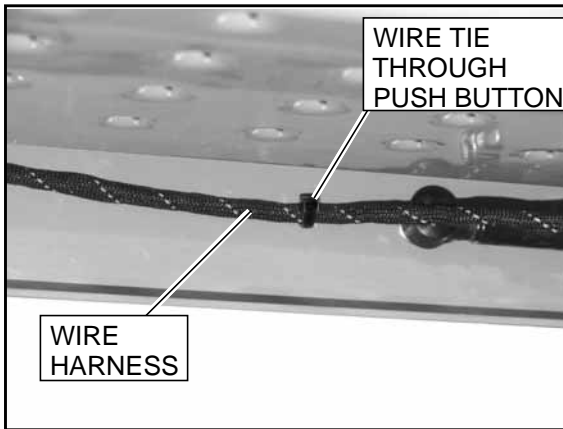

FIG. 9

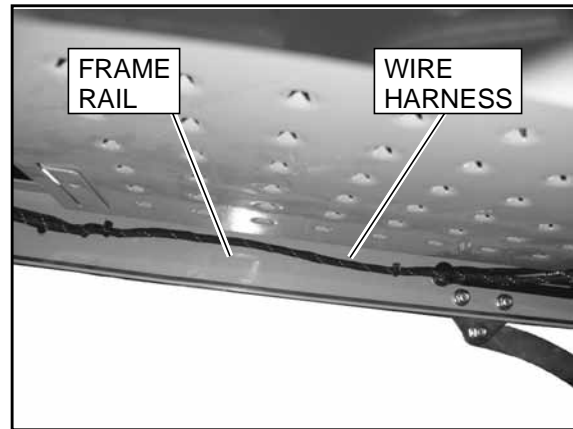

FIG. 10

14. Assemble the oval lights to the bracket using the .250" bolts, washers and nuts supplied, as shown (Fig. 12).

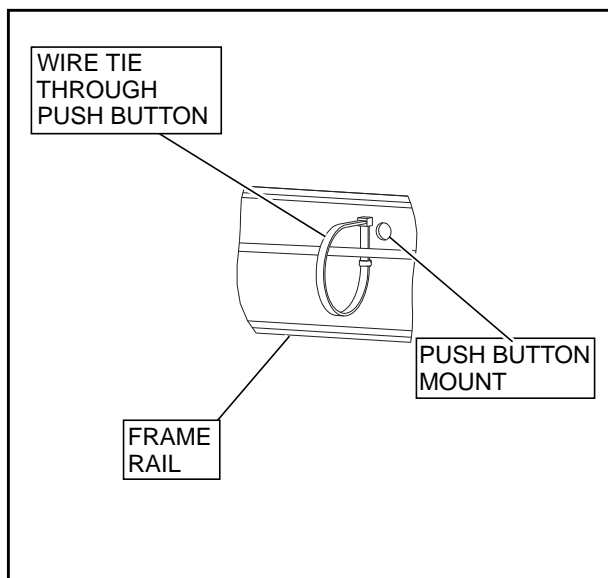

FIG. 11

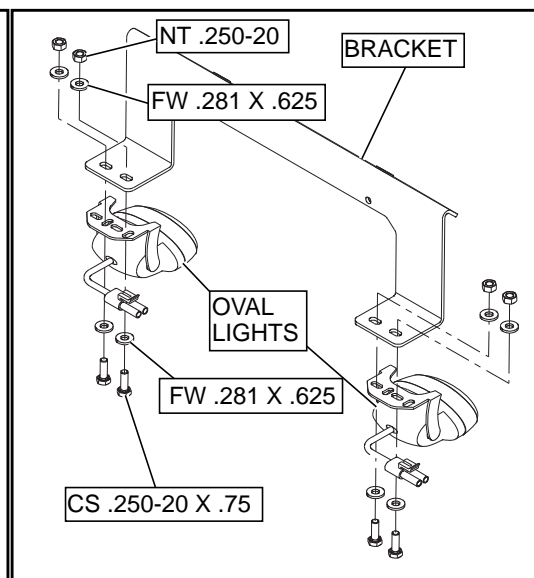

FIG. 12

15. Remove the .375" nuts and bolts from the front of the mower. Retain the bolts and discard the nuts (Fig. 13).
16. Assemble the bracket with lights to the mower using the 3/8" bolts from the previous step (Fig. 14).

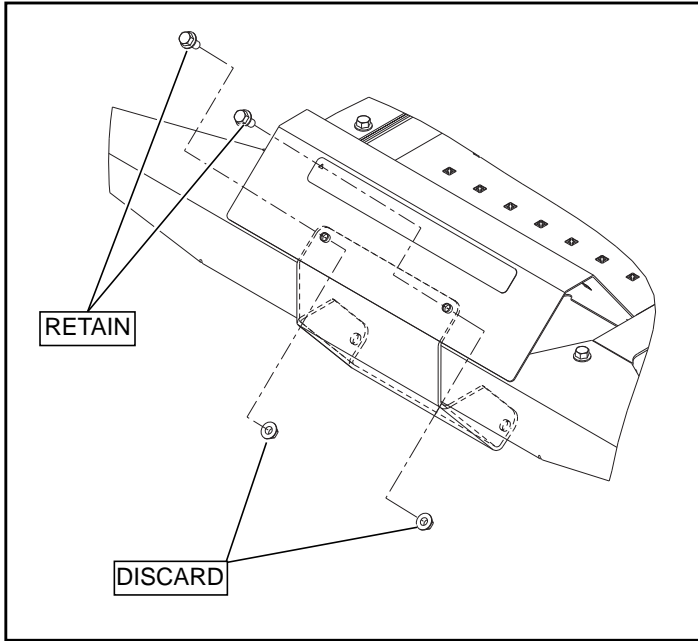

FIG. 13

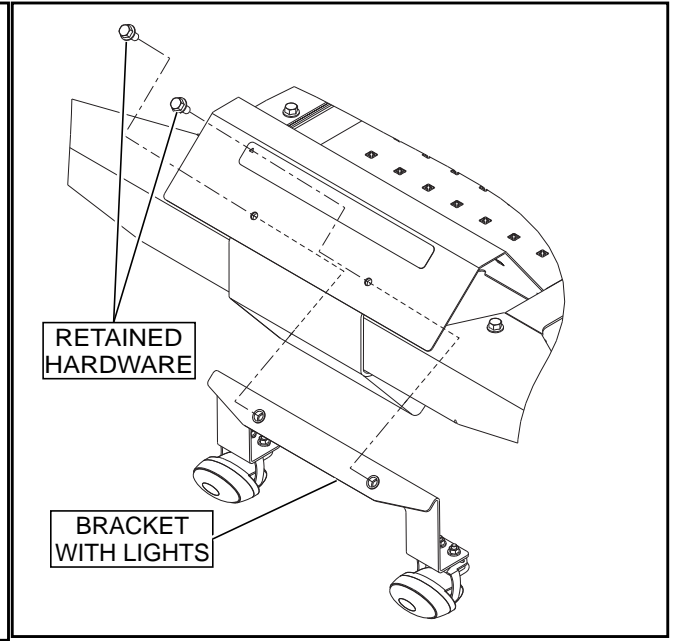

FIG. 14

17. Connect the wire harness to the lights. Secure the wire harness to the bracket with wire ties (Fig. 15 & Fig. 16). Coil and tie the extra length of wire harness together (Fig. 15).

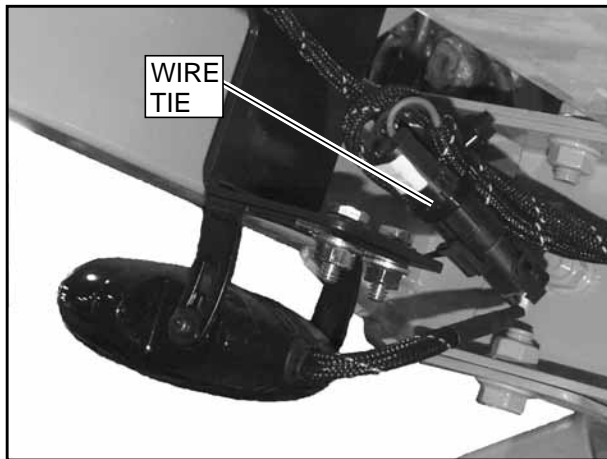

FIG. 15

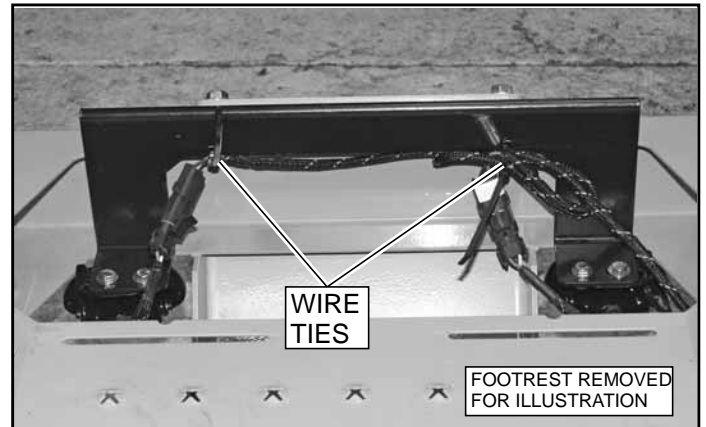

FIG. 16

18. Check the wire harness to make sure it does not come into contact with any moving parts.
19. Check the wire harness routing, pull the wire ties tight and cut off excess wire ties.
20. Reconnect the negative battery cable and return the seat to the operating position.