

**Excel Anti-Scalp Wheel (60"/66") Kit  
Part Number 113911  
Excel Anti-Scalp Wheel (72") Kit  
Part Number 113937**

**Instruction No. 113958  
March 2011**

Refer to the illustration (Fig. 1) below for the listing of parts included in this kit. If any parts are missing or damaged, please contact Excel Industries, Inc.

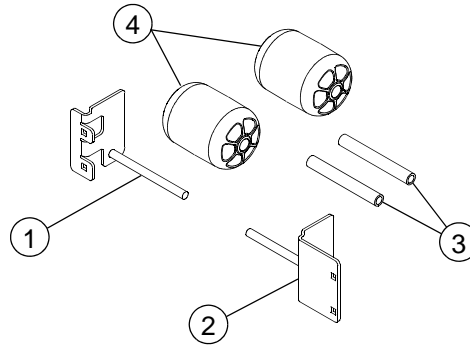

**Fig. 1**

Ref. No.	P/N	Description	Qty
1	113692	BRKT W/A, A/S LH (60"/66")	1
	113954	BRKT W/A, A/S LH (72")	
2	113952	BRKT W/A, A/S RH (60"/66")	1
	113956	BRKT W/A, A/S RH (72")	
3	602344	ANTI-SCALP SPACER 5.73	2
		ANTI-SCALP WHEEL	

**Assembly**

1. Park the tractor on a solid, level surface, set park brakes, shut-off engine and remove ignition key. Disconnect negative battery cable.
2. Raise the front of the mower and deck up until the anti-scalp wheel kit can be installed. Place the mower securely on the jack stands and do not allow the mower to move. Chock the rear wheels.



**WARNING:** Use only appropriate vehicle stands, with a maximum weight rating of 2000 pounds to block the unit up. Use in pairs only. Follow the instructions supplied with the vehicle stands.



**WARNING:** Exercise caution when working under the deck as the mower blades are extremely sharp. Wrap the blade(s) or wear gloves and use extra caution when servicing them.

3. Remove the outer hardware from the pusher arm brackets. Fig. 2
4. Attach the anti-scalp wheel kit to the deck as shown. Fig. 2
5. Remove the jack stands and lower mower.
6. Re-connect the negative battery cable. Make sure the seat platform is securely fastened before operating.
7. The unit is now ready to operate.

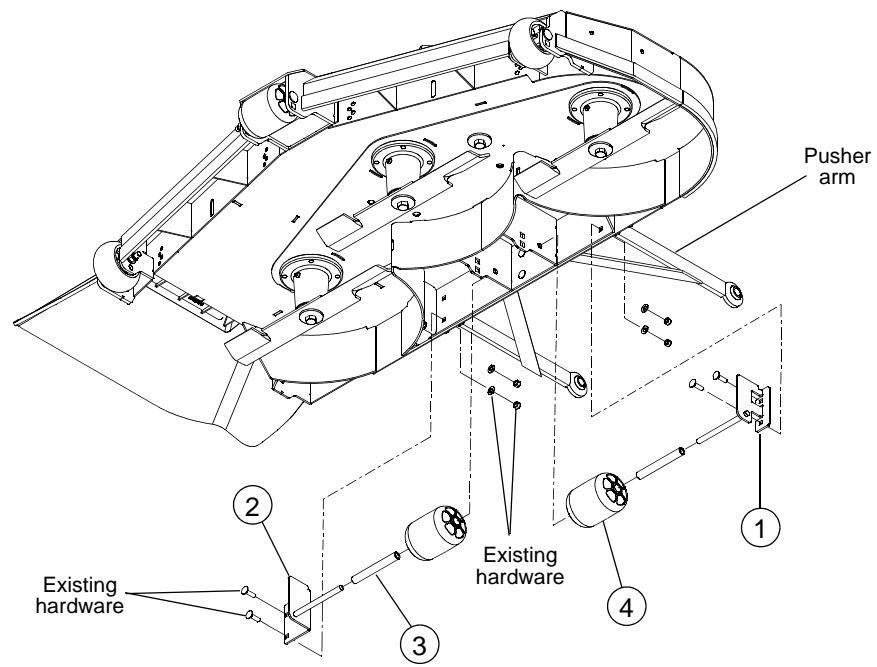

**Fig. 2**