

JETSON

Safara

Kids' 12V Ride-On

A guide for your ride.

IMPORTANT: READ CAREFULLY AND RETAIN FOR FUTURE REFERENCE.

MODELS: JSAFAR-RED | JSAFAR-PNK | JSAFAR-NAV



**Jetson's top two riding rules:
Be safe. Have fun!**

Contents

Safety Warnings	4
Warranty Coverage	6
What's in the Box	8
Specs & Features	11
Online Resources	12
1. Getting Started	
Starting Notes	13
Assembling the Steering Brackets	14
Assembling the Rear Wheels	21
Assembling the Front Wheels	32
Inserting the Seat	38
Attaching the Rear Tailstock	43
Attaching the Steering Wheel	45
Attaching the Windshield	47
Attaching the Side Mirrors	49
Charging the Safara	52

2. Making Moves

Fastening the Seatbelt	54
Setting Up & Using the Remote Control	54
Activating Horn & Engine Sounds	56
A Guide to Your Dashboard	57
Riding the Safara	58
Helmet Safety	59
Care & Maintenance	60

Safety Warnings

- Before use, please read the user manual and safety warnings carefully, and make sure you understand and accept all the safety instructions. The user will be responsible for any loss or damage caused by improper use.
- **Failure to use correct charger can result in fire and explosion.**
- Before each cycle of operation, the operator shall perform the preoperation checks specified by the manufacturer: That all guards and pads originally supplied by the manufacturer are in proper place and in serviceable condition; That the braking system is functioning properly; That any and all axle guards, chain guards, or other covers or guards supplied by the manufacturer are in place and in serviceable condition; That tires are in good condition, inflated properly, and have sufficient tread remaining; The area that the product is to be operated should be safe and suitable for safe operation.
- Components shall be maintained and repaired in accordance with the manufacturer's specifications and using only the manufacturer's authorized replacement parts with installation performed by dealers or other skilled persons.
- Warning against recharging non-rechargeable batteries.
- Don't allow hands, feet, hair, body parts, clothing, or similar articles to come in contact with moving parts, wheels, or drive train, while the motor is running.
- This product should not be used by children or persons with reduced physical, sensory or mental capabilities, or lack of experience and knowledge, unless they have been given supervision or instruction (IEC 60335-1/A2:2006).
- Unsupervised children should not play with the product (IEC 60335-1/A2:2006).
- Adult supervision is required.
- The rider should not exceed 77 lb.
- Units shall not be operated to perform racing, stunt riding, or other maneuvers, which may cause loss of control, or may cause uncontrolled operator passenger actions or reactions.
- Never use near motor vehicles.
- Avoid sharp bumps, drainage grates, and sudden surface changes. Ride-on may suddenly stop.
- Avoid streets and surfaces with water, sand, gravel, dirt, leaves, and other debris. Wet weather impairs traction, braking, and visibility.
- Avoid riding around flammable gas, steam, liquid, or dust that could cause fire.
- Operators shall adhere to all of the manufacturer's recommendations and instructions, as well as comply with all laws and ordinances: Units without headlights shall be operated only with adequate daylight conditions of visibility, and; Owners shall be encouraged to highlight (for conspicuity) using lighting, reflectors, and for low-riding units, signal flags on flexible poles.
- Persons with the following conditions shall be cautioned not to operate: Those with heart conditions; Pregnant women; Persons with head, back, or neck ailments, or prior surgeries to those areas of the body; and persons with any mental or physical conditions that may make them susceptible to injury or impair their physical dexterity or mental capabilities to recognize, understand, and perform all of the safety instructions and to be able to assume the hazards inherent in unit use.
- Do not ride at night.
- Do not ride after drinking or taking prescription medication.
- Do not carry items when riding.
- Never operate the product barefooted.
- Always wear shoes and keep shoelaces tied.
- Make sure your feet are always placed securely on the deck.
- Operators always shall use appropriate protective clothing, including but not limited to a helmet, with appropriate certification, and any other equipment recommended by the manufacturer: Always wear protective equipment such as helmet, knee pads, and elbow pads.
- Always give way to pedestrians.
- Be alert to things in front and far away from you.
- Do not allow distractions when riding, such as answering the phone or engaging in any other activities.
- The product cannot be ridden by more than one person.
- When you ride the product along with other riders, always keep a safe distance to avoid a collision.

- This vehicle does not have brakes or braking capability. Do not leave a child unattended during operation. Do not use in a location that may require braking capability, as this could result in loss of control, which may result in serious injury or death.
- Replace worn or broken parts immediately.
- Check whether all safety labels are in place and understood before riding.
- The owner shall allow the use and operation of the unit after a demonstration that such operators can understand and operate all components of the unit before use.
- Do not ride without proper training. Do not ride at high speeds, on uneven terrain, or on slopes. Do not perform stunts or turn abruptly.
- Prolonged exposure to UV rays, rain and the elements may damage the enclosure materials, store indoors when not in use.

MODIFICATIONS

Do not attempt to disassemble, modify, repair, or replace the unit or any components of the unit without instruction from the Jetson Customer Care. This will void any warranty, and can lead to malfunctions which may cause injury.

ADDITIONAL OPERATION CAUTIONS

Do not lift the product off the ground while it is on and the wheels are in motion. This can result in freely spinning wheels, which may cause injury to yourself or others nearby. Do not jump on or off the product, and do not jump while using it. Always keep your feet firmly planted on the foot rest while in operation. Always check the battery charge before using.

NOTICE OF COMPLIANCE

This device complies with Part 15 of the FCC Rules. Operation is subject to the following two conditions:

(1) this device may not cause harmful interference, and (2) this device must accept any interference received, including interference that may cause undesired operation. Warning: Changes or modifications to this unit not expressly approved by the party responsible for compliance could void the user's authority to operate the equipment.

NOTE: This equipment has been tested and found to comply with the limits for a Class B digital device, pursuant to Part 15 of the FCC Rules. These limits are designed to provide reasonable protection against harmful interference in a residential installation. This equipment generates, uses and can radiate radio frequency energy and, if not installed and used in accordance with the instructions, may cause harmful interference to radio communications. However, there is no guarantee that interference will not occur in a particular installation. If this equipment does cause harmful interference to radio or television reception, which can be determined by turning the equipment off and on, the user is encouraged to try to correct the interference by one or more of the following measures:

- Reorient or relocate the receiving antenna.
- Increase the separation between the equipment and receiver.
- Connect the equipment into an outlet on a circuit different from that to which the receiver is connected.
- Consult the dealer or an experienced radio/TV technician for help.

Shielded cables must be used with this unit to ensure compliance with the Class B FCC limits.

DISPOSAL OF USED BATTERY



Battery may contain hazardous substances which could endanger the environment and human health. This symbol marked on the battery and/or packaging indicates that used battery shall not be treated as municipal waste. Batteries should be disposed of at an appropriate collection point for recycling. By ensuring the used batteries are disposed of correctly, you will help preventing potential negative consequences for the environment and human health. The recycling of materials will help to conserve natural resources. For more information about recycling of used batteries, please contact your local municipality waste disposal service.

California Proposition 65



WARNING:
This product can expose you to chemicals including Chromium (hexavalent compounds), which is known to the State of California to cause cancer and birth defects or other reproductive harm. For more information go to: www.P65Warnings.ca.gov.

Warranty Coverage

GENERAL LIMITED WARRANTY

Your new Jetson product is warranted against defects in materials and workmanship as indicated on ridejetson.com/warranty for a period of time from the date of original retail purchase when used in accordance with Jetson's user manuals (refer to ridejetson.com/support). **Under this warranty, you will be able to direct your claims to Jetson even in situations where you purchased the Jetson Product from one of our authorized retailers.** To read the full terms of our warranty, visit ridejetson.com/warranty.

What's in the Box

1. BODY
2. SEAT
3. STEM BACK
4. REAR TAILSTOCK
5. STEERING WHEEL
6. WINDSHIELD
7. SIDE MIRROR (X2; LEFT & RIGHT)
8. BACKSHAFT BASE (X2; LEFT & RIGHT)
9. GEAR BOX (X2; LEFT & RIGHT)
10. STEERING BRACKET (PRE-ATTACHED)
WITH FRONT WHEEL AXLES
11. STEERING BRACKET (PRE-ATTACHED)
12. REAR AXLE
13. FRONT WHEEL (X2)
14. REAR WHEEL (DRIVE WHEEL) (X2)
15. HUB CAP (X4)
16. CHARGER
17. REMOVE CONTROL
18. SEAT BELT

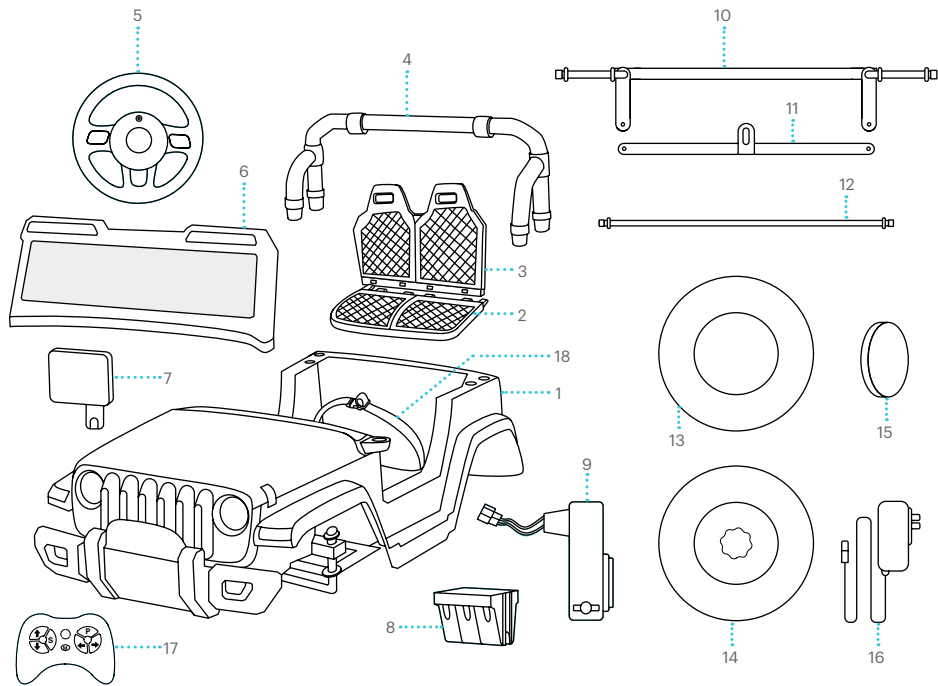

NOTE: IMAGES MAY NOT REFLECT EXACT APPEARANCE OF ACTUAL PRODUCT.

HARDWARE AND TOOLS:

NOTE: SOME HARDWARE USED FOR ASSEMBLY IS PRE-ATTACHED ON PARTS OF THE SAFARA. LOCATIONS AND INSTRUCTIONS FOR USE OF PRE-ATTACHED HARDWARE ARE NOTED IN THE ASSEMBLY DIRECTIONS.



LARGE NUT
(X6; 5 PRE-ATTACHED
PLUS 1 SPARE)



SMALL NUT
(X3; 2 PRE-ATTACHED
PLUS 1 SPARE)



WASHER
(X6; 5 PRE-ATTACHED
PLUS 1 SPARE)



SCREW
(X18, INCLUDING
2 SPARE)

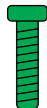

BOLT
(X3; 2 PRE-ATTACHED
PLUS 1 SPARE)

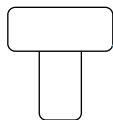

WRENCH (X2)

DEPENDENT ON PRODUCTION DATE:



PHILLIPS-HEAD SCREWDRIVER



OR

DOUBLE-SIDED FLAT-HEAD (A) AND
PHILLIPS-HEAD (B) SCREWDRIVER
WITH ATTACHABLE HANDLE (C)



Specs & Features

- FAST SPEED: 3.5 MPH
- SLOW SPEED: 1.7 MPH
- BATTERY: RECHARGEABLE 12V, 7AH
- RUN TIME: 1 - 2 HOURS
- BATTERIES NEEDED FOR REMOTE CONTROL: 2 AAA (NOT INCLUDED)
- BATTERIES NEEDED FOR STEERING WHEEL: 2 AA (NOT INCLUDED)
- MOTOR: 40W × 2
- PRODUCT WEIGHT: 42 LB
- PRODUCT DIMENSIONS: 45.0"(L) × 30.0"(W) × 26.0"(H)
- TIRE SIZE: 12.5" × 4.75"
- CHARGER: UL LISTED, DC12V
- CHARGING TIME: 8 - 12 HOURS (INITIAL CHARGING SESSION: 15 - 18 HOURS)
- MAX CLIMBING ANGLE: 15°
- WEIGHT LIMIT: 77 LB
- RECOMMENDED AGE: 3+
- NUMBER OF RIDERS: 1

Online Resources

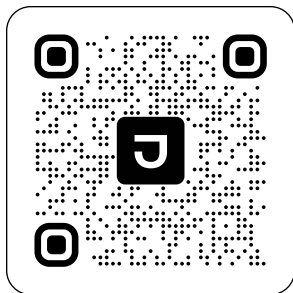

**Scan for our most
updated Safara
onboarding materials
and support resources.**

1. Getting Started

1.1 Starting Notes

- REMOVE ALL PACKAGING BEFORE BEGINNING ASSEMBLY.
- THE DIRECTIONS GIVEN IN THIS MANUAL—RIGHT, LEFT, FRONT/FORWARD, AND REAR/BACK—ARE ORIENTED AS THE RIDER WOULD SEE THEM WHEN SEATED IN THE SAFARA. THE "RIGHT SIDE," FOR EXAMPLE, IS THE SIDE WHERE THE RIDER'S RIGHT HAND AND FOOT WILL BE.
- IT MIGHT BE USEFUL TO HAVE EXTRA HANDS FOR ASSEMBLY. GRAB AN ASSISTANT!

WARNING:

FAILURE TO COMPLY WITH THE FOLLOWING INSTRUCTIONS MAY RESULT IN INJURY TO THE CHILD OR OTHERS.

- KEEP SMALL PARTS AWAY FROM CHILDREN DURING ASSEMBLY.
- ACCESSORY MUST BE ASSEMBLED AND REMOVED BY AN ADULT.
- FREQUENTLY INSPECT THE PRODUCT FOR DAMAGE.

* ADULTS MUST ASSIST CHILDREN IN THE ASSEMBLY AND INITIAL ADJUSTMENT PROCEDURES OF THE PRODUCT.

1.2 Assembling the Steering Brackets

1. FLIP THE BODY OVER SO THAT THE UNDERSIDE IS FACING UPWARDS.
2. RELEASE THE STEERING BRACKET (B) AND FRONT AXLE (A) AT THE FRONT OF THE BODY BY CUTTING OFF THE ZIP TIES.
3. REMOVE THE LARGE NUT AT THE CENTER OF THE STEERING BRACKET BY TURNING IT CLOCKWISE WITH A WRENCH.

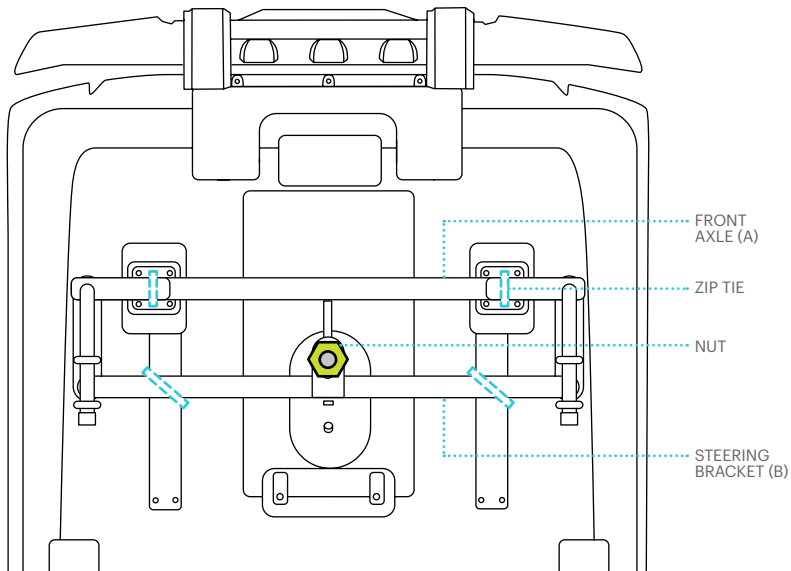

4. REMOVE THE WASHER UNDERNEATH THE NUT AND SET THE HARDWARE ASIDE.
5. LIFT THE STEERING BRACKET OFF THE BODY.

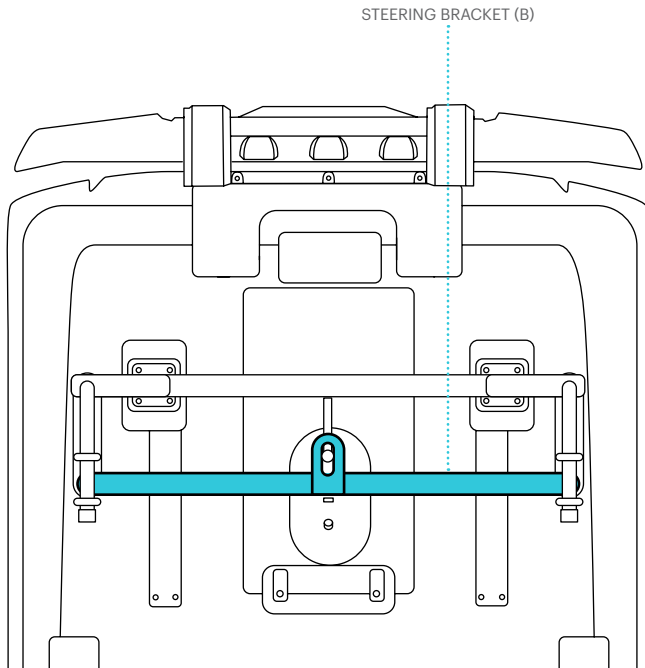

6. LOOSEN AND REMOVE THE BOLTS FROM THE SMALL NUTS ON BOTH SIDES OF THE STEERING BRACKET BY TURNING THE BOLTS COUNTERCLOCKWISE WITH THE PHILLIPS-HEAD SCREWDRIVER. SET THE HARDWARE ASIDE.

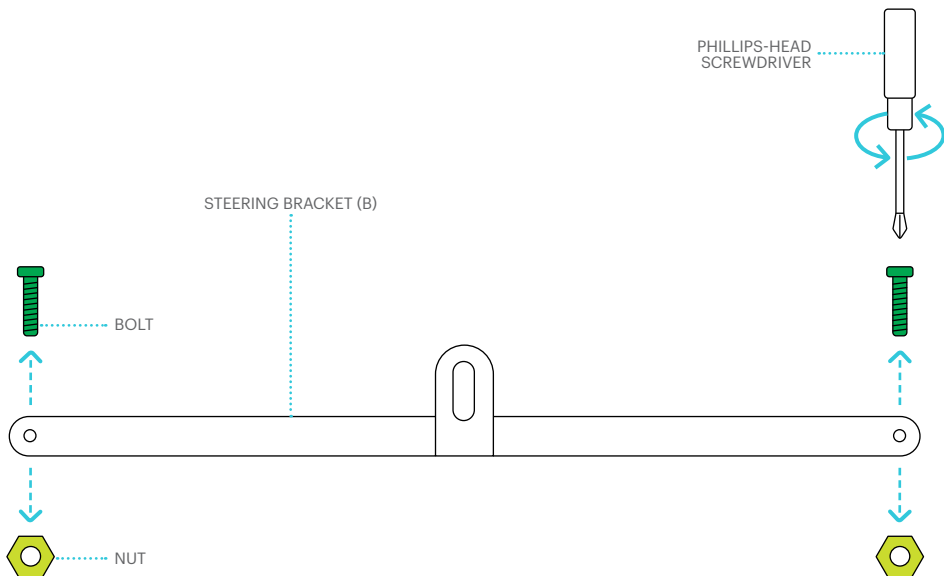

7. ROTATE THE FRONT WHEEL AXLES ON THE STEERING BRACKET UNTIL THEY ARE IN LINE WITH THE BRACKET AND EXTENDING OVER THE SIDES OF THE BODY.

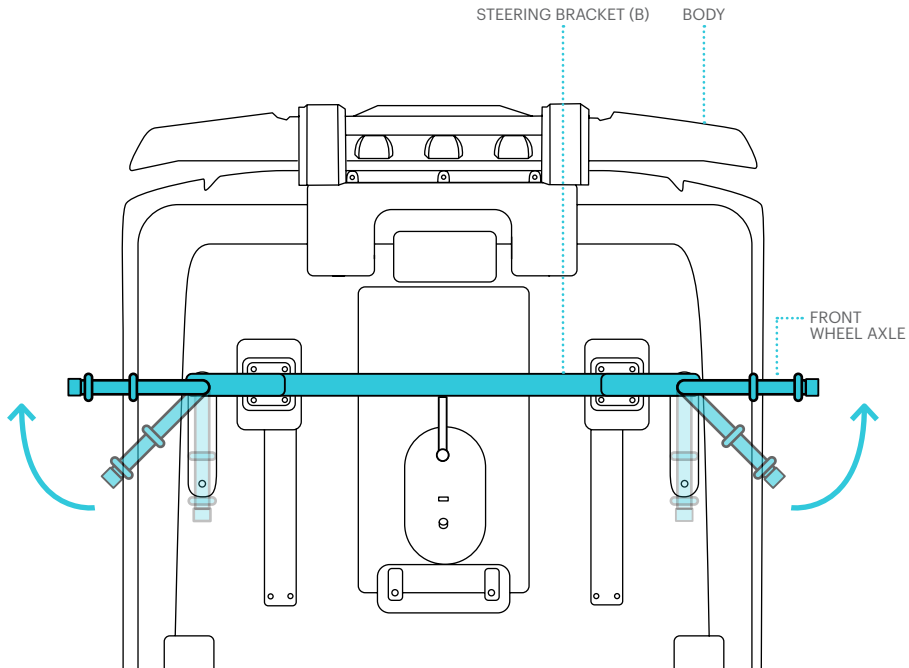

8. REPLACE THE STEERING BRACKET ON THE BODY SUCH THAT THE FOLLOWING CONDITIONS ARE MET:

- THE TAB EXTENDING FROM THE MIDDLE OF THE BRACKET IS CLOSER TO THE BODY.
- THE HOLE IN THE TAB IS AROUND THE FRAME BOLT FROM WHICH IT CAME.
- THE HOLES ON THE ENDS OF THE BRACKET ARE ALIGNED WITH THE HOLES ON THE ENDS OF THE STEERING BRACKET CONNECTORS.

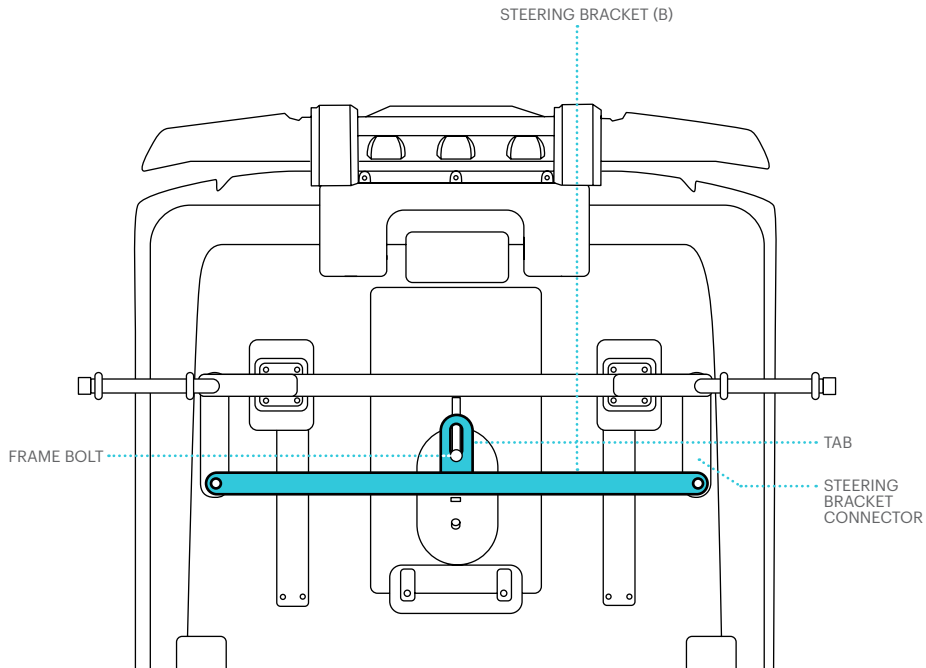

9. SLIDE THE WASHER BACK ON THE FRAME BOLT AND PUT THE LARGE NUT ONTO THE BOLT BY TWISTING IT ON CLOCKWISE. TIGHTEN THE NUT WITH A WRENCH.

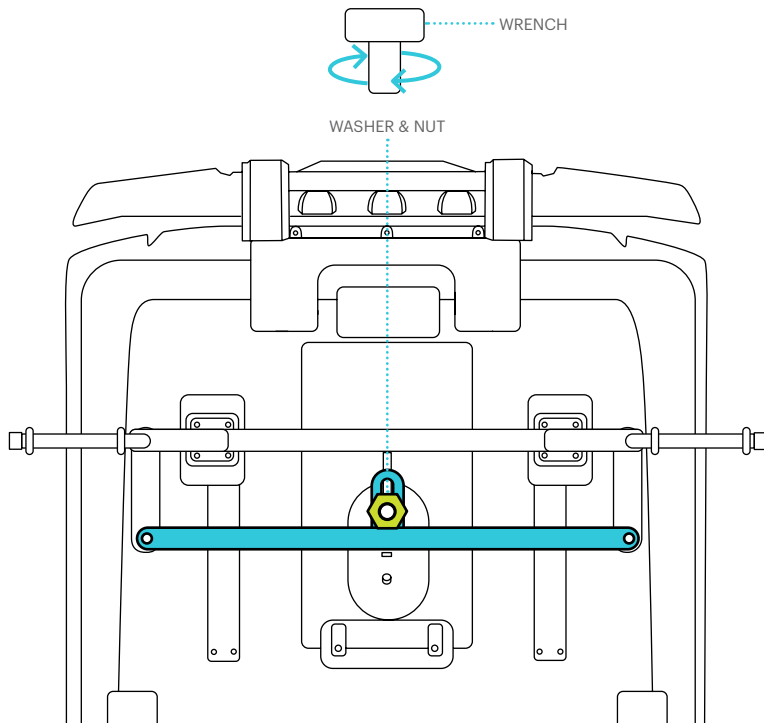

10. INSERT A BOLT THROUGH THE ALIGNED HOLES ON EACH SIDE OF THE STEERING BRACKET (B) FROM UNDERNEATH. TWIST A NUT CLOCKWISE ONTO THE END OF EACH BOLT.

- HOLD THE BOLT STEADY WHILE YOU FULLY TIGHTEN THE NUT.
- CHECK THAT THE STEERING BRACKET (B) IS SECURELY ATTACHED TO THE STEERING BRACKET CONNECTORS.

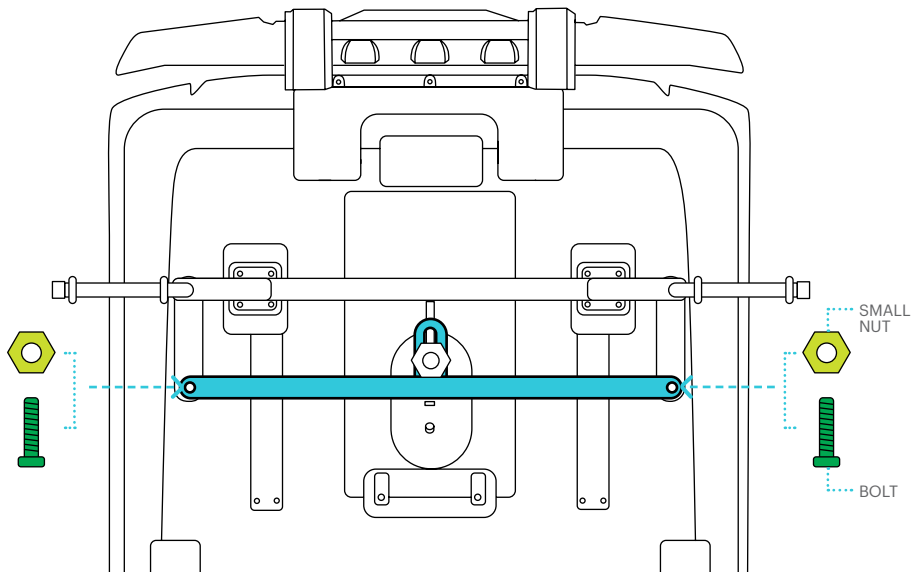

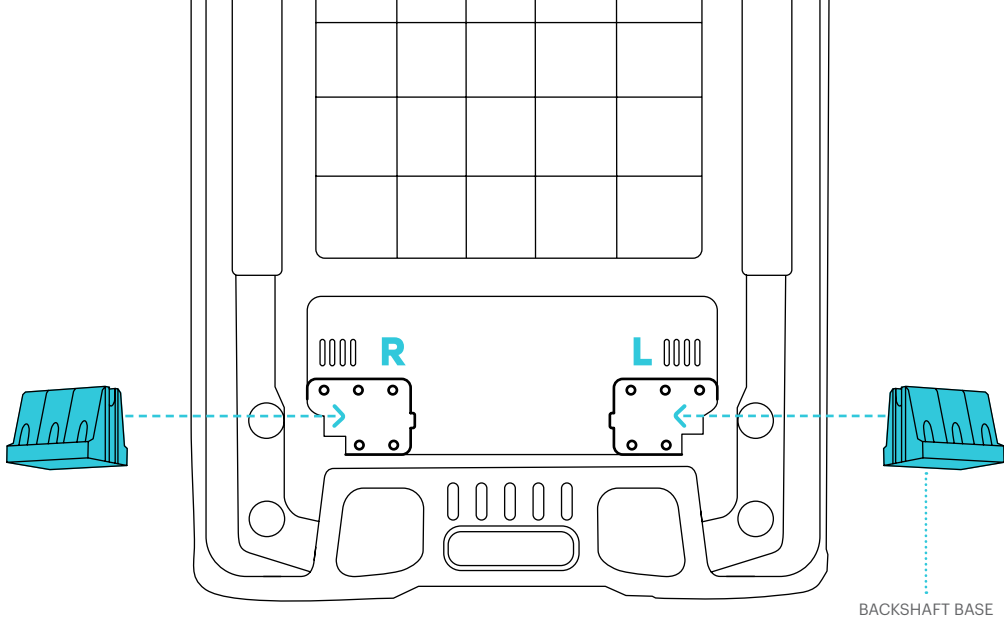

1.3 Assembling the Rear Wheels

1. IN THE REAR OF THE BODY, PLACE THE TWO BACKSHAFT BASES INTO THEIR CORRESPONDING SLOTS.

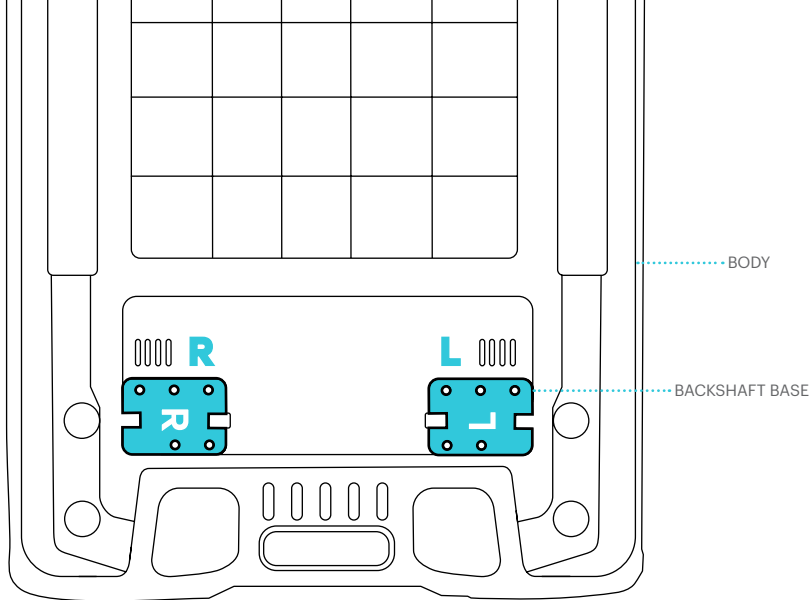

IMPORTANT: ENSURE THAT THE BACKSHAFT BASE MARKED "R" IS PLACED ON THE SIDE OF THE BODY MARKED "R" AND THAT THE BACKSHAFT BASE MARKED "L" IS PLACED ON THE SIDE OF THE BODY MARKED "L."

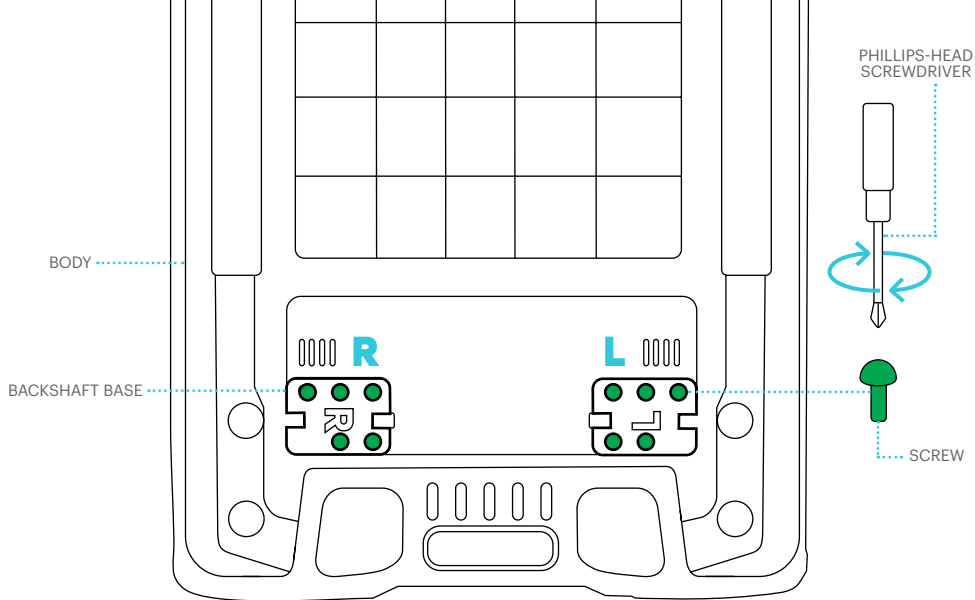

2. INSERT 1 SCREW INTO EACH SET OF ALIGNED HOLES IN THE BACKSHAFTS AND BODY BY TWISTING IT IN CLOCKWISE WITH THE PHILLIPS-HEAD SCREWDRIVER. (10 TOTAL SCREWS)
3. CHECK THAT THE BACKSHAFTS ARE SECURED TO THE BODY.

4. LOOSEN AND REMOVE THE LARGE NUTS ON THE END OF THE REAR AXLE BY TWISTING THEM OFF COUNTERCLOCKWISE.
5. REMOVE THE WASHERS FROM THE AXLE.

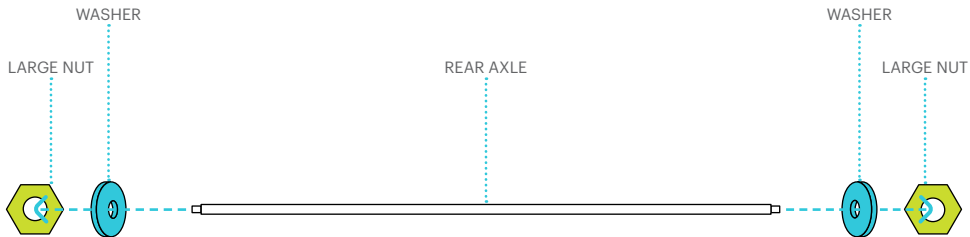

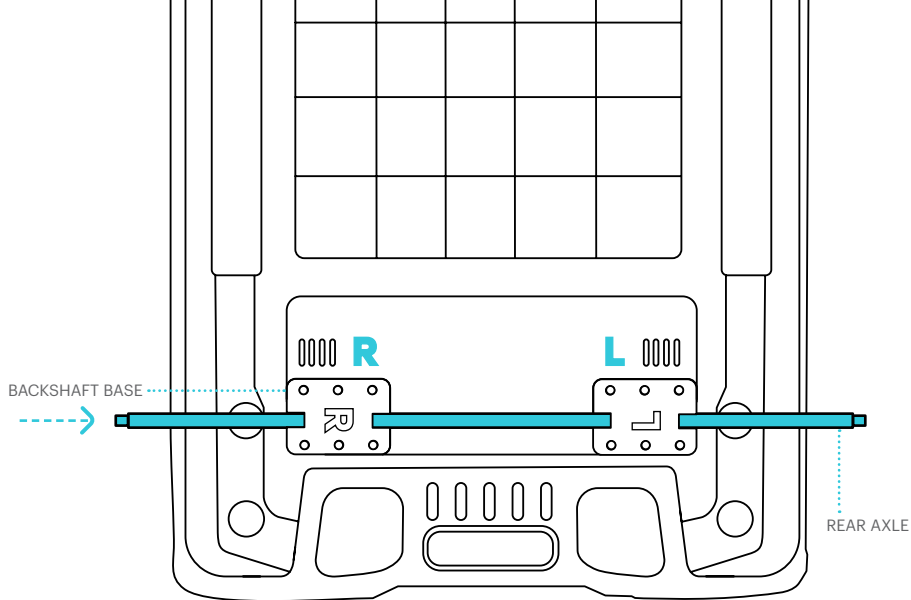

6. FROM ONE SIDE, SLIDE THE REAR AXLE THROUGH THE SIDE HOLES IN BOTH BACKSHAFT BASES.
7. CENTER THE AXLE.

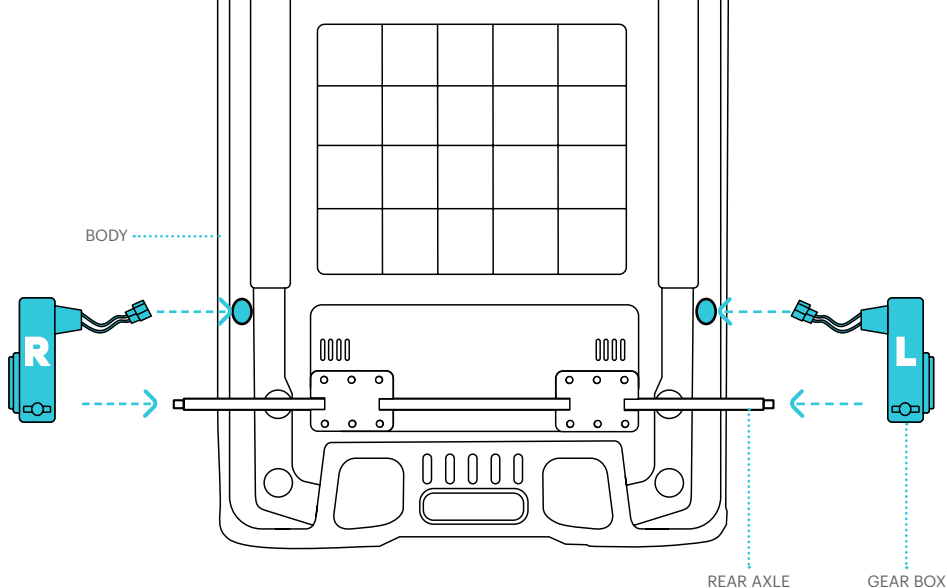

8. LEADING WITH SIDE OF THE GEAR BOX WITH THE WIRES, SLIDE THE HOLE IN GEAR BOX MARKED "L" ONTO THE END OF THE REAR AXLE ON THE LEFT SIDE ("L") OF THE BODY MARKED.
9. WHILE PUSHING THE GEAR BOX ALL THE WAY UP TO THE BODY, PUSH THE WIRES ON THE GEAR BOX INTO THE HOLE IN THE SIDE OF THE BODY.
10. REPEAT STEPS 8 AND 9 WITH THE RIGHT ("R") GEAR BOX AND THE OPPOSITE END OF THE AXLE.

BODY

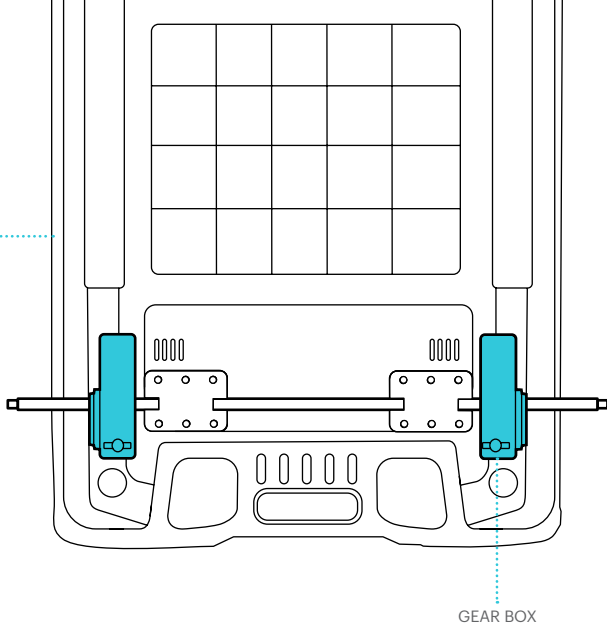

GEAR BOX

11. CHECK THAT THE GEAR BOXES ARE SNUG UP TO THE BODY AND THE WIRES FROM BOTH GEAR BOXES ARE FULLY INSIDE THE BODY.

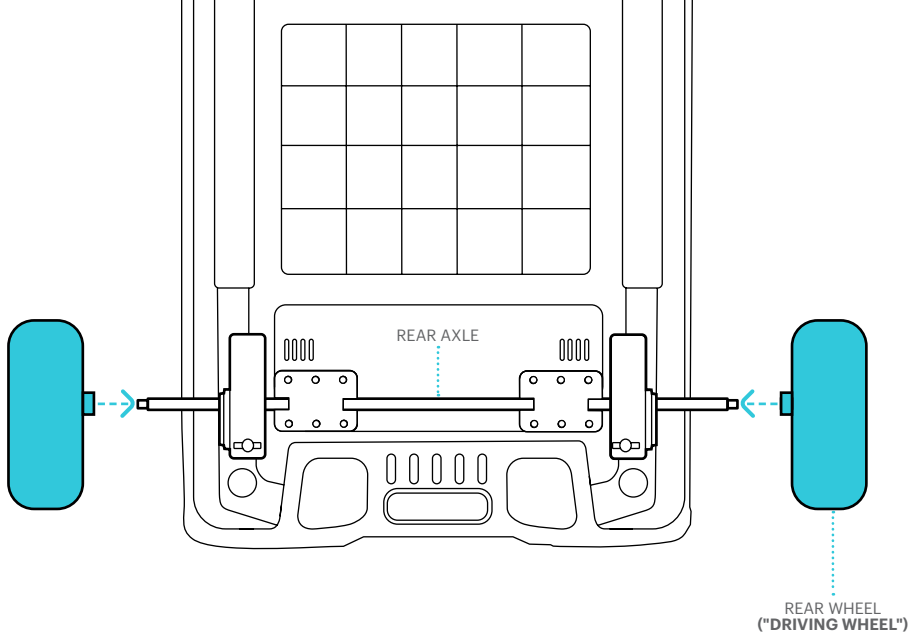

- 12. LEADING WITH THE SIDE OF THE WHEEL THAT HAS AN EXTENSION IN THE CENTER, SLIDE ONE REAR WHEEL ("DRIVING WHEEL") ONTO EACH END OF THE AXLE.**

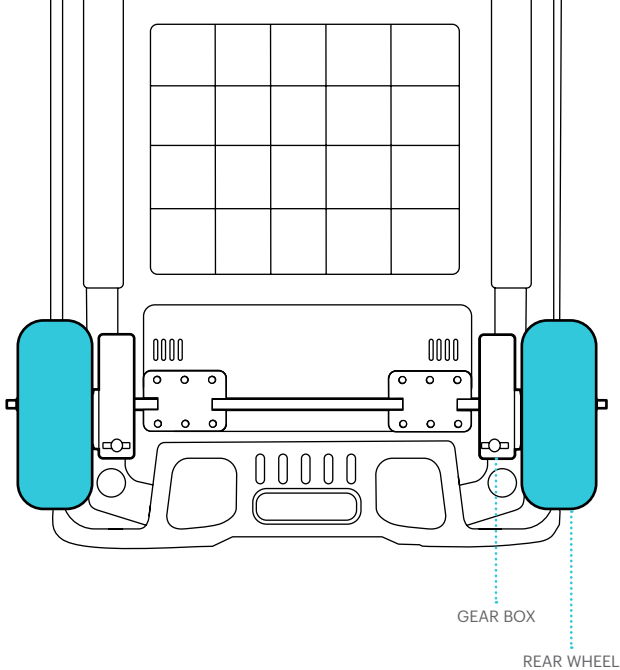

13. PUSH THE WHEELS UP AGAINST THE GEAR BOXES.

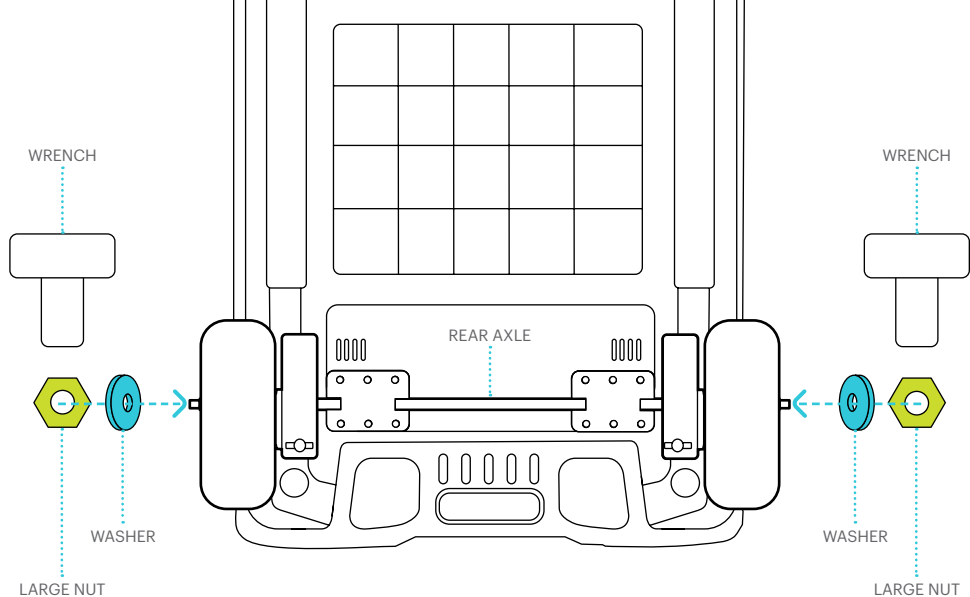

14. SLIDE A WASHER ONTO EACH END OF THE REAR AXLE, AND THEN TWIST A LARGE NUT CLOCKWISE ONTO EACH END OF THE AXLE.

15. SIMULTANEOUSLY TIGHTEN BOTH NUTS BY TURNING THEM BOTH CLOCKWISE WITH THE WRENCHES.

IMPORTANT: TAKE CARE NOT TO OVER-TIGHTEN THE NUTS, AS OVER-TIGHTENING CAN CAUSE THE WHEELS TO CRACK. STOP TURNING THE NUTS WITH THE WRENCHES ONCE THERE IS A LOT OF RESISTANCE.

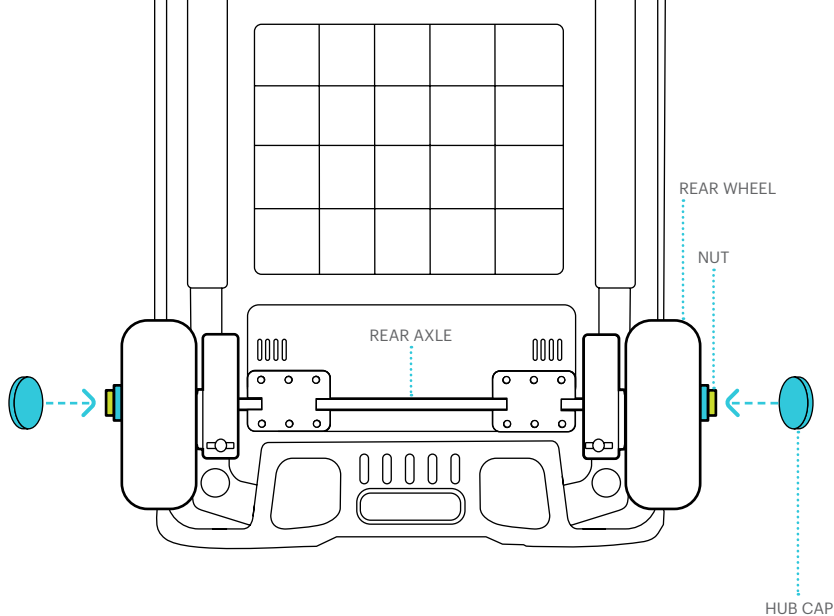

- 16. LEADING WITH THE OPEN SIDE OF THE HUB CAB, POP A HUBCAP INTO PLACE IN THE CENTER OF EACH REAR WHEEL OVER THE NUT.**

1.4 Assembling the Front Wheels

1. REMOVE THE LARGE NUT FROM EACH FRONT WHEEL AXLE BY TWISTING IT OFF COUNTERCLOCKWISE.

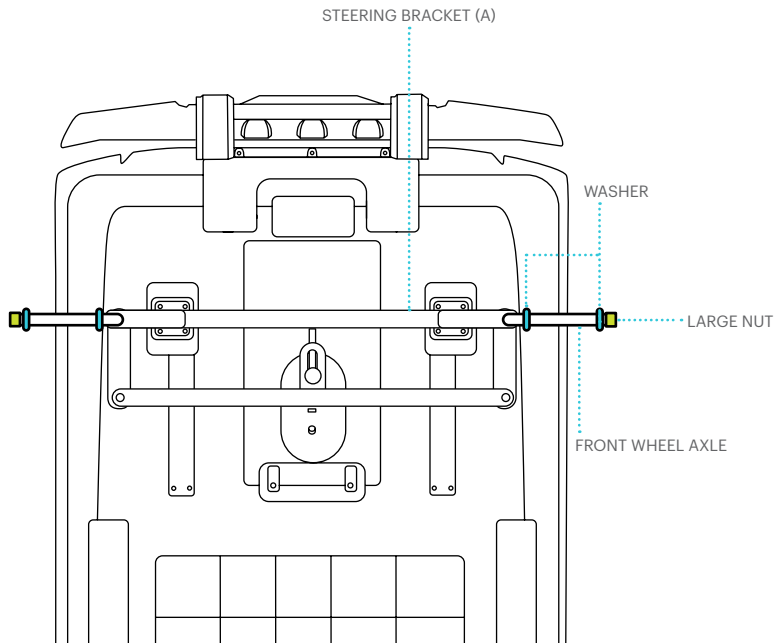

2. REMOVE ONE WASHER FROM EACH FRONT WHEEL AXLE AND SET IT ASIDE WITH THE NUT. LEAVE THE SECOND WASHER ON EACH AXLE.

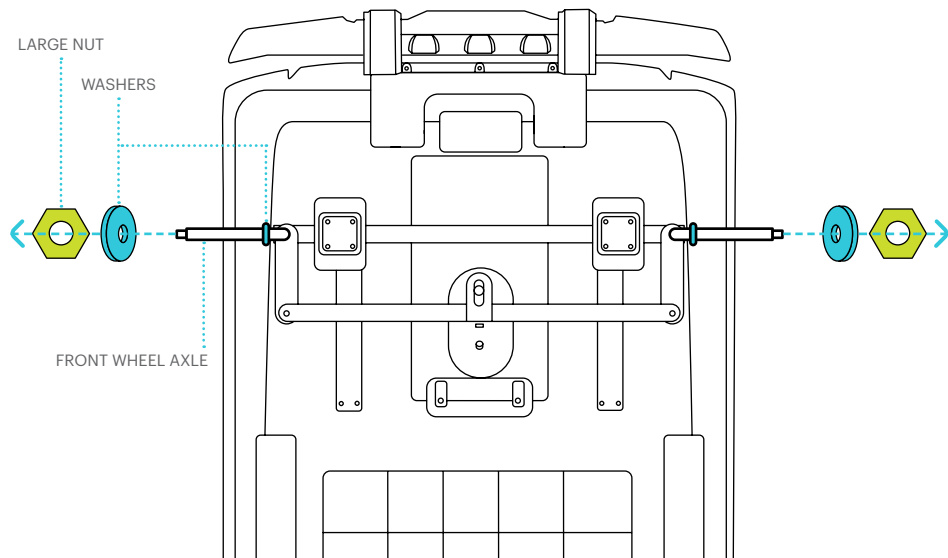

3. LEADING WITH THE FLAT SIDE OF THE WHEEL, SLIDE ONE FRONT WHEEL ONTO EACH FRONT AXLE.

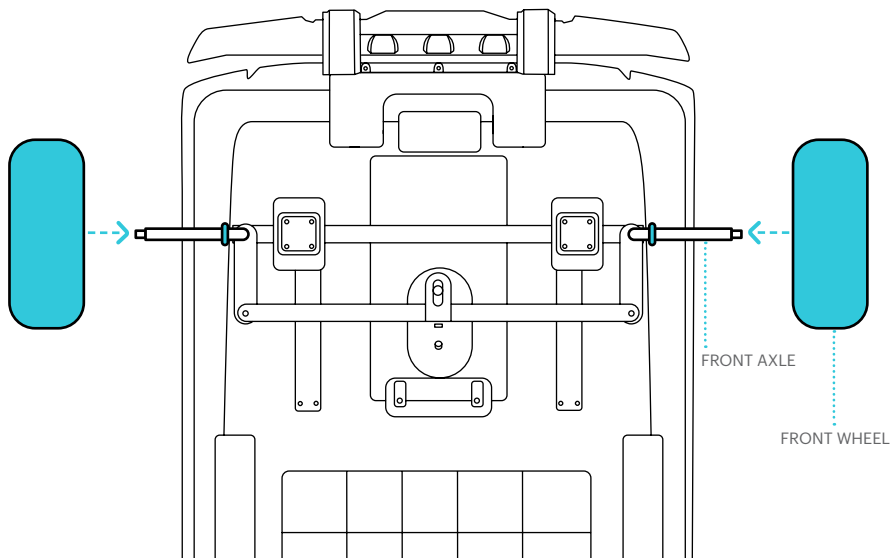

4. PUSH THE WHEELS ALL THE WAY ONTO THE AXLE SO THAT THEY ARE SNUG AGAINST THE WASHERS.

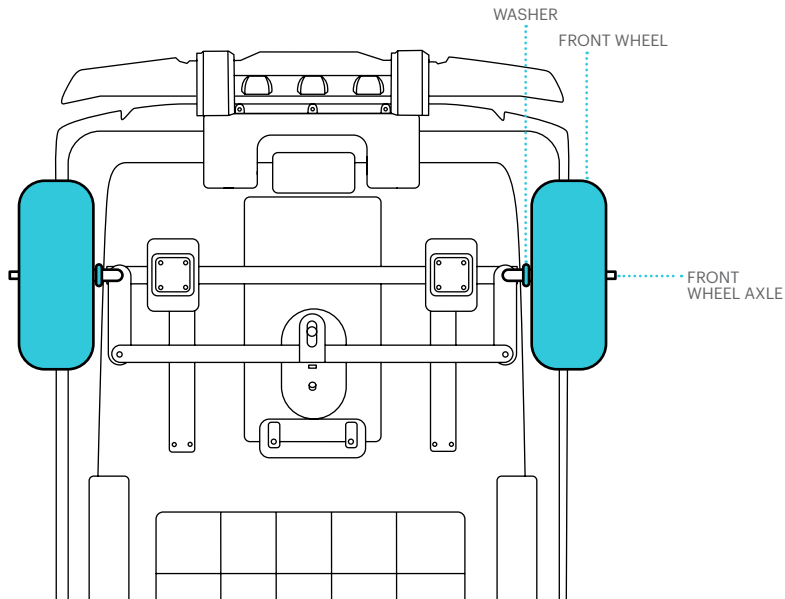

5. SLIDE A WASHER ONTO THE END OF EACH FRONT WHEEL AXLE, AND THEN TWIST A LARGE NUT CLOCKWISE ONTO EACH END OF THE AXLE.

6. SIMULTANEOUSLY TIGHTEN BOTH NUTS BY TURNING THEM BOTH CLOCKWISE WITH THE WRENCHES.

IMPORTANT: TAKE CARE NOT TO OVER-TIGHTEN THE NUTS, AS OVER-TIGHTENING CAN CAUSE THE WHEELS TO CRACK. STOP TURNING THE NUTS WITH THE WRENCHES ONCE THERE IS A LOT OF RESISTANCE.

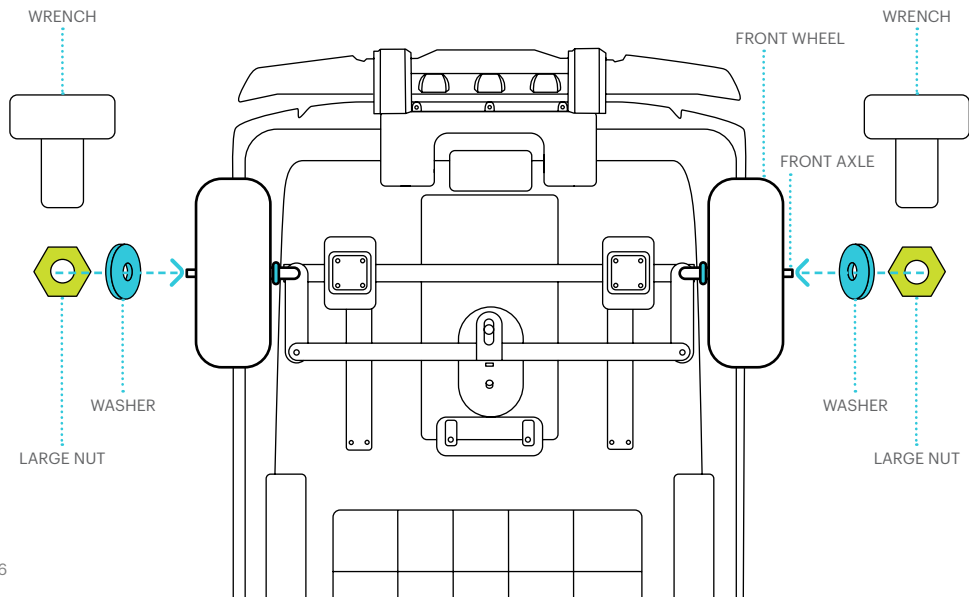

7. LEADING WITH THE OPEN SIDE OF THE HUB CAB, POP A HUBCAP INTO PLACE IN THE CENTER OF EACH REAR WHEEL OVER THE NUT.

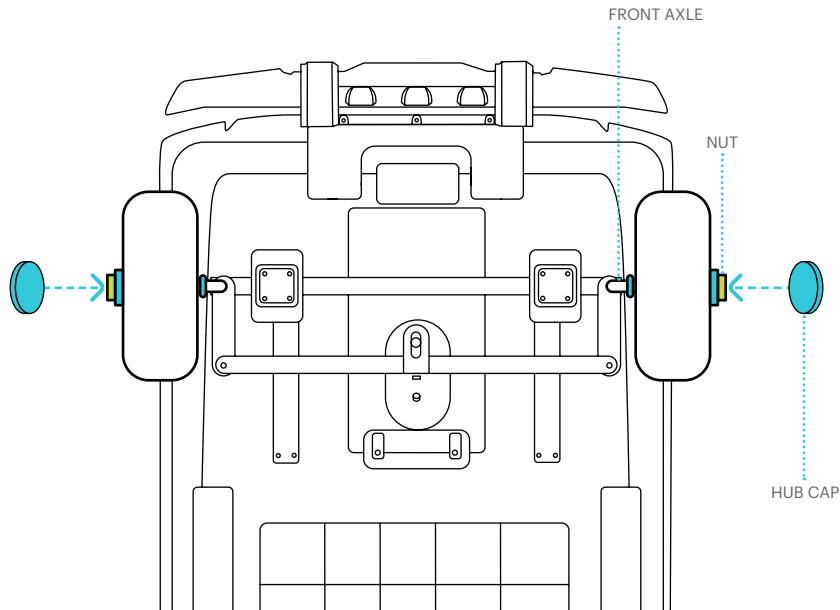

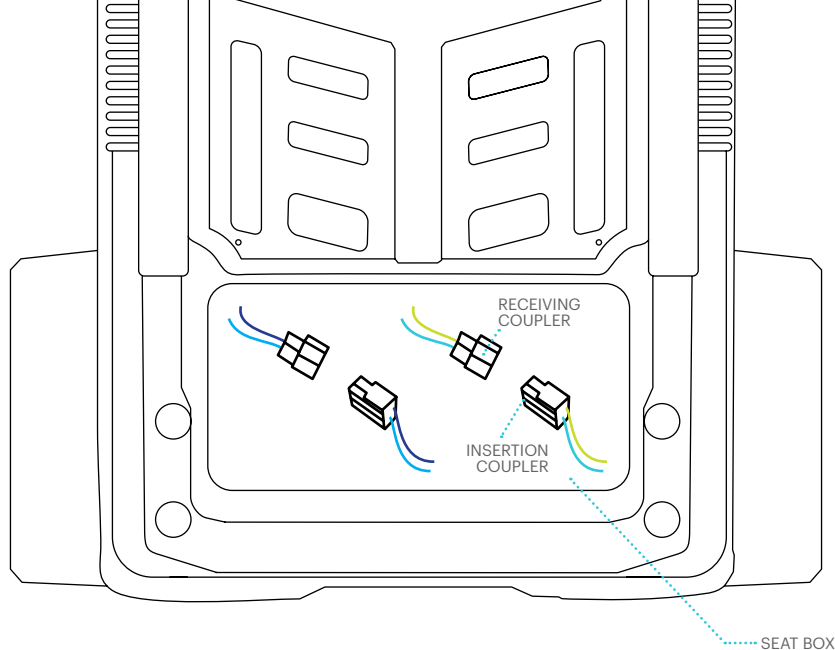

1.5 Inserting the Seat

1. FLIP THE BODY OVER SO IT IS UPRIGHT.
2. ALIGN THE COUPLERS IN THE SEAT BOX WITH WIRES OF THE SAME COLORS.

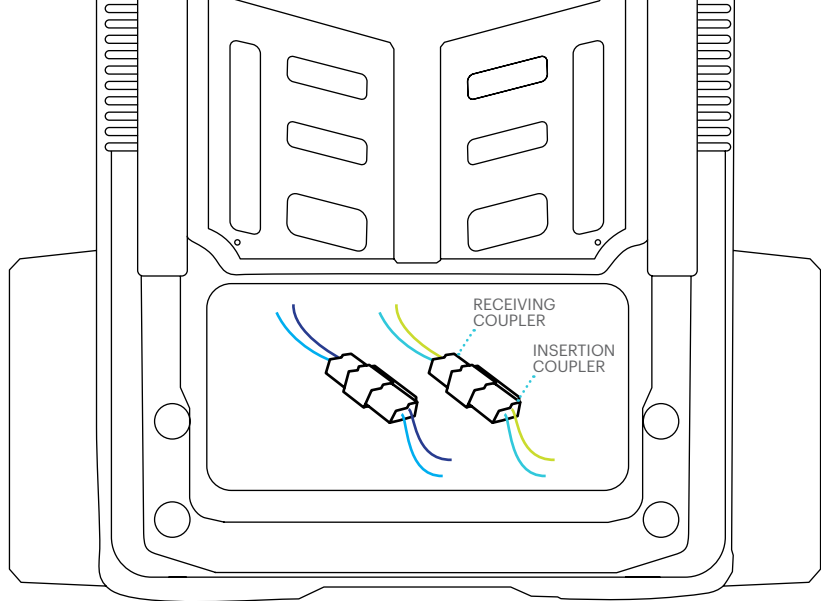

3. PUSH THE INSERTION COUPLERS INTO THE RECEIVING COUPLERS.

NOTE: MAKE SURE TO CONNECT EACH COUPLER WITH THE RECEPTOR OF CORRESPONDING COLOR.

4. CHECK THAT THE CONNECTIONS ARE SECURE.

IMPORTANT: ATTACH ELECTRICAL COMPONENTS WITH CAUTION.

5. IF NECESSARY, UNCLIP THE SEAT BELT. MOVE BOTH SIDES OF THE SEAT BELT OUT OF THE WAY OF THE SEAT SECTION.
6. POSITION THE SEAT BOTTOM SUCH THAT THE CURVED SECTION IS FORWARD AND THE CROSSHATCH SECTION IS FACING UP.
7. POSITION THE SEAT BACK SUCH THAT THE HEADRESTS ARE UP AND THE CROSSHATCH IS FORWARD.
8. ALIGN THE 4 CENTER TABS AT THE BACK OF THE SEAT BOTTOM WITH THE 4 HOLES AT THE BASE OF THE SEAT BACK, AND PUSH THE TABS INTO THE HOLES.

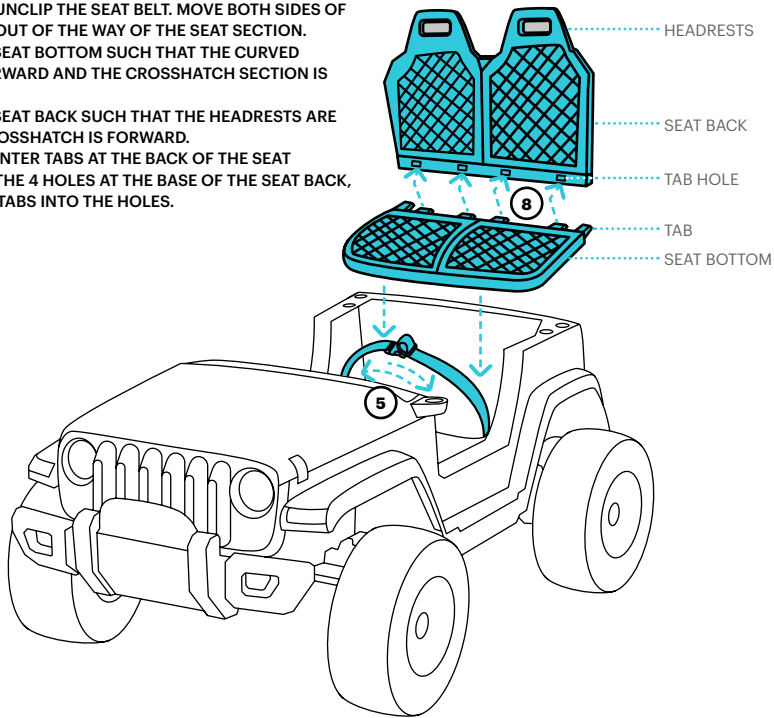

9. PUSH THE CONNECTED SEAT BACK AND SEAT BOTTOM INTO THE SEAT SECTION, AND SLIDE IT BACK SUCH THAT THE TWO REMAINING TABS IN THE SEAT BOTTOM FIT INTO THE TAB HOLES AT THE REAR OF THE SEAT SECTION.

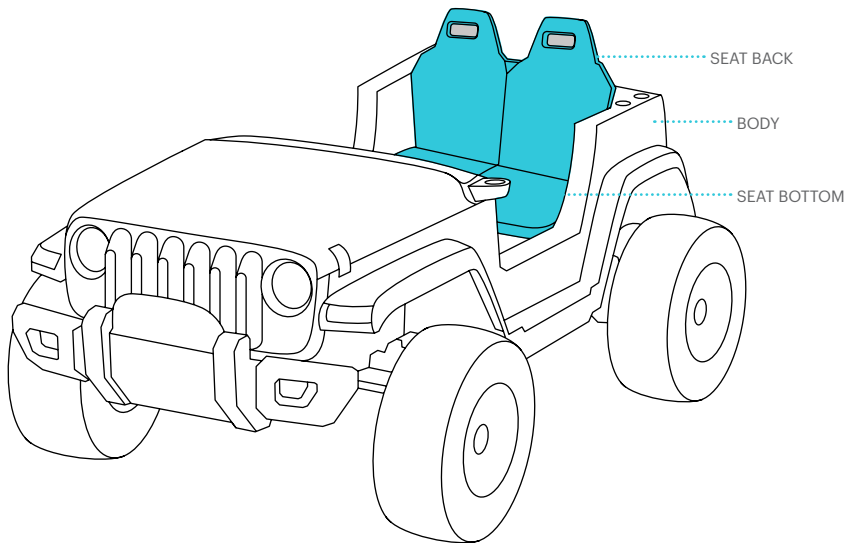

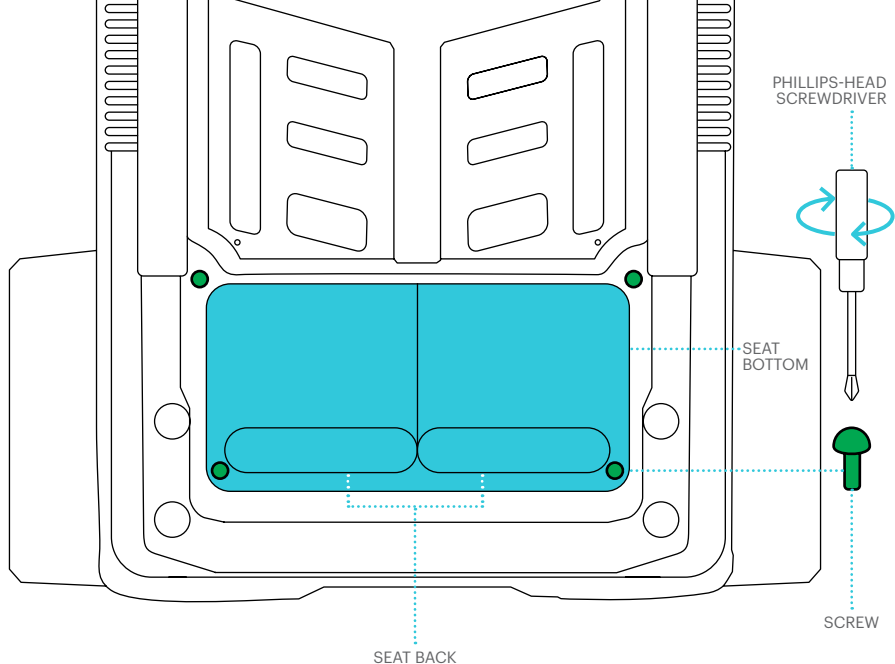

10. INSERT ONE SCREW INTO EACH SET OF ALIGNED HOLES IN THE SEAT BACK AND BODY, AND SEAT BOTTOM AND BODY, BY TWISTING IT CLOCKWISE. (4 TOTAL) TIGHTEN THE SCREWS WITH THE PHILLIPS-HEAD SCREWDRIVER.

11. CHECK THAT THE SEAT BOTTOM AND SEAT BACK ARE SECURELY ATTACHED TO THE BODY.

1.6 Attaching the Rear Tailstock

1. POSITION THE REAR TAILSTOCK OVER THE BODY SUCH THAT THE EXTENSION LEGS ARE IN FRONT AND THE 4 LEGS ARE ALIGNED WITH THE 4 HOLES IN THE REAR OF THE BODY.

2. POP THE LEGS INTO THE HOLES.

NOTE: YOU MAY HAVE TO USE SOME FORCE.

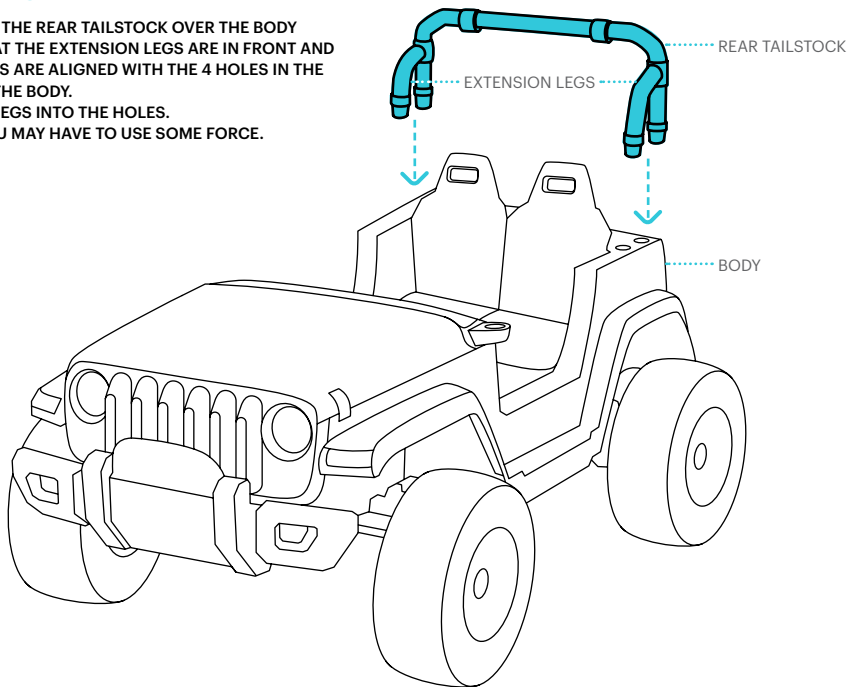

3. CHECK THAT THE REAR TAILSTOCK IS SECURELY ATTACHED.

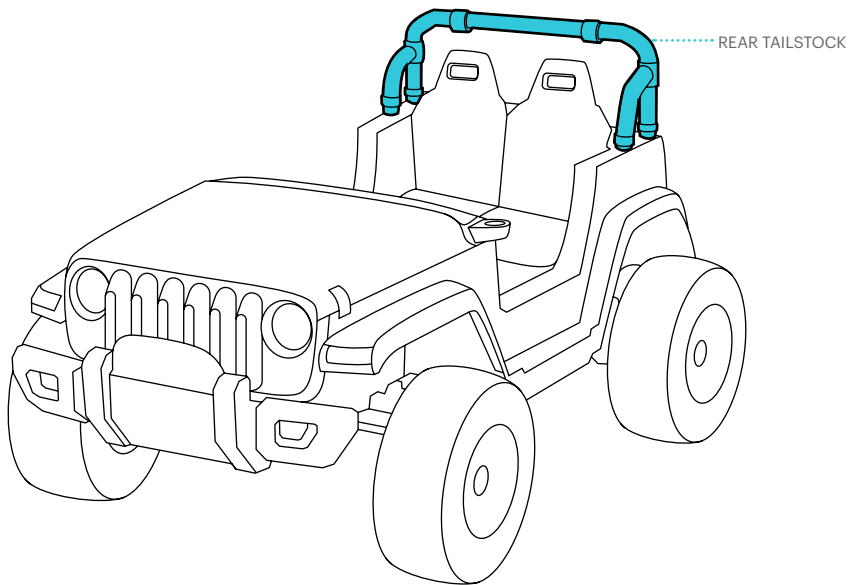

1.7 Attaching the Steering Wheel

1. ALIGN THE STEERING WHEEL STEM WITH THE STEERING POST AT THE FRONT OF THE RIDER AREA. ROTATE THE STEERING WHEEL UNTIL THE TAB HOLES IN THE STEM ARE ALIGNED WITH THE TABS IN THE POST.

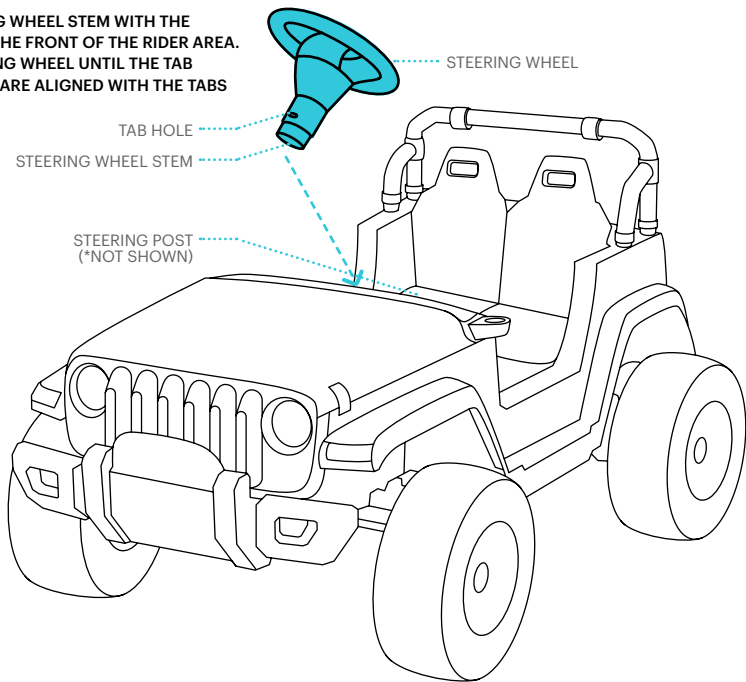

2. PUSH THE STEERING WHEEL STEM ONTO THE STEERING POST.
3. CHECK THAT THE TABS ON THE POST ARE CLICKED INTO THE HOLES IN THE STEM, AND THAT THE STEERING WHEEL IS SECURE.

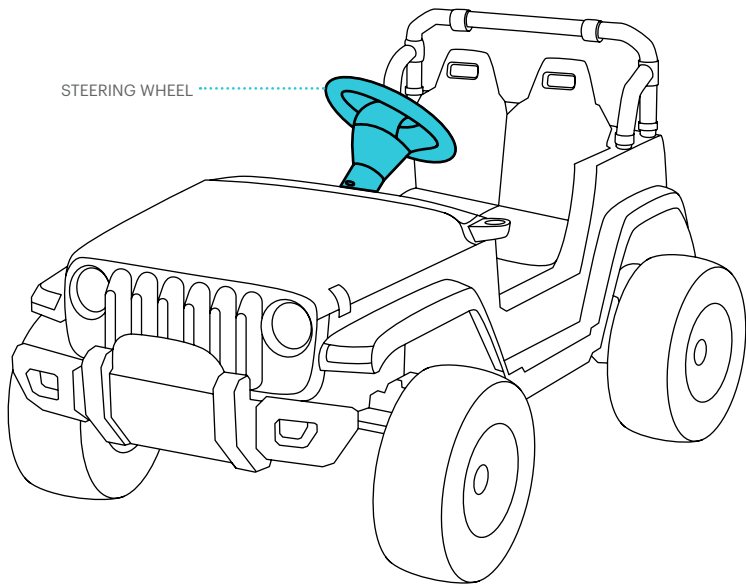

1.7 Attaching the Windshield

1. POSITION THE WINDSHIELD OVER THE FRONT OF THE BODY SUCH THE REFLECTORS ARE AT THE TOP FACING FORWARD.
2. POP THE WINDSHIELD INTO ITS CORRESPONDING SLOT IN THE BODY.

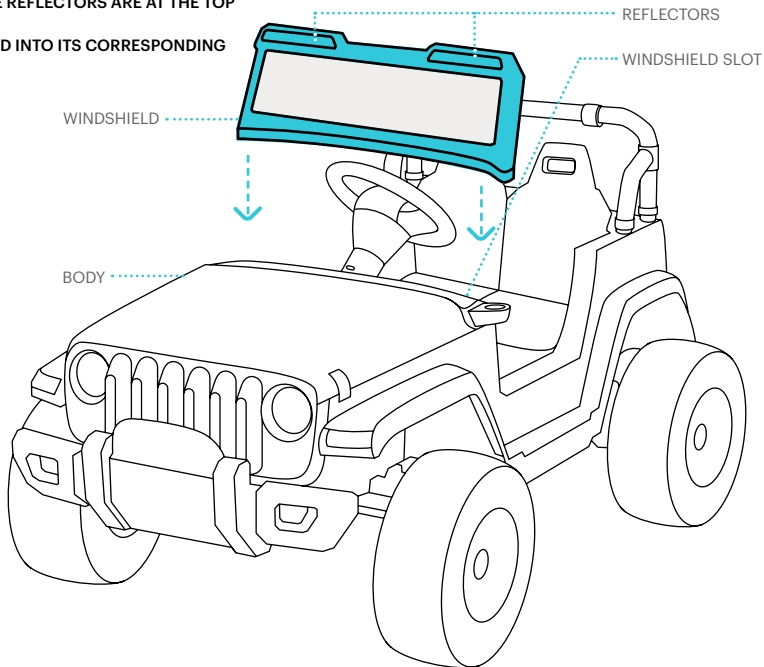

3. INSERT 1 SCREW INTO EACH SET OF ALIGNED HOLES IN THE WINDSHIELD AND BODY BY TWISTING IT IN CLOCKWISE. (2 TOTAL) TIGHTEN THE SCREWS WITH THE PHILLIPS-HEAD SCREWDRIVER.
4. CHECK THAT THE WINDSHIELD IS SECURELY ATTACHED TO THE BODY.

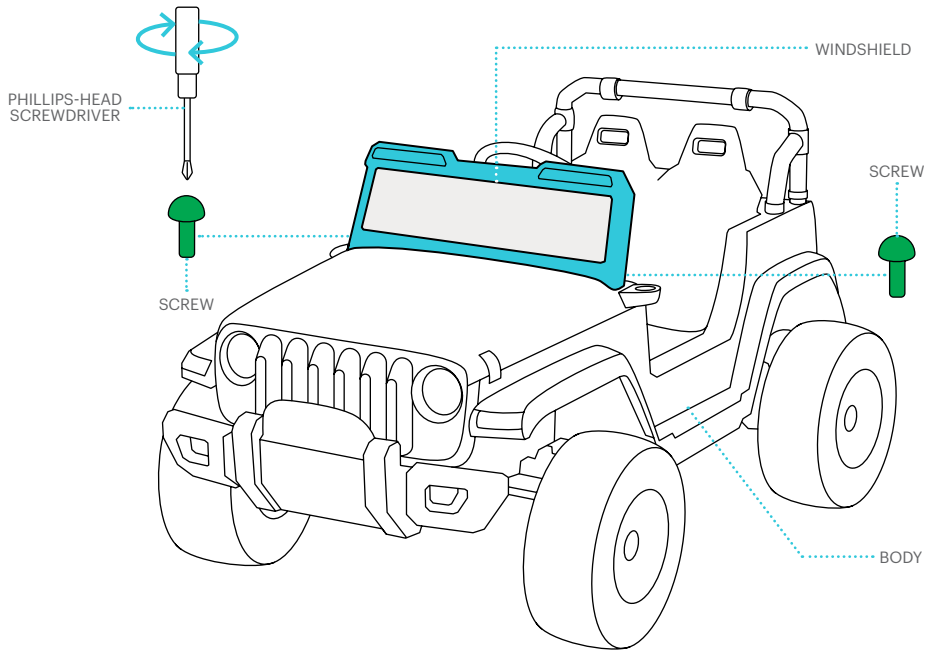

1.8 Attaching the Side Mirrors

1. POSITION THE SIDE MIRRORS ON THE SIDE OF THE WINDSHIELD SUCH THAT THE MIRROR SIDE IS FACING THE RIDER AND THE SIDE WITH THE STEM IS CLOSEST TO THE WINDSHIELD.
2. POP THE STEMS INTO THE DESIGNATED HOLES NEXT TO THE WINDSHIELD.

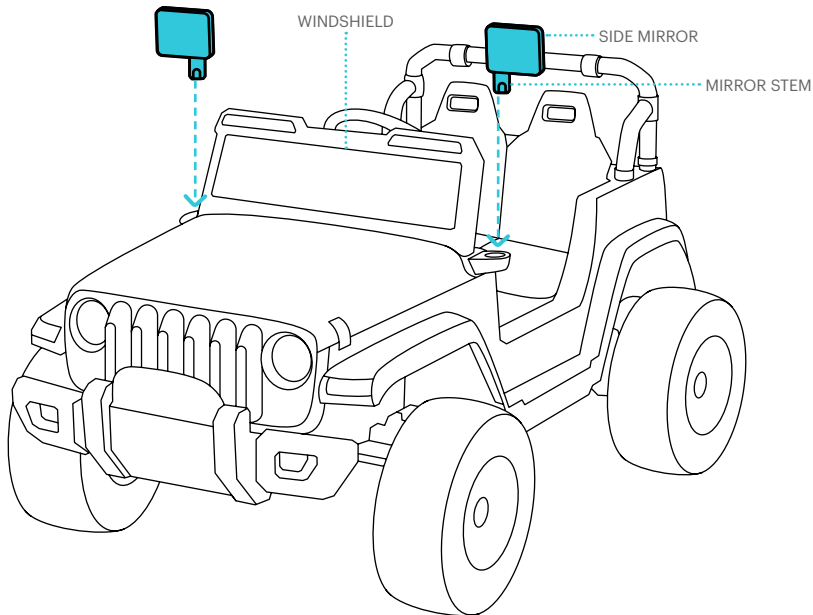

3. ENSURE THAT THE SIDE MIRRORS ARE SECURED TO THE BODY.

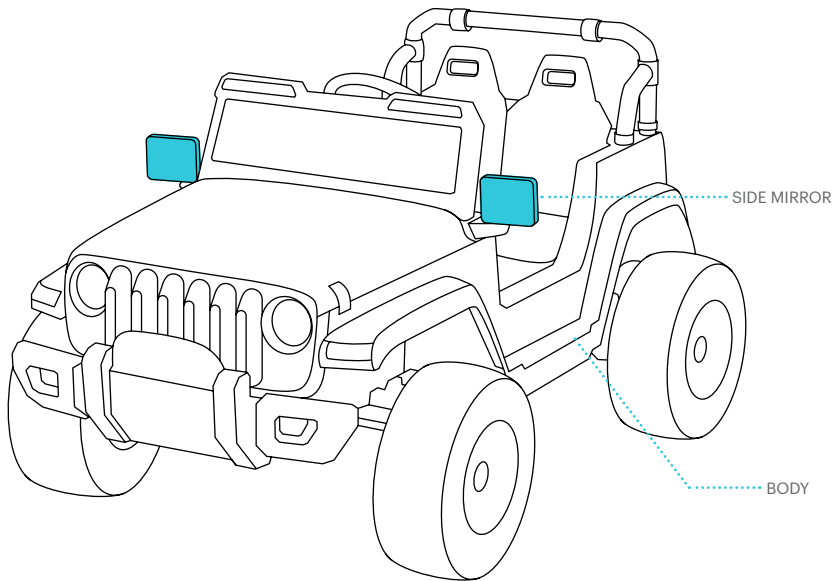

1.9 Charging the Safara

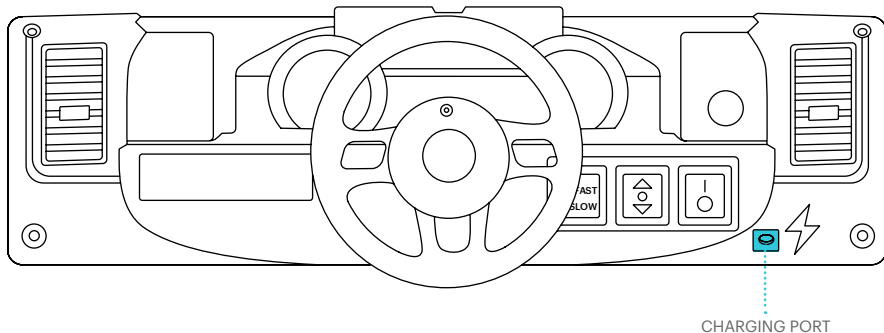



⚠ IMPORTANT: BEFORE RIDING THE SAFARA FOR THE FIRST TIME, CHARGE THE BATTERY FOR 15 TO 18 HOURS — EVEN IF THE CHARGER INDICATOR LIGHT IS ILLUMINATED IN GREEN. THEN, CHARGE ONLY UNTIL THE BATTERY POWER IS FULL — 8 TO 12 HOURS PER SESSION.

1. PLUG THE CHARGING CABLE INTO THE WALL, AND THEN PLUG THE CHARGER INTO THE CHARGING PORT.
2. WHEN THE INDICATOR LIGHT ON THE CHARGER TURNS FROM RED TO GREEN, YOUR BATTERY HAS REACHED FULL CHARGE. REMOVE THE CHARGER FROM THE CHARGING PORT AND UNPLUG THE CABLE FROM THE WALL OUTLET.

IMPORTANT CHARGING NOTES:

- **ONLY USE THE INCLUDED CHARGER OR ONE OBTAINED DIRECTLY THROUGH JETSON LABELED WITH: SL12-07-02**
 FAILURE TO USE CORRECT CHARGER CAN RESULT IN FIRE AND EXPLOSION.
- ALWAYS KEEP THE CHARGING PORT CLOSED WHEN NOT ACTIVELY CHARGING THE BATTERY.
- NEVER TURN ON THE SAFARA WHILE IT IS CHARGING.
- FOR BEST BATTERY HEALTH, CHARGE THE BATTERY FULLY DURING EACH CHARGING SESSION—UP TO 12 HOURS.
- NEVER LEAVE YOUR BATTERY CHARGING OVERNIGHT OR FOR EXTENDED PERIODS OF TIME.
- DO NOT ATTEMPT TO REMOVE OR DISASSEMBLE THE BATTERY.

CHARGING INDICATOR LIGHT ON THE CHARGER

-  - CHARGING
-  - CHARGING COMPLETE

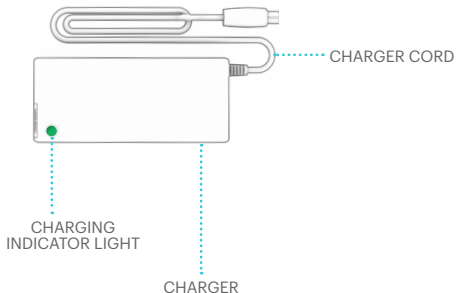

THIS IS THE MARKING YOUR CHARGER WILL HAVE.

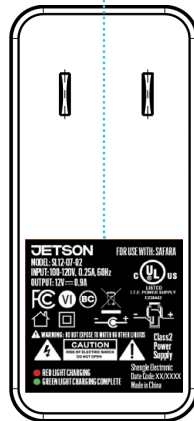

2. Making Moves

IMPORTANT: ENSURE THAT CHILD IS SECURELY FASTENED BY THE SEAT BELT BEFORE RIDING.

2.1 Fastening the Seatbelt

POSITION BOTH STRAPS OF THE SEATBELT OVER THE LAP OF THE RIDER AND CLICK THE INSERTION CLIP INTO THE RECEIVING CLIP. CHECK THAT THE BELT IS SECURE AND SNUG OVER THE RIDER'S LAP. IF NECESSARY, SHORTEN OR LENGTHEN THE BELT BY MOVING THE ADJUSTMENT SLIDE BUCKLE ALONG THE STRAP.

2.2 Setting Up & Using the Remote Control

YOU MAY NEED TO PAIR THE REMOTE CONTROL WITH THE VEHICLE UPON FIRST USE. (PRE-PAIRED ON SOME MODELS.) THE REMOTE CONTROL ALSO NEEDS TO BE PAIRED WITH THE VEHICLE AGAIN EVERY TIME THE REMOTE CONTROL BATTERIES ARE REPLACED.

ONCE THE REMOTE CONTROL IS PAIRED AND WHENEVER IT IS BEING USED, IT WILL TAKE OVER CONTROL OF THE SAFARA. USE THE BUTTONS TO CONTROL VEHICLE SPEED (FAST OR SLOW) AND DIRECTION (LEFT, RIGHT, FORWARD, REVERSE), AND TO STOP (PARK). TO RETURN CONTROL TO THE DRIVER, RELEASE ALL BUTTONS ON THE REMOTE CONTROL.

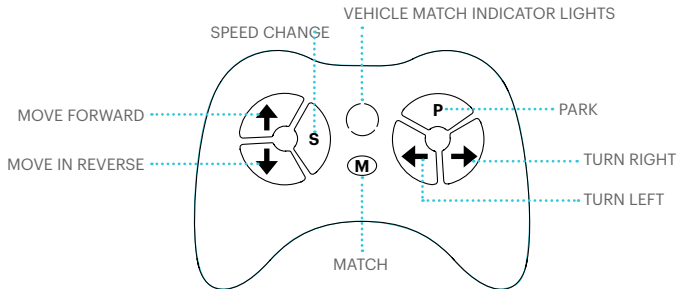

TO INSERT BATTERIES IN THE REMOTE CONTROL:

1. LOOSEN THE SCREW ON THE BATTERY COMPARTMENT ON THE BACK SIDE OF THE REMOTE CONTROL BY TWISTING THE SCREW COUNTERCLOCKWISE WITH THE PHILLIPS-HEAD SCREWDRIVER.
2. LIFT UP THE COMPARTMENT COVER.
3. PLACE 2 AAA BATTERIES AS DIRECTED BY THE +/- MARKINGS IN THE COMPARTMENT.
4. REPLACE THE COMPARTMENT COVER.
5. INSERT AND TIGHTEN THE SCREW IN THE HOLE BY TURNING IT CLOCKWISE WITH THE SCREWDRIVER.

TO PAIR THE REMOTE CONTROL WITH YOUR SAFARA:

1. PRESS AND HOLD THE MATCH BUTTON FOR 2 TO 4 SECONDS. THE INDICATOR LIGHTS ON THE REMOTE CONTROL WILL FLASH.
2. FLIP THE POWER SWITCH ON THE SAFARA DASHBOARD TO TURN THE SAFARA ON. (REFER TO PAGE 51 OF THIS MANUAL.)
3. IF THE LIGHTS CONTINUE TO FLASH, THE PAIRING HAS BEEN UNSUCCESSFUL. REMOVE AND REINSERT THE BATTERIES AND REPEAT STEPS 1 AND 2.

NOTE: AFTER 10 SECONDS OF NON-OPERATION, THE REMOTE WILL GO INTO POWER-SAVING MODE TO PRESERVE BATTERY LIFE.

2.3 Activating Horn & Engine Sounds

PUSH THE BUTTONS ON THE STEERING WHEEL TO MAKE HORN AND ENGINE SOUNDS.

NOTE: INSERTING BATTERIES IN THE STEERING WHEEL WILL ONLY ALLOW THE RIDER TO MAKE USER OF THE HORN AND ENGINE SOUNDS. THEY ARE NOT NECESSARY FOR RIDING.

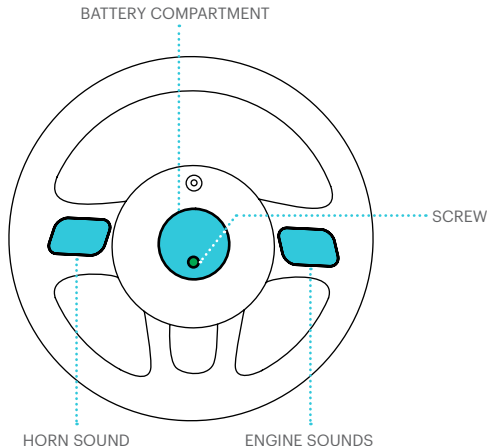

TO INSERT BATTERIES IN THE STEERING WHEEL:

1. LOOSEN THE SCREW ON THE BATTERY COMPARTMENT BY TWISTING THE SCREW COUNTERCLOCKWISE WITH THE PHILLIPS-HEAD SCREWDRIVER.
2. LIFT UP THE COMPARTMENT COVER.
3. PLACE 2 AA BATTERIES AS DIRECTED BY THE +/- MARKINGS IN THE COMPARTMENT.
4. REPLACE THE COMPARTMENT COVER.
5. INSERT AND TIGHTEN THE SCREW IN THE HOLE BY TURNING IT CLOCKWISE WITH THE SCREWDRIVER.

2.4 A Guide to Your Dashboard

TOGGLE THE SWITCHES ON THE DASHBOARD TO POWER ON/OFF, SWITCH FROM FAST TO SLOW, AND CHANGE DIRECTIONS FROM FORWARD TO REVERSE.

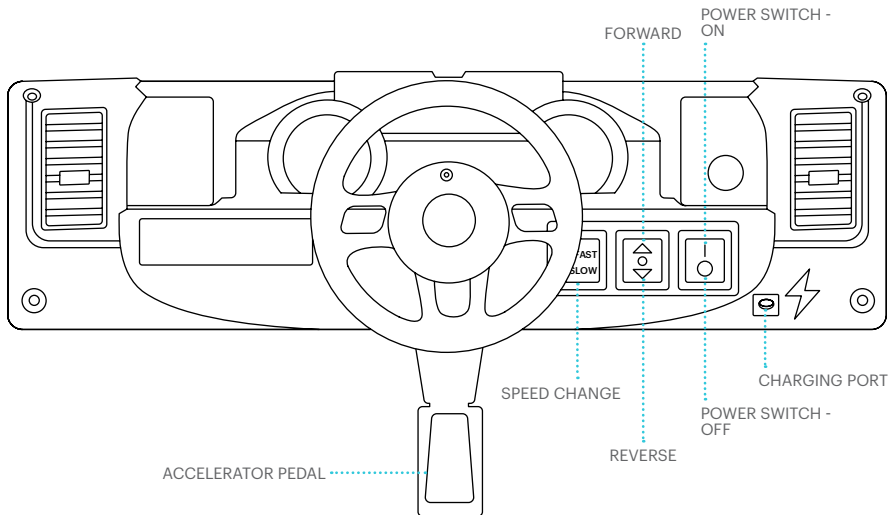

- ENGAGE THE ACCELERATOR PEDAL UNDERNEATH THE DASHBOARD TO MOVE THE SAFARA.
- EASE BACK ON THE PEDAL TO SLOW DOWN OR STOP.

NOTE: THE HEADLIGHTS AND TAIL LIGHTS WILL ILLUMINATE WHENEVER THE SAFARA IS POWERED ON.

2.5 Riding the Safara

IMPORTANT: ALWAYS FASTEN THE SEATBELT OVER THE LAP OF THE RIDER PRIOR TO POWERING ON THE SAFARA.

TO GO: PUSH THE ACCELERATOR PEDAL TO MOVE THE SAFARA ACCORDING TO THE SPEED (FAST OR SLOW) AND DIRECTION (FORWARD OR BACKWARD) IN WHICH YOU HAVE THE VEHICLE SET.

TO SLOW DOWN: EASE UP ON THE PEDAL.

TO STOP: RELEASE THE PEDAL.

TO TURN: ROTATE THE STEERING WHEEL LEFT OR RIGHT.

2.6 Helmet Safety

A HELMET SHOULD BE WORN BY THE RIDER AT ALL TIMES.



PROPER POSITIONING:
THE FOREHEAD IS COVERED
BY THE HELMET.



IMPROPER POSITIONING:
THE FOREHEAD IS EXPOSED.
A FALL COULD RESULT IN SERIOUS INJURY.

* WEAR A HELMET, APPROPRIATE CLOTHING, SHOES, AND SAFETY GEAR. AVOID CLOTHING THAT CAN GET CAUGHT INTO OR UNDER THE WHEELS. CLOSED-TOE, FLAT SHOES ARE RECOMMENDED. WEAR AN ASTM F1492 APPROVED HELMET AND PROTECTIVE GEAR TO PREVENT INJURY IN THE EVENT OF AN ACCIDENT.

Care & Maintenance

CLEANING THE SAFARA

- TO CLEAN THE SAFARA, CAREFULLY WIPE WITH A DAMP CLOTH AND THEN DRY WITH A DRY CLOTH. DO NOT APPLY WATER DIRECTLY TO THE PRODUCT, AS THE ELECTRICAL AND ELECTRONIC SYSTEMS MAY GET WET, WHICH COULD LEAD TO A MALFUNCTION THAT PUTS RIDER SAFETY AT RISK.
- IF THE ELECTRIC PARTS OR BATTERY GET WET, DO NOT POWER ON THE SAFARA. CONTACT THE JETSON CARE TEAM FOR ASSISTANCE.

STORING THE SAFARA

- STORE THE SAFARA INDOORS AND IN A DRY PLACE.
- COVER THE SAFARA TO PROTECT IT AGAINST DUST.
- FULLY CHARGE THE BATTERY BEFORE STORING FOR EXTENDED PERIODS OF TIME. ONCE IN STORAGE, CHARGE THE BATTERY ONCE A MONTH.

BATTERY CARE AND PRECAUTIONS

- KEEP AWAY FROM FIRE AND EXCESSIVE HEAT.
- TIMELY BATTERY CHARGING AFTER EVERY RIDE WILL PROLONG BATTERY LIFE.
- AVOID INTENSE PHYSICAL IMPACT AND/OR SEVERE VIBRATION.
- PROTECT FROM WATER AND MOISTURE.
- DO NOT DISASSEMBLE THE HOVERBOARD OR ITS BATTERY.
- CONTACT THE JETSON CARE TEAM IF THERE ARE ANY ISSUES WITH THE BATTERY.

Stay connected.

Be sure to follow **@ridejetson**
on social media to learn about fantastic offers,
giveaways, and all the latest Jetson news.



Loving your ride?

Then be sure to leave a review at ridejetson.com/reviews.
We can't wait to hear from you!

JETSON

#MakeMoves

Questions? Let us help.

ridejetson.com/support
ridejetson.com/chat

To exercise your product's warranty
or inquire about warranty
coverage, contact us directly.

US/CANADA: 1-888-976-9904
UK: +44 1355 241 222

Manufactured in Zhejiang, China
Imported by Jetson Electric Bikes LLC.
P.O. Box 320149, 775 4th Ave #2,
Brooklyn, NY 11232

www.ridejetson.com



Made in China
Date Code: 08/2023
Document Edition: v2.1

© 2023, JETSON. ALL RIGHTS RESERVED. Manufactured by JETSON ELECTRIC BIKES LLC.
No portion of this document, including shape, copy, graphics, and design,
may be reproduced or transmitted in any form or by any means.