

**JETSON**

# Electric Bike Rear Basket

**A guide for your accessory.**

IMPORTANT: READ CAREFULLY AND RETAIN FOR FUTURE REFERENCE.

MODEL: JRBSKT-BLK



**Jetson's top two riding rules:  
Be safe. Have fun!**

# Contents

<b>Safety Warnings</b> .....	3
<b>What's in the Box</b> .....	4
<b>Product Specs &amp; Care</b> .....	6
<b>Warranty Coverage</b> .....	6
<b>Online Resources</b> .....	7
<b>Basket Assembly &amp; Attachment</b>	
Prepping your Bike .....	8
Prepping the Basket .....	17
Attaching the Basket to your Bike .....	20
<b>Using the Basket</b> .....	27

## Safety Warnings

- Before use, please read the user manual and safety warnings carefully, and make sure you understand and accept all the safety instructions. The user will be responsible for any loss or damage caused by improper use.
- Components shall be maintained and repaired in accordance with the manufacturer's specifications and using only the manufacturer's authorized replacement parts with installation performed by dealers or other skilled persons.
- This product should not be used by children or persons with reduced physical, sensory or mental capabilities, or lack of experience and knowledge, unless they have been given supervision or instruction (IEC 60335-1/A2:2006).
- Unsupervised children should not play with the product (IEC 60335-1/A2:2006).
- Adult supervision is required.
- The max load capacity should not exceed 11 lb.
- Replace worn or broken parts immediately.
- The owner shall allow the use and operation of the unit after a demonstration that such operators can understand and operate all components of the unit before use.

### MODIFICATIONS

Do not attempt to disassemble, modify, repair, or replace the product or any components of the unit without instruction from the Jetson Care Team. This will void any warranty, and can lead to malfunctions which may cause injury.

### California Proposition 65

## **WARNING:**

This product can expose you to chemicals including Chromium (hexavalent compounds), which is known to the State of California to cause cancer and birth defects or other reproductive harm. For more information go to: [www.P65warnings.ca.gov](http://www.P65warnings.ca.gov).

# What's in the Box

1. BASKET
2. BRACKET
3. BRACKET EXTENDER (X2)
4. ELASTIC STRAP
5. CLAMP WITH QUICK-RELEASE LATCH
6. CLAMP SIZING RING

## TOOLS & HARDWARE:



**SMALL WASHER**  
(X7, INCLUDING 1 SPARE)



**MEDIUM WASHER**  
(X7, INCLUDING 1 SPARE)



**NUT**  
(X3)



**BOLT**  
(X7, INCLUDING 1 SPARE)

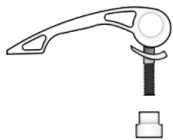

**QUICK-RELEASE LATCH WITH  
CURVED WASHER & KNOB**  
(PRE-ASSEMBLED ON THE  
CLAMP IN SOME MODELS)



**MEDIUM BOLT (X2)**



**LARGE BOLT**



**3MM & 4MM ALLEN KEYS**

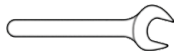

**10MM OPEN SPANNER WRENCH**

\* ADULTS MUST ASSIST CHILDREN IN THE ASSEMBLY AND INITIAL ADJUSTMENT PROCEDURES OF THE PRODUCT.

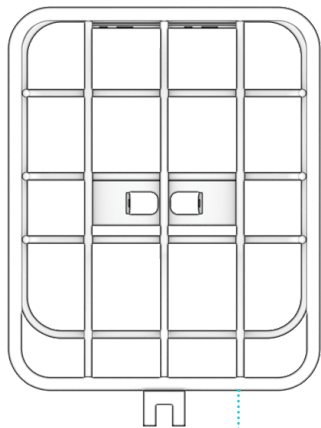

1



2

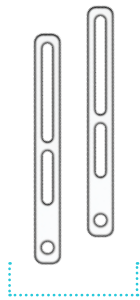

3



4

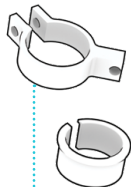

5

6

## Product Specs & Care

- BASKET DIMENSIONS: 11.8" (L) X 8.7" (W) X 6.5" (H)
- WEIGHT: 2.2 LBS
- MAX CARRYING LOAD: 11 LBS
- MATERIAL: IRON
- COMPATIBILITY: DESIGNED FOR USE WITH MANY JETSON ELECTRIC BIKES.

**CARE:** TO CLEAN YOUR BASKET, WIPE FIRST WITH A DAMP CLOTH AND THEN WITH A DRY CLOTH.

## Warranty Coverage

### GENERAL LIMITED WARRANTY

Your new Jetson product is warranted against defects in materials and workmanship as indicated on [ridejetson.com/warranty](https://ridejetson.com/warranty) for a period of time from the date of original retail purchase when used in accordance with Jetson's user manuals (refer to [ridejetson.com/support](https://ridejetson.com/support)). **Under this warranty, you will be able to direct your claims to Jetson even in situations where you purchased the Jetson Product from one of our authorized retailers.** To read the full terms of our warranty, visit [ridejetson.com/warranty](https://ridejetson.com/warranty).



## Online Resources

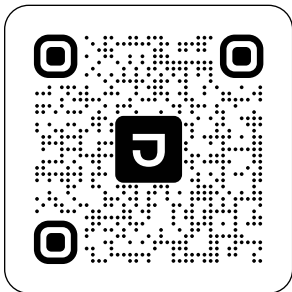

**Scan for our most updated onboarding materials and support resources.**

### **⚠️WARNING:**

FAILURE TO COMPLY WITH THE FOLLOWING INSTRUCTIONS MAY RESULT IN INJURY TO THE CHILD OR OTHERS.

- KEEP SMALL PARTS AWAY FROM CHILDREN DURING ASSEMBLY.
- ACCESSORY MUST BE ASSEMBLED AND REMOVED BY AN ADULT.
- FREQUENTLY INSPECT THE PRODUCT FOR DAMAGE.

\* ADULTS MUST ASSIST CHILDREN IN THE ASSEMBLY AND INITIAL ADJUSTMENT PROCEDURES OF THE PRODUCT.

# 1. Basket Assembly & Attachment

## 1.1 Prepping your Bike

### ATTACH THE BRACKET

1. USING AN APPROPRIATELY SIZED ALLEN KEY FOR YOUR BIKE\*, LOOSEN AND REMOVE THE BOLT SECURING THE REAR WHEEL FENDER BY TURNING IT CLOCKWISE. REMOVE IT AND SET IT ASIDE ALONG WITH THE WASHER (IF APPLICABLE), AND NUT (IF APPLICABLE)\*\* AND FENDER THAT IT HAD BEEN SECURING.

\* DEPENDING ON YOUR BIKE MODEL, THE ALLEN KEYS INCLUDED WITH THIS BASKET MAY OR MAY NOT FIT THE FENDER BOLT ON YOUR BIKE

\*\* DEPENDING ON THE DATE OF PRODUCTION OF YOUR BIKE, YOURS MAY OR MAY NOT HAVE A NUT ON THE UNDERSIDE.

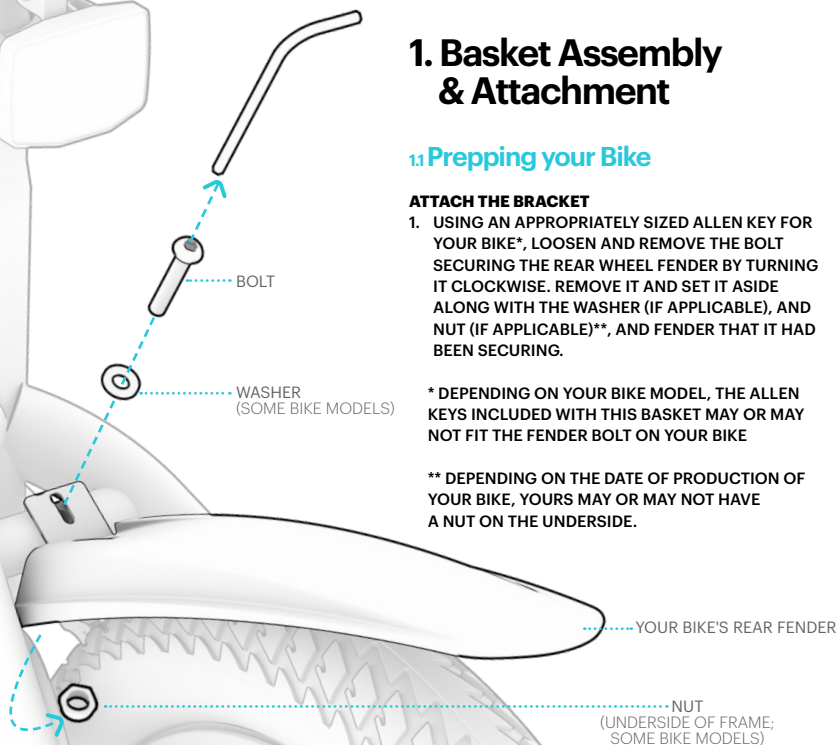

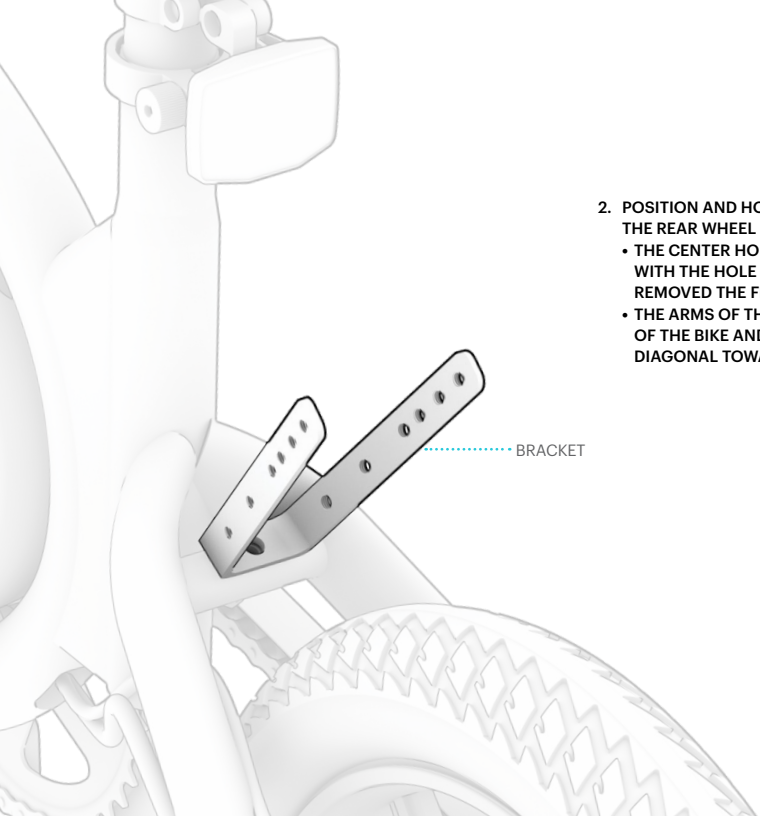

**2. POSITION AND HOLD THE BASKET BRACKET OVER THE REAR WHEEL SUCH THAT:**

- **THE CENTER HOLE IN THE END OF IT IS ALIGNED WITH THE HOLE FROM WHICH YOU JUST REMOVED THE FENDER.**
- **THE ARMS OF THE BRACKET ARE ON THE SIDES OF THE BIKE AND EXTEND UPWARDS ON THE DIAGONAL TOWARDS THE REAR OF THE BIKE.**

BRACKET

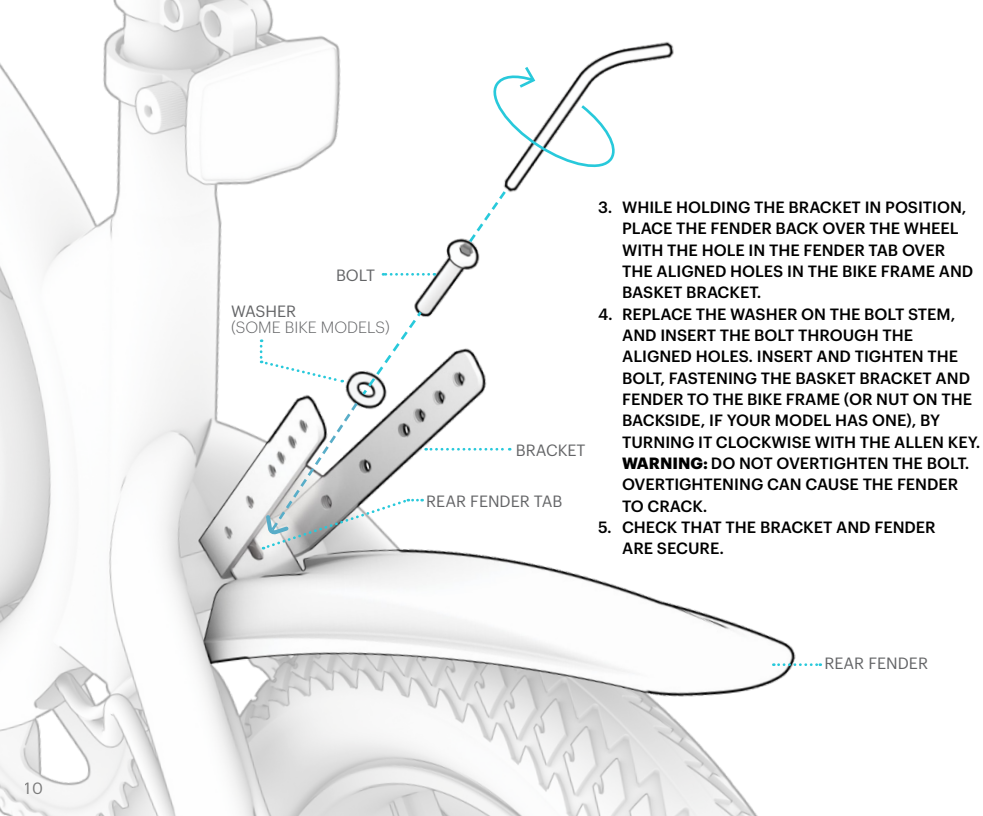

3. WHILE HOLDING THE BRACKET IN POSITION, PLACE THE FENDER BACK OVER THE WHEEL WITH THE HOLE IN THE FENDER TAB OVER THE ALIGNED HOLES IN THE BIKE FRAME AND BASKET BRACKET.
4. REPLACE THE WASHER ON THE BOLT STEM, AND INSERT THE BOLT THROUGH THE ALIGNED HOLES. INSERT AND TIGHTEN THE BOLT, FASTENING THE BASKET BRACKET AND FENDER TO THE BIKE FRAME (OR NUT ON THE BACKSIDE, IF YOUR MODEL HAS ONE), BY TURNING IT CLOCKWISE WITH THE ALLEN KEY. **WARNING:** DO NOT OVERTIGHTEN THE BOLT. OVERTIGHTENING CAN CAUSE THE FENDER TO CRACK.
5. CHECK THAT THE BRACKET AND FENDER ARE SECURE.

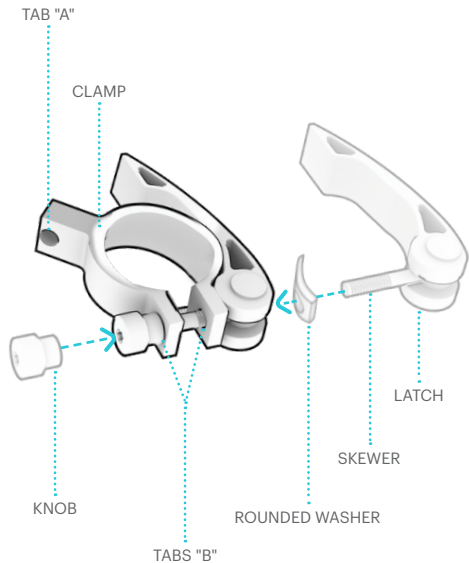

**ASSEMBLE THE CLAMP:**

IF YOUR QUICK-RELEASE SKEWER IS NOT PRE-ASSEMBLED AND ATTACHED TO THE CLAMP, FOLLOW THESE INSTRUCTIONS.

1. SLIDE THE ROUNDED BLACK WASHER ONTO THE SKEWER SUCH THAT THE CURVE OF THE WASHER NESTLES AROUND THE ROUNDED BASE OF THE LATCH. SLIDE THE SKEWER WITH WASHER THROUGH THE TWO HOLES IN TABS "B" OF THE CLAMP, BEGINNING WITH THE ONE FURTHEST FROM TAB "A."
2. TWIST THE KNOB CLOCKWISE ONTO THE END OF THE SKEWER UNTIL IT IS SECURELY ON BUT NOT FULLY TIGHT.

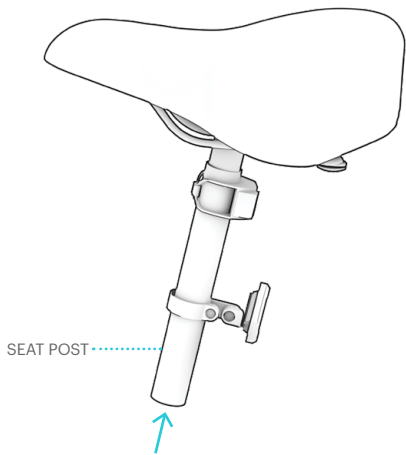

#### **ATTACH THE CLAMP TO YOUR BIKE**

1. ON YOUR BIKE, PULL OPEN THE LATCH ON THE SEAT CLAMP.
2. IF NECESSARY, WIDEN THE CLAMP OPENING BY LOOSENING THE KNOB, AND THEN PULL THE SEAT POST UPWARDS UNTIL IT CLEARS FROM THE BIKE FRAME.

SEAT POST

SEAT CLAMP LATCH

SEAT CLAMP KNOB

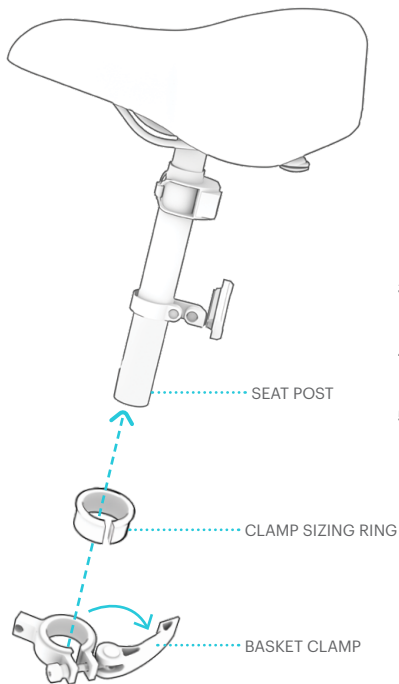

3. SLIDE THE CLAMP SIZING RING UP ONTO THE SEAT POST SUCH THAT THE EDGE WITH THE RIM IS ON TOP.
4. OPEN THE CLAMP LATCH AND LOOSEN (BUT DO NOT REMOVE) THE KNOB BY TURNING IT COUNTERCLOCKWISE.
5. SLIDE THE CLAMP ONTO THE SEAT POST AND ONTO THE SIZING RING.

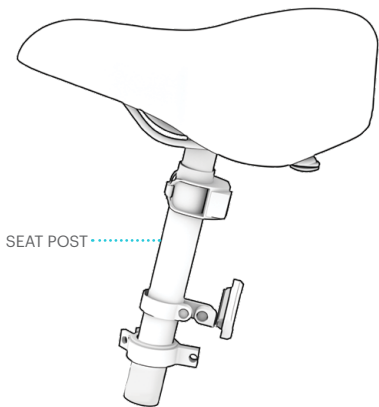

6. REINSERT THE SEAT POST BACK INTO THE SEAT TUBE.
7. ADJUST SEAT HEIGHT TO DESIRED POSITION, THEN TIGHTEN AND CLOSE THE LATCH ON THE SEAT CLAMP. CHECK THAT THE SEAT IS SECURE.

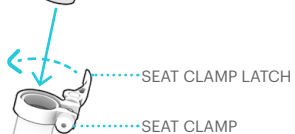



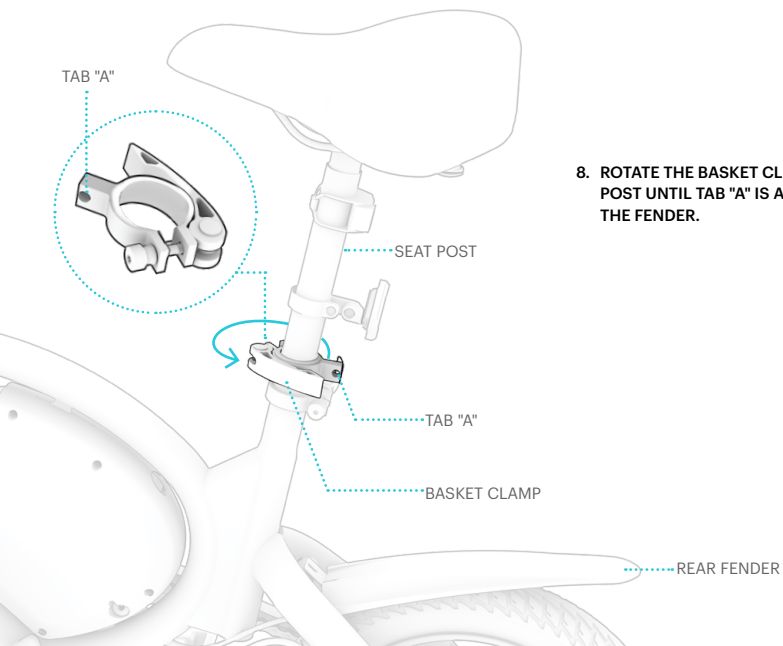

8. ROTATE THE BASKET CLAMP AROUND THE SEAT POST UNTIL TAB "A" IS AT THE REAR, DIRECTLY OVER THE FENDER.

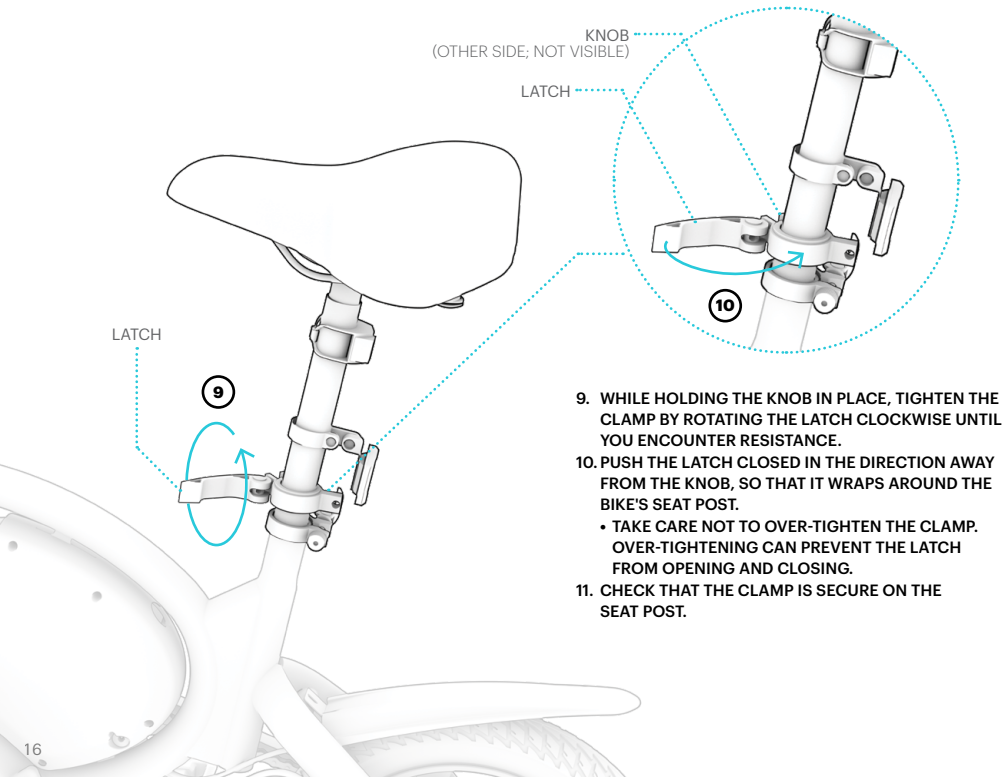

9. WHILE HOLDING THE KNOB IN PLACE, TIGHTEN THE CLAMP BY ROTATING THE LATCH CLOCKWISE UNTIL YOU ENCOUNTER RESISTANCE.
10. PUSH THE LATCH CLOSED IN THE DIRECTION AWAY FROM THE KNOB, SO THAT IT WRAPS AROUND THE BIKE'S SEAT POST.
  - TAKE CARE NOT TO OVER-TIGHTEN THE CLAMP. OVER-TIGHTENING CAN PREVENT THE LATCH FROM OPENING AND CLOSING.
11. CHECK THAT THE CLAMP IS SECURE ON THE SEAT POST.

## 1.2 Prepping the Basket

1. PLACE THE BASKET UPSIDE DOWN ON A FLAT SURFACE.
2. SLIDE A MEDIUM WASHER ONTO A MEDIUM BOLT. WORKING FROM THE OUTSIDE IN, INSERT THE BOLT THROUGH THE HOLE IN ONE OF THE TABS "C" EXTENDING UPWARDS FROM THE BASKET.
3. SLIDE THE SMALLEST HOLE OF ONE BRACKET EXTENDER ONTO THE END OF THE BOLT, THEN SLIDE ON ANOTHER WASHER AND A NUT, STARTING WITH THE LARGER SIDE OF THE NUT.

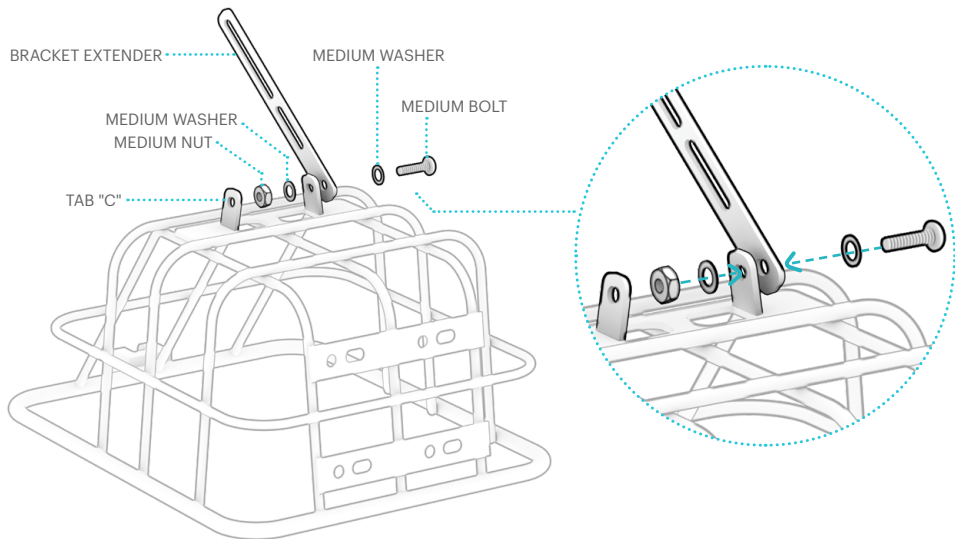

4. USE THE 10MM WRENCH TO HOLD THE NUT STEADY WHILE YOU FULLY TIGHTEN THE BOLT INTO IT BY TURNING THE BOLT CLOCKWISE WITH THE 4MM ALLEN KEY.

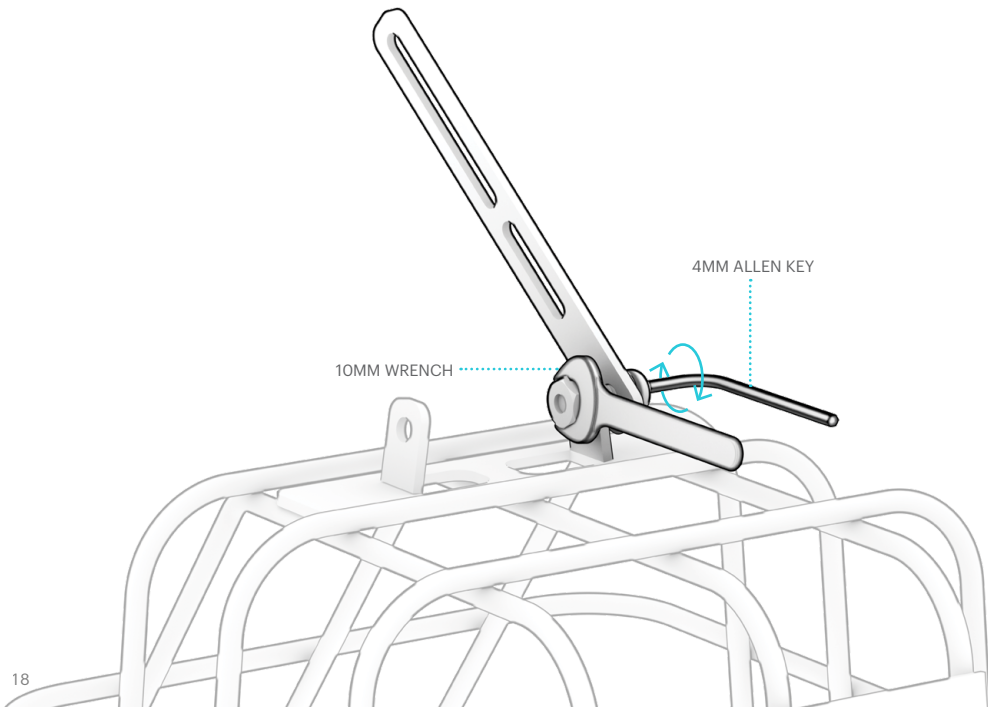

5. REPEAT STEPS 1 - 5 WITH THE OTHER BRACKET EXTENDER.

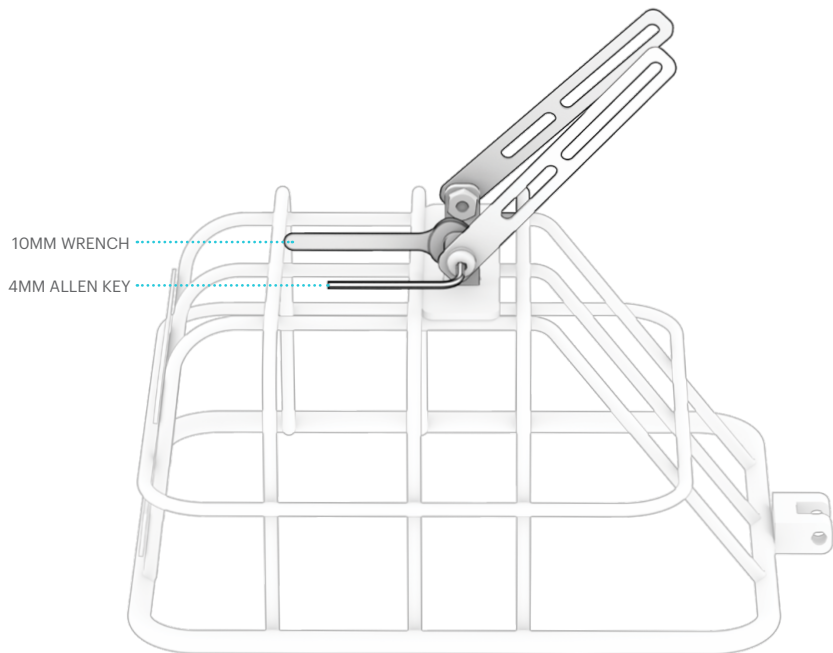

### 1.3 Attaching the Basket to your Bike

#### **FASTEN YOUR BASKET ONTO THE CLAMP**

1. SLIDE A MEDIUM WASHER ONTO THE LARGE BOLT. SET THE HARDWARE ASIDE.
2. TURN THE BIKE BASKET UPRIGHT AND POSITION IT BEHIND THE BASKET CLAMP WITH TABS "D" OF THE BASKET IN LINE WITH TAB "A" OF THE BASKET CLAMP.

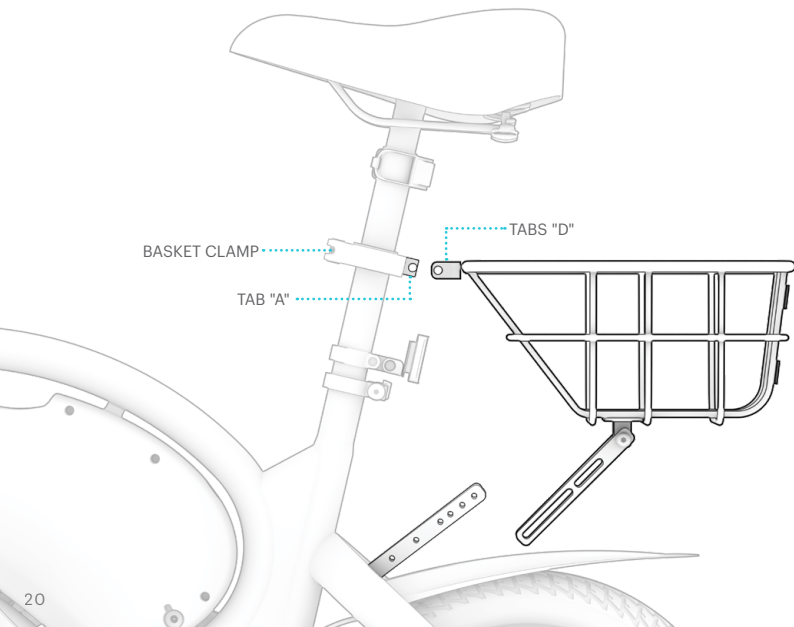

3. SLIDE TABS "D" ONTO EITHER SIDE TAB "A" SO THAT ALL THREE TAB HOLES ARE ALIGNED.

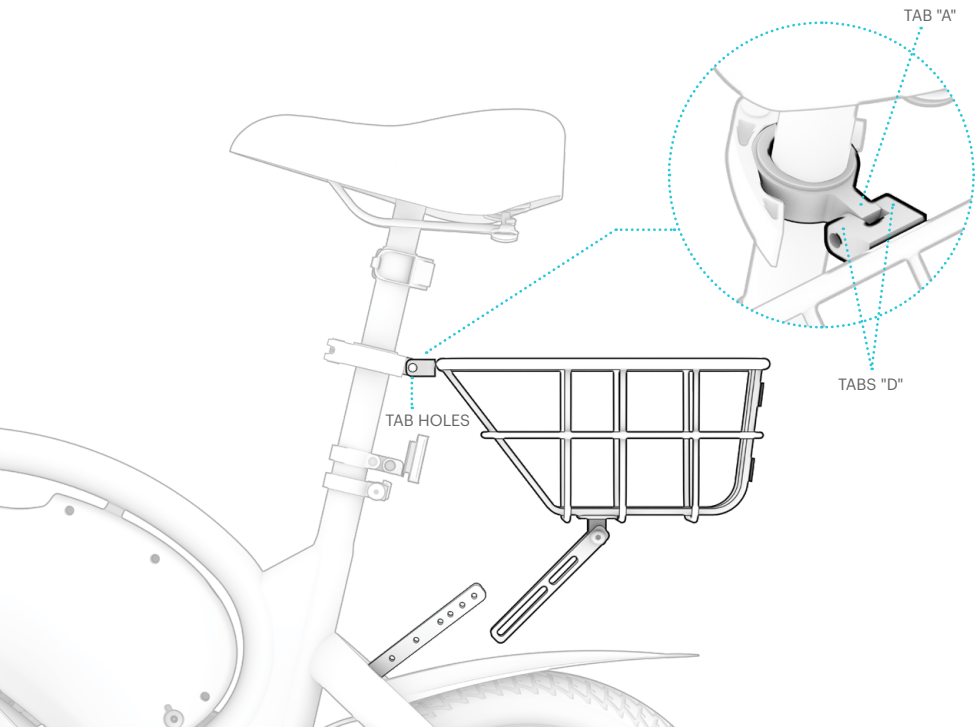

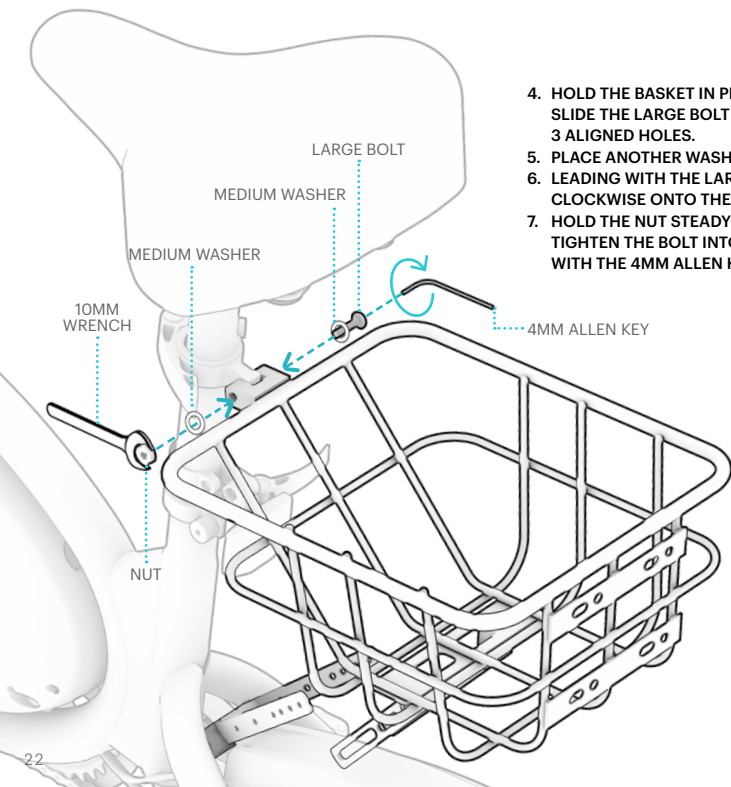

4. HOLD THE BASKET IN PLACE AND, FROM EITHER SIDE, SLIDE THE LARGE BOLT WITH WASHER THROUGH THE 3 ALIGNED HOLES.
5. PLACE ANOTHER WASHER ON THE END OF THE BOLT.
6. LEADING WITH THE LARGER SIDE OF THE NUT, TWIST A NUT CLOCKWISE ONTO THE END OF THE BOLT.
7. HOLD THE NUT STEADY WITH THE 10MM WRENCH. TIGHTEN THE BOLT INTO IT BY TURNING IT CLOCKWISE WITH THE 4MM ALLEN KEY.



## CONNECT THE BRACKET EXTENDERS WITH THE BRACKET

1. HOLD THE BASKET LEVEL.
2. ROTATE THE BRACKET EXTENDERS TOWARDS THE BRACKET ARMS AND POSITION THEM ON THE OUTSIDE OF THE ARMS SUCH THAT THEY OVERLAP AS MUCH AS POSSIBLE.
3. DEPENDING ON YOUR BIKE MODEL, THE HEIGHT OF YOUR BIKE SEAT, AND THE POSITIONING OF THE BASKET BRACKET, YOUR OVERLAP MAY ALLOW YOU TO SECURE THE TWO PIECES TOGETHER WITH 1, 2, OR 3 SCREWS ON EACH SIDE. DETERMINE THE NUMBER OF HARDWARE INSERTION POINTS THAT YOUR SET-UP ALLOWS BY LOOKING TO SEE HOW MANY BRACKET HOLES YOU CAN ALIGN WITH THE HOLES IN THE BRACKET EXTENDERS. (MAXIMUM 3 PER SIDE)

**TROUBLESHOOTING:** IF YOUR BRACKET EXTENDERS CANNOT OVERLAP WITH THE BRACKET ARMS, RETURN TO PAGE 15 AND CHANGE THE HEIGHT OF THE BASKET CLAMP ON THE SEAT POST TO CHANGE THE POSITION OF THE BASKET RELATIVE TO THE BRACKET.

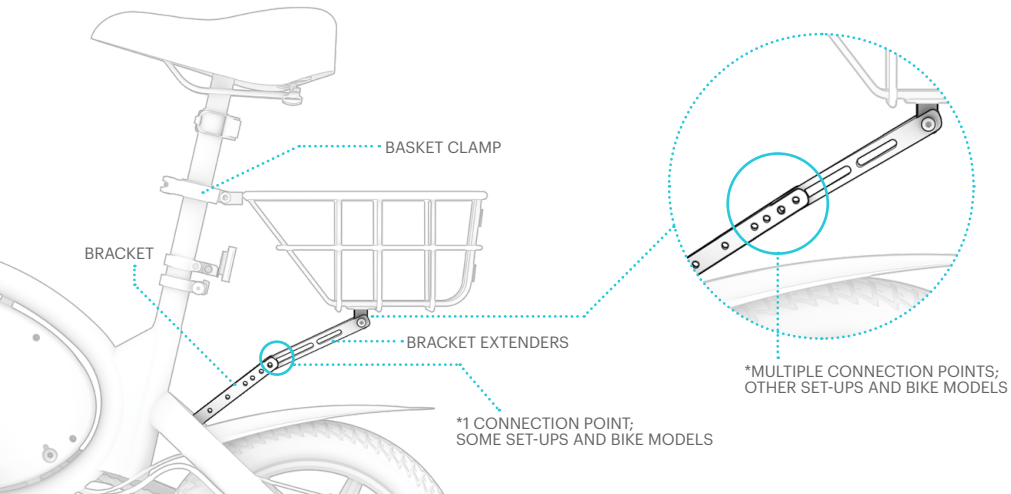

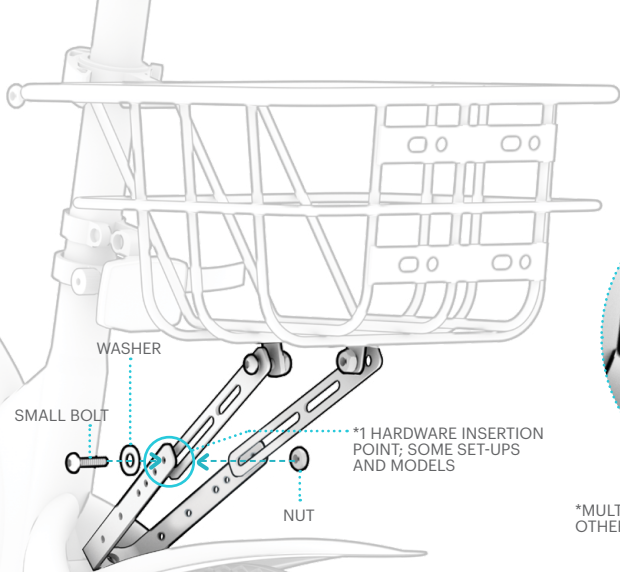

3MM ALLEN KEY

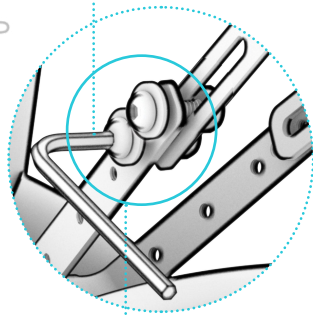

\*MULTIPLE HARDWARE INSERTION POINTS;  
OTHER SET-UPS AND BIKE MODELS

4. SLIDE 1 WASHER ONTO 1 SMALL BOLT FOR EACH AVAILABLE HARDWARE INSERTION POINT.
5. WORKING FROM THE OUTSIDE IN, INSERT A BOLT WITH WASHER THROUGH THE ALIGNED HOLES AT EACH HARDWARE INSERTION POINT BY FINGER-TURNING IT CLOCKWISE.
6. ONCE ALL BOLTS ARE PARTIALLY INSERTED, USE THE 3MM ALLEN KEY TO FULLY INSERT AND THEN TIGHTEN ALL OF THEM.

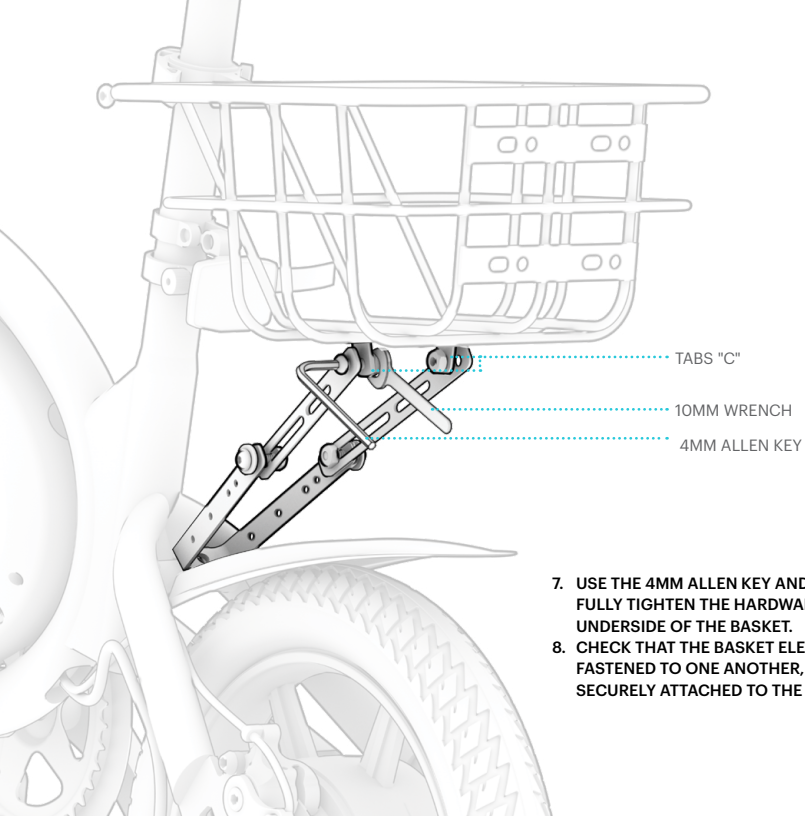

7. USE THE 4MM ALLEN KEY AND 10MM WRENCH TO FULLY TIGHTEN THE HARDWARE IN TABS "C" ON THE UNDERSIDE OF THE BASKET.
8. CHECK THAT THE BASKET ELEMENTS ARE SECURELY FASTENED TO ONE ANOTHER, AND THAT THE BASKET IS SECURELY ATTACHED TO THE BIKE.



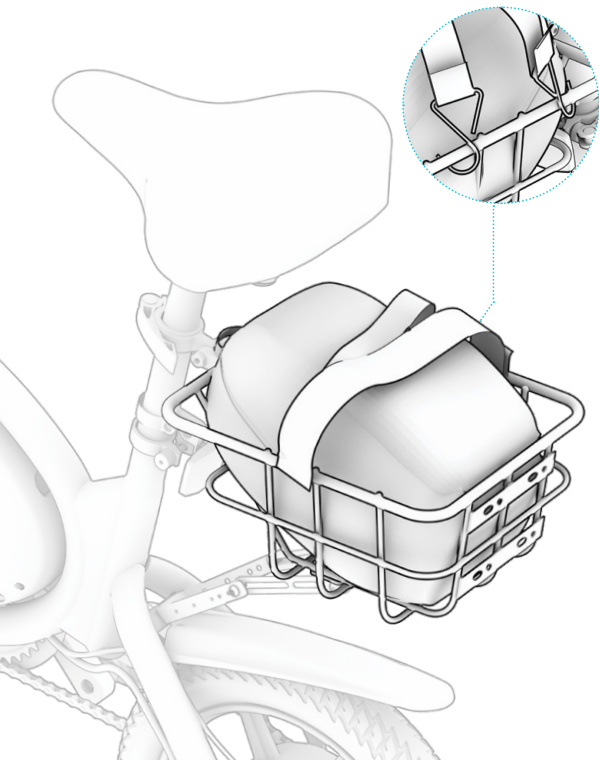

## 2. Using the Basket

### **FOR SAFETY AND SECURITY:**

- LIMIT CARRYING CONTENTS TO 11 POUNDS.
- DO NOT OVERFLOW YOUR BASKET.
- ALWAYS SECURE CONTENTS WITH THE INCLUDED ELASTIC STRAP OR A BUNGEE CORD.

### **TO USE THE INCLUDED ELASTIC STRAP:**

1. HOOK ONE SIDE OF THE STRAP ON THE UNDERSIDE OF THE BASKET.
2. LOOP THE STRAP OVER THE TOP OF THE BASKET.
3. HOOK THE OTHER END OF THE ELASTIC STRAP ONTO THE BASKET SUCH THAT IT IS TAUGHT AND SECURE OVER THE CONTENTS OF THE BASKET.

**NOTE:** DEPENDENT ON THE SIZE OF YOUR CONTENTS, YOU MAY NEED TO DOUBLE-BACK THE STRAP OR LOOP THE STRAP IN A DIFFERENT WAY IN ORDER TO SECURE YOUR CARGO.



## Stay connected.

Be sure to follow **@ridejetson** on social media to learn about fantastic offers, giveaways, and all the latest Jetson news.



## Loving your basket?

Then be sure to leave a review at [ridejetson.com/reviews](https://ridejetson.com/reviews).  
We can't wait to hear from you!

**JETSON**

**#MakeMoves**







# Questions? Let us help.

[ridejetson.com/support](https://ridejetson.com/support)  
[ridejetson.com/chat](https://ridejetson.com/chat)

To exercise your product's warranty or inquire about warranty coverage, contact us directly.

US/CANADA: 1-888-976-9904  
UK: +44 1355 241222

Manufactured in Hebei, China  
Imported by Jetson Electric Bikes LLC.  
P.O. Box 320149, 775 4th Ave #2,  
Brooklyn, NY 11232

[www.ridejetson.com](https://www.ridejetson.com)



Made in China  
Date Code: 09/2023  
Document Edition: v1.2

© 2023, JETSON. ALL RIGHTS RESERVED. Manufactured by JETSON ELECTRIC BIKES LLC.  
No portion of this document, including shape, copy, graphics, and design,  
may be reproduced or transmitted in any form or by any means.