

PHANTOM JETKART

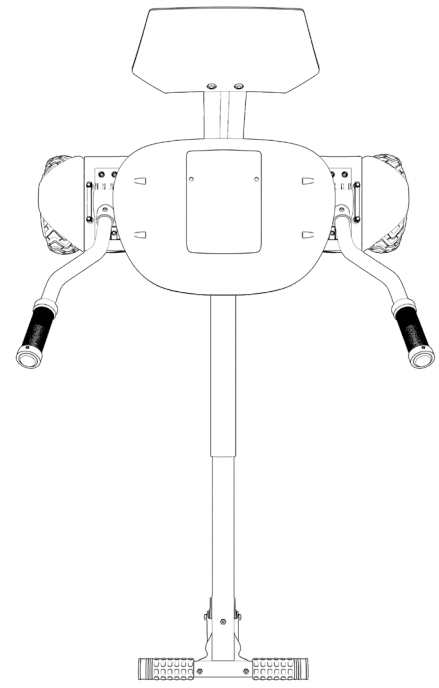

1. WHAT'S IN THE BOX

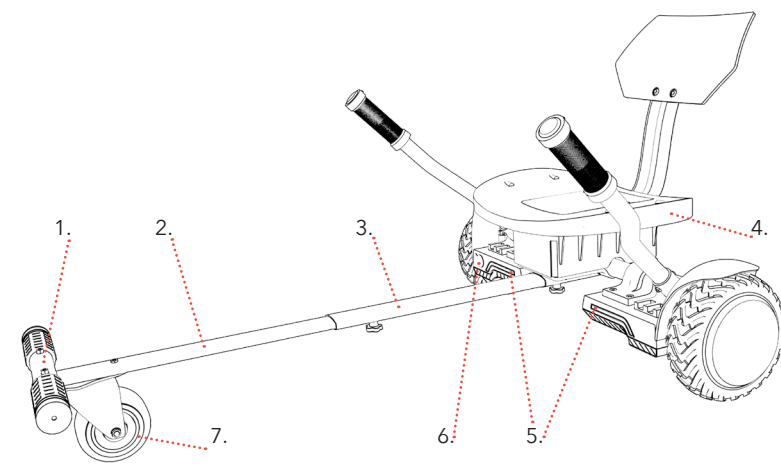

- | | |
|-------------------|-----------------|
| 1. FOOT REST | 6. FRONT LIGHTS |
| 2. FOOT REST TUBE | 7. POWER BUTTON |
| 3. FRAME TUBE | 8. FRONT WHEEL |
| 4. SEAT | |

- | | |
|-------------------|--------------------|
| 1. CHARGING PORT | 4. RIGHT HANDLEBAR |
| 2. LEFT HANDLEBAR | 5. BACK LIGHTS |
| 3. BACK REST | |

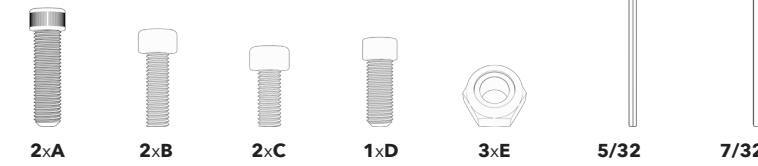
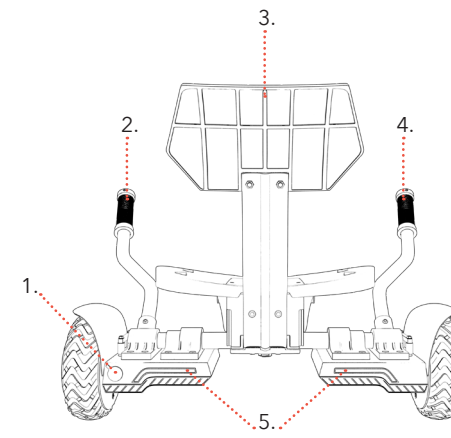

2. FEATURES & SPECS

- Weight Limit: 220 lbs
- Product Weight: 30.3 lbs
- Recommended Age: 13+
- Tire Size: (Front) 4" (Rear) 7"
- Max Speed: 9 mph
- Max Range: 12 miles
- Battery: 36V, 4.0 Ah Lithium Ion
- Motor: 250W*2, Dual Hub Motor
- Charger: 110-240V
- Charge Time: 2-3 Hours
- Frame: Aluminum Alloy

Press in the push buttons on the Handlebars and slide them into the tubes near the base of the Seat. Wait until you hear it click. Make sure the Handlebars are secure.

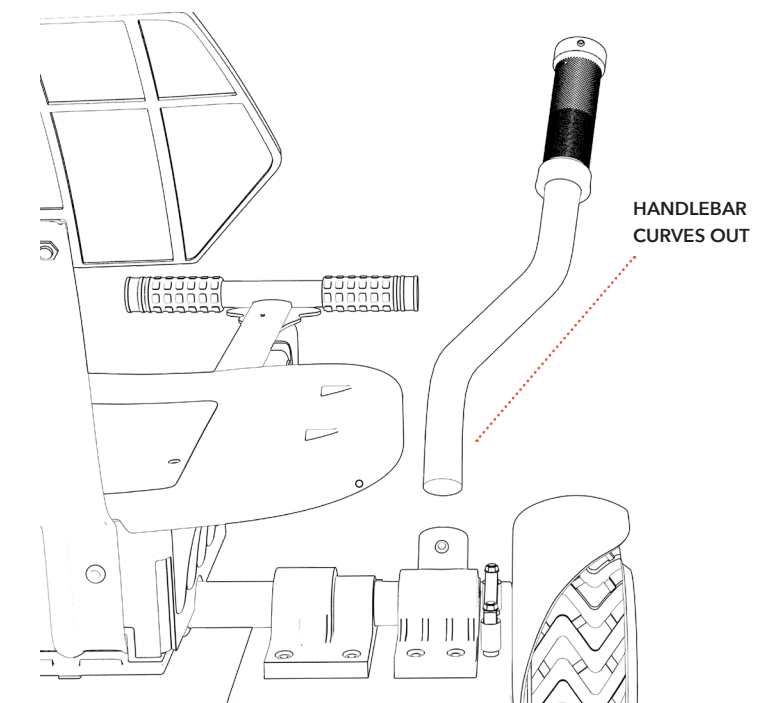
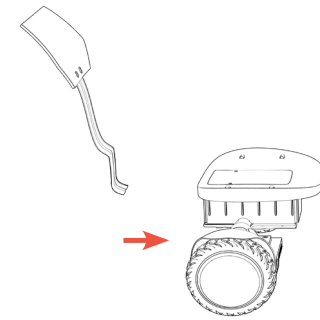

TABLE OF CONTENTS

What's in the Box	1
Features & Specs	2
Assembly	3
Operating the Phantom	4
Adjusting the Foot Rest	5
Charging the Battery	6
Care and Maintenance	7

3. ASSEMBLY

3.1



3.3

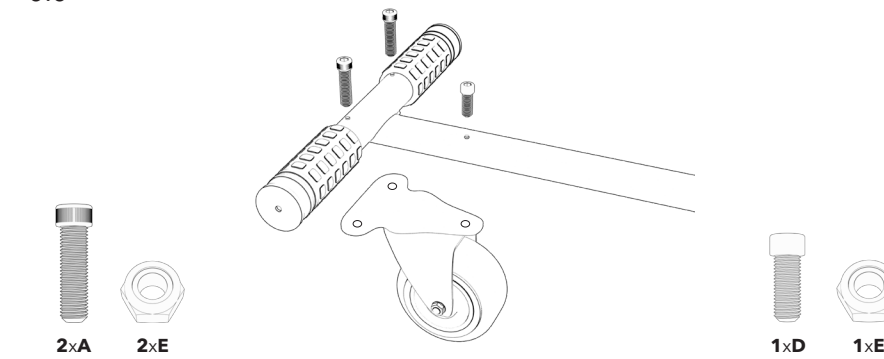

3.2

These bolts may arrive in the back of the unit. You will need to remove them first to assemble the Backrest.

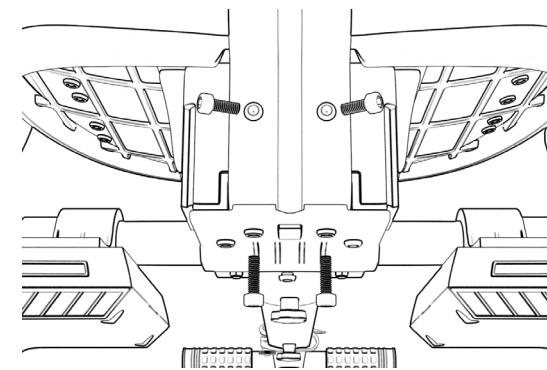
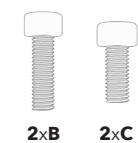

3.4

Slide frame tube into slot at the bottom of the seat.

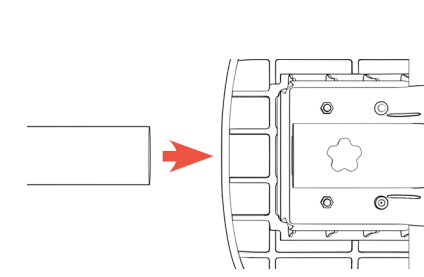

3.5

Tighten knob and bolts.

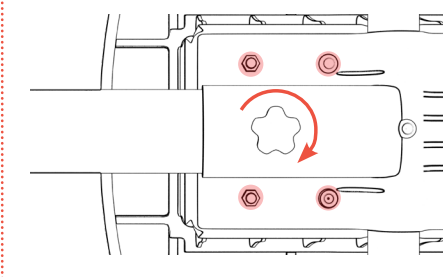

4. OPERATING THE PHANTOM

1. Before taking your seat, place the Phantom on a leveled surface, facing up and turned off.
2. Carefully lower yourself into the seat and place both feet on the footrests.
3. Turn on the Phantom.

FORWARD PUSH DOWN

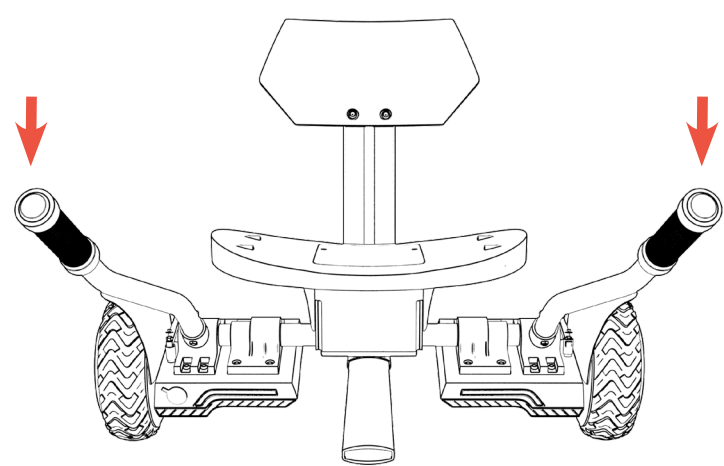

BRAKE/ REVERSE PULL UP

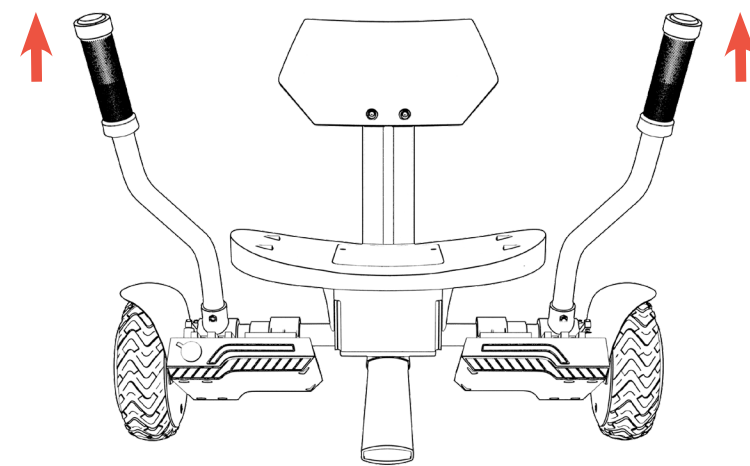

TURN RIGHT

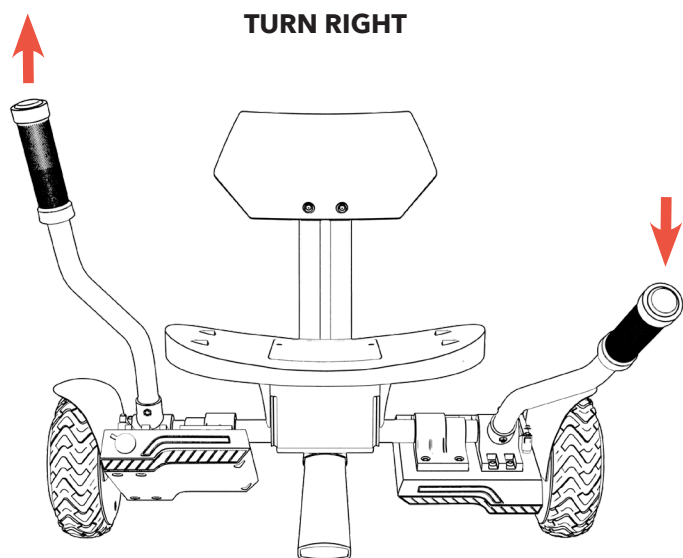

TURN LEFT

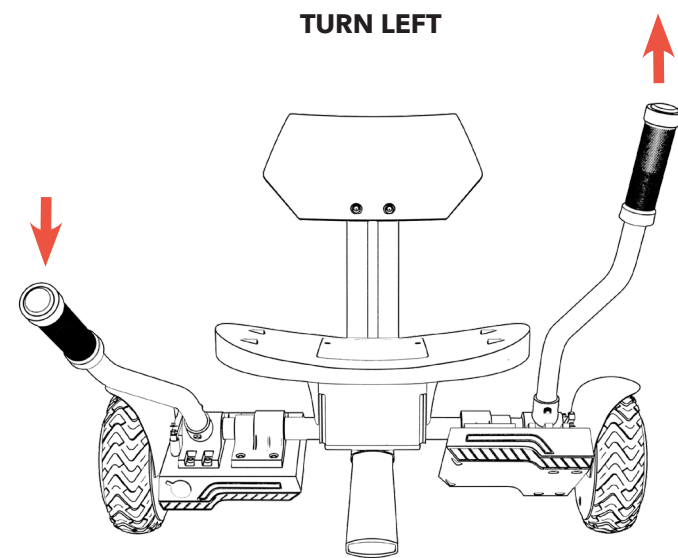

5. ADJUSTING THE FOOT REST

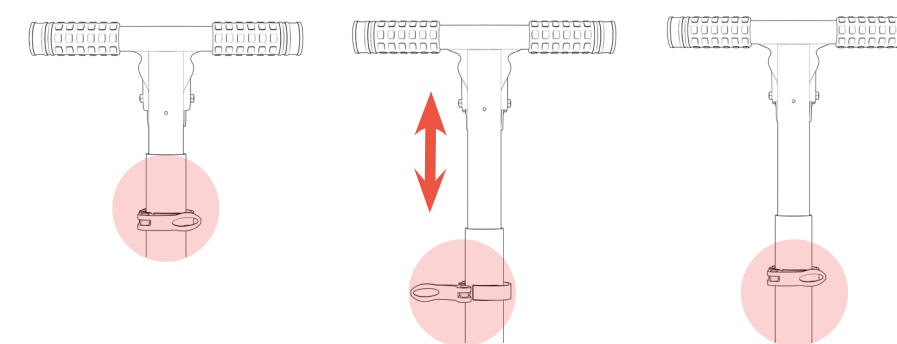

6. CHARGING THE BATTERY

Always use the provided charger only. Do not turn on the Phantom while it is charging. Charge the battery until it is fully charged, and NOT LONGER. Do not leave it plugged in past the charge time. Remember to cover the Charging Port when you are done.

(Please note: Always plug the charger into the wall first before the Charging Port.)

CHARGING INDICATOR ON TOP OF THE CHARGER:
Charging Light Red: Battery is charging.
Charging Light Green: Charging is complete.

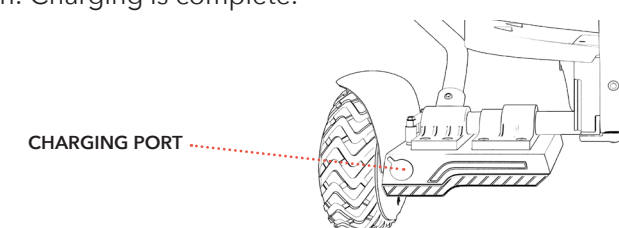

7. CARE AND MAINTENANCE

RIDING RANGE

The average range is 12 miles. However, a lot of factors will affect how far you can go per charge:

- Driving Surface: A smooth, flat surface will increase driving distance.
- Weight: More weight means less distance.
- Temperature: Ride and store the Phantom under recommended temperature (above 50°F).
- Maintenance: Timely battery charging, and maintenance will increase driving distance.
- Speed and Driving Style: Frequent starting and stopping will reduce driving distance.

CLEANING THE PHANTOM

To clean the Phantom, carefully wipe with a damp cloth, then dry with a dry cloth. Do not use water to clean the Phantom, as the electrical and electronic systems may get wet, resulting in personal injury or malfunction of the Phantom.

BATTERY

- Keep the Phantom away from fire and excessive heat.
- Never subject the Phantom to intense physical shock, severe vibration, or impact.
- Protect from water or moisture.
- Never disassemble the Phantom or its battery.
- If there are any issues with the battery, please contact Jetson Customer Support.

STORAGE

- Fully charge the battery before storing. The battery should be fully charged once a month after this.
- To protect against dust, cover the Phantom.
- Store the Phantom indoors, in a dry place and at a suitable temperature.
- You should bring the Phantom into a warm environment for charging.

Jetson