

JETSON

Gem

Learn & Grow Kick Scooter

A guide for your ride.

IMPORTANT: READ CAREFULLY AND RETAIN FOR FUTURE REFERENCE.

MODELS: JGEM-PNK, JGEM-BLU



**Jetson's top two riding rules:
Be safe. Have fun!**

Contents

| | |
|---|----|
| Safety Warnings | 6 |
| Warranty Coverage | 7 |
| Product Overview | 8 |
| Specs & Features | 10 |
| Online Resources | 11 |
| 1. Getting Started | |
| Starting Notes | 13 |
| Assembly | 14 |
| Adjusting Handlebar Height | 15 |
| 2. Making Moves | |
| Getting Going & Keeping Momentum | 17 |
| Using the Brake | 18 |
| Making Turns | 19 |
| Activating the LED Lights | 19 |
| Removing the Stem for Storage & Transport | 20 |
| Helmet Safety | 21 |
| Care & Maintenance | 22 |

Safety Warnings

- Before use, please read the user manual and safety warnings carefully, and make sure you understand and accept all the safety instructions. The user will be responsible for any loss or damage caused by improper use.
- Before each cycle of operation, the operator shall perform the preoperation checks specified by the manufacturer: That all guards and pads originally supplied by the manufacturer are in proper place and in serviceable condition; That the braking system is functioning properly; That any and all axle guards, chain guards, or other covers or guards supplied by the manufacturer are in place and in serviceable condition; That tires are in good condition, inflated properly, and have sufficient tread remaining; The area that the product is to be operated should be safe and suitable for safe operation.
- Components shall be maintained and repaired in accordance with the manufacturer's specifications and using only the manufacturer's authorized replacement parts with installation performed by dealers or other skilled persons.
- Warning against recharging non-rechargeable batteries.
- Don't allow hands, feet, hair, body parts, clothing, or similar articles to come in contact with moving parts, wheels, or drive train, while the motor is running.
- This product should not be used by children or persons with reduced physical, sensory or mental capabilities, or lack of experience and knowledge, unless they have been given supervision or instruction (IEC 60335-1/A2:2006).
- Unsupervised children should not play with the product (IEC 60335-1/A2:2006).
- Adult supervision is required.
- The rider should not exceed 66 lb.
- Units shall not be operated to perform racing, stunt riding, or other maneuvers, which may cause loss of control, or may cause uncontrolled operator/passenger actions or reactions.
- Never use near motor vehicles.
- Avoid sharp bumps, drainage grates, and sudden surface changes. Scooter may suddenly stop.
- Avoid streets and surfaces with water, sand, gravel, dirt, leaves, and other debris. Wet weather impairs traction, braking, and visibility.
- Avoid riding around flammable gas, steam, liquid, or dust that could cause fire.
- Operators shall adhere to all of the manufacturer's recommendations and instructions, as well as comply with all laws and ordinances: Units without headlights shall be operated only with adequate daylight conditions of visibility, and; Owners shall be encouraged to highlight (for conspicuity) using lighting, reflectors, and for low-riding units, signal flags on flexible poles.
- Persons with the following conditions shall be cautioned not to operate: Those with heart conditions; Pregnant women; Persons with head, back, or neck ailments, or prior surgeries to those areas of the body; and persons with any mental or physical conditions that may make them susceptible to injury or impair their physical dexterity or mental capabilities to recognize, understand, and perform all of the safety instructions and to be able to assume the hazards inherent in unit use.
- Do not ride at night.
- Do not ride after drinking or taking prescription medication.
- Do not carry items when riding.
- Never operate the product barefooted.
- Always wear shoes and keep shoelaces tied.
- Make sure your feet are always placed securely on the deck.
- Operators always shall use appropriate protective clothing, including but not limited to a helmet, with appropriate certification, and any other equipment recommended by the manufacturer: Always wear protective equipment such as helmet, knee pads, and elbow pads.
- Always give way to pedestrians.
- Be alert to things in front and far away from you.
- Do not allow distractions when riding, such as answering the phone or engaging in any other activities.
- The product cannot be ridden by more than one person.
- When you ride the product along with other riders, always keep a safe distance to avoid a collision.
- When turning, be sure to maintain your balance.
- Riding with improperly adjusted brakes is dangerous and can result in serious injury or death.
- The brake may become hot while operating, do not touch the brake with your bare skin.

- Applying brakes too hard or too suddenly can lock up a wheel, which could cause you to lose control and fall. Sudden or excessive application of the brake may result in injury or death.
- If the brake loosens, please adjust with the hexagon wrench, or please contact the Jetson Care Team.
- Replace worn or broken parts immediately.
- Check whether all safety labels are in place and understood before riding.
- The owner shall allow the use and operation of the unit after a demonstration that such operators can understand and operate all components of the unit before use.
- Do not ride without proper training. Do not ride at high speeds, on uneven terrain, or on slopes. Do not perform stunts or turn abruptly.
- Recommended for indoor use.
- Prolonged exposure to UV rays, rain and the elements may damage the enclosure materials, store indoors when not in use.

MODIFICATIONS

Do not attempt to disassemble, modify, repair, or replace the unit or any components of the unit without instruction from the Jetson Care Team. This will void any warranty, and can lead to malfunctions which may cause injury.

ADDITIONAL OPERATION PRECAUTIONS

Do not lift the product off the ground while it is on and the wheels are in motion. This can result in freely spinning wheels, which may cause injury to yourself or others nearby. Do not jump on or off the product, and do not jump while using it. Always keep your feet firmly planted on the foot rest while in operation.

California Proposition 65



This product can expose you to chemicals including Chromium (hexavalent compounds), which is known to the State of California to cause cancer and birth defects or other reproductive harm. For more information go to: www.P65warnings.ca.gov.

Warranty Coverage

GENERAL LIMITED WARRANTY

Your new Jetson product is warranted against defects in materials and workmanship as indicated on ridejetson.com/warranty for a period of time from the date of original retail purchase when used in accordance with Jetson's user manuals (refer to ridejetson.com/support). **Under this warranty, you will be able to direct your claims to Jetson even in situations where you purchased the Jetson Product from one of our authorized retailers.** To read the full terms of our warranty, visit ridejetson.com/warranty.

Product Overview

1. **HANDLEBAR**
2. **STEM CLAMP**
3. **STEM** (HEIGHT-ADJUSTABLE)
4. **STEM MOUNT**
5. **STEM RELEASE BUTTON**
6. **FRONT WHEEL** (X2; MOTION-ACTIVATED LED LIGHT-UP)
7. **DECK**
8. **REAR FOOT BRAKE**
9. **REAR WHEEL**

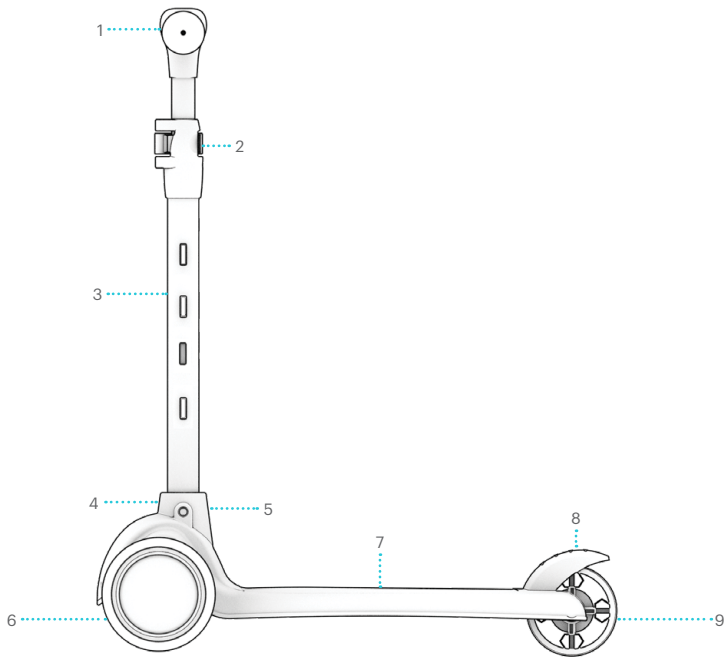

NOTE: IMAGES MAY NOT REFLECT EXACT APPEARANCE OF ACTUAL PRODUCT.

Specs & Features

- WHEEL SIZES: 4.7" (FRONT), 3.5" (REAR)
- PRODUCT DIMENSIONS: 20.9" (L) × 10.3" (W) × 24.4" (H)
- DECK SIZE: 20.9" (L) × 5.1" (W)
- HANDLEBAR HEIGHT: 24.4" - 31.1"
- WEIGHT LIMIT: 66 LBS
- PRODUCT WEIGHT: 4.5 LBS
- RECOMMENDED AGE: 3+
- REAR FOOT BRAKE
- LED LIGHT-UP WHEELS
- REMOVABLE STEM
- ADJUSTABLE-HEIGHT HANDLEBAR

Online Resources



**Scan for our most updated
Gem onboarding materials
and support resources.**

1. Getting Started

1.1 Starting Notes

- REMOVE ALL PROTECTIVE PACKAGING PIECES PRIOR TO BEGINNING ASSEMBLY.
- THE DIRECTIONS GIVEN IN THIS MANUAL—RIGHT, LEFT, FRONT/FORWARD, AND REAR/BACK—ARE ORIENTED AS THE RIDER WOULD SEE THEM WHEN STANDING ON THE SCOOTER. THE "RIGHT SIDE" OF THE SCOOTER, FOR EXAMPLE, IS THE SIDE WHERE THE RIDER'S RIGHT HAND WILL BE.

WARNING:

FAILURE TO COMPLY WITH THE FOLLOWING INSTRUCTIONS MAY RESULT IN INJURY TO THE CHILD OR OTHERS.

- KEEP SMALL PARTS AWAY FROM CHILDREN DURING ASSEMBLY.
- ACCESSORY MUST BE ASSEMBLED AND REMOVED BY AN ADULT.
- FREQUENTLY INSPECT THE PRODUCT FOR DAMAGE.

* ADULTS MUST ASSIST CHILDREN IN THE ASSEMBLY AND INITIAL ADJUSTMENT PROCEDURES OF THE PRODUCT.

1.2 Assembly

TO INSERT THE STEM, PLACE THE STEM OVER THE STEM MOUNT SUCH THAT THE STEM CLAMP LATCH IS FACING THE BACK OF THE SCOOTER. PUSH IN THE STEM RELEASE PINS AND SLIDE THE STEM DOWN INTO THE STEM MOUNT UNTIL THE PINS CLICK INTO THE HOLES IN THE STEM MOUNT.

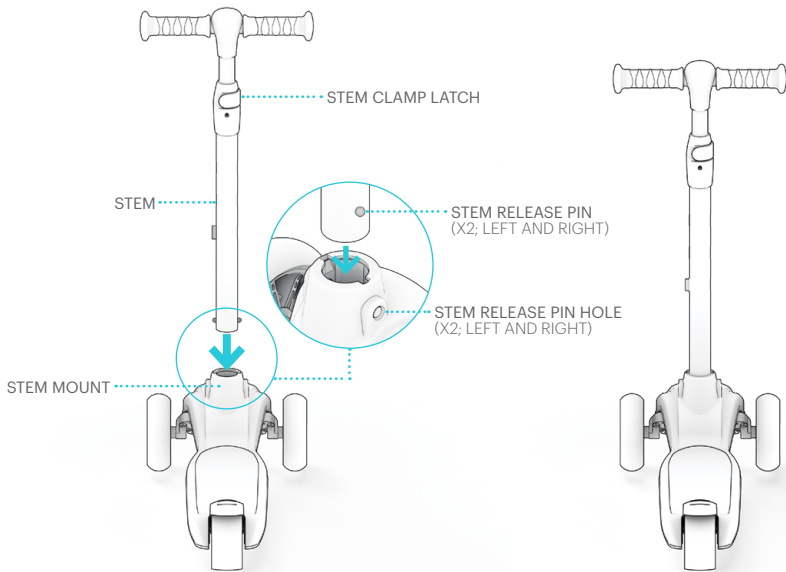

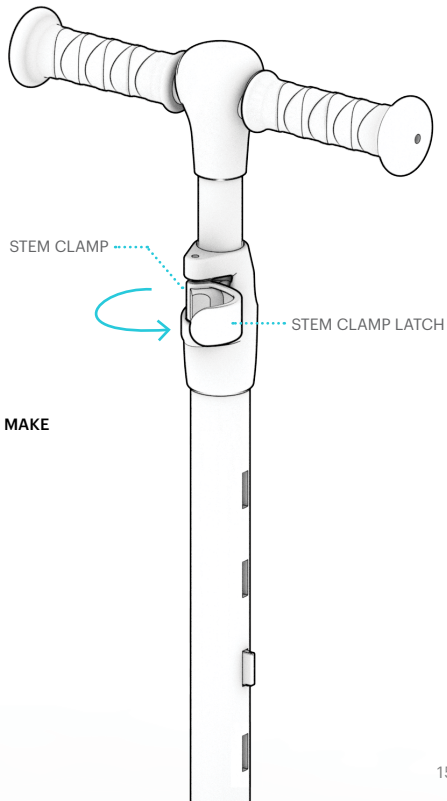

1.3 Adjusting Handlebar Height

RAISE THE HANDLEBAR AS YOUR LITTLE RIDER GROWS! LOWER IT TO MAKE IT MORE COMPACT FOR TRANSPORT AND STORAGE.

1. PULL OPEN THE STEM CLAMP LATCH.

2. PRESS IN THE STEM PIN AND RAISE OR LOWER THE HANDLEBAR UNTIL THE PIN CLICKS INTO ANOTHER STEM PIN HOLE.
3. CLOSE THE STEM CLAMP LATCH AND TO SECURE THE HANDLEBAR IN PLACE.

IMPORTANT: THE STEM PIN ALONE WILL NOT KEEP THE STEM SECURE. ALWAYS MAKE SURE THE STEM CLAMP LATCH IS CLOSED PRIOR TO RIDING.

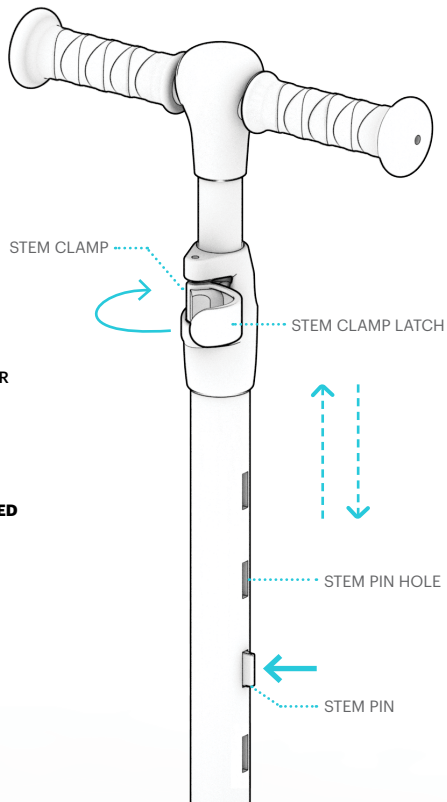

2. Making Moves

2.1 Getting Going & Keeping Momentum

1. PLACE ONE FOOT ON THE FRONT OF THE DECK FACING FORWARD.
2. PUSH THE OTHER FOOT OFF THE GROUND TO PROPEL THE SCOOTER FORWARD. REPEAT AS NECESSARY TO ACHIEVE OR MAINTAIN DESIRED SPEED.
3. TO COAST, PLACE KICKING FOOT ON THE REAR OF THE DECK, TURNED OUTWARD AT A SLIGHT ANGLE FOR STABILITY.

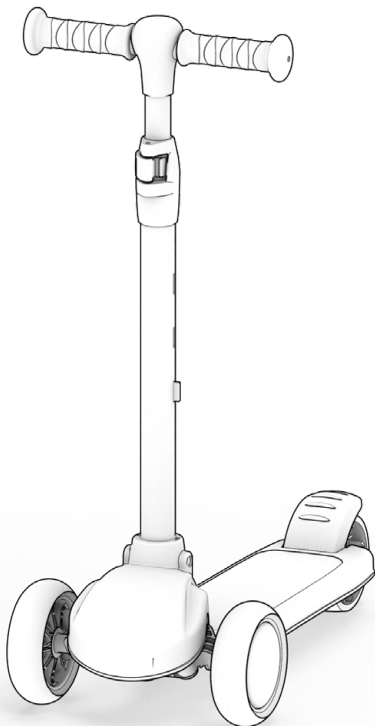

2.2 Using the Brake

PRESS DOWN GENTLY WITH YOUR REAR RIDING FOOT TO SLOW DOWN. APPLY MORE PRESSURE TO COME TO A COMPLETE STOP.

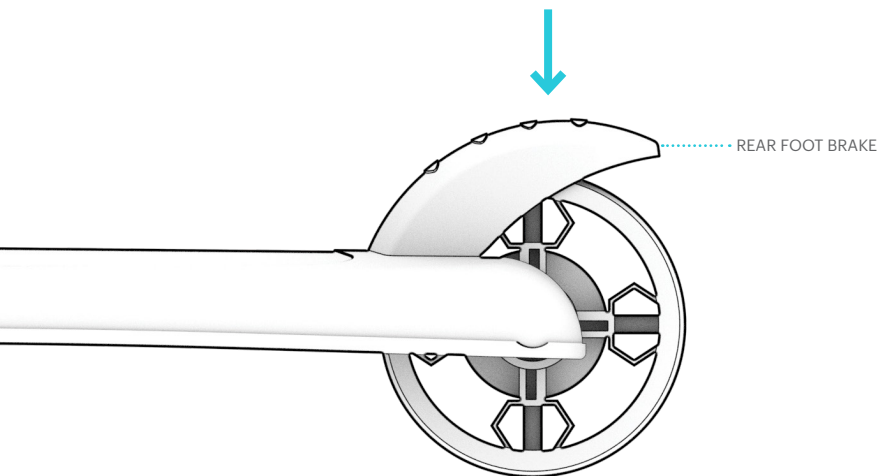

2.3 Making Turns

THIS SCOOTER IS A LEAN-TO-STEER SCOOTER. ITS TRIANGULAR BASE PROVIDES A STABLE FOUNDATION, WHICH HELPS NEW RIDERS KEEP THEIR BALANCE WHILE THEY LEARN HOW TO MOVE.

TO TURN, SLIGHTLY LEAN LEFT OR RIGHT WHILE RIDING AND THE SCOOTER WILL VEER ACCORDINGLY.

2.4 Activating the LED Lights

THE LED LIGHTS ON THE FRONT WHEELS WILL ILLUMINATE WHENEVER THE WHEELS ARE IN MOTION.

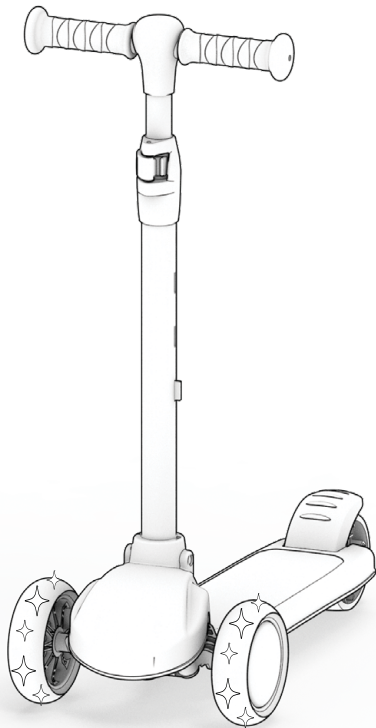

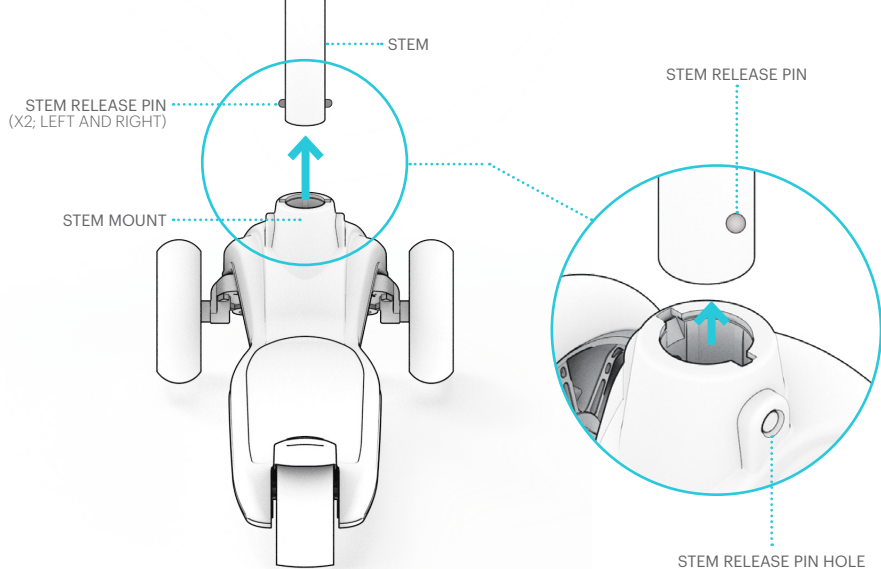

2.5 Removing the Stem for Storage & Transport

TO REMOVE STEM, PRESS THE LEFT AND RIGHT STEM RELEASE PINS IN AND PULL THE STEM UP AND OUT OF THE STEM MOUNT.

TO RE-INSERT THE STEM, PLACE THE STEM OVER THE STEM MOUNT SUCH THAT THE STEM CLAMP LATCH IS FACING THE BACK OF THE SCOOTER. PUSH IN THE STEM RELEASE PINS AND SLIDE THE STEM DOWN INTO THE STEM MOUNT UNTIL THE PINS CLICK INTO THE HOLES IN THE STEM MOUNT.

2.6 **Helmet Safety**

A HELMET SHOULD BE WORN BY THE RIDER AT ALL TIMES.



**PROPER POSITIONING:
THE FOREHEAD IS COVERED
BY THE HELMET.**



**IMPROPER POSITIONING:
THE FOREHEAD IS EXPOSED.
A FALL COULD RESULT IN SERIOUS INJURY.**

* WEAR A HELMET, APPROPRIATE CLOTHING, SHOES, AND SAFETY GEAR. AVOID CLOTHING THAT CAN GET CAUGHT INTO OR UNDER THE WHEELS. CLOSED-TOE, FLAT SHOES ARE RECOMMENDED. WEAR AN ASTM F1492 APPROVED HELMET AND PROTECTIVE GEAR TO PREVENT INJURY IN THE EVENT OF AN ACCIDENT.

Care & Maintenance

CLEANING YOUR SCOOTER

- TO CLEAN YOUR SCOOTER, CAREFULLY WIPE WITH IT A DAMP CLOTH AND THEN WITH A DRY CLOTH.
- DO NOT APPLY WATER DIRECTLY TO THE SCOOTER. WATER CAN DAMAGE THE FRAME, WHICH CAN RESULT IN A MALFUNCTION THAT PUTS RIDER SAFETY AT RISK.

MAINTAINING YOUR SCOOTER

- KEEP AWAY FROM FIRE AND EXCESSIVE HEAT.
- AVOID INTENSE PHYSICAL IMPACT AND/OR SEVERE VIBRATION.
- RIDE THE SCOOTER ON A SMOOTH, FLAT SURFACE.
- PROTECT FROM WATER OR MOISTURE.
- CONTACT THE JETSON CARE TEAM IF THERE ARE ANY ISSUES WITH YOUR SCOOTER.

STORING YOUR SCOOTER

- STORE YOUR SCOOTER INDOORS AND IN A DRY PLACE.
- COVER YOUR SCOOTER TO PROTECT IT AGAINST DUST.

Stay connected.

Be sure to follow **@ridejetson** on social media to learn about fantastic offers, giveaways, and all the latest Jetson news.



Loving your ride?

Then be sure to leave a review at ridejetson.com/reviews.
We can't wait to hear from you!

JETSON

#MakeMoves

Questions? Let us help.

ridejetson.com/support
ridejetson.com/chat

To exercise your product's warranty
or inquire about warranty
coverage, contact us directly.

US/CANADA: 1-888-976-9904
UK: +44 1355 241222

Manufactured in Hebei, China
Imported by Jetson Electric Bikes LLC.
P.O. Box 320149, 775 4th Ave #2,
Brooklyn, NY 11232

www.ridejetson.com



Made in China
Date Code: 07/2023
Document Edition: v1.0

© 2023, JETSON. ALL RIGHTS RESERVED. Manufactured by JETSON ELECTRIC BIKES LLC.
No portion of this document, including shape, copy, graphics, and design,
may be reproduced or transmitted in any form or by any means.