



*\*Skewers shown are 3/4" wide*

## Product Description

The KabobMaster Skewer Series are professional grade skewers for residential and commercial use. These skewers are made with food grade stainless steel and are available in various lengths and widths<sup>1</sup>. Each skewer is cut with a guillotine cutter to form a very sharp skewer tip that could easily penetrate all types of ground and solid meats. The skewers are available in two handle types: flat and twisted.<sup>2</sup> Flat handle skewers are recommended for restaurant environments due to ease of storage and cleaning versus their twisted counterparts.

The skewers have passed NSF International's NSF/ANSI Standard 4 commercial food equipment standards.

**Material:** Stainless Steel 304

<sup>1</sup> Skewers available in custom lengths and widths. Speak to your sales representative

<sup>2</sup> Twisted handle is not available for skewers wider than 1/2 in. [12.7 mm]

## Accessories

The KabobMaster Stone Series skewers can be paired with a KabobMaster Rotisserie to automate the skewer turning process while cooking. The skewer adapters are compatible with our 1/2 in. [12.7 mm] wide skewers and are available in residential and commercial (NSF certified) variants. The commercial variants feature a custom set screw with a slotted drive and a portion of the threads removed to comply with the NSF/ANSI Standard 4.



*\*Commercial (NSF certified) skewer adapter shown*



## Dimensions

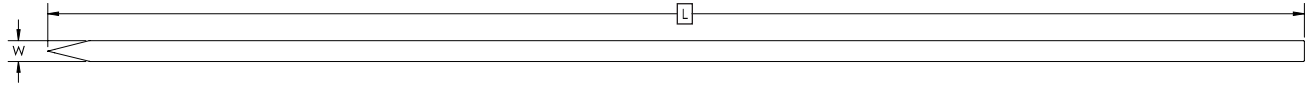

Flat Handle Style

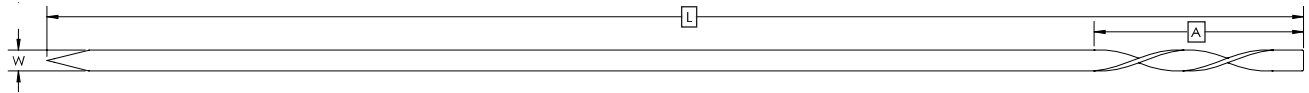

Twisted Handle Style

Model	L	W	A Handle	Handle Style	Thickness
SK-0.25-24-T	24 in. 61 cm	1/4 in. 6.4 mm	5 in. 127 mm	Twisted	16 Gauge
SK-0.5-24-F	24 in. 61 cm	1/2 in. 12.7 mm	-	Flat	11 Gauge
SK-0.5-24-T	24 in. 61 cm	1/2 in. 12.7 mm	5 in. 127 mm	Twisted	11 Gauge
SK-0.5-30-F	30 in. 76 cm	1/2 in. 12.7 mm	-	Flat	11 Gauge
SK-0.5-30-T	30 in. 76 cm	1/2 in. 12.7 mm	5 in. 127 mm	Twisted	11 Gauge
SK-0.5-36-F	36 in. 91.5 cm	1/2 in. 12.7 mm	-	Flat	11 Gauge
SK-0.5-36-T	36 in. 91.5 cm	1/2 in. 12.7 mm	5 in. 127 mm	Twisted	11 Gauge
SK-0.75-30-F	30 in. 76 cm	3/4 in. 19 mm	-	Flat	13 Gauge
SK-0.88-24-F	24 in. 61 cm	7/8 in. 22.5 mm	-	Flat	16 Gauge
SK-1.0-30-F	30 in. 76 cm	1 in. 25.4 mm	-	Flat	13 Gauge

KabobMaster Standard Skewer Sizes

## Custom Orders

Custom skewer sizes can be special ordered with a 3 week lead-time. Minimum quantities apply. Speak to your sales representative for more information about custom orders.

