



INSTRUCTIONS MANUAL

TYL-B63B

SELF-CLEANING WET&DRY Vacuum Cleaner

Powerful, versatile cleaning at your fingertips



www.tylrhome.com

TABLE OF CONTENTS

IMPORTANT SAFEGUARDS	4
PARTS AND FEATURES	8
Accessories	9
Display Panel	10
ASSEMBLING YOUR VACUUM CLEANER	11
Assembling the Handle.....	11
Assembling the Clean Water Tank (CWT).....	12
Assembling the Dirty Water Tank (DWT).....	13
Installing the Brush Roll and Cover	14
OPERATING YOUR VACUUM CLEANER	16
Turning On	16
Switching Modes	17
Using the Turbo Function	17
Turning Off	17
Turning On/Off the Voice Prompt	17
USING THE CHARGING STATION	18
Charging the Vacuum Cleaner.....	18
Using the Self-Cleaning Function	19
Using the Air-Drying Function.....	19
CLEANING AND MAINTENANCE	20
Cleaning the Dirty Water Tank.....	20
Cleaning the Filter Assembly	21
Cleaning the Brush Roll and Cover.....	21
Cleaning the Main Vacuum Unit	22
Cleaning the Charging Station.....	23

Recommended Cleaning and Replacement Chart	23
FAULT AND ERROR CODE TABLE.....	23
WARRANTY TERMS AND CONDITIONS.....	26

IMPORTANT SAFEGUARDS

When using this appliance, basic safety precautions should always be followed to reduce the risk of fire, electric shock, or injury, including the following:

1. Do not disassemble or attempt to repair this unit as this may lead do damage to the unit, injury to humans, or a fire hazard.
2. Unplug from electrical socket when not in use, before cleaning, maintaining, or servicing the unit.
3. For indoor use only. Not intended for use for industrial environments, commercial, or outdoors.
4. Do not use in an environment with a temperature lower than -10°C or higher than $+45^{\circ}\text{C}$.
5. Do not add alcohol to the water tank.
6. This appliance is intended for use on hard floors in the home environment, such as marble, ceramic tiles, wood tiles, solid wood, and laminate floors.
7. Do not immerse. Use only on hard floor surfaces moistened by cleaning process.
8. Do not handle the power adapter, including the power adapter plug, and adapter terminals with wet hands.
9. Use only the power adapter specifically supplied for this appliance, use of any other power adapter may lead to damage to the unit or a fire hazard.
- 10.If the power adapter is damaged, please stop using the

appliance immediately and contact our service center immediately.

11. Always make sure that the plug is inserted into the wall socket properly.
12. Do not allow to be used as a toy. Close attention is necessary when used by or near children, pets, or plants.
13. Do not use with a damaged cord or plug. If appliance has been dropped, damaged, left outdoors, dropped into water, or is not working as it should, return it to the authorized service center immediately.
14. This appliance is NOT INTENDED FOR USE by persons with reduced physical, sensory, or mental capabilities, or lack of experience and knowledge, unless they are UNDER THE SUPERVISION of a responsible person or have been given proper instruction in using the appliance. This appliance is NOT INTENDED FOR USE by children.
15. Do not use if the clean water tank and dirty water tank are not in place.
16. When moving the appliance, please keep the appliance upright to avoid water leaking into the motor.
17. If using a cleaning solution, follow the instructions on the label of the cleaning solution.
18. Cleaning solutions should be kept out of reach of children.
19. Do not put any object into openings. Do not use with any opening blocked; Keep free of dust, lint, hair, and anything that may reduce air flow.

20. Keep hair, clothing, fingers, and all parts of your body away from openings and moving parts while operating the appliance.
21. Do not use to pick up anything that is burning or smoking, such as matches, cigarettes, or hot ashes.
22. Take care not to activate the appliance unintentionally. Make sure that the switch is in the OFF position before picking up or carrying the appliance.
23. Always switch off the appliance before making any adjustments, changing accessories, or storing the appliance in order to avoid accidental activation of the appliance.
24. Do not use without the HEPA filter.
25. Do not use to pick up ultrafine particles, such as lime, cement, sawdust, gypsum powder, or ashes.
26. Do not use to pick up sharp objects, such as metallic nails, pieces of glass, metal paper clips, or pins.
27. Do not use to pick up hazardous material or chemicals, such as solvent, drain cleaner, strong acids, or strong alkali.
28. Do not use this appliance to clean flammable liquids such as gasoline, kerosene, paint, perfume, etc., as these liquids may cause the appliance to short circuit or explode.
29. Do not use the appliance to clean up color powder or toner used in laser printers and copiers.
30. Do not use to clean up strong staining liquids such as paints, lacquer, shoe polish, etc.

31. Do not shake the appliance or allow it to collide vigorously with surfaces in order to avoid water flowing into the motor.
32. Store properly indoors in a dry place after use.
33. Stop using immediately if the appliance is overheating, making unusual noises, producing unusual odors, performing low suction, or leaks electricity.
34. Always clean the dirty water tank after each use to avoid blockage, which may lead to low suction power, motor overheating, or reduce the service life of the appliance.
35. Do not block the air inlet or outlet to avoid overheating of the motor.
36. DO NOT USE this appliance for any purpose other than described in this manual.

SAVE THESE INSTRUCTIONS. FOR HOUSEHOLD USE ONLY. NOT FOR COMMERCIAL USE.

PARTS AND FEATURES

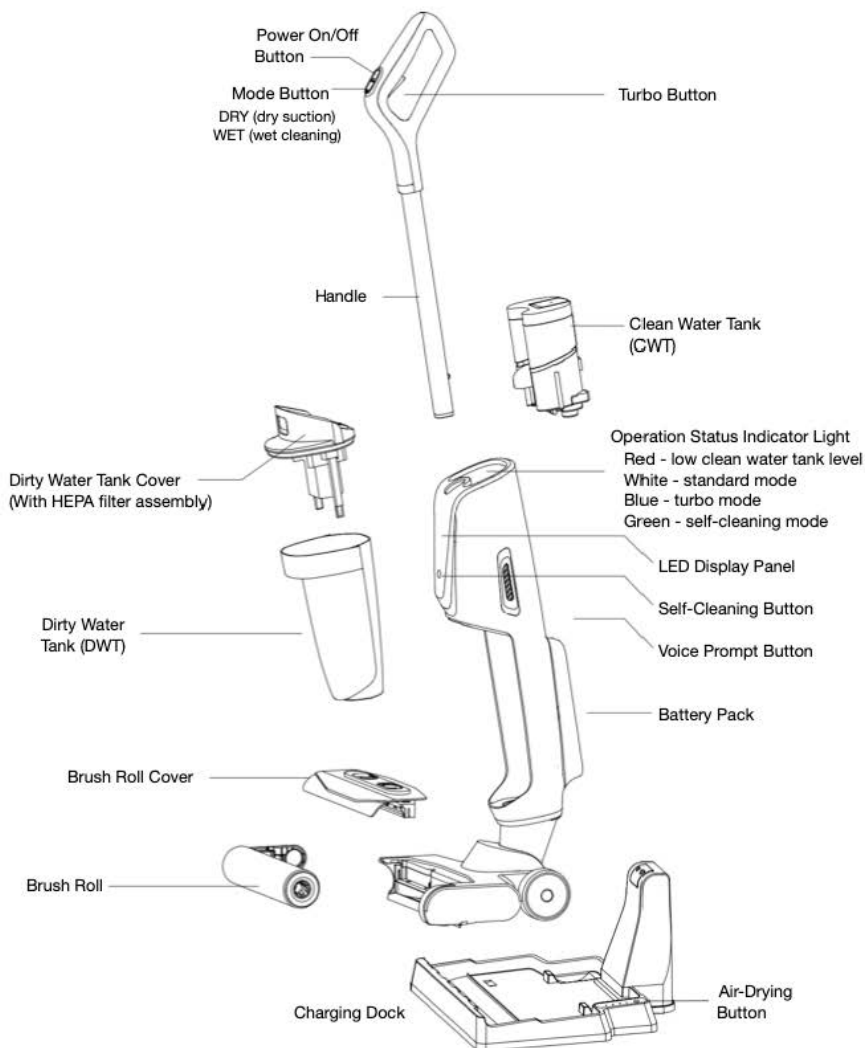

Accessories



Cleaning Tool

For cleaning the tube inside the Dirty Water Tank



Cleaning Brush

For cleaning the filter assembly

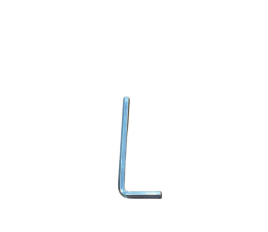

Allen Key

For removing the handle from the main vacuum unit



Charging Adaptor

For charging the vacuum

Display Panel

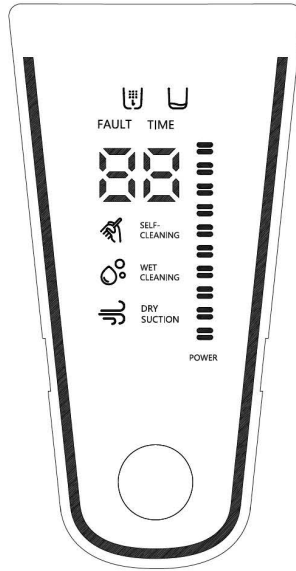

 – blinks when Dirty Water Tank is full and needs to be discarded

 – blinks when Clean Water Tank is empty

FAULT – lights up when there is a fault or error

TIME – displays elapsed vacuuming time in minutes

LED DISPLAY – displays time and error codes

SELF-CLEANING – icon blinks when the unit is in self-cleaning cycle

WET CLEANING – lights up when in wet mopping mode

DRY SUCTION – lights up when in dry vacuuming mode

POWER – displays battery level

ASSEMBLING YOUR VACUUM CLEANER

Assembling the Handle

1. Insert the handle into to the slot on the main vacuum unit until a “click” sound is heard.

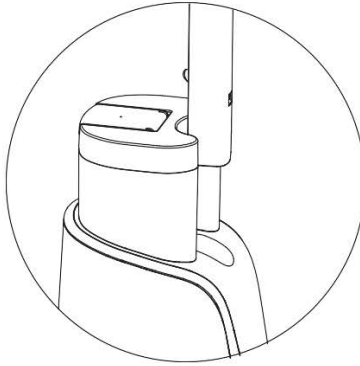

2. To remove the handle, insert the allen key or a similar tool into the small hole (shown below), and push the key to release the handle. Lift the handle away from the main vacuum unit.

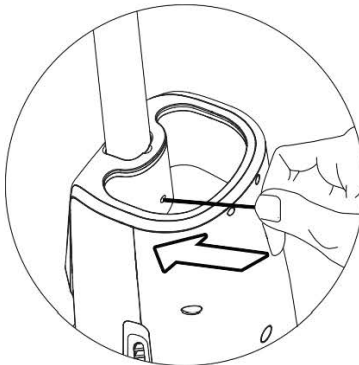

Assembling the Clean Water Tank (CWT)

1. Lift the cover of the Clean Water Tank.

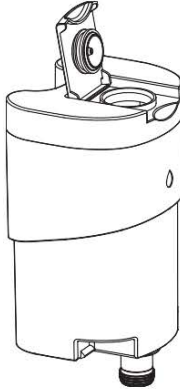

2. Fill the tank with clean water, then close the cover.

NOTE: You may also add 10ml of mild home floor cleaning solution to each full tank of clean water.

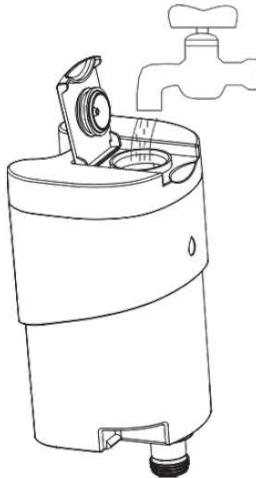

3. Place the tank back into the main vacuum unit. Press firmly until you hear a “click.”

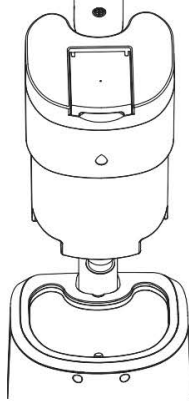

Assembling the Dirty Water Tank (DWT)

1. Insert the Dirty Water Tank into the main vacuum unit, as shown below.

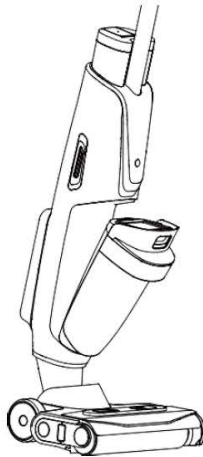

2. Grab the Dirty Water Tank by the cover handle and push firmly until it clicks into place.

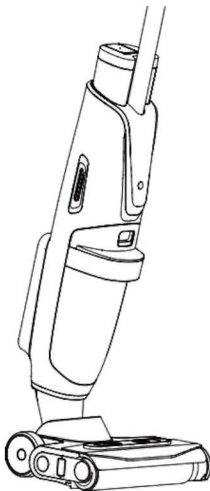

Installing the Brush Roll and Cover

1. Align the brush roll with the drive shaft on the brush roll chamber, then push the brush roll until it clicks into place.

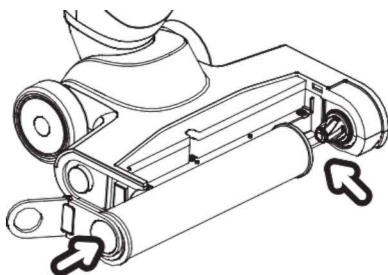

2. Press the brush roll tab inwards into the tab compartment until it clicks into place.

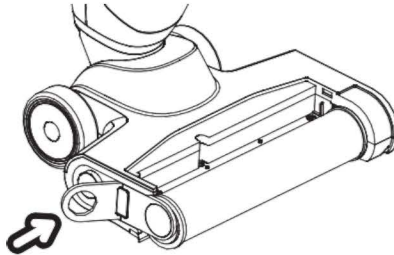

3. Squeeze the latches on the brush roll cover, then place the cover over the brush roll. Release the latches when the cover is securely in place.

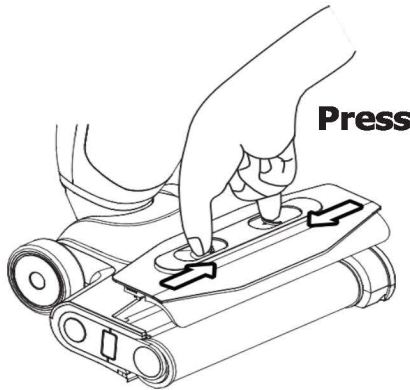

OPERATING YOUR VACUUM CLEANER

Before first use, charge the vacuum for 5 hours (please refer to section “Using the Charging Station” for details).

Turning On

Once the vacuum has been properly assembled and the battery has been charged, pull back the handle and press the Power On/Off button to turn the vacuum on. The vacuum will start in WET (wet cleaning) mode by default.

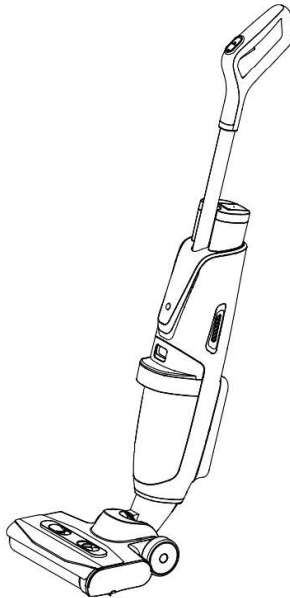

Switching Modes

Press the Mode button to switch between DRY (dry suctioning) and WET (wet cleaning) modes.

In DRY mode, the vacuum will only run and suction without spraying water. In WET mode, the vacuum will periodically spray water while suctioning for wet mopping.

Using the Turbo Function

Press and hold the Turbo button for maximum power while vacuuming or mopping. Release the Turbo button to return to normal power.

Turning Off

Press the On/Off button again to turn the vacuum off. The vacuum will continue to run for a few seconds before turning off. Place the vacuum on the charging station after use for recharging and storage.

Turning On/Off the Voice Prompt

Press the voice prompt button at the back of the vacuum unit to active or deactivate the voice prompt feature.

USING THE CHARGING STATION

Charging the Vacuum Cleaner

Connect the charging cord to the charging station and plug the power adapter into an outlet. Place the vacuum on the charging station. Make sure that the charging contacts on the charging station and the vacuum align.

The battery level indicator on the LED display shows the battery charging status.

NOTE: *The air-drying function automatically starts with a default drying time of 2 hours (2H) once the vacuum starts charging.*

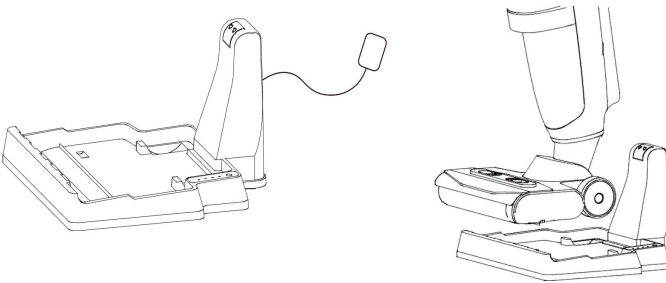

Using the Self-Cleaning Function

When the appliance is charging on the charging station, press the Self-Cleaning button to activate the self-cleaning function. Please make sure that the Clean Water Tank is full.

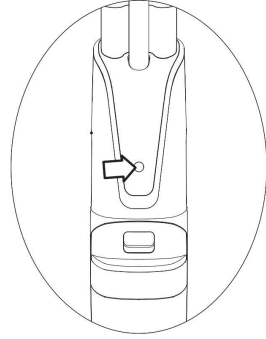

Using the Air-Drying Function

After self-cleaning cycle has completed, the vacuum enters the air-drying cycle. During the air-drying process, the charging station fan is on and the roller brush periodically rotates.

NOTE: *If the air-drying function is turned off, press the Air-Drying button to turn it on. Pressing the Air-Drying button repeatedly cycles through **OFF / 0.5H / 1.5H / 2H**.*

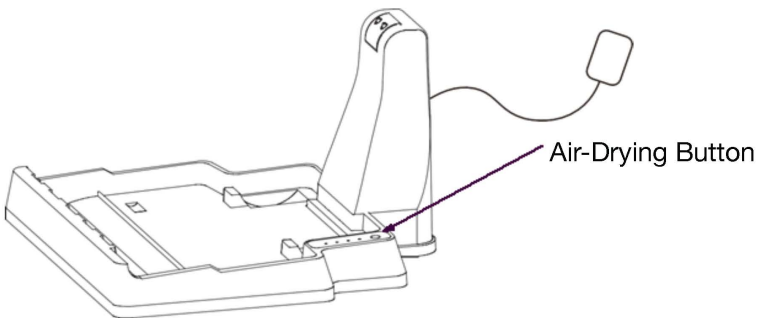

CLEANING AND MAINTENANCE

NOTE: *Switch off and unplug the vacuum before performing any maintenance or cleaning.*

Cleaning the Dirty Water Tank

Hold the dirty water tank by the handle and press the lock with your thumb while pulling the tank away from the vacuum. Remove the dirty water tank cover. Discard the dirty water and rinse the tank with fresh, clean water.

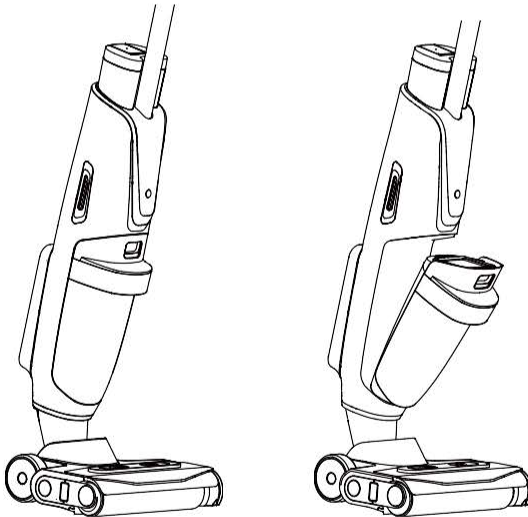

Cleaning the Filter Assembly

Remove the filter assembly from the Dirty Water Tank cover as shown below. Wash carefully and clean the filter screen and HEPA filter using the cleaning brush provided. Place the filter assembly back into the compartment on the DWT cover.

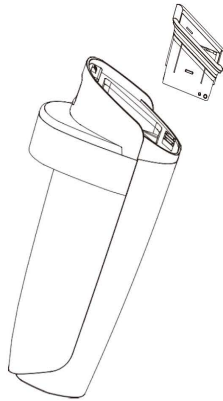

Cleaning the Brush Roll and Cover

Squeeze the latches on the brush roll cover and lift to remove. Rinse the brush roll cover with water.

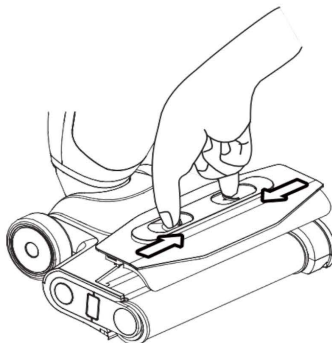

1. Press the tab release button and the brush roll tab pops out.

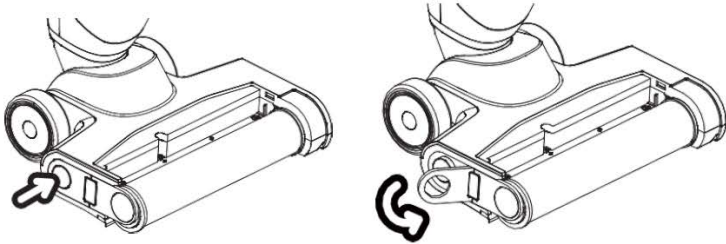

2. Gently but firmly pull the brush roll out of the chamber.

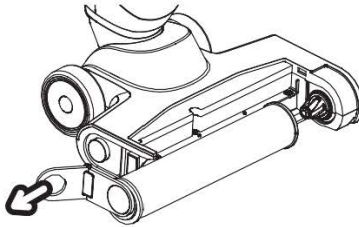

3. Remove debris and hair wrapped around the brush roll.
4. Remove hair and debris from the brush roll chamber using paper towel or damp cloth.
5. Reinstall the brush roll and the cover.

Cleaning the Main Vacuum Unit

Use a soft, dry cloth to clean the surface of the vacuum.

Cleaning the Charging Station

Disconnect the charging cord from the charging station. Use a soft, dry cloth or paper towel to clean the charging station. Do not rinse directly with water.

Recommended Cleaning and Replacement Chart

Dirty Water Tank	Clean after every use.
Brush Roll	Do Self-cleaning after every use.
Filter Assembly	Clean 2-3x a week, depending on use.
Brush Roll Cover	Clean 2x a month, depending on use.
Brush Roll Chamber	Clean 2x a month, depending on use.

FAULT AND ERROR CODE TABLE

Code	Cause	Solution
E1	Loose connection of battery pack.	Contact customer service.
E2	Battery senses high voltage during operation.	Contact customer service.

E3	Battery senses low temperature during operation	Contact customer service.
E4	Battery thermostat is defective.	Contact customer service.
E5	Battery senses high temperature during operation.	Clean the brush roll and filter. Wait for the battery to cool down.
E6	Battery senses high temperature during charging.	Wait for the battery to cool down.
E7	Battery senses too low temperature during charging.	Make sure the ambient temperature is above 5°C.
F1	Battery detects high current during charging.	Make sure the to use the charging adaptor supplied with the unit.
F2	Short-circuit protection is triggered.	Contact customer service.
F3	Battery detects high current during operation.	Clean the brush roll and filter. Wait for the battery to cool down.

F4	Brush roll sensor detects high current during operation.	Clean the brush roll. If the problem persists, contact customer service.
F6	No dirty water tank (DWT) installed.	Make sure DWT is installed in place.

WARRANTY TERMS AND CONDITIONS

ONE-YEAR LIMITED WARRANTY ON PARTS AND LABOR

TYLR provides a warranty to the original purchaser of this product against defects in materials and workmanship for one year. If a product covered by this warranty is determined to be defective within the warranty period, **TYLR** will repair or replace the defective part with a new or remanufactured part free of charge subject to terms and conditions stated herein.

To obtain warranty service, proof of purchase in the form of a sales invoice or copy thereof is required to show that a product is within the warranty period. If any one of the documents cannot be produced, corresponding fees for labor and replacement parts will be charged.

Parts and Labor

There will be no charge for parts and labor during the warranty period. Replacement parts or units may be new or recertified and are upon **TYLR**'s option and sole discretion. Replacement parts and units are warranted for the remaining portion of the original warranty. Our decision on all questions relating to complaints as a result of defects, either workmanship or materials, shall be conclusive and you shall agree to abide by such decision. Any unit or defective part that have been replaced shall become **TYLR**'s property. After the lapse of this warranty, a charge will be made on all labor and replacement of parts.

Types of Services

Defective Products must be sent to any **TYLR** service center to obtain warranty service. **TYLR** is neither responsible for transportation costs to the service center nor **TYLR** will cover return shipping to the customer. Product returns to **TYLR** service centers must utilize either the original carton box and shipping material or packaging that affords an equal degree of protection.

For home service, the transportation fee of **TYLR** service personnel will be charged to the customer, depending on the location. Our service personnel reserve all rights to refuse to attend to any equipment installed in an inaccessible location or any other hazardous situation.

LIMITATIONS AND EXCLUSIONS

TYLR one-year limited warranty only covers defects in materials and workmanship; however, this warranty does not cover the following:

1. Damage resulting from accidents, transport, misuse, abuse, alteration, tampering, or failure of the purchaser to follow normal operating procedures outlined in the user's manual.
2. Damage caused by negligence and poor maintenance.
3. Defects or damage due to spillage of food/liquids or improper usage of electrical supply or electrical circuit, major fluctuations in voltage, exposure to rain or moisture, wrong fuel or oil used.
4. Damage, losses, and defects as a result of fire, flood, or other Acts of God.

5. Normal wear-and-tear, corrosion, rusting, or stains.
6. Defects & damage arising from improper testing, operation, usage of the wrong component, demonstration, maintenance, installation, adjustment, or any alteration or modification of any kind.
7. Scratches & damage to the outer surface areas and externally exposed parts that are due to normal customer use.
8. General maintenance & routine servicing.
9. Claims for damaged/missing parts after 7 days from the date of purchase.
10. If any part or parts of the unit are replaced with a part or parts not supplied or approved by us, or if the unit has been dismantled or repaired by any person other than a **TYLR** authorized technician.
11. Any equipment/product which has its serial number removed or made illegible/tampered with.
12. If the warranty card is altered, defaced, or erased in any manner whatsoever.
13. If the unit is used for purposes other than household use, such as commercial use.

The six (6) months warranty covers the rechargeable batteries. The one (1) year warranty covers the mainboard, control PCB and motor. However, this warranty does not cover parts (i.e. accessories, power adaptor, floor brush assembly, nozzles, hose, couplings, connectors, dust tank, water tanks, filter, wheels, fuse, gears, power switch, plastic cover, interior and exterior casing) that are subject to wear and tear, rust, stains, or corrosion

This one-year limited warranty does not cover Products sold “**AS IS**”, “**FACTORY RECTIFIED**”, or by a non-authorized reseller.

THERE ARE NO EXPRESS WARRANTIES OTHER THAN THOSE LISTED OR DESCRIBED ABOVE. ANY IMPLIED WARRANTIES, INCLUDING ANY IMPLIED WARRANTY OF MERCHANTABILITY AND FITNESS FOR A PARTICULAR PURPOSE, SHALL BE LIMITED IN DURATION TO THE PERIOD OF TIME SET FORTH ABOVE. **TYLR'S** TOTAL LIABILITY FOR ANY AND ALL LOSSES AND DAMAGES RESULTING FROM ANY CAUSE WHATSOEVER INCLUDING **TYLR'S** NEGLIGENCE, ALLEGED DAMAGE, OR DEFECTIVE GOODS, WHETHER SUCH DEFECTS ARE DISCOVERABLE OR LATENT, SHALL IN NO EVENT EXCEED THE PURCHASE PRICE OF THE PRODUCT. **TYLR** SHALL NOT BE RESPONSIBLE FOR LOSS OF USE, COMMERCIAL LOSS, LOST REVENUE OR LOST PROFITS, OR OTHER INCIDENTAL OR CONSEQUENTIAL DAMAGES. THIS WARRANTY IS SUBJECT TO CHANGE WITHOUT NOTICE.

IMPORTANT: Please present sales invoice as proof of purchase whenever you require our service during the warranty period.

www.tylrhome.com