

**BAUMANN
LIVING**
PROFESSIONAL

COUNTERTOP BLENDER

WITH SOUND ENCLOSURE



BM-BL1880

INSTRUCTIONS MANUAL

www.baumannliving.com

TABLE OF CONTENTS

IMPORTANT SAFEGUARDS	2
PARTS AND FEATURES	6
Control Panel.....	6
BEFORE FIRST USE	7
OPERATING YOUR BLENDER	7
Using the Speed Control Knob	8
Using the Pulse Function	9
Using the Tamper.....	10
Switching Off.....	10
Overheat Protection	10
BLENDING TIPS	11
CLEANING AND MAINTENANCE	12
TROUBLESHOOTING	14
WARRANTY TERMS AND CONDITIONS	16

IMPORTANT SAFEGUARDS

When using electrical appliances, basic safety precautions should always be followed, including the following:

- Read all instructions.
- Incorrect operation and improper use of the appliance can seriously damage the appliance and injure users.
- The appliance may only be used for the purpose for which it was intended and designed.
- The manufacturer is not liable for any damage caused by incorrect operation and improper use.
- Keep the appliance and electrical plug away from water and any other liquids. In the unlikely event that the appliance should fall into water, immediately pull the plug out of the socket and have the appliance checked by a certified technician.
- Never try to open the casing of the appliances yourself.
- Do not insert any objects in the casing of the appliance.
- Do not touch the plug with wet or damp hands.
- Regularly check the plug and cord for any damage. Should the plug or cord be damaged have it/them repaired by a certified repair company.
- Do not use the appliance after it has fallen or is damaged in any other way. Have it checked and repaired, if necessary, by a certified repair company.

- Do not try to repair the appliance yourself. This could give rise to life-threatening situations.
- Make sure the cord does not come in contact with sharp or hot objects and keep it away from open fire. To pull the plug out of the socket, always pull on the plug and not on the cord.
- Make sure that no one can accidentally pull the cord (or extension cord) loose or trip over the cord.
- Always keep an eye on the appliance when in use.
- Children do not understand that incorrect use of electrical appliances can be dangerous. Never let children use home appliances without supervision.
- Always pull the plug out of the socket when the appliance is not being used and always before cleaning.
- As long as the plug is in the socket, the appliance is connected to the power source.
- Turn off the appliance before pulling the plug out of the socket.
- Never carry the appliance by the cord.
- This appliance is solely used for blending food.
- Do not use any extra accessories or devices that are not supplied along with the appliance.
- Only connect the appliance to an earthed 220-240VAC electrical socket.
- Avoid overloading.
- Tamper can only be used when the the jar lid is securely placed onto the blender jar.

- Be careful if hot liquid is poured into the jar as it can be ejected out of the appliance due to a sudden steaming.
- Always remove the plug from the socket when cleaning the appliance.
- The jar of the appliance is only to be used with the main machine provided.
- The wire connection must be done by specialized technician. The manufacturer will not be held liable for any damages resulting from incorrect or improper installation.
- Check that the outlet voltage corresponds to that indicated on the rating label fixed on the appliance.
- Means for disconnection must be incorporated in the fixed wiring in accordance with the wiring rules.
- If the supply cord is damaged, it must be replaced from the manufacturer or its service agent.
- Connect the plug to a socket complying with current regulations, located in an accessible place.
- Children shall not play with the appliance. Cleaning and user maintenance shall not be made by children without supervision.
- Children should be supervised to ensure that they do not play with the appliance.
- The appliance is not to be used by persons (including children) with reduced physical, sensory or mental capabilities, or lack of experience and knowledge, unless they have been given supervision or instruction.

- The symbol on the product or on its packaging indicates that this product may not be treated as household waste. Instead, it shall be handed over to the applicable collection points for the recycling of electrical and electronic equipment.

Special safety instructions

- Be careful when handling the appliance, as the blade is extremely sharp! Do not touch the blade during use. Be careful that neither fingers nor tools touch the blade! Always unplug before cleaning.
- Do not exceed 2 minutes when running the appliance at Max power. Switch off the appliance and wait for at least 2 minutes before you switch on the appliance again.
- Moving parts will become hot with extended use. Don't touch the moving parts. Risk of burns!
- Be careful when blending hot liquids. Only blend hot liquids at the lowest speed and with the lid firmly in place. Risk of burns by escaping steam and splashes!
- Unplug the appliance from the power outlet if not in use.
- Make sure the motor base is switched off before placing the jar onto the motor base.

**SAVE THESE INSTRUCTIONS.
FOR HOUSEHOLD USE ONLY.**

PARTS AND FEATURES

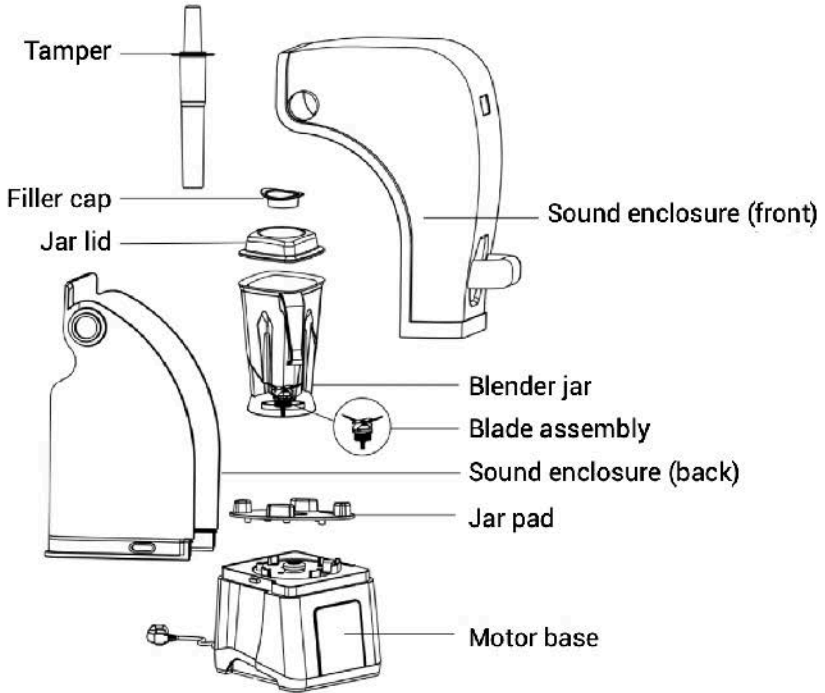

Control Panel

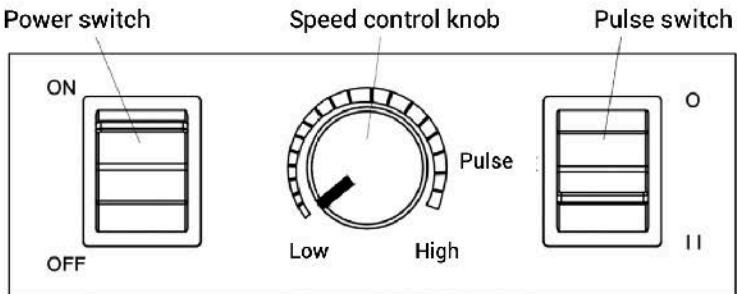

BEFORE FIRST USE

1. Check to make sure the appliance is undamaged. In case of any damage, contact your supplier immediately and do NOT use the appliance.
2. Remove all packaging material.
3. Wash all parts except the blender base with warm, soapy water. Dry thoroughly.
4. Wipe the motor base with a soft, damp cloth.
5. Place the appliance on a level and steady surface.
6. Position the appliance in a way that the plug is always accessible.

CAUTION! Do not immerse motor base in water or other liquids.

WARNING! Risk of injury! Do not reach into the jar while appliance is running. Sharp rotating blades can cause serious injury.

OPERATING YOUR BLENDER

1. Place the motor base on a stable, level surface.
2. Make sure that the Power switch is in the OFF position.
3. Plug the appliance into a power outlet.

4. Fill the blender jar with ingredients. Push the jar lid down onto the blender jar firmly to seal.
5. Set the jar on the motor base by aligning it over the jar pad anchored to the base.
6. Close the sound enclosure firmly.

CAUTION! The motor will start immediately if the blender jar is placed back on the motor base with the appliance switched ON. Make sure the appliance is switched OFF before placing the blender the jar onto the motor base.

NOTE: *Remove the filler cap only when using the tamper or when adding ingredients into the blender jar.*

Using the Speed Control Knob

1. Check to make sure the speed control knob is at the lowest speed position.
2. Turn the Power switch to ON to start blending.

NOTE: *The blending starts as soon as the Power switch is turned on. Always pour the ingredients in before switching the appliance on.*

3. Use speed control knob to adjust the speed. Turn knob clockwise to increase the speed. Turn knob counterclockwise to decrease the speed.

NOTE: *Always start at the lowest speed and adjust to a higher speed after starting the blender.*

Use **lower** speed for light stirring or mixing such as dressings, marinades and batters. Use **middle** speed for heavy mixing and chopping. Use **higher** speed for blending, puréeing or liquefying ingredients.

Using the Pulse Function

Press and hold the **Pulse** switch downwards to start the pulse function. Blending operate at maximum speed. Release the Pulse switch to stop blending.

Pulse function is ideal for foods that require short bursts of power such as crushing ice, chopping nuts, or mincing fruits.

WARNING! Risk of injury! Do not reach into the jar while appliance is running. Sharp rotating blades can cause serious injury.

IMPORTANT: Do not exceed 2 minutes for each blending cycle. Let the appliance rest for a minimum of 2 minutes between consecutive cycles.

Using the Tamper

The tamper helps in preparing thick and frozen mixtures, and in the release of trapped air bubbles.

To use the tamper, remove filler cap and insert through the opening in the jar lid. Use the tamper only when the jar lid is securely placed onto the blending jar.

Switching Off

1. Switch off the appliance and wait until the motor comes to a complete stop before removing the jar.
2. Unplug the appliance from the outlet when not in use.

Overheat Protection

The appliances has a built-in overheat protection mechanism. When the blender reaches a certain temperature (135°C), it will automatically switch off to protect the motor from overheating. Allow the appliances to rest for 30 minutes before switching on again.

BLENDING TIPS

- Cut all food into cubes (approximately 1 inch) where appropriate, for an even blending result.
- Place liquid before solid ingredients in the jar, unless specified otherwise in the recipe.
- Always begin blending on the lowest speed setting, then increase speed if desired.
- To purée more efficiently, blend thick mixtures when the jar is $\frac{1}{4}$ to $\frac{1}{2}$ full.
- When blending thick or dry mixtures, stop the appliance and scrape down the sides of the blending jar with a rubber or plastic spatula.
- Do not overfill the jar before blending begins. Stop the appliance periodically to add extra liquid or ingredients through the hole in the lid.
- Add liquids in small increments until you have reached your desired consistency. Adding too much liquid can make your mixtures too runny, while adding too little liquid will make your mixtures too thick.

CLEANING AND MAINTENANCE

WARNING! Risk of electric shock!

- To prevent electric shock, unplug the appliance before cleaning.
- Do not immerse motor base in water or other liquids.

CAUTION! Risk of injury!

Blades are sharp. Avoid touching the blades with bare hands during cleaning.

1. Add 240ml (1 cup) of hot water and a drop of mild dish soap to the blender jar.
2. Place the jar lid tightly onto the blender jar.
3. Place the blender jar on the motor base and, with your hand placed on top of the lid, switch the appliance on at **HIGH** speed for about 10 to 20 seconds.
4. Wash any remaining residue and rinse well, then dry thoroughly.
5. Wipe the motor base and sound enclosure with a soft, damp cloth.

IMPORTANT:

- Never use corrosive cleaning agents, wire brushes, abrasive scourers, metal or sharp utensils to clean the appliance.

- Always clean and dry the blender jar immediately after use. This will prevent discoloration.

TROUBLESHOOTING

Problem	Possible Cause	Solution
The appliance does not switch on.	<ul style="list-style-type: none">• Power plug is not connected properly.• Blender jar is not properly placed on the jar pad.	<ul style="list-style-type: none">• Ensure the plug is properly inserted into the outlet.• Position the blender jar properly on the jar pad.
The appliance switches off automatically.	The appliance is equipped with an overheat protection. If appliance overheats, it automatically switches off.	Press the START button after selecting the preset program or function.
The food cannot be blended or is not fully blended.	<ul style="list-style-type: none">• Contents are too thick.• Ingredient size too large.• There is excessive amount of	<ul style="list-style-type: none">• Add liquid thin the recipe.• Use the tamper to agitate the contents.• Remove the ingredients and

	ingredients in the jar.	cut into smaller pieces. <ul style="list-style-type: none">• Remove some ingredients., then shake the jar to redistribute the contents.
--	-------------------------	---

WARRANTY TERMS AND CONDITIONS

ONE-YEAR LIMITED WARRANTY ON PARTS AND LABOR

BAUMANN LIVING provides a warranty to the original purchaser of this product against defects in materials and workmanship for one year. If a product covered by this warranty is determined to be defective within the warranty period, **BAUMANN LIVING** will repair or replace the defective part with a new or remanufactured part free of charge subject to terms and conditions stated herein.

To obtain warranty service, proof of purchase in the form of a sales invoice or copy thereof is required to show that a product is within the warranty period. If any one of the documents cannot be produced, corresponding fees for labor and replacement parts will be charged.

Parts and Labor

There will be no charge for parts and labor during the warranty period. Replacement parts or units may be new or recertified and are upon **BAUMANN LIVING's** option and sole discretion. Replacement parts and units are warranted for the remaining portion of the original warranty. Our decision on all questions relating to complaints as a result of defects, either workmanship or materials, shall be conclusive and you shall agree to abide by such decision. Any unit or defective part that have been replaced shall become **BAUMANN LIVING's** property. After the lapse of this warranty, a charge will be made on all labor and replacement of parts.

Types of Services

Defective products must be sent to any **BAUMANN LIVING** service center to obtain warranty service. **BAUMANN LIVING** is neither responsible for transportation costs to the service center nor **BAUMANN LIVING** will cover return shipping to the customer. Product returns to **BAUMANN LIVING** service centers must utilize either the original carton box and shipping material or packaging that affords an equal degree of protection.

For home service, the transportation fee of **BAUMANN LIVING** service personnel will be charged to the customer, depending on the location. Our service personnel reserve all rights to refuse to attend to any equipment installed in an inaccessible location or any other hazardous situation.

LIMITATIONS AND EXCLUSIONS

BAUMANN LIVING one-year limited warranty only covers defects in materials and workmanship; however, this warranty does not cover the following:

1. Damage resulting from accidents, transport, misuse, abuse, alteration, tampering, or failure of the purchaser to follow normal operating procedures outlined in the user's manual.
2. Damage caused by negligence and poor maintenance.
3. Defects or damage due to spillage of food/liquids or improper usage of electrical supply or electrical circuit, major fluctuations in voltage, exposure to rain or moisture, wrong fuel or oil used.
4. Damage, losses, and defects as a result of fire, flood, or other Acts of God.
5. Normal wear-and-tear, corrosion, rusting, or stains.

6. Defects & damage arising from improper testing, operation, usage of the wrong component, demonstration, maintenance, installation, adjustment, or any alteration or modification of any kind.
7. Scratches & damage to the outer surface areas and externally exposed parts that are due to normal customer use.
8. General maintenance & routine servicing.
9. Claims for damaged/missing parts after 7 days from the date of purchase.
10. If any part or parts of the unit are replaced with a part or parts not supplied or approved by us, or if the unit has been dismantled or repaired by any person other than a **BAUMANN LIVING** authorized technician.
11. Any equipment/product which has its serial number removed or made illegible/tampered with.
12. If the warranty card is altered, defaced, or erased in any manner whatsoever.
13. If the unit is used for purposes other than household use, such as commercial use.

The one (1) year warranty covers the mainboard and control PCB, motor, heating element, boiler, and power supply. However, this warranty does not cover parts (i.e. accessories, bowl, pressure valve, top cover lid, filter, glass carafe, heating and grill plates, glass lid, pot, wire racks, drip tray, glass and plastic jar, juicing cones, lever, blades, cutter, baskets, glass bowl, handle, trays, fuse, coffee holder, water and milk tank, silicon tubes, belts, gaskets, burrs, rubber connectors, gears, glass door, bulb, handle, interior and exterior casing) that are subject to wear and tear, rust, stains, or corrosion.

This one-year limited warranty does not cover Products sold "**AS IS**", "**FACTORY RECTIFIED**", or by a non-authorized reseller.

THERE ARE NO EXPRESS WARRANTIES OTHER THAN THOSE LISTED OR DESCRIBED ABOVE. ANY IMPLIED WARRANTIES, INCLUDING ANY IMPLIED WARRANTY OF MERCHANTABILITY AND FITNESS FOR A PARTICULAR PURPOSE, SHALL BE LIMITED IN DURATION TO THE PERIOD OF TIME SET FORTH ABOVE. **BAUMANN LIVING'S** TOTAL LIABILITY FOR ANY AND ALL LOSSES AND DAMAGES RESULTING FROM ANY CAUSE WHATSOEVER INCLUDING **BAUMANN LIVING'S** NEGLIGENCE, ALLEGED DAMAGE, OR DEFECTIVE GOODS, WHETHER SUCH DEFECTS ARE DISCOVERABLE OR LATENT, SHALL IN NO EVENT EXCEED THE PURCHASE PRICE OF THE PRODUCT. **BAUMANN LIVING** SHALL NOT BE RESPONSIBLE FOR LOSS OF USE, COMMERCIAL LOSS, LOST REVENUE OR LOST PROFITS, OR OTHER INCIDENTAL OR CONSEQUENTIAL DAMAGES. THIS WARRANTY IS SUBJECT TO CHANGE WITHOUT NOTICE.

IMPORTANT: Please present sales invoice as proof of purchase whenever you require our service during the warranty period.

www.baumannliving.com