

**BAUMANN  
LIVING**

# power blender

Stronger crushing power for smoother blends



**BM-BL1029KWCB**

## **INSTRUCTIONS MANUAL**

[www.baumannliving.com](http://www.baumannliving.com)

## TABLE OF CONTENTS

<b>IMPORTANT SAFEGUARDS .....</b>	<b>3</b>
<b>PARTS AND FEATURES .....</b>	<b>5</b>
<b>BEFORE FIRST USE.....</b>	<b>6</b>
<b>USING THE POWER BLENDER.....</b>	<b>6</b>
<b>HELPFUL HINTS FOR BLENDING.....</b>	<b>8</b>
<b>CLEANING AND MAINTENANCE .....</b>	<b>9</b>

## **IMPORTANT SAFEGUARDS**

When using electrical appliances, basic safety precautions should always be followed, including the following:

1. Read all instructions.
2. To protect against risk of electrical shock, do not put cord, plug, base, or motor in water or other liquid.
3. Children must be supervised to ensure that they do not play with the appliance.
4. Unplug cord from outlet when not in use, before putting on or taking off parts, and before cleaning.
5. Avoid contact with moving parts.
6. Do not operate any appliance with a damaged cord or plug, or after the appliance malfunctions, or is dropped or damaged in any manner.
7. If the supply cord is damaged, it must be replaced by the manufacture or its service agent or a similarly quality person in order to avoid a hazard.
8. The use of attachments, including canning jars, not recommended or sold by the appliance manufacturer may cause a risk of injury to persons.
9. Do not use outdoors.
10. Do not let cord hang over edge of table or counter or touch hot surfaces, including stove.

11. Keep hands and utensils out of jar while blending to reduce the risk of severe personal injury and/or damage to blender. A rubber spatula may be used but must be used only when blender is not running.
12. Blades are sharp; handle carefully – especially when assembling, disassembling, or cleaning inside blender jar.
13. Do not use a broken, chipped, or cracked blender jar.
14. Do not use broken, cracked, or loose blade assembly.
15. To reduce the risk of injury, never place blade assembly on base without jar properly attached.
16. Always operate blender with lid in place.
17. Be careful if hot liquid is poured into the jar as it can be ejected out of the appliance due to a sudden steaming.
18. Do not leave blender unattended while it is operating.
19. To disconnect cord, turn the control to OFF. Then remove plug from wall outlet.
20. Do not use appliance for other than intended purpose.
21. This appliance is not to be used by persons (including children) with reduced physical, sensory or mental capabilities or lack of experience and knowledge, unless they have been given supervision or instruction.

**SAVE THESE INSTRUCTIONS  
FOR HOUSEHOLD USE ONLY**

## PARTS AND FEATURES

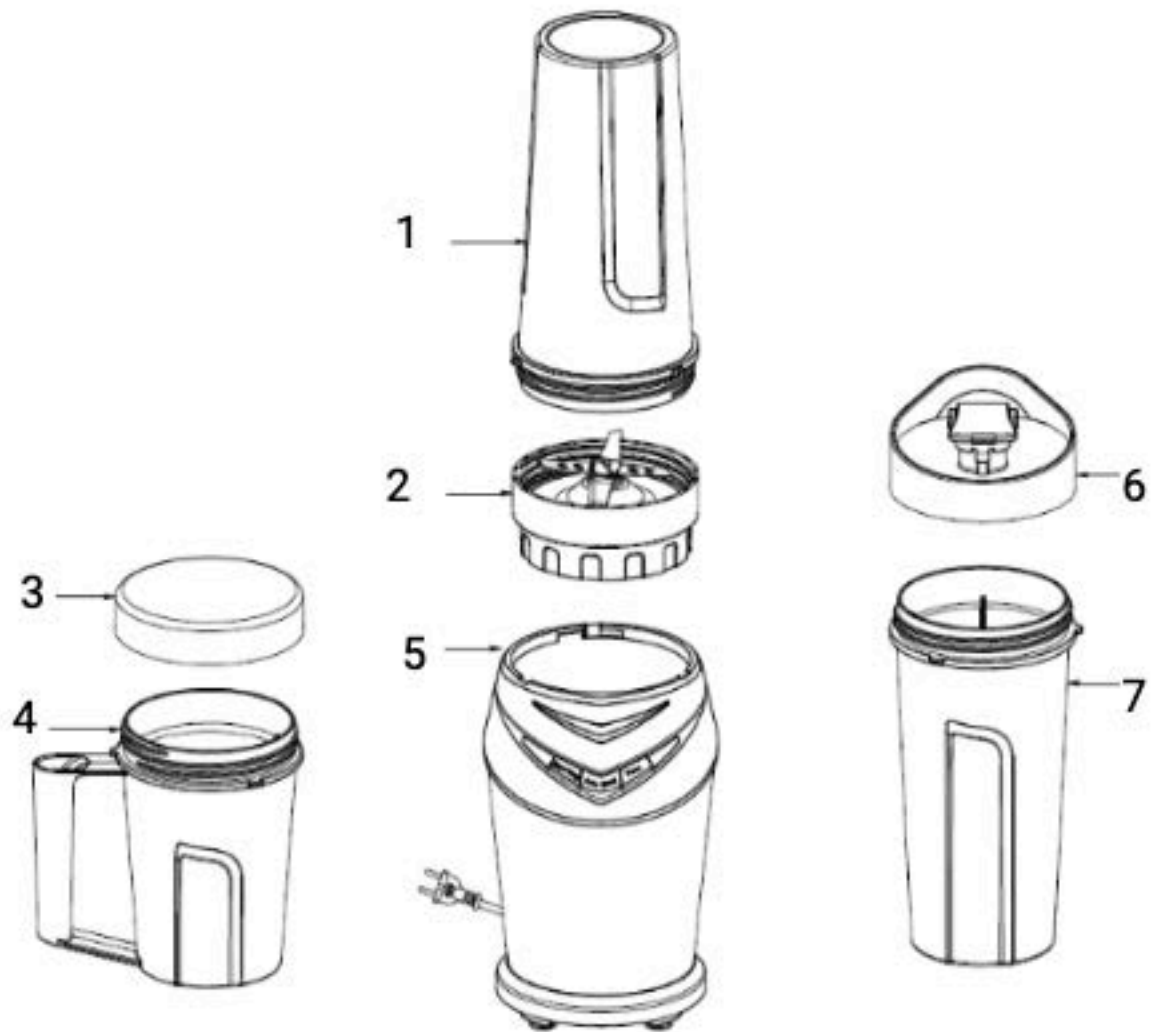

- 1 – Blending jar 700ml
- 2 – Blade assembly
- 3 – Storage lid
- 4 – Blending cup 350ml
- 5 – Motor base
- 6 – Travel lid with drinking spout
- 7 – Blending jar 700ml

## BEFORE FIRST USE

Wash the blending jars and cup, lids and blade assembly (see section on **Cleaning and Maintenance**).

**CAUTION!** The blades at the base of the blade assembly are very sharp and must be handled with the utmost care.

## USING THE POWER BLENDER

1. Place the motor base on a flat, stable surface and plug into a wall socket.
2. Fill the blending jar/cup with ingredients.

**NOTE:** Do not exceed the MAX mark. For best results, we recommend filling the jar/cup with liquid ingredients first and then fresh/frozen ingredients (cut the ingredients into pieces no larger than 2 cm).

3. Screw the blade assembly securely onto the blending jar/cup, then place the jar/cup with the screwed-on blade assembly onto the motor base by aligning the tabs on the jar with the slots on the motor base. Then turn the bottle clockwise until it clicks into place.
4. Start blending by selecting the function keys on the motor base.

**Start/Stop:** Press the button to blend continuously for 60 seconds. To stop sooner, press the button again.

**Auto Blend:** Press the button to blend at intervals of 3 seconds with a 2-second pause, for 10 intervals. Then blending stops automatically.

**Pulse:** Press the button at short intervals for pulse blending.

**NOTES:**

- Maximum continuous operating time is 1 minute. This must be followed by a pause of 10 minutes.
  - This appliance is not suitable for blending potatoes, cream, egg whites, dough, etc.
  - The appliance must not be used with hot liquids, as the pressure at the base will be too great.
  - If the motor stops during use, unplug the appliance and remove the blender jar/cup from the motor base. Let the appliance rest for at least 30 minutes before starting it again.
5. After you have finished blending, remove the blending jar/cup from the motor base by turning counterclockwise and pull straight up.
  6. Turn the jar/cup upright so that the blade assembly is facing up. Unscrew, and remove the blade assembly. Then screw on the lid provided and the blender jar/cup is ready to drink from or take with you.
  7. Make sure that the motor base is unplugged when not in use.



## HELPFUL HINTS FOR BLENDING

- Always make sure the blade assembly is secured to the bottle before blending.
- When making nut butters or oil based foods, do not process for more than one minute after the mixture starts circulating. Over-processing can cause the blender to overheat and possibly malfunction.
- When blending cold drinks using ice (i.e. margaritas or smoothies), it is recommended that the ice cubes are ½ inch and there should be a 2:3 ratio of ice to liquid. You can also use frozen fruits as a replacement for ice to add extra flavor to your drinks.
- Add liquids in small increments until you have reached your desired consistency. Adding too much liquid can make your mixtures too runny, while adding too little liquid will make your mixtures too thick.
- Use the 350ml bottle for best results when grinding food.
- Make sure to use no more than 3.5 ounces (100 g) of ingredients when grinding food like coffee beans.
- If necessary, use a rubber spatula or a wooden spoon to remove food from the sides of the bottle. Make sure to turn the power off and unplug the blender from the electrical outlet before using the spatula.
- Allow the blender to rest for at least 10 minutes in between uses when mixing multiple mixtures.



## **CLEANING AND MAINTENANCE**

- Always unplug the appliance prior to cleaning and maintenance.
- Only blender jar/cup and lids are dishwasher safe. You may also use water and some mild dishwashing liquid to clean.
- For Auto-Cleaning, pour about 200-300ml of warm water and a couple drops of liquid dish detergent into the jar, then reassemble the blender with the blade assembly and jar. Press the 'Start/Stop' button to turn on the blender. Allow the blender to run for about 10 seconds. Turn off the unit, remove the jar from the blade assembly and rinse the jar under running water.
- Do not use harsh chemical agents or any other abrasive product. Remove any stubborn stains by soaking and rubbing with a soft cloth and mild detergent.
- Use a damp cloth when cleaning the motor base. Dry all parts thoroughly. Store the blending jar/cup with the lid loosely screwed on to allow air to circulate.

### **IMPORTANT!**

**THE MOTOR BASE MUST NEVER BE IMMERSED IN ANY LIQUID!**

### **Cleaning the rubber gasket**

The gasket can also be removed from the blade assembly and jar/bottle lids for easier removal of residue.



1. Unscrew the blade assembly (or jar lid) from the blending jar/cup. Use a flat plastic stick to lift the edge of the gasket. The gasket can then be washed using water and mild dishwashing liquid.  
**CAUTION:** The blades are very sharp. Handle carefully!
2. Replace the gasket in the slot on the blade assembly (or jar lid). Make sure that the gasket forms a tight seal around the base by pressing it right down into the slot. There is a risk of leakage if the gasket is not correctly replaced.