

STEEL BED FRAMES

IRONHORSE, ADVANTAGE OR CLASSIC

TWIN / FULL

To learn more about your product or its warranty, call **855.581.3095** or visit us online at glideaway.com.

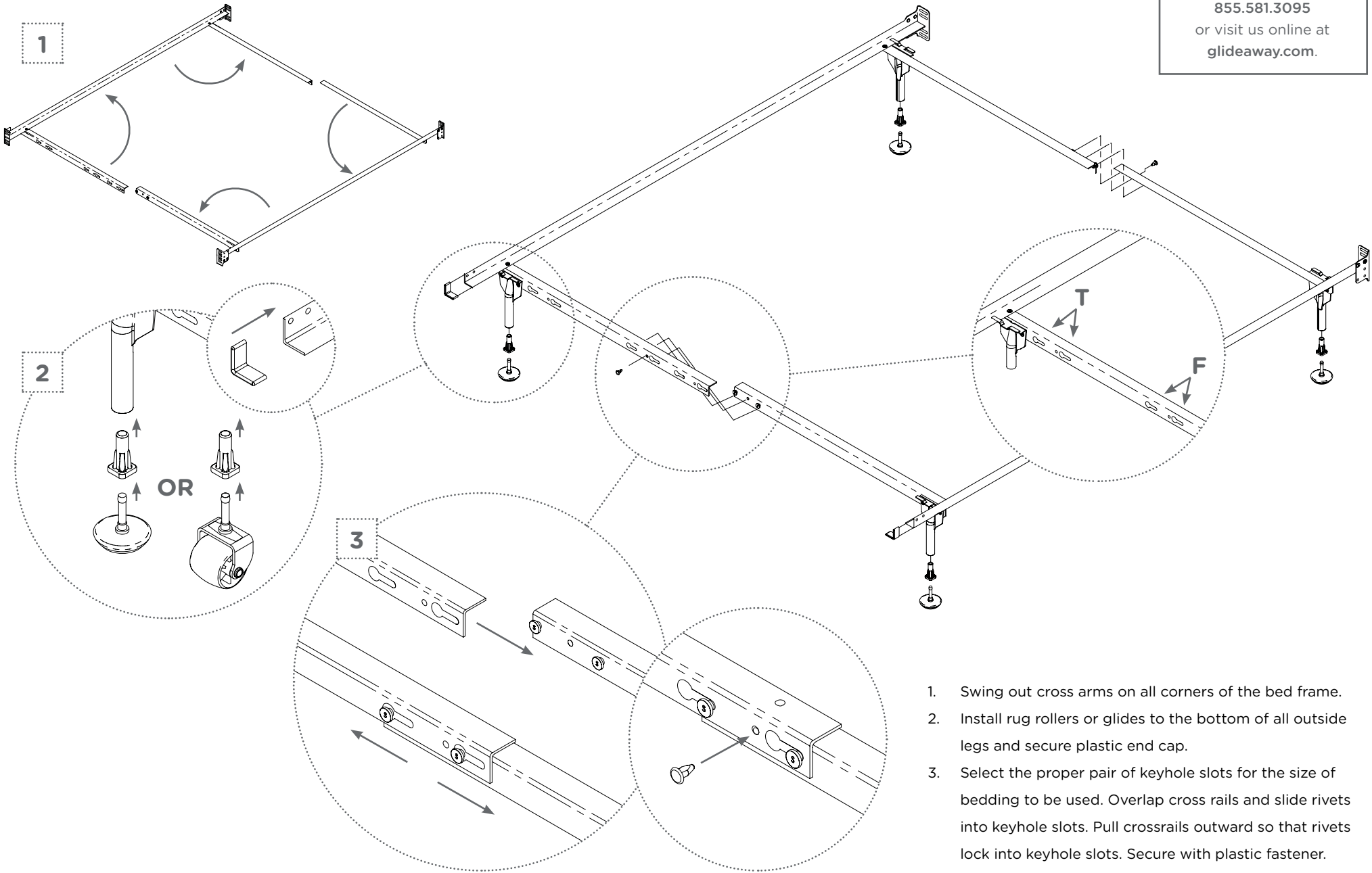

1. Swing out cross arms on all corners of the bed frame.
2. Install rug rollers or glides to the bottom of all outside legs and secure plastic end cap.
3. Select the proper pair of keyhole slots for the size of bedding to be used. Overlap cross rails and slide rivets into keyhole slots. Pull crossrails outward so that rivets lock into keyhole slots. Secure with plastic fastener.

STEEL BED FRAMES

IRONHORSE, ADVANTAGE OR CLASSIC

QUEEN

To learn more about your product or its warranty, call **855.581.3095** or visit us online at glideaway.com.

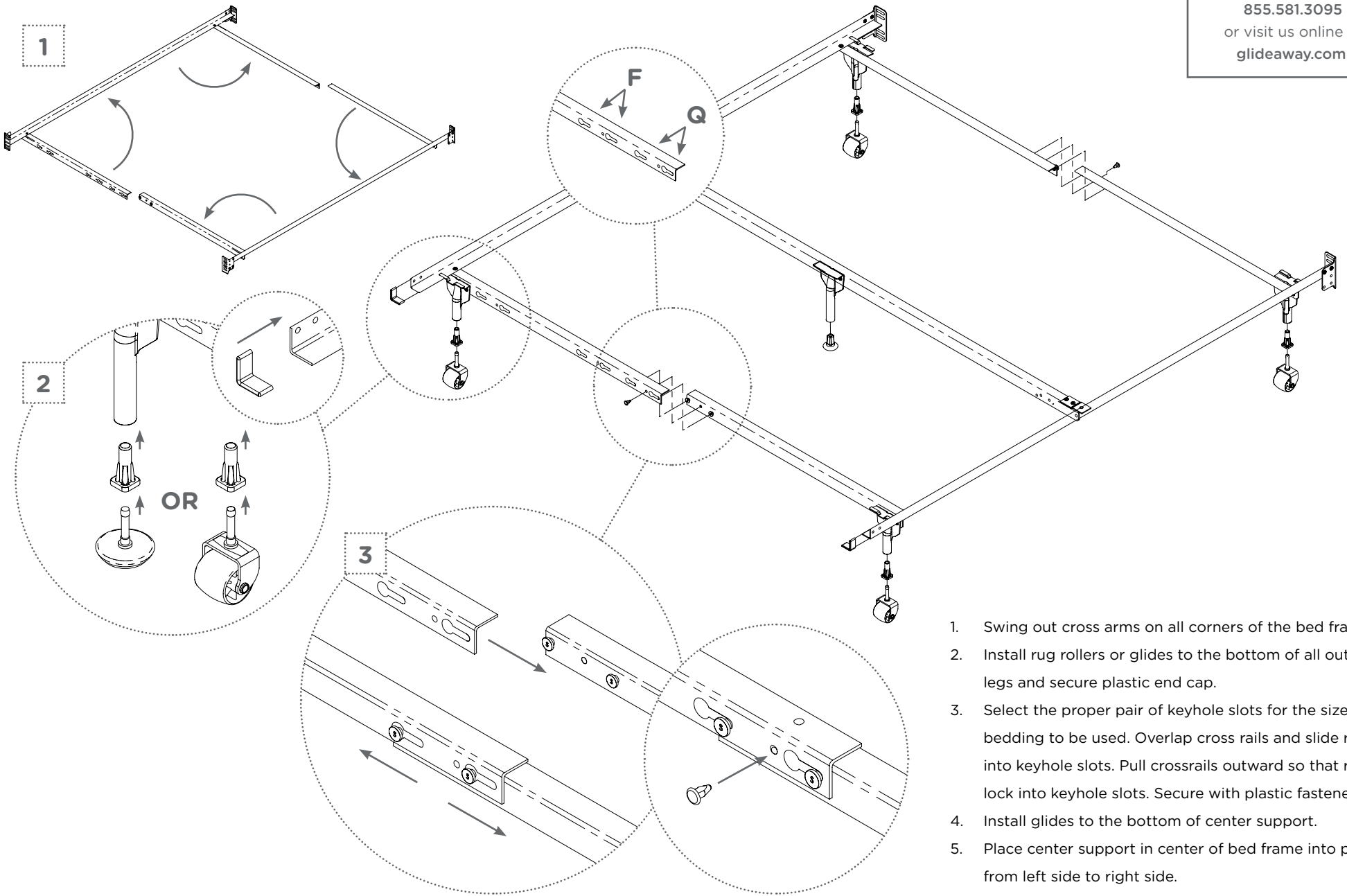

1. Swing out cross arms on all corners of the bed frame.
2. Install rug rollers or glides to the bottom of all outside legs and secure plastic end cap.
3. Select the proper pair of keyhole slots for the size of bedding to be used. Overlap cross rails and slide rivets into keyhole slots. Pull crossrails outward so that rivets lock into keyhole slots. Secure with plastic fastener.
4. Install glides to the bottom of center support.
5. Place center support in center of bed frame into position from left side to right side.

STEEL BED FRAMES

IRONHORSE, ADVANTAGE OR CLASSIC

KING AND CALIFORNIA KING

To learn more about your product or its warranty, call **855.581.3095** or visit us online at glideaway.com.

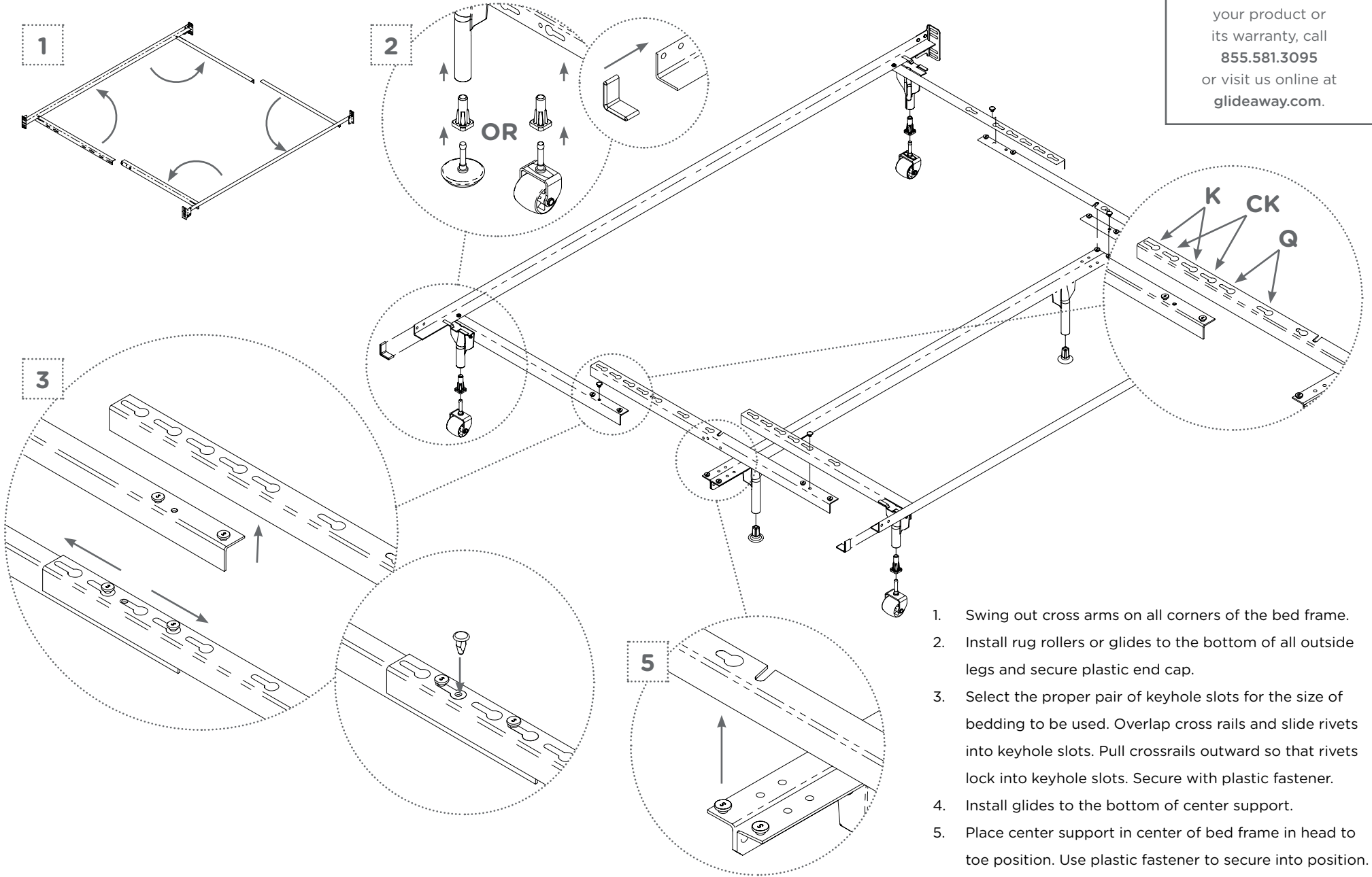

1. Swing out cross arms on all corners of the bed frame.
2. Install rug rollers or glides to the bottom of all outside legs and secure plastic end cap.
3. Select the proper pair of keyhole slots for the size of bedding to be used. Overlap cross rails and slide rivets into keyhole slots. Pull crossrails outward so that rivets lock into keyhole slots. Secure with plastic fastener.
4. Install glides to the bottom of center support.
5. Place center support in center of bed frame in head to toe position. Use plastic fastener to secure into position.