

Constellation Connect Honeywell Home Plug-in Overview

Your Constellation Connect system can connect to thousands of additional smart home devices*, including the T5+ and Round Lyric smart thermostats from Honeywell Home.

Adding your Honeywell Home products to your Constellation Connect system is simple and can be set up by following the instructions in this guide or the Connect app.

Once your Honeywell products are integrated into your Connect system, you'll be able to control them from your Connect app, incorporate them into scenes and modes, and control it by voice through the Alexa skill.



What is a scene? Scenes are customized device actions that are triggered by a defined action, e.g. a device status change, a schedule or a geofence location.

What is a mode? Modes are predefined, but configurable, settings that change when you set your system status to Home, Armed Away, Armed Stay or Vacation.

*Requires an active Always Connected or Professional Monitoring plan. To sign up for a monitoring plan, call 855-532-1979.

Questions? Call 855-532-1979 or view our videos at constellationconnect.com/contact

Honeywell Home is a trademark of Honeywell International Inc. used under license to Resideo Technologies, Inc.

© 2019 Constellation Energy Resources, LLC. These materials are provided by Constellation NewEnergy, Inc. or Constellation Connect, LLC each a subsidiary of Exelon Corporation. Brand names and product names are trademarks or service marks of their respective holders. All rights reserved. Errors and omissions excepted.

MD License #s IR-500; 107-2276. TX License #s PUCT #10014; B07305101.

Adding a Honeywell Home Thermostat to Your Constellation Connect System

To start connecting, install the Honeywell Home plug-in to your Connect system following the step-by-step instructions below.

Before you begin, make sure your thermostat is mounted and that you have set up a Honeywell Home account and can access it.

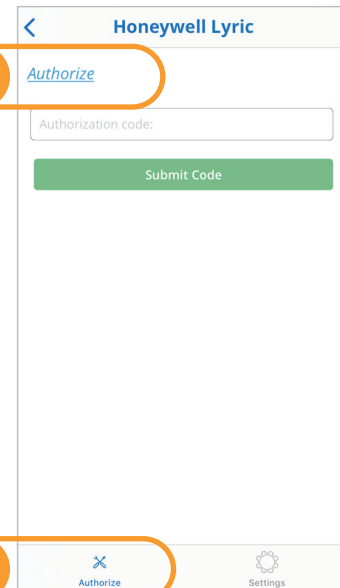
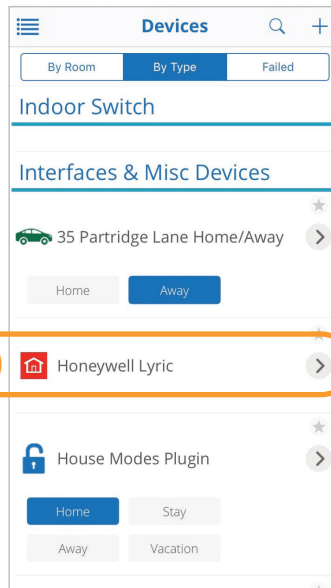
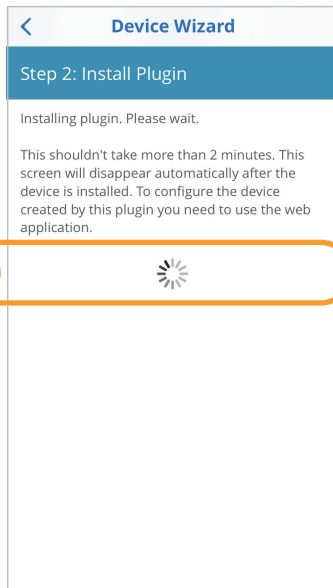
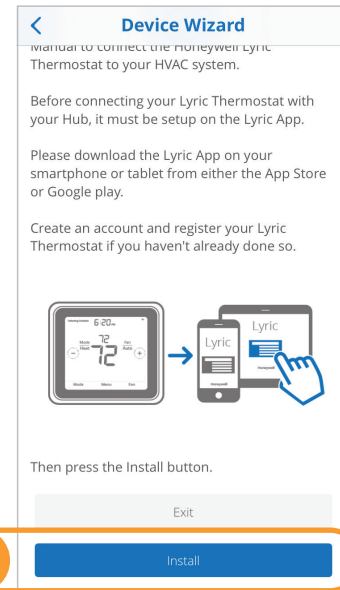
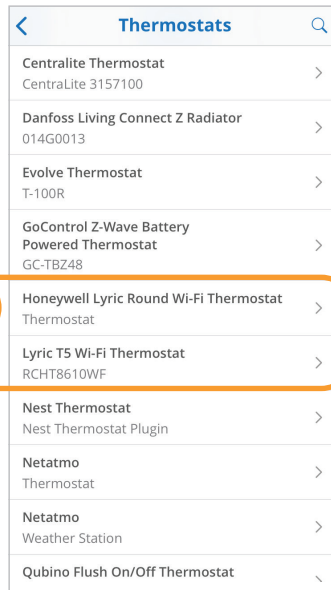
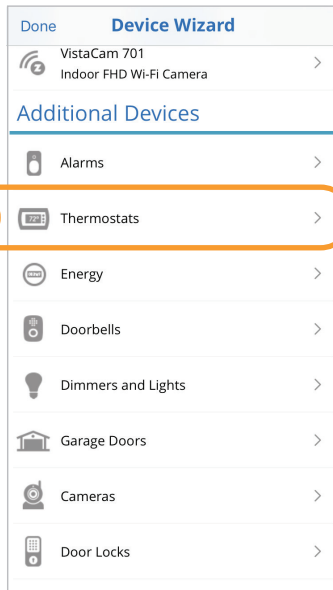

TIP: You'll need to log into your Constellation Connect account using your mobile or PC web browser to complete the setup of your Honeywell Home plug-in.

Authorizing and Authenticating Your Thermostat

Once the Honeywell Home plug-in has been installed, you will need to authorize and authenticate your Connect system by logging into your Honeywell Home account.

Follow the steps below to authorize and authenticate your system:

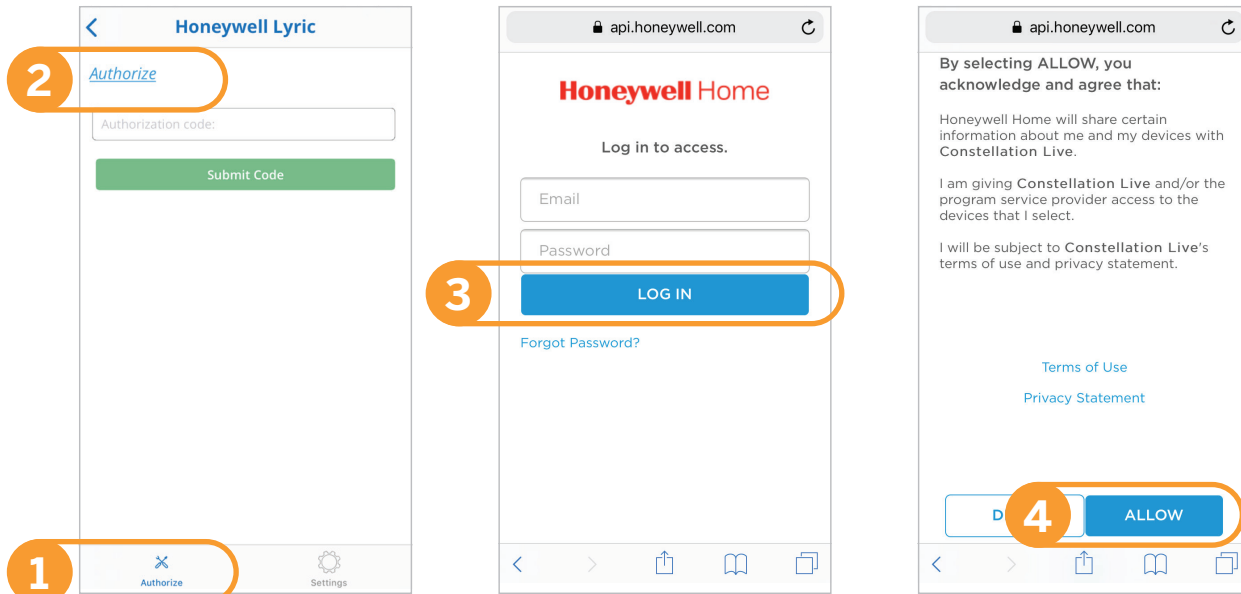

If you have multiple devices in your account, you can select one or more of them to connect.

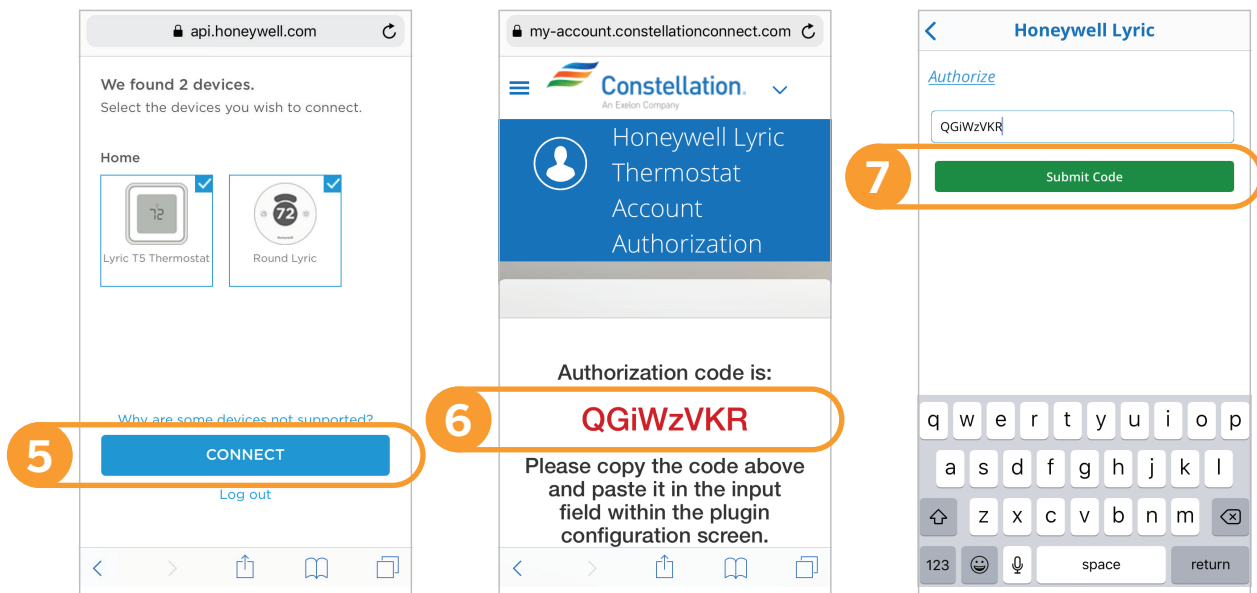

Congratulations! You've connected your Honeywell Home products to your Constellation Connect account!

Using Your Honeywell Home Thermostat in Constellation Connect

Once your Honeywell Home thermostat is linked to your Constellation Connect system, you'll be able to control it and incorporate it into scenes and modes.

If you have the Constellation Connect Alexa skill set, you can control your thermostat by voice.

You can change your Honeywell Thermostat mode between Auto, Heating, Cooling and Off.

You can also change the temperature set points.

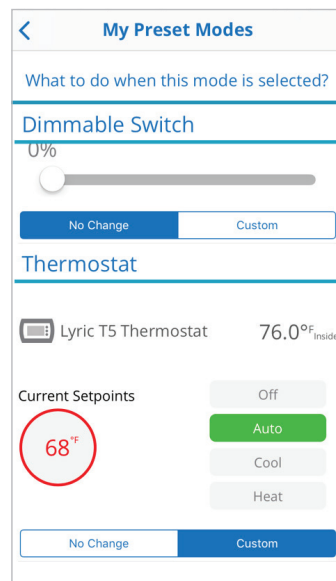
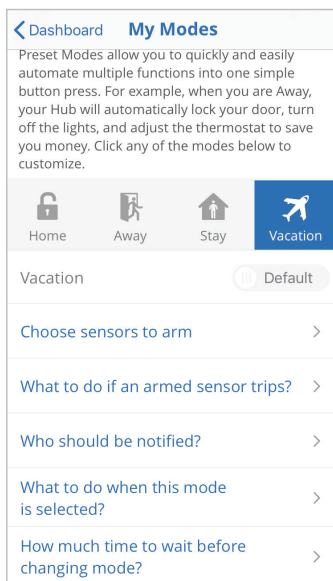
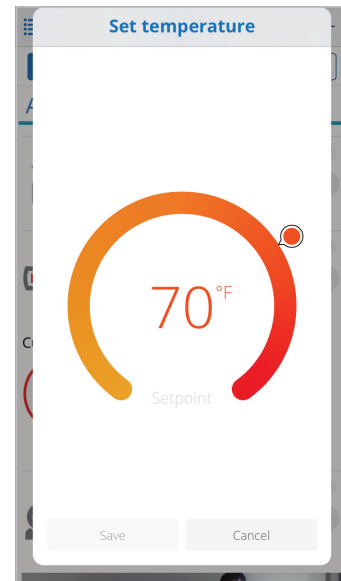
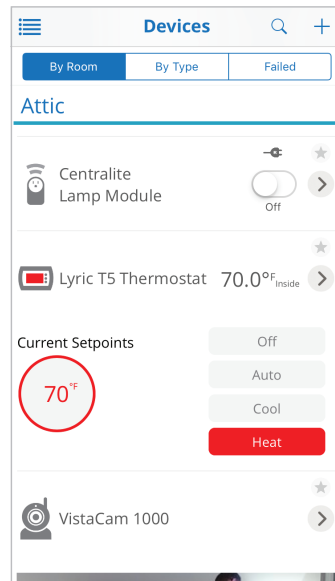

You can also create scenes or customize your modes to include your Honeywell Home thermostat. For example, you can make your thermostat go to a lower or higher set point when your home is in Vacation mode to save energy.