

LiquiLevel

TANK LEVEL INDICATORS

FB Tank Level Indicator Industrial series

LiquiLevel FB series tank level indicators are easy to install, and offer a economical solution where a reliable mechanical liquid level indicator is required on bulk storage tanks operating under atmospheric or low pressure. The system is assembled on-site, and installed to both new and existing tank installations.

- Durable Aluminium powder coated gauge board in white with black graduations and numbers
- Level indication in centimetres and accurate to 5cm.
- Guided float as standard. Unguided float available on request

The FB system consists of a float connected to an external tank level indicator via a cord and a set of pulleys. The indicator has nylon roller glides which enables the indicator to ride smoothly up and down the gauge board which is positioned parallel to the tank. The float accurately follows the liquid variations in the tank. The horizontal float movement is restricted by two guide wires firmly anchored to the tank base. When the indicator is at the top position when the tank is empty and the bottom position when the tank is full. The gauge board is supplied in 1 metre lengths and multiple gauge boards are connected by bracket joiners as per the ordered measuring range.

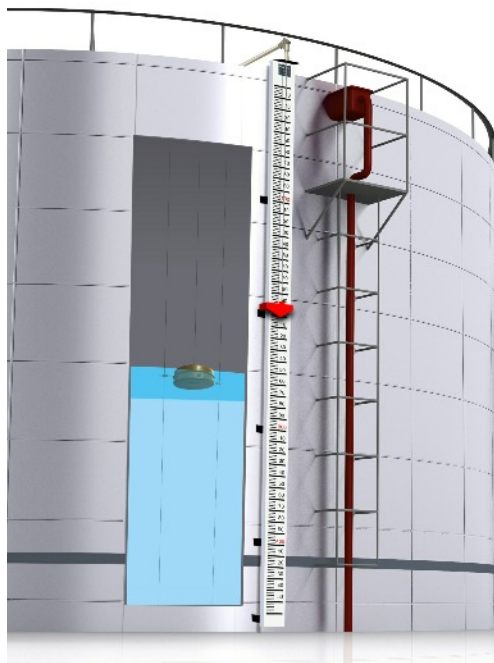

Additional Information to be provided by customer:
Range x service liquid x temperature x pressure. For information on the CR LiquiLevel series of chemical resistant system, please contact our sales or technical department.

TECHNICAL SPECIFICATION

Range	Guided upto 7.5 mtr with 200mmø float and 15 mtr with 350mmø float
Travel	Full range
Graduations	5 mm
Max Temperature	150°C stainless steel, 80°C Polypropylene
Max Pressure	Atmospheric
Float	SS304/SS316
Float cord/ wire	SS304/SS316 x 1.6mmø multistrand, PP x 3mmø
Calibrated gauge board	150mm wide (6") aluminium powder coating with black/red graduations and numbers
Level Indicator	Red powder coated steel with cord fastener
Protection conduit	Vertical and horizontal pipe in galvanised steel pipe Vertical pipe - 20NB x 285mm & 295mm (2 No:s) Horizontal pipe - 20NB x 650mm long (1 No)
Pulley Elbow	Cadmium plated steel with PTFE bush and stainless steel shaft housed in weatherproof enclosure
Guide Wire Tensioners	Cadmium plated steel spring housed in CS
Float Anchor	1 weldable SS304/SS316 plate 25mm x 6mm thick
Float cord fixings	SS304/SS316
Gauge brackets	Powder coated steel
Alarm (optional)	Micro-switch - 5A 230 V in ABS enclosure (IP65)

LiquiLevel

TANK LEVEL INDICATORS

Components & Sub Assemblies

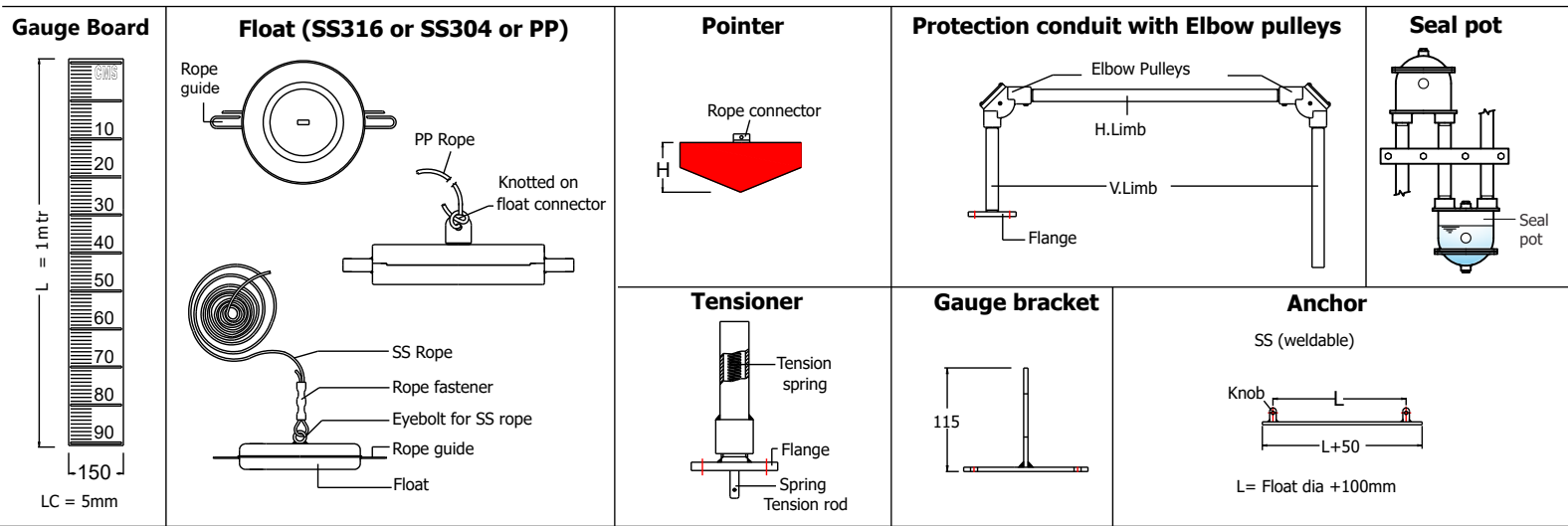

Installation

ASSEMBLY & INSTALLATION

Fig. 1

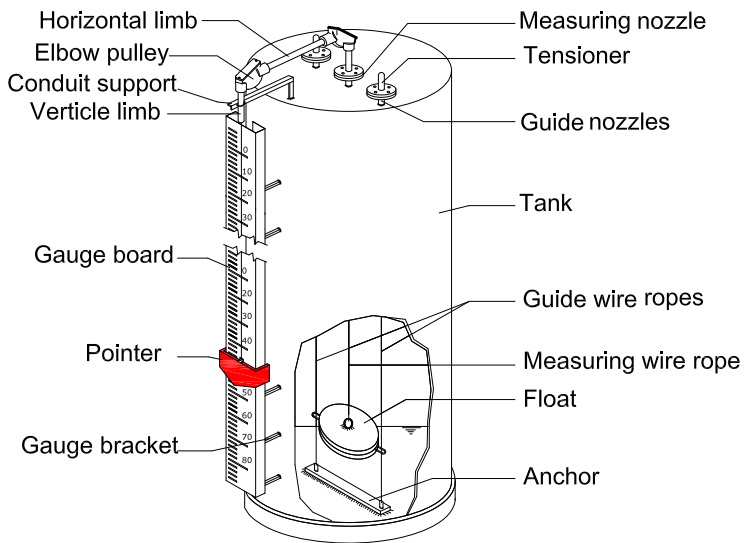

GUIDED CONSTRUCTION WITH FULL TRAVEL

Fig. 2

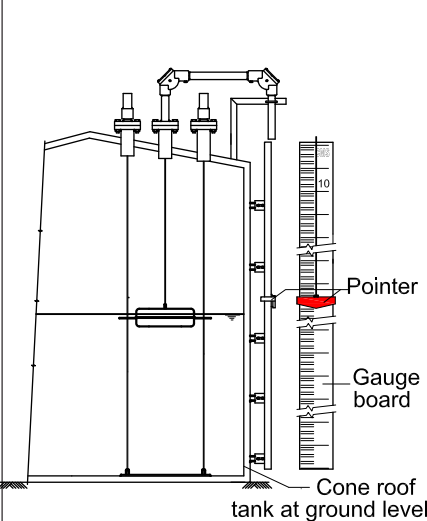

GUIDED CONSTRUCTION WITH HALF TRAVEL

Fig. 3

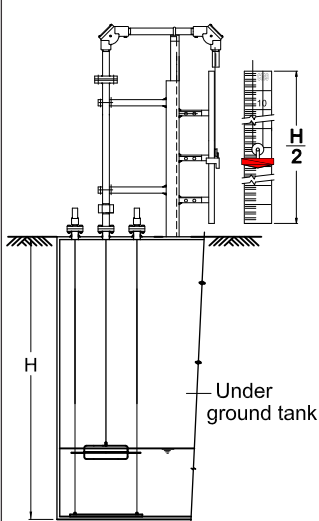

Components to be fabricated by 'customer'

Guide/tank connection

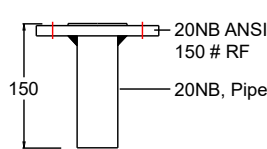

Conduit support

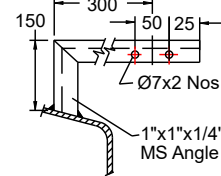

Gauge bracket support

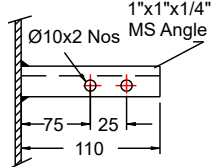

Model Identification

FB:

--	--	--	--	--

 X Range (mm)

Construction					
Guided	G				
Unguided		C			
Float x Dimensions					
SS 304 x Ø200mm			N1		
SS 304 x Ø350mm			N2		
SS316 x Ø200mm			S1		
SS316 x Ø350mm			S2		
PP x Ø200mm			P1		
PP x Ø350mm			P2		
Seal Pot					
50mm WC				1	
200mm WC				2	
Without				W	
Alarm Switches					
Adjustable Microswitch x 1					1
Adjustable Microswitch x 2					2
Without					W
Installation					
Ground Level Tank					G
Under Ground Tank (Sump)					U
Overhead Tank					H

FB : Full travel scale. FB(H) : Half travel scale