

T-100

INSTRUCTION MANUAL

FEATURES:

24 hour clock display

Count up timer with range to 9 hr. 59 min. 59 sec.

Presetable countdown timer with loud beep

Large 4 inch LCD digits for viewing from as far away as 150 feet

RF remote control – no cords required

Powered by AC adapter (included) or batteries (four D size – not included)

Wall mounted or free standing

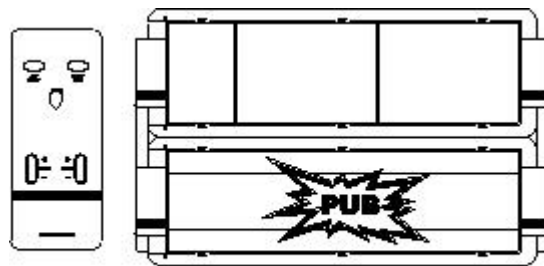

Fig. 1

LIST OF ACCESSORIES:

- Wall Timer
- Remote control with four AAA batteries
- Stands
- AC adapter
- Instruction manual

HOW TO OPEN NAME PLATE DOORS:

Use a suitable screwdriver to open the side doors (as shown in Fig. 2). Do this carefully so as not to damage the plastic side doors. This will allow the removal or insertion of the nameplates and advertisements.

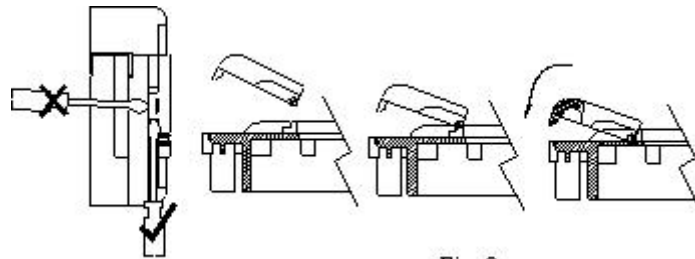

Fig. 2

MOUNTING THE WALL TIMER:

The Wall Timer can be mounted on the wall by the 2 screws hooked into the eyelets on the back of the top housing. Make sure the screws are securely fixed in the wall. The Wall Timer can also stand-alone on the floor or on a table using the stands of the Wall Timer (as shown in Fig. 3).

POWER UP:

For AC connection, use only the AC adapter (9V) supplied with the unit. Verify the power rating indicated on the adapter is the same as the AC power supplied in your location. Plug the adapter into the socket on the right side of the Wall Timer (as shown in Fig. 3). The digits will light up automatically and be ready for setting.

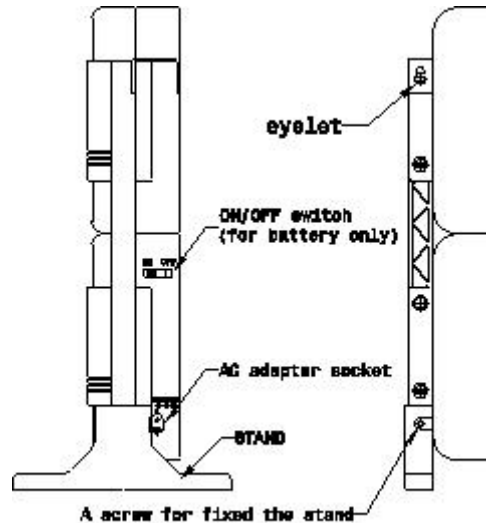

Fig. 3

When AC power is not available, insert 4 D-size batteries into the battery compartment on the back of the Wall Timer (as shown in Fig. 4). When using battery power, the ON/OFF SWITCH can be used to turn the Wall Timer on and off. If the batteries are left in the Wall Timer during AC operation, they serve as a back up in the event of AC power interruption.

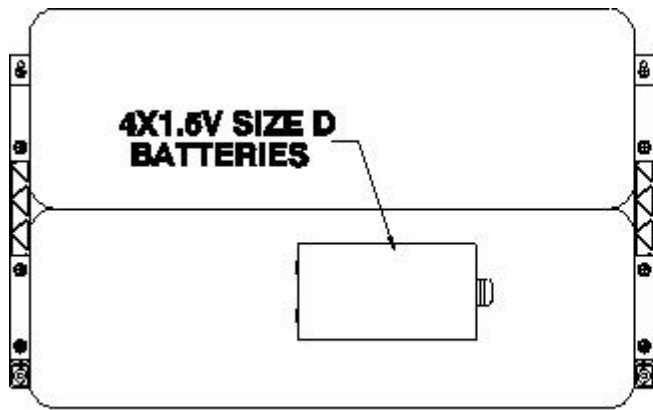

Fig. 4

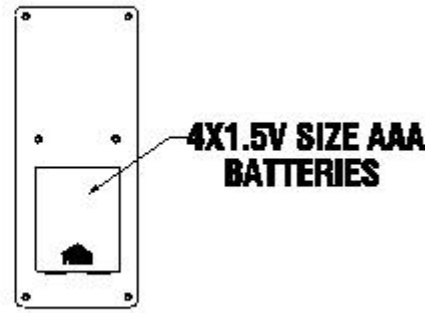

Fig. 5

The batteries for the remote control can be inserted as shown in Fig. 5.

TIME SETTING:

From the Time Display Mode (as shown in Fig. 6), press and hold for 3 seconds to go to the Time Setting Mode (as shown in Fig. 7). In this mode press once for time setting and the time digits will blink. Adjust the minute by using the <+/-TEAM 2> and the hour by using the <+/-TEAM 1>. When time is set, press to return to the Time Display Mode.



Fig. 6



Fig. 7

COUNT UP MODE:

When the Wall Timer is in the Time Display Mode, press and hold 3 seconds and repeat this action once more. It will enter the Count Up Mode with the display showing "C UP" as shown in Figure 8. Press once and 0:00:00 will be displayed. Press to start and press again to stop the count up timer. After timing is stopped, press and hold 3 seconds for resetting to zero.



Fig. 8

COUNT DOWN MODE:

When the Wall Timer is in the Time Display Mode, press and hold 3 seconds and repeat this action twice to enter the Count Down Mode with the display showing "C dn", as shown in Figure 9. Press once to enter SET COUNT DOWN MODE. The previously set countdown time digits will be blinking. Press <+/- TEAM 1> to adjust the minutes and hours. Press <+/- TEAM 2> to adjust the seconds. When the countdown period is set, press once and the time will be stored in memory. The countdown timer can be started and stopped by pressing . At 0:00:00 the Wall Timer will give a long beep to indicate that the time is up. The countdown period can be reset to the memorized period by pressing and holding for 3 seconds. If setting of countdown period is desired at this stage, press momentarily to enter SET COUNT DOWN MODE and set using the <+/-> Buttons as before.



Fig. 9

CHANNEL DESIGNATION

Each packing box, main Wall Timer and remote control box are labeled with the color codes of one of the four preset RF channels (yellow, green, blue and orange). Each set should have the same color code. You are suggested to choose different label set for purchasing 2 to 4 set in order to avoid interference. If you wish to purchase more than 4 sets, you can adjust the Wall Timer to a different channel by opening the backs of the remote control and the lowest compartment of the Wall Timer and change the 4 position mini-toggles to a different position. Make sure that both of the 4 position mini-toggles are set to identical ON/OFF positions otherwise the unit will not work. A maximum of 16 different settings can be achieved.

WATER RESISTANCE

The Wall Timer is not water-resistant so it should be kept and used in a dry location. For outdoor use, avoid contact with water or rain.

TEMPERATURE

Do not leave the Wall Timer in direct sunlight or in very high temperatures for an extended time, as the display may become black. Do not leave the Wall Timer in very low temperatures, as this may result in slow-moving digits. The above conditions will be corrected when the Wall Timer is returned to normal temperatures.

SHOCKS

Be careful not to drop the Wall Timer or hit it against hard surfaces as it may cause mechanical damages.

MAGNETISM

Not affected.

CHEMICALS

Do not expose the Wall Timer to solvents such as gasoline, alcohol, cosmetic sprays, cleaners, paints, etc., as they may cause damage to the Wall Timer.

BATTERY CHANGE (when powered by DC)

When the display becomes dim or blank, or the remote control does not function, battery replacement is necessary. Replace with alkaline battery size D 1.5 V for the Wall Timer and alkaline size AAA 1.5V for the remote control. Remove the batteries from the Wall Timer and remote control when not being used for an extended time (over 3 months).

TROUBLESHOOTING

If for any reason the Wall Timer does not function, contact your dealer for an authorized service center. Do not try to repair it yourself.