

ROLLATOR Instruction Manual



Model # BD749

BIOS living

The BIOS Living Rollator comes with removable nylon storage bags, locking brakes, and a padded seat with back rest. It folds away easily for storage and transport and comes with anti-fold safety locks to prevent the rollator from accidentally folding, while in use.

Please read these instructions before assembly or use of this rollator, and please keep the manual in a safe place.

DO NOT assemble or use this equipment without first reading and understanding this instruction manual.

Personal Safety

- **Never** sit on the rollator and use it as a rolling chair or transport device. The rollator is not designed to be used while seated as a means of transport
- The rollator can provide assistance to an individual weighing up to 136 kg (300 lbs), including the weight of the contents of the nylon storage bags
- The maximum load of the nylon basket under seat is 10 kg (22 lbs)
- **Never** stand on the rollator, or use it as a step
- **Never** transport a person on the seat of the rollator
- Use caution when lifting and carrying the rollator
- Test the brakes before using. Care should be taken to ensure that **ALL** hand and height adjustments are secured, and that moving parts are in good working order before using this or any mobility aid
- Ensure that brakes are in the locked position before sitting
- **Never** sit on the rollator when it is on an incline
- Always sit in the center of the seat

- **Never** sit on the rollator when it is folded
- Each individual should always consult with their physician or therapist to determine proper adjustment usage
- Avoid excessive weight in the rollator bag, it may cause rollator to tip
- Customers should seek the advice / recommendations of a medical professional, to determine if the rollator is suitable for their needs.

Assembly Instructions

Please examine the rollator for shipping damage. Do not use the rollator if there is apparent damage.

Please see the warranty section for more information.

1. Open the rollator frame until it is at its widest point **(Figure A)**. The safety lock automatically fastens when the rollator is fully opened.

Using your hands unfold the nylon storage bag and ensure all clips are securely in place. **(Figure B)**

Remove plastic wrap on the wheels.

Figure A

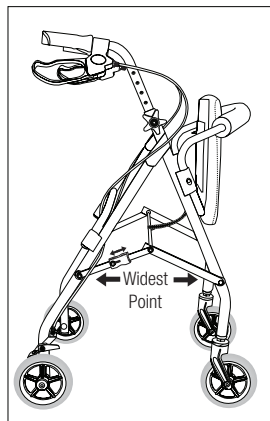
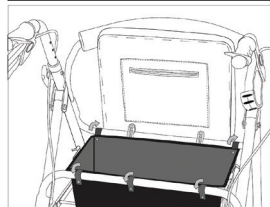

Figure B



2. Insert the handles into the frame tubing. **(Figure C)**. Adjust to the height that best suits you, ideally the handles should be positioned at the break in the wrist. Insert the triangular knob screw through frame and handle holes. **(Figure D & E)** Insert the plastic washer then the triangular knob and turn in a clockwise direction until the handles are secured.
3. Insert the curved backrest into its slot on the front side of the rollator. Ensure it clicks securely into place. **(Figure F)**.
4. Flip the seat forward.

Figure C

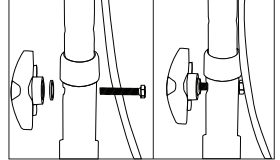
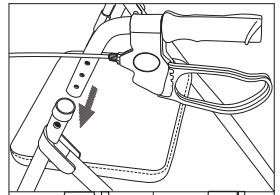

Figure D

Figure E

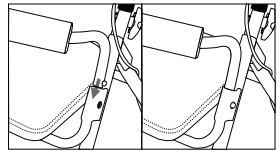
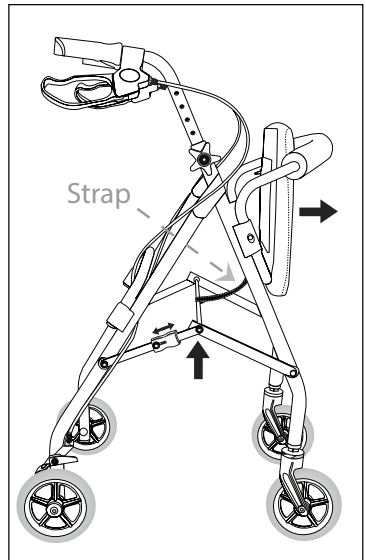

Figure F

Folding the Rollator

To fold the rollator you must manually pull the safety lock to the left to disengage the safety lock. Remove plastic wrap on the wheels.

Lift the seat, and pull up on the black strap which is attached to the cross folding bar. The nylon storage bag will fold up into the rollator.



Brake Operation

The brakes can be used for normal braking while walking with the rollator, or for parking when users want to sit down on the seat.

1. Squeeze handles upwards to apply normal braking.

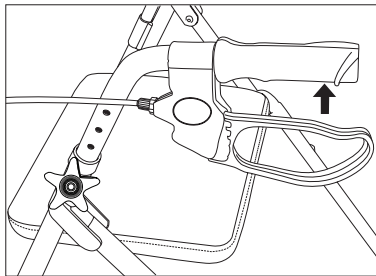

Parking Brakes

1. Push both handles down until they click to activate parking brake. The handle will lock automatically and stay in place.
2. To release the parking brake, pull the handle up. The handle will return to its basic position.

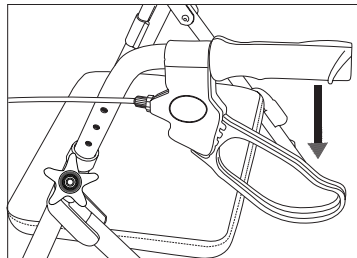

Parking Brake

Adjusting Hand Brakes

If the tension of the brake on the wheels is too loose or too tight, adjust using the following steps:

Note: counter-clockwise/clockwise directions are determined by standing behind the rollator from the user's position.

1. Ensure brake handle is not locked.
2. **To loosen brake handle tension:** Brace the jam nut while turning the adjustment screw clockwise.

Note: If the brake level is scraping the rear wheel, the brake handle must be loosened.

3. To tighten brake handle tension:

Brace the jam nut while turning the adjustment screw counterclockwise.

4. Repeat with other brake.

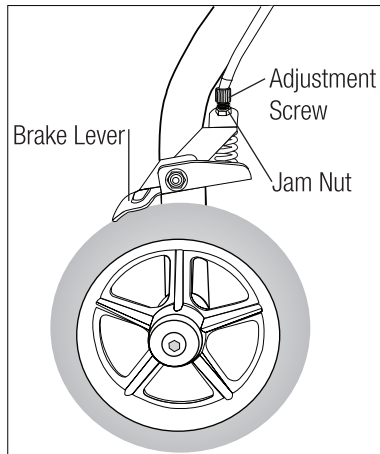

Care & Maintenance

1. Ensure that ALL attached hardware is secured at all times.
2. Make sure seat is secured to rollator properly, tighten screw if loose.
3. Replace any broken, damaged or worn items immediately.
4. To clean, wipe with a damp cloth, use mild soap only, do not use abrasive detergents.

Recommended Handle Height Adjustment

Adjustable Handle Height	Approx. User Height Min / Max
31½" - 35" / 80 - 88 cm	5'4" - 5'10" / 162 - 176 cm
Seat Height	
21.7" / 55 cm	

1 Year Warranty

This Rollator has a 1 year warranty to be free of manufacturing defects in materials and workmanship under normal applications for 1 year of the original owner. If this product becomes inoperable due to defect and requires repair, return the product with all component pieces and proof of purchase to the address listed below. This warranty does not cover any shipping/transport costs. This warranty does not apply if the product is subject to misuse, neglect, rough handling or damage.

Ship the unit prepaid and insured (at owners option) to:

Thermor Ltd.

Attn: Repair Department

16975 Leslie Street

Newmarket, ON L3Y 9A1

www.biosmedical.com

Email: support@biosmedical.com

BIOS | Medical

 MANUFACTURED BY / FABRIQUÉ PAR :

THERMOR LTD.

16975 LESLIE STREET

NEWMARKET, ON L3Y 9A1

MADE IN CHINA / FABRIQUÉ EN CHINE

WWW.BIOSMEDICAL.COM