



SDHQ Motorsports
190 S McQueen Rd
Ste 109 Gilbert, AZ 85233
Phone: 480-633-2929

Product Packing List

Product: SDHQ-53-9211-G3

Description: '07-'21 Tundra, '08-'22 Sequoia & '08-'21 Land Cruiser/LX 570 Dual Battery Billet Power Steering Reservoir Kit

- | | | |
|-------|---|-------------------|
| _____ | (1) Universal Billet Power Steering Reservoir | SDHQ-00-9201-U1 |
| _____ | (1) SDHQ Dual Battery PS Reservoir Mount | SDHQ-53-9212-G3 |
| _____ | (1) Hardware Package | SDHQ-53-9211-G3-A |
| _____ | (1) Quart of Power Steering Fluid | |
| _____ | (1) 15" Power Steering Hose with 90° Fitting | |
| _____ | (1) 14" Power Steering Hose | |
| _____ | (1) 10" Power Steering Hose | |
| _____ | (1) -10 ORB to AN-10 Flare Fitting | |
| _____ | (1) AN-10 Push Lok 90° Fitting | |
| _____ | (1) 5/16" - 18 x 1 ¼" Grade 8 Bolt | |
| _____ | (2) 5/16" Grade 8 Washers | |
| _____ | (1) 5/16" - 18 Grade 8 Lock Nut | |

Inspected and Packaged By: _____ Date: _____

For questions or help with the installation, please call SDHQ Offroad @ 480-633-2929
Mon.-Fri. 8:00am-5:30pm and Sat. 8:00am-3:30pm Arizona Time. www.sdhqoffroad.com

Included in **SDHQ-00-9201-U1**:

- (1) SDHQ Power Steering Reservoir Cap
- (1) SDHQ Power Steering Reservoir Body
- (1) Hardware Package
 - (1) AN-6 Anti-Cavitation Fitting
 - (1) SDHQ 3D Printed Baffle

SDHQ-00-9201-U1-A
SDHQ-00-9201-U1-B
SDHQ-00-9201-U1-C



SDHQ Motorsports
 190 S McQueen Rd
 Ste 109 Gilbert, AZ 85233
 Phone: 480-633-2929

INSTALLATION INSTRUCTIONS

Product: SDHQ-53-9211-G3

Description: '07-'21 Tundra & '08-'22 Sequoia & '08-'21 Land Cruiser Dual Battery Billet Power Steering Reservoir Kit



| <u>Parts List</u> | <u>Hardware List</u> | <u>Required Tools</u> |
|---|---|--|
| (1) Universal Power Steering Reservoir SDHQ-00-9201-U1 (1) SDHQ Dual Battery PS Mount SDHQ-53-9212-G3 (1) Hardware Package SDHQ-53-9211-G3-A | (1) Quart of Power Steering Fluid (1) 15" Power Steering Hose with 90° Fitting (1) 14" Power Steering Hose (1) 10" Power Steering Hose (1) 5/16" – 18 x 1 1/4" Grade 8 Bolt (2) 5/16" Grade 8 Washers (1) 5/16" – 18 Grade 8 Lock Nut (1) -10 ORB to AN-10 Flare Fitting (1) AN-10 Push Lok 90° Fitting | Hand Pump Siphon Oil Catch Container Shop Rags 10mm Socket 1/2" Socket 1/2" Wrench Ratchet 3", 6" Extensions Pliers Assembly Lube #6, #10 and #12 AN Wrenches <u>or 11/16", 1" and 1 1/8"</u> Wrenches |

Tech Notes

Exercise extreme caution when working on a vehicle's power steering system. Fluids can be hot and/or pressurized. Check the reservoir fluid levels at operating temperatures after 25 – 50 miles of driving. For Tundra/Sequoia's, the 10" Power Steering Hose needs to be cut down to 8". [Compare to factory hose before cutting.](#) For Land Cruiser's, the 14" Power Steering Hose needs to be cut down to 9 1/2". [Compare to factory hose before cutting.](#) AN Wrenches are highly recommended for install, the equivalent standard wrenches would work also. Power Steering Filter (00-9204-U1) is an optional upgrade.

Approx. Install Time: 1 Hour

For questions or help with the installation, please call SDHQ Offroad @ 480-633-2929
 Mon.–Fri. 8:00am–5:30pm and Sat. 8:00am–3:30pm Arizona Time. www.sdhqoffroad.com



Hoses with factory clamps installed.

*****READ ALL INSTRUCTIONS THOROUGHLY FROM START TO FINISH BEFORE BEGINNING INSTALLATION!*****

Installation Instructions:

1. Unbox all parts and verify all parts are accounted for. Familiarize yourself with the parts. Begin with the 2007-2020 Tundra Dual Battery Kit (SDHQ-53-3001-G3) Install Instructions first.

2. The SDHQ Billet Power Steering Reservoir, fittings and mount need to be assembled first. Locate the SDHQ 3D Printed Baffle, the SDHQ Power Steering Cap and the SDHQ Power Steering Body as pictured right. Verify the o-ring on the SDHQ Power Steering Body, Cap and Baffle. Place the 3D Printed Baffle in the Body and tighten the Cap onto the Body.



3. Locate the AN-6 Anti-Cavitation Fitting and the AN-10 Cutoff Tapered Flare Fitting, as shown right. Check for the o-rings on these fittings, arrowed to in red right. Lube the threads of the AN-6 Anti-Cavitation Fitting with assembly lube/PS fluid and thread this fitting into the 'front' of the Power Steering Body such that the logo on the Cap is legible and this fitting is closest to you. Lube the threads of the AN-10 Cutoff Tapered Flare Fitting and thread this fitting into the 'rear' of the Power Steering Body such that the logo on the Cap is legible and this fitting is furthest from you. Tighten both fittings.

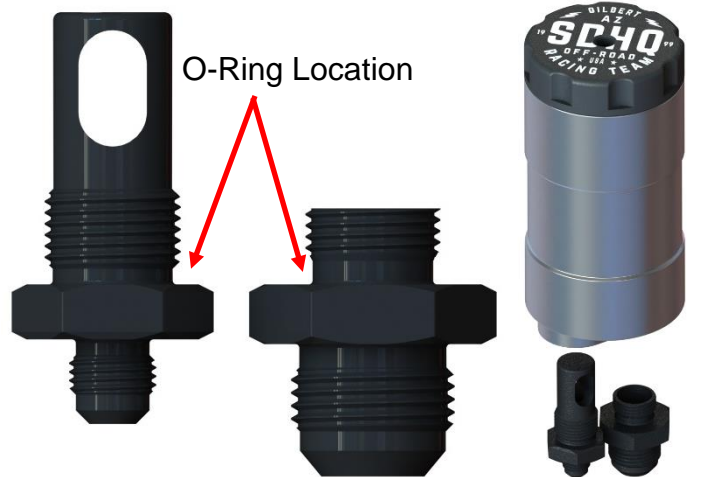

4. Install the Power Steering Body and Cap, 3D Printed Baffle and fittings into the SDHQ Dual Battery PS Mount as shown right. Position the Power Steering Reservoir as shown right, with the AN-6 Anti-Cavitation Fitting closer to the tab. Use the supplied 5/16" Hardware to secure the Power Steering Reservoir to the Mount.



For questions or help with the installation, please call SDHQ Offroad @ 480-633-2929
 Mon.-Fri. 8:00am-5:30pm and Sat. 8:00am-3:30pm Arizona Time. www.sdhqoffroad.com

5. Locate the AN-10 Push Lok 90° Fitting. Lube the threads of the AN-10 Cutoff Tapered Flare Fitting and thread the AN-10 Push Lok Fitting onto the AN-10 Cutoff Flare Fitting. The barbed end of the AN-10 Push Lok Fitting should be perpendicular to the mount as shown below. Tighten the AN-10 Push Lok Fitting.



6. If you purchased the optional Power Steering Filter (00-9204-U1), begin those Install Instructions before continuing.

7. **Installing new power steering hoses.** There are (2) factory power steering hoses that will be replaced underneath the vehicle. For Tundra/Sequoia's, the 10" power steering hose will need to be cut down to 8". Remove the skid plate to access (2) of the lines. Start on the passenger side and locate the hose shown to the right. Move the hose clamps off of the hard lines. With your catch container ready, remove the power steering hose and allow the power steering fluid to drain. Remove the (2) clamps on the old power steering hose and place them on the 10" (8") power steering hose. Lube the ends of the new power steering hose with power steering fluid and install it. Place the factory hose clamps back over the hard lines to secure the hose.

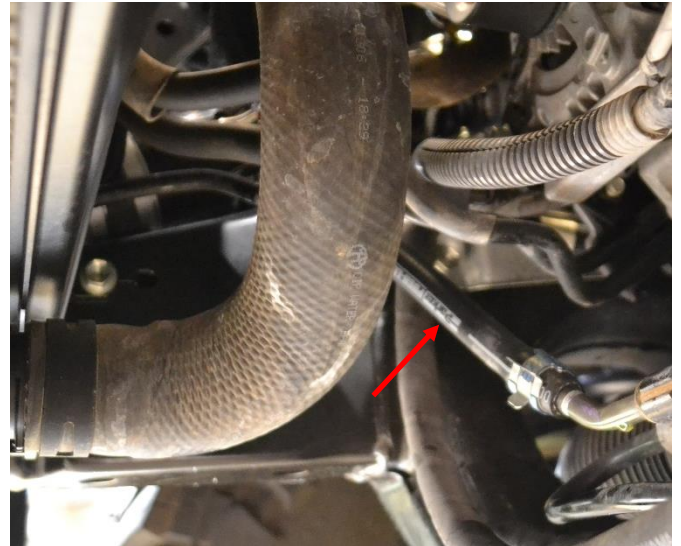

8. Locate the second power steering hose that will be removed on the driver side as shown to the right. Move the hose clamp off the hard line. With your catch container ready, remove this end of the power steering hose. Follow this hose up and back to the steering rack. Move the hose clamp off the hard line and remove the hose from the truck. For Land Cruiser's, the 14" Power Steering Hose will need to be cut down to 9 1/2". Install the new 14" (9 1/2") power steering hose with clamps.

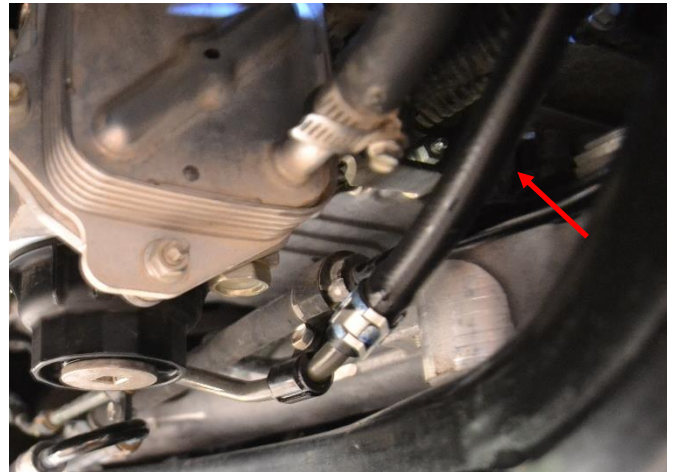

Before installing the Power Steering Reservoir, proceed to Step 8 in the Tundra Dual Battery Kit Install Instructions (**SDHQ-53-3001-G3**) or Step 9 in the Land Cruiser Dual Battery Kit Install Instructions (**SDHQ-52-3001-200**). Use the 15" Power Steering Hose with 90° fitting from this kit in place of the 17" Power Steering Hose supplied in your dual battery kit. Do **NOT** replace the larger diameter power steering hose with the 24" supplied in your dual battery kit, it will not fit properly over the push lok fitting and it will leak.

- 9. Installing the Power Steering Reservoir.** Install (2) 5/16" – 18 Nutclips to the SDHQ Dual Battery Power Steering Mount as shown right.

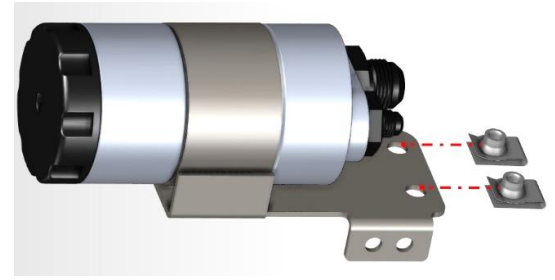

- 10.** Install the SDHQ Dual Battery Power Steering Mount onto the Dual Battery Tray using (2) 5/16" Button Head Bolts and (2) 5/16" Washers from the Tundra Dual Battery Kit (**SDHQ-53-3001-G3**). Be sure to align the Upright Support Bracket between the Main Battery Mount and the Power Steering Mount. See Figure 4 on Page 4 of the Tundra/LC Dual Battery Kit.

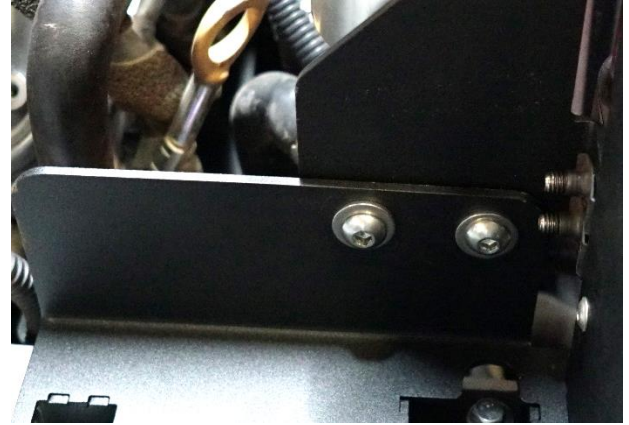

- 11. Connecting the power steering hoses.** The larger diameter factory hose will slip onto the AN fitting on the bottom of the power steering reservoir and secure with a hose clamp. The power steering hose that was replaced with the 15" power steering hose with 90° fitting will connect to the bottom of the reservoir. If the optional Power Steering Filter (00-9204-U1) was purchased, the 15" power steering hose will connect to the bottom of the filter.



The SDHQ Dual Battery Power Steering Reservoir Kit (**SDHQ-53-9211-G3**) install is complete. Proceed to Step 17 in the Tundra Dual Battery Kit (**SDHQ-53-3001-G3**) or Step 14 in the Land Cruiser Dual Battery Kit Installation Instructions (**SDHQ-52-3001-200**)

- 12.** Using the supplied power steering fluid, fill up the power steering reservoir to the internal fill line. With the power steering cap off, lift the vehicle so the front wheels are in the air and cycle the steering rack to either side until there is no longer air bubbling into the reservoir. Refill the reservoir as needed. Start the vehicle and check for any leaks. Clean up any spilt fluid.
- 13.** There will be some left over parts from the Tundra/LC Dual Battery Kit such as the 17" Power Steering Hose, (2) 1/4" – 20 x 3/4" S.S. Button Head Bolts, (4) 1/4" S.S. SAE Washers, (2) 1/4" – 20 S.S. Nylock Nuts, and the SDHQ Reservoir Mount/SDHQ Reservoir to Tray Mount.

*****Double check all hardware is installed correctly and tight*****

*****Re-torque ALL bolts after 100 miles*****



190 S McQueen Rd
Ste 109 Gilbert, AZ 85233
Phone: 480-633-2929 | Fax: 480-633-1791
www.sdhqoffroad.com

Follow us on:



Facebook



Instagram

For questions or help with the installation, please call SDHQ Offroad @ 480-633-2929
Mon.–Fri. 8:00am–5:30pm and Sat. 8:00am–3:30pm Arizona Time. www.sdhqoffroad.com