



SDHQ Motorsports
190 S McQueen Rd
Ste 109 Gilbert, AZ 85233
Phone: 480-633-2929

Product Packing List

Product: SDHQ-52-1661-200

Description: Land Cruiser Harrop Supercharger Water Pump Relocation Kit

- _____ (1) Harrop Supercharger Water Pump Relocation Bracket
SDHQ-52-1661-200-A

- _____ (1) Hardware Package
SDHQ-52-1661-200-B
 - _____ (4) #10-24 x 1/2" S.S. Socket head bolts
 - _____ (4) #10 S.S. washers
 - _____ (4) #10-24 No-Slip Clip-On Barrel Nuts
 - _____ (2) 1/4"-20 x 3/4" Hex Bolts
 - _____ (2) 1/4"-20 Top Lock Nuts
 - _____ (4) 1/4" Washers
 - _____ (1) Aeromotive 2 1/2"x 3/4" Clamp (P/N 12702)
 - _____ (1) 7" Door Edge Trim
 - _____ (1) 90 Degree Molded Heater Hose
 - _____ (1) Tube of Blue Thread Locker

Inspected and Packaged By: _____ Date: _____



SDHQ Motorsports
 190 S McQueen Rd
 Ste 109 Gilbert, AZ 85233
 Phone: 480-633-2929

INSTALLATION INSTRUCTIONS

Product: SDHQ-52-1661-200

Description: Land Cruiser Harrop Supercharger Water Pump Relocation Bracket Kit

*****This kit is only needed if you have a Harrop TVS2650 Supercharger Kit*****



<u>Parts List</u>	<u>Hardware List</u>	<u>Required Tools</u>
(1) Harrop Supercharger Water Pump Relocation Bracket SDHQ-52-1661-200-A (1) Hardware Package SDHQ-52-1661-200-B	(4) #10-24 x 1/2" S.S. Socket head bolts (4) #10 S.S. washers (4) #10-24 No-Slip Clip-On Barrel Nuts (2) 1/4"-20 x 3/4" Hex Bolts (2) 1/4"-20 Top Lock Nuts (4) 1/4" Washers (1) Aeromotive 2 1/2"x 3/4" Clamp (P/N 12702) (1) 7" Door Edge Trim (1) 90 Degree Molded Heater hose (1) Tube of Blue Thread Locker	10mm socket/wrench 13mm socket/wrench 15mm socket/wrench 1/2" socket/wrench T25 Torx bit T30 Torx bit Flush cut pliers Wire crimpers
<u>Tech Notes</u>		
-This kit is designed specifically for use with the SDHQ Built Hidden Winch Mount for 2008-2021 Toyota Land Cruiser. -Make sure all hoses and wiring is free from abrasion and pinching. -This kit will require you to open your superchargers cooling system, you will need to replace any coolant lost during install		

*****READ ALL INSTRUCTIONS THOROUGHLY FROM START TO FINISH BEFORE BEGINNING INSTALLATION! *****

For questions or help with the installation, please call SDHQ Offroad @ 480-633-2929
 Mon.-Fri. 8:00am-5:30pm and Sat. 8:00am-3:30pm Arizona Time. www.sdhqoffroad.com

Installation Instructions:

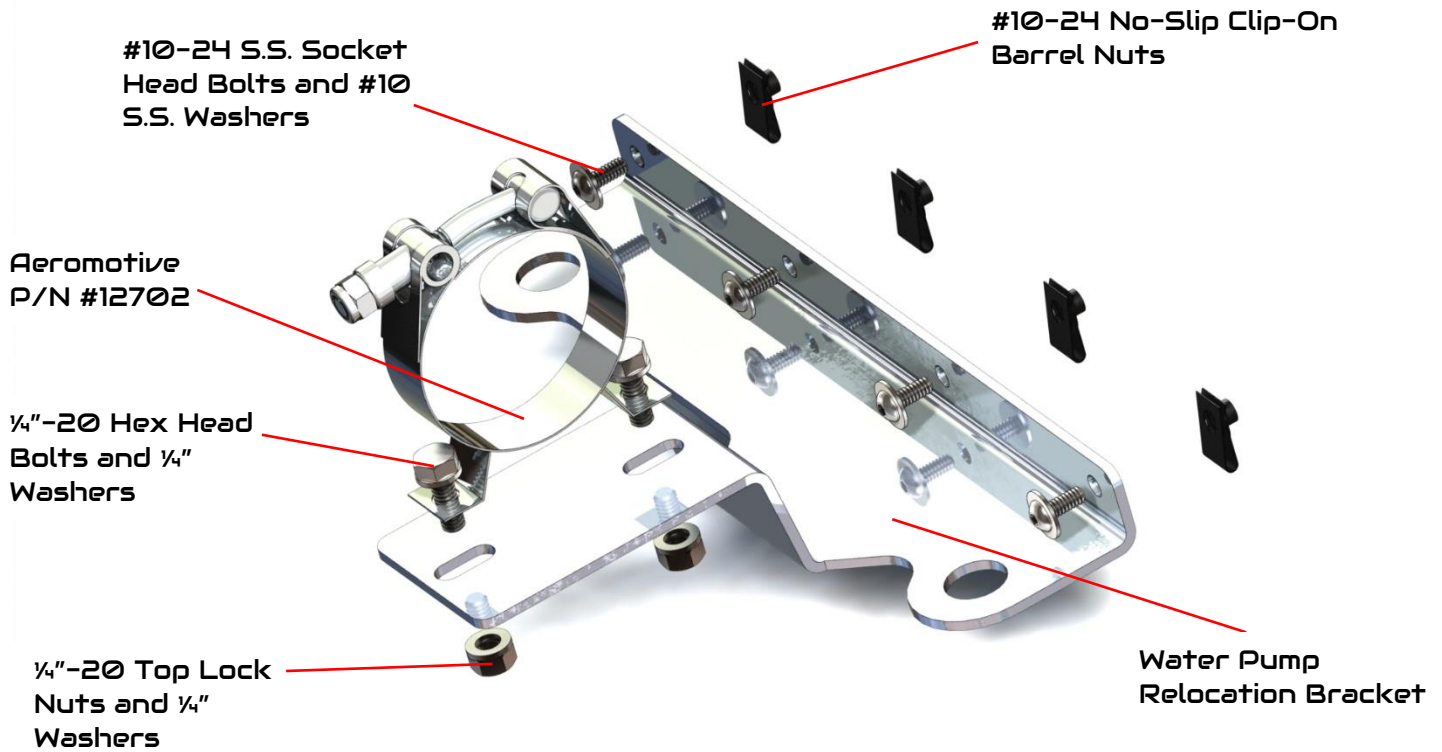

1. If you have previously installed the Harrop Supercharger TVS2650 Kit, you will need to unbolt the intercooler enough to reach the nuts holding the original water pump bracket to the intercooler. If you are installing the supercharger kit and the SDHQ Built Hidden Winch Mount concurrently then you can skip to Step 5.

2. Start to unbolt your intercooler by unbolting the (3) 10mm bolts and (1) 10mm nut holding the center support to the core support. Following that, unbolt the (2) aluminum brackets that hold the intercooler to the top of the core support. Bolt locations shown in the picture below.

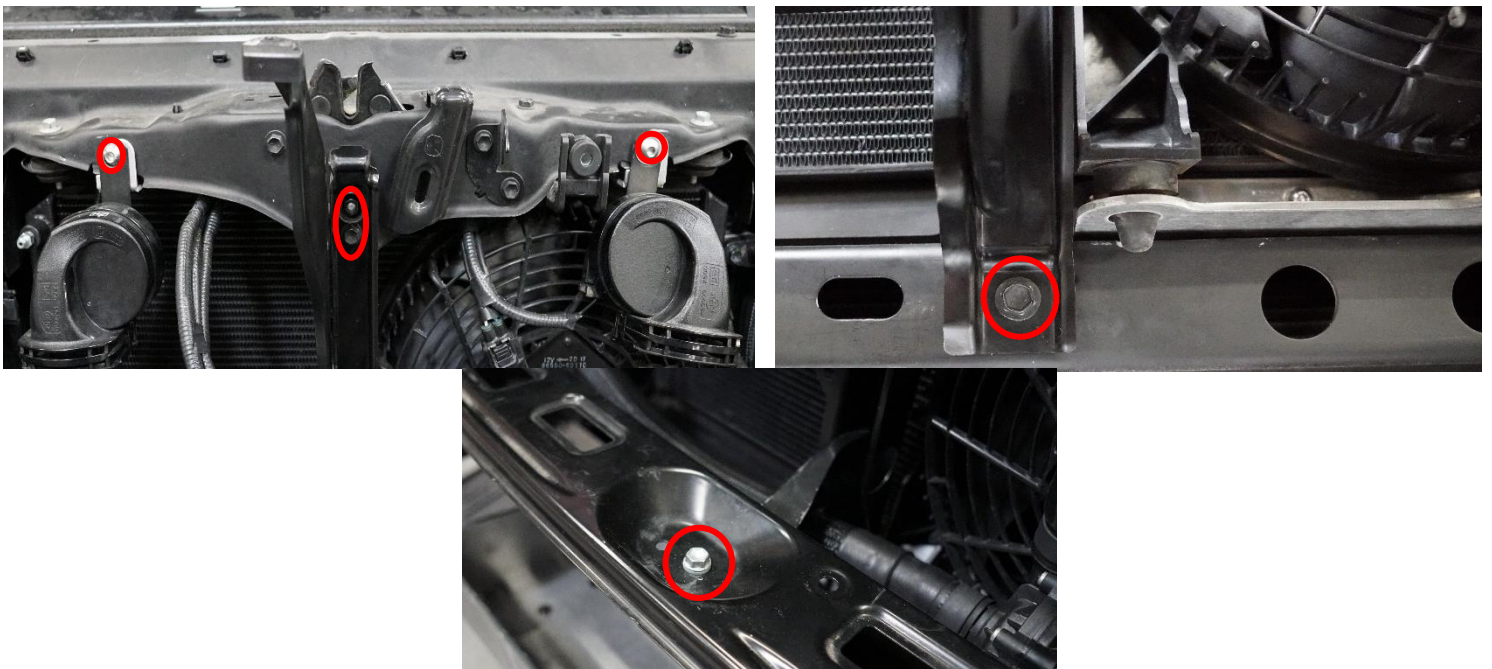

For questions or help with the installation, please call SDHQ Offroad @ 480-633-2929
Mon.-Fri. 8:00am-5:30pm and Sat. 8:00am-3:30pm Arizona Time. www.sdhqoffroad.com

3. Disconnect and unbolt the intercooler fan and set aside. Next, remove and discard the 2 clamps holding the water pump to the Harrop bracket, pictured below. Secure the water pump out of the way for now.



4. Now the intercooler will be able to move enough to get to the (4) 10mm nuts out from behind the intercooler. Carefully pull the bottom of the intercooler towards you and remove the (4) 10mm nuts and bolts, bolt locations pictured below. Now, you can remove and discard the original Harrop water pump bracket.

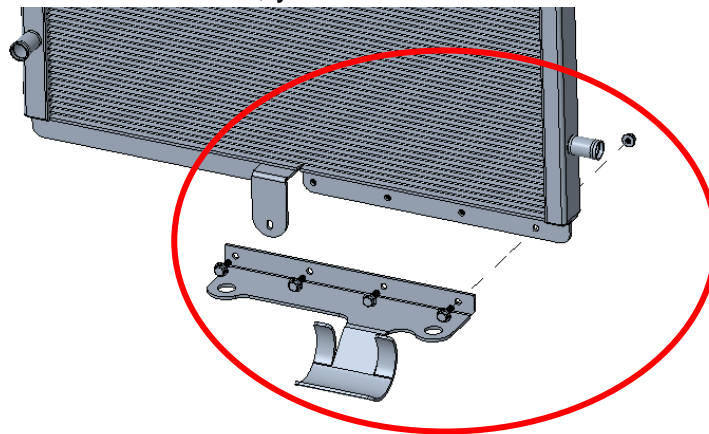

5. **Prepare the SDHQ Water Pump Relocation Bracket.** Insert the (4) #10-24 Nut Clips onto the flange of the intercooler, be sure to line them up with the predrilled holes. Install the Aeromotive clamp onto the flange of the relocation bracket, with the nut side facing out, using the (2) ¼"-20 bolts, (4) ¼" washers and (2) ¼"-20 Top Lock nuts, leave the hardware loose to aid in positioning the water pump during installation.

6. Mount your assembled relocation bracket to the intercooler with the (4) #10-24 x ½" S.S. socket head bolts and (4) #10 S.S. washers; when installing, add blue thread locker to the bolts to ensure they do not vibrate loose over time.

7. Reinstall the intercooler, fan and center support back into the vehicle in the reverse order of removal, leaving the water pump tucked out of the way.

8. In order to have both water lines for the water pump run without any kinks or awkward bends, you will have to remove the passenger side water line from the pump and replace it with the supplied 90 degree molded heater hose and place it through the center support. Before you run the water line through the center support, cut the 7" door edge trim piece in half and apply it to the inside of the center support where the water line will run. Next, place your drip pan under your working area and remove the old hose from the pump and intercooler, replace with 90 Degree hose and trim the end of it as necessary. Now place it through the center support and reattach it to the water pump. Pictured below shows the hose and door edge trim in the proper places.

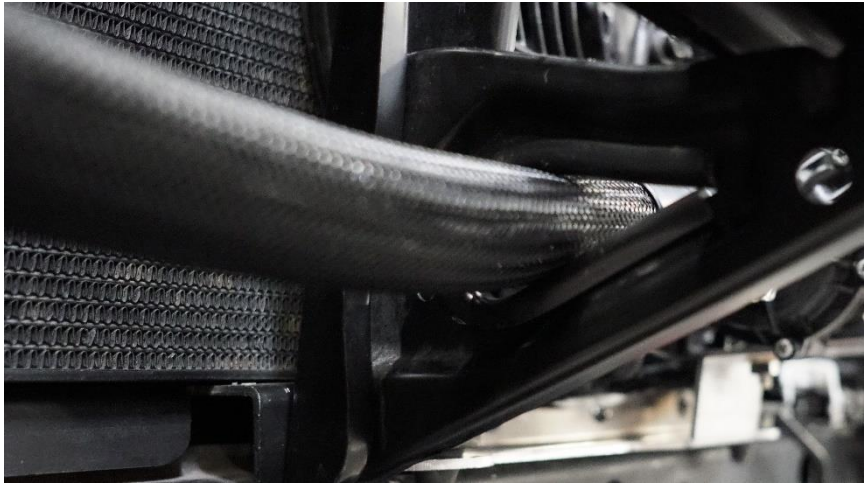

9. The water pump is now ready to be inserted into the clamp and tightened. Go over all hardware and connections and make sure everything is tight and connected properly. You can now continue with the install of your SDHQ Built Hidden Winch Mount for your Land Cruiser!

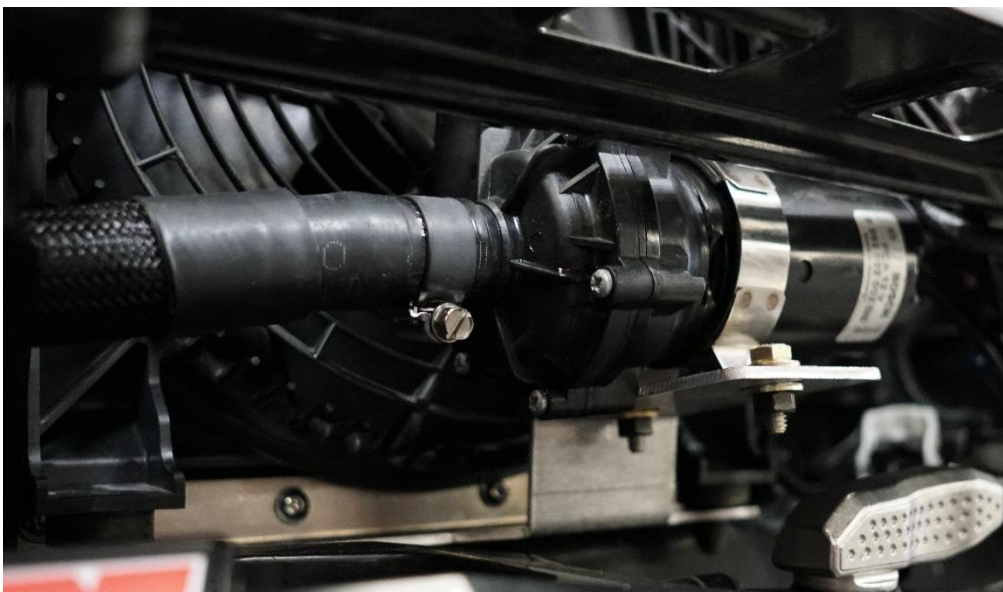

Proceed to Step 5 in the SDHQ Built Hidden Winch Mount for the 2008-2021 Land Cruiser (SDHQ-52-1650-200) install instructions

*****Double check all hardware is installed correctly and tight*****

*****Re-torque ALL bolts after 100 miles*****



190 S McQueen Rd
Ste 109 Gilbert, AZ 85233
Phone: 480-633-2929 | Fax: 480-633-1791
www.sdhqoffroad.com

Follow us on:



Facebook



Instagram

For questions or help with the installation, please call SDHQ Offroad @ 480-633-2929
Mon.–Fri. 8:00am–5:30pm and Sat. 8:00am–3:30pm Arizona Time. www.sdhqoffroad.com